

863

in the year of our Lord, one thousand nine hundred twenty-seven
between Caroline McClaren a widow as owner and Elizabeth M. Hall
as mortgagee

parties of the first part
and City of Riverside, a Municipal Corporation, organized and
existing under the laws of the State of California
party of the second part,

863

WITNESSETH, That for and in consideration of the sum of
TEN Dollars,

in hand paid by the said party of the second part, the receipt whereof is hereby ac-
knowledged, the said parties of the first part do by these presents grant, bargain, sell,
convey and confirm unto the said party of the second part and to its
successors and assigns forever, all that certain lot or parcel of land situate in
the County of San Bernardino State of

California and bounded and particularly described as follows, to-wit:
An Easement to excavate for, and lay, construct, maintain, operate,
repair, alter, replace, and remove, a line of pipe constructed of
steel or concrete not exceeding 42" in diameter, for the purpose of
conveying domestic water, through lot 22 adjacent to the westerly
line thereof, Sec. 5, Twp. 2 South, Range 4 West, S.B.B.&M., per map
recorded in Book 6 of maps, page 44, Records of San Bernardino, Calif.
The easterly side of said pipe shall not exceed a distance of thirty
feet easterly from the westerly line of said lot. A plat is hereto
attached and made a part hereof. Should second party have cause to
re-enter this land after the first installation for purposes connected
with said pipe line as enumerated, then and in that event second party
shall at that time pay what damages it does to structures, trees, and
crops.

Together with all and singular, the tenements, hereditaments and appurtenances there-
unto belonging, or in anywise appertaining, and the reversion and reversions, remainder
and remainders, rents, issues and profits thereof.

To Have and to Hold all and singular, the said premises together with the appurte-
nances, unto the said party of the second part and to its successors
and assigns forever.

In Witness Whereof, the said parties of the first part have hereunto set their
hands the day and year first above written.

Caroline McClaren
Elizabeth M. Hall

State of California

COUNTY OF ~~RIVERSIDE~~ San Bernardino } SS.

On this 13th day of June in the year one thousand nine hundred twenty seven, before me, Noah Adair

a Notary Public in and for said County and State, personally appeared

Caroline McCleskey

known to me to be the person... described in and whose name... is subscribed to the within instrument, and acknowledged that... She... executed the same.

In Witness Whereof: I have hereunto set my hand and official seal, at my office in the said County, the day and year in this Certificate first above written.

Noah Adair

Notary Public in and for the County of Riverside, San Bernardino State of California

Approved as to form
Georget. Branch
City Attorney

Dated..... 19.....
S 24 1M

-70-

Deed

[RECORDER'S FORM]

State of California,
COUNTY OF LOS ANGELES

On this 1st day of June A. D., 1927 before me,
John W. Scheuch a Notary Public in and for the said
County and State, residing therein, duly commissioned and sworn, personally appeared
Elizabeth M. Hall

known to me to be the person whose name is subscribed to the within
Instrument, and acknowledged to me that ^s he executed the same.
In Witness Whereof, I have hereunto set my hand and affixed my official seal
the day and year in this Certificate first above written.

John W. Scheuch
Notary Public in and for said County and State.

*ACKNOWLEDGMENT—General—Wolcott's Notary Blank 232.

My Commission Expires June 21, 1928

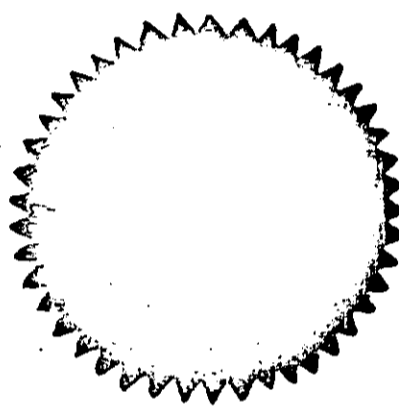

RESOLUTION NO. 1156 (NEW SERIES)

RESOLUTION OF THE COMMON COUNCIL OF THE CITY OF RIVERSIDE ACCEPT^{ing}
A DEED FOR A RIGHT-OF-WAY FOR A DOMESTIC WATER PIPE LINE.

RESOLVED; by the Common Council of the City of Riverside,
that deed dated May 27, 1927, executed by CAROLINE MCCLARREN, a
widow as owner, and ELIZABETH M. HALL, as mortgagee, to the City
of Riverside, a municipal corporation, of the County of Riverside,
State of California, for an easement for right-of-way to excavate
for, and lay, construct, maintain, operate, repair, alter, replace,
and remove a line of pipe constructed of steel or concrete not
exceeding 42" in diameter, for the purpose of conveying domestic
water through the following described premises situated in the
County of San Bernardino, State of California, and more partic-
ularly described as follows, to-wit:

Lot 22 adjacent to the westerly line thereof, Sec. 5, Twp. 2
South, Range 4 West, S.B.B. & M., per map recorded in Book 6 of
maps, page 44, Records of San Bernardino, California. The easterly
side of said pipe shall not exceed a distance of thirty feet
easterly from the westerly line of said lot. A plat is hereto at-
tached and made a part hereof. Should second party have cause to
re-enter this land after the first installation for purposes con-
nected with said pipe line as enumerated, then and in that event
second party shall at that time pay what damages it does to struc-
tures, trees, and crops,

be, and the same is hereby, accepted; and

BE IT FURTHER RESOLVED; that a copy of this resolution be at-
tached to said deed and that the same be recorded in the office of
the County Recorder of San Bernardino, California, and thereafter
filed in the office of the City Engineer of the City of Riverside,
California.

I, G. Albert Mills, the duly elected, qualified and acting
Clerk of the City of Riverside, California, do hereby certify that
the foregoing resolution was duly and regularly introduced and ad-
opted by the Common Council of the City of Riverside, California,
at its meeting held on the 23th day of June, 1927, by the following
vote:

Ayes: Councilmen Strickler, Lord, Wagner, Taylor, Backstrand and
Wells.

Noes: None.

Absent: None.

G. Albert Mills

Clerk of the City of Riverside.

I hereby approve the foregoing resolution this 30th day of
June, 1927.

J. T. Jarvis

Mayor of the City of Riverside.

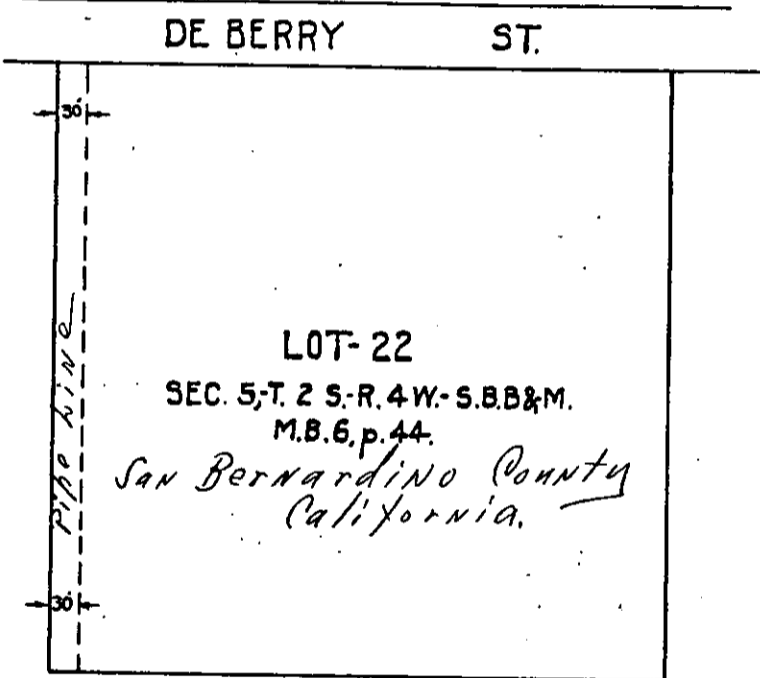

SMH-R

INDEXED

91

*City Clerk -
City of Riverside*

DEED

Caroline McClaren

To

City of Riverside

Dated May 27, 1927.

Approved as to Form

Georg A. Frueh
City Attorney

Approved as to Description

Edward H. Lawm
Consulting Engineer.

Approved as to Title

A. R. ...
Right-of-way Agent.

Recorded
 JUL 8 1927
 AT REQUEST OF
 Grantee
 Trustees
 Trustor
 Mortgagee
 Mortgage
 Sheriff
 Attorney
 Grantor

34

Min Past 9 A.M.

In Book 246

Page 304

Of Official Records

San Bernardino County, Calif.

Carlton G. Erava

County Recorder

I certify that I have correctly transcribed this document in above mentioned book.

... Copyist

R. MARTIN

Nov 17

13

This Indenture, Made the 2d day of June

in the year of our Lord, one thousand nine hundred twenty-seven

between F. W. Thayer, *an unmarried man,*

864

party of the first part and City of Riverside, a Municipal Corporation organized and existing under the laws of the State of California

party of the second part,

WITNESSETH, That for and in consideration of the sum of

TEN Dollars,

in hand paid by the said party of the second part, the receipt whereof is hereby acknowledged, the said party of the first part does by these presents grant, bargain, sell, convey and confirm unto the said party of the second part and to its

successors heirs and assigns forever, all that certain lot or parcel of land situate in the

County of San Bernardino State of

California and bounded and particularly described as follows, to-wit:

An Easement to excavate for, and lay, construct, maintain, operate, repair, alter, replace, and remove, a line of pipe constructed of steel or concrete not exceeding 42" in diameter, for the purpose of conveying domestic water, through Lot 58 as herein described and shown by plat hereto attached and made a part hereof, Sec. 5, Twp. 2 South, Range 4 West, S.B.B.&M., as per map recorded in Book of Maps 6, Page 44, Records of San Bernardino County, California. The center line of said Easement is described as follows, viz:

Beginning at a point in the northerly boundary line of lot 55 as shown on the map book above referred to, distant westerly along said northerly line 13.83 feet from the northeast corner of said lot 55; thence south 24°42'28" west through said lots 55 and 58, a distance of 1347.54 feet to a point; thence along the arc of a tangent curve concave northwesterly and having a radius of 100 feet, a distance of 45.68 feet, more or less, to the southerly boundary line of said lot 58, distant easterly along said southerly boundary line, 41.20 feet from the southwest corner of said lot 58; thence continuing along the arc of said last mentioned curve a further distance of 69.20 feet to a point in the COUNTY LINE ROAD distant 10 feet northerly, measured at right angles from the center line of said road.

The undersigned granting such Easement only as to that prt of the land above described of which they are the owner or otherwise interested.

Together with all and singular, the tenements, hereditaments and appurtenances thereunto belonging, or in anywise appertaining, and the reversion and reversions, remainder and remainders, rents, issues and profits thereof.

To Have and to Hold all and singular, the said premises together with the appurtenances, unto the said party of the second part and to its successors heirs and assigns forever.

In Witness Whereof, the said party of the first part has hereunto set his hand the day and year first above written.

F. W. Thayer