

No Fee - 6103 Government Code

91137

When recorded mail to:  
City Clerk's Office  
City of Riverside  
City Hall, 3711 Orange Street  
Riverside, California 92501  
Bldg. Permit - 7638 Freda Ave.

RECEIVED FOR RECORD  
JUL 19 1974  
Min. Past 3 o'clock P.M.  
CITY CLERK  
Book 1974, Page 91137  
Recorded in Official Records of Riverside County, California  
W.H. DeLoach Recorder  
FEES \$

INDEXED

DOCUMENTARY TRANSFER TAX  
\$             None

Signature *[Signature]*  
CITY OF RIVERSIDE

FOR RECORDER'S OFFICE USE ONLY

GRANT DEED

APPROVED AS TO FORM  
*[Signature]*  
ASS. CITY CLERK

8228

PEDRO CHAVEZ, a single man

\_\_\_\_\_, Grantor

FOR A VALUABLE CONSIDERATION, receipt of which is hereby acknowledged, do es hereby grant to the CITY OF RIVERSIDE, a Municipal Corporation, the real property in the City of Riverside, County of Riverside, State of California, described as follows:

The northwesterly 8.00 feet of Lot 19 of Map of MONTEREY SUBDIVISION as shown by map on file in Book 12 of Maps, at page 24 thereof, Records of Riverside County, California.

Area: 373.6 square feet

DESCRIPTION APPROVAL  
by *[Signature]* 7/12/74 by *[Signature]*  
Surveyor

*[Signature]*

Dated 7/12/74

*[Signature]*  
PEDRO CHAVEZ

STATE OF CALIFORNIA,  
COUNTY OF Los Angeles } ss.

ON July 12, 19 74,  
before me, the undersigned, a Notary Public in and for said State, personally appeared  
Pedro J. Chavez

to be the person whose name            is            subscribed to the within Instrument, and acknowledged to me that he executed the same.

WITNESS my hand and official seal.



*[Signature]*  
Notary Public in and for said State.

8228

91137

91137

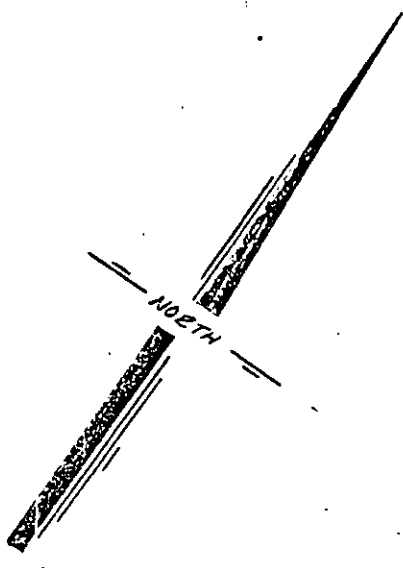

(Formerly)

D-536

7700

# FERN AVE

7694	7688	7672	7664	7658	7650	7642	7634-36	7628	7620	7614	7606
46.72	"	"	"	"	"	"	"	"	46.71	46.73	50
40	41	42	43	44	45	46	47	48	49	50	52
<b>MONTREY</b>											
						M.B. 12/24					
39	38	37	36	35	34	33	32	31	30	29	28
46.71	"	"	"	"	"	"	46.71	"	"	46.71	46.71
7695	7689	7673	7665	7659	7651	7643	7635	7627	7621	7615	7607

# FREDA AVE

7688								7634	7628	7620	7614	7606
46.70	"	"	"	"	"	"	"	"	46.70	46.71	50	
14	15	16	17	18	19	20	21	22	23	24	25	26
<b>JUB</b>												
										M.B. 12/29 P.M. CO.		
13	12	11	10	9	8	7	6	5	4	3	2	1
46.69	"	"	"	"	"	"	"	"	"	46.69	40	50
7689	7683	7677	7671	7665	7659	7653	7647	7641	7635	7629	7623	7617

# LINCOLN

CARY ST

SOUTH

## CITY OF RIVERSIDE, CALIFORNIA

THIS PLAT IS SOLELY AN AID IN LOCATING THE PARCEL(S) DESCRIBED IN THE ATTACHED DOCUMENT. IT IS NOT A PART OF THE WRITTEN DESCRIPTION THEREIN.

SHEET 1 OF 1

5/38

SCALE: 1" = 100'

DRAWN BY WF DATE 7/9/74

SUBJECT BLDG PERMIT - 7638 FRENDA AVE.

8228