



ENCROACHMENT PERMIT
Storm Drain Connection
 City of Riverside - Public Works Dept.
 951-826-5341

Issuance of this permit shall not be construed as a waiver of any other applicable permit or requirement, and is only revocable permission to use the land for the purpose described.

Owner: KIENLE & KIENLE INVESTMENTS LLP
Location: 7082 INDIANA AV RIVE
A.P.N.: 229-091-001

Encroachment: Connect Private S.D. to City Catch Basin per Attached Exhibits

The above-described encroachment being shown on Exhibit A attached hereto.

Upon issuance of this permit, I agree to comply with the attached terms and conditions.

Date: 12/22/08

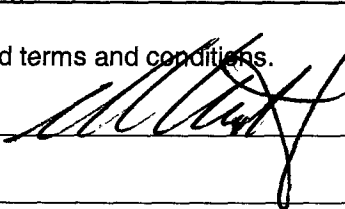
By:  **STEVE KIENLE**
 OWNER

Date: _____

By: _____

Applicant

IW CONSULTING ENGINEERS, INC
 3544 UNIVERSITY AVENUE
 RIVERSIDE, CA 92501
 951-687-2929

Contractor/Developer

STILWELL CONSTRUCTION INC
 P O BOX 55106
 RIVERSIDE, CA 92517-5106
 951/686-5088

ENCROACHMENT PERMIT APPROVAL

This permit has been reviewed and approved by the Departments listed below provided the attached terms and conditions are adhered to:

- P/W ENGINEERING
- P/W TRAFFIC
- P/U WATER

FINAL APPROVAL

Date: 12/22/08

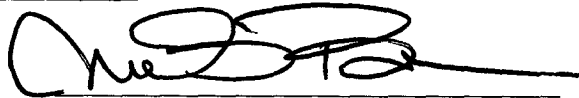
 City Engineer

THIS PERMIT IS NOT VALID UNTIL ISSUED AND POSTED IN CITY RECORDS

Issued by: Nicole Clark

Dated: 12/22/08



City of Riverside

The following are requirements that need to be met for your permit #PW08-0800 .

- 1: Permittee acknowledges that the area of encroachment is owned or controlled by the City of Riverside
- 2 Permittee acknowledges that the described property could be needed for a proposed or planned public improvement and the City may revoke this permit. Upon written notice of revocation, the permittee shall, within the time prescribed by the City, remove all improvements placed, constructed or maintained. If the permittee fails to abide by the removal order of the City, the City shall have the right to remove and destroy the improvements without reimbursement to the permittee. The cost of such removal shall be paid by the permittee to the City and shall constitute a debt owed to the City.
- 3: Permittee waives the right of claim, loss, damage or action against the City resulting from revocation, termination, removal of improvements or any action of the City, its officers, agents or employees taken in accordance with the terms herein
- 4 If the Public Works Director of the City of Riverside finds that the permittee is in default of the terms of this permit, that shall be cause for revocation
- 5 Permittee herewith agrees to hold the City of Riverside harmless from and against all claims demands, costs, losses, damages, injuries, actions for damages and/or injuries, and liability in connection with the construction, encroachment, and/or maintenance to be done by permittee within the described property.
- 6: Prior to any construction taking place on City controlled property, permittee shall obtain a Construction Permit or Street Opening Permit from the City Public Works Department
- 7 The permittee agrees to insure that construction of their improvements will not interfere in any way with any existing City or utility facilities
- 8 Permittee acknowledges that existing city or utility facilities will require future maintenance, reconstruction, and revisions and that facilities may be added, any of which may result in removal or alteration of the permittee's improvements without reimbursement to the permittee
- 9 Prior to construction, permittee shall contact Underground Service Alert to field locate existing utility lines. Any conflicts discovered will void the permit until acceptable revisions are made. It shall be Permittee's responsibility to determine the location and required clearances from all public and private utility, sewer and drainage facilities prior to drilling and shall only drill in compliance with such clearance requirements
- 10 All on-site catch basins and inlets must have a properly installed and maintained drainage water filtration system to Public Works Specifications
- 11 Permittee acknowledges that there are existing public works and public utility facilities that may interfere with the proposed improvement. All existing utilities, sewers and storm drains must be field located (pot-holed) prior to installation of the proposed facilities.
- 12 Permittee acknowledges that all maintenance of the drain line between its connection with the line in the street and the right of way line is the responsibility of the permittee.

EDB-0800

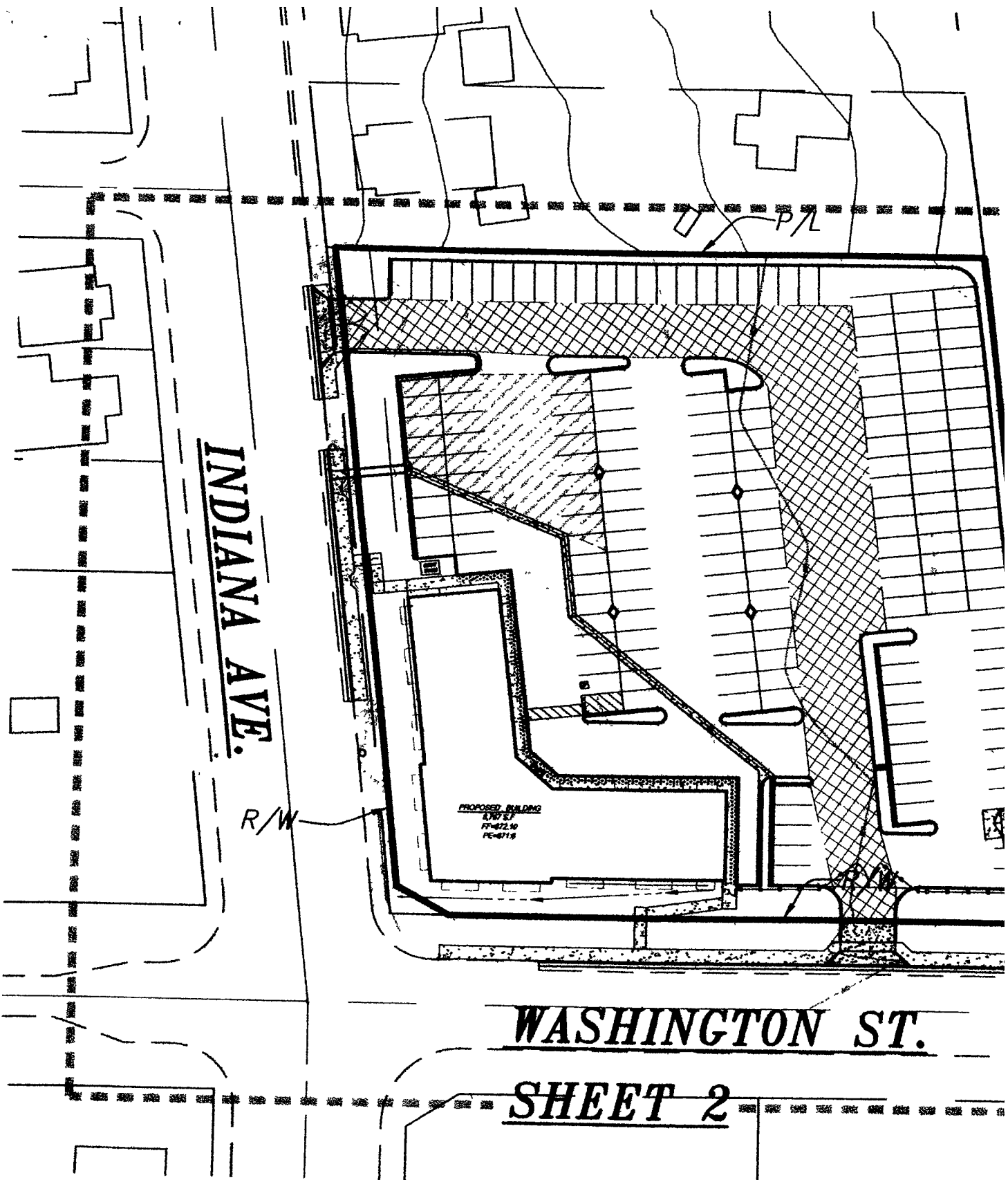

INDIANA AVE.

WASHINGTON ST.

SHEET 2

NOTE

THESE PLANS ARE FOR
 THESE QUANTITIES DO NOT
 3, SUBSIDENCE, OVER
 CONDITIONS THAT MAY BE
 LS REPORT. SINCE THE
 EXACT METHOD OR MEANS
 GRADING OPERATIONS,
 THE EXACT SOIL

INDEX MAP

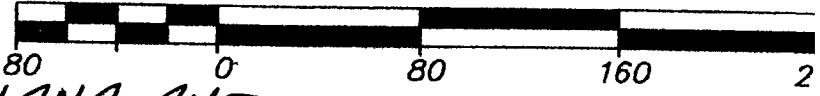

7082 INDIANA AVE
 PW07-0895

SCALE: 1"=80'

EDB-D800

LANA AVENUE

SEE SHEET 3 FOR DETAIL "G"

PROPOSED GRADED SINGLE ABOVE STORM DRAIN PIPE (TYP)

PROPOSED BUILDING
8,767 S.F.
FF=872.10
PE=871.6

TER LATERAL

EX WATER METER TO BE REMOVED

EX 1" WATER SERVICE

EXIST. 12" WATER

EXIST. 24" ML&C WATER

EXIST. CURB AND GUTTER

EXIST. S/W

PROP. R/W

EXIST. R/W

EXIST. 8" VCP SEWER

ST. SEWER LATERAL

EXIST. 18" RCP STORM DRAIN

STORM DRAIN CONCRETE

EXIST. 24" ML&C WATER

EXIST. 12" WATER

EXIST. 8" VCP SEW

EDB-DB00

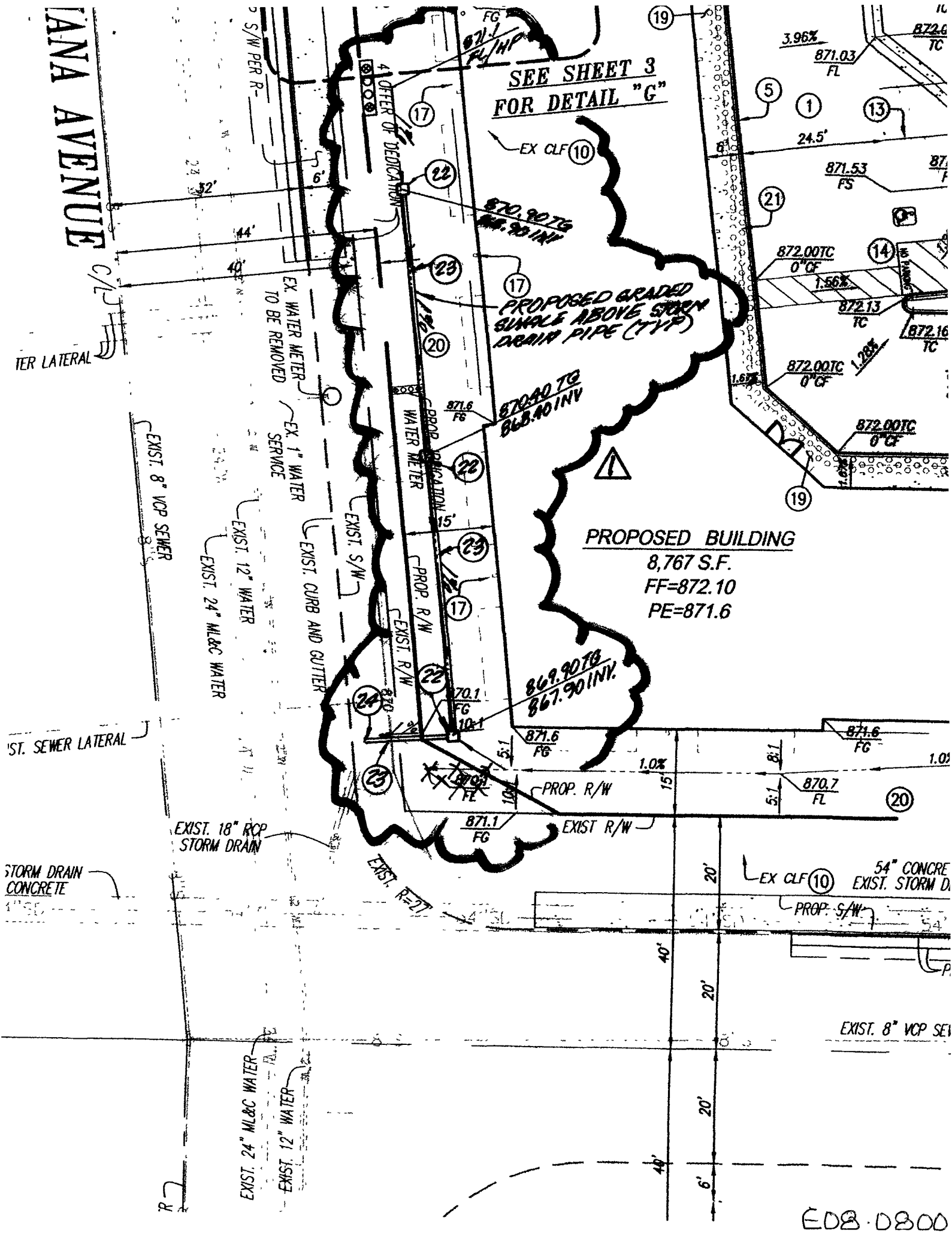

OR APPROVED EQUAL.



- 23) INSTALL 6" PVC STORM DRAIN PIPE.
- 24) CONNECT TO EXISTING BACK OF CATCH BASIN PER CITY OF RIVERSIDE REQUIREMENTS AND PROVISIONS OF THE ENCROACHMENT PERMIT.

PAVEMENT LEGEND



AC PAVEMENT



CONCRETE



3" THK. A.C. PAVING OVER 6" THK.
COMPACTED CL. II AGGR. BASE

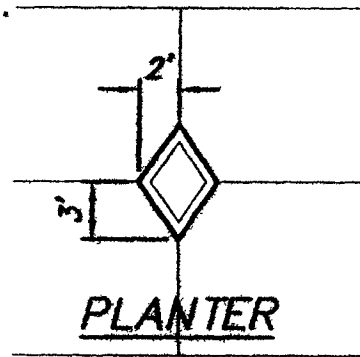

* NOTE:

PRIOR TO CONSTRUCTION, THE CONTRACTOR SHALL VERIFY THE HORIZONTAL AND VERTICAL POSITION OF ALL POINTS OF CONNECTION TO, OR CROSSING OF EXISTING STRUCTURES. THIS SHALL INCLUDE BOTH ABOVE GROUND AND BELOW