



ENCROACHMENT PERMIT
General Permit
 City of Riverside - Public Works Dept.
 951-826-5341

Issuance of this permit shall not be construed as a waiver of any other applicable permit or requirement, and is only revocable permission to use the land for the purpose described.

Owner: MCDONALDS CORP
Location: 2242 UNIVERSITY AV RIVE
A.P.N.: 221-022-032

Encroachment: Install Drive through curb and Arbor in City Right of Way per attached exhibit.

The above-described encroachment being shown on Exhibit A attached hereto.

Upon issuance of this permit, I agree to comply with the attached terms and conditions.

Date: Jan 8, 2010

By: [Signature]

Date: Jan 12 2010

By: [Signature]

Applicant
 MC SPI INC.
 3353 DURAHART STREET
 RIVERSIDE CA
 92507

Contractor/Developer

RECEIVED

JAN 21 2010

Public Works

ENCROACHMENT PERMIT APPROVAL

This permit has been reviewed and approved by the Departments listed below, provided the attached terms and conditions are adhered to:

- P/W ENGINEERING
- P/W TRAFFIC
- P/U WATER
- P/U ELECTRIC
- PLANNING

FINAL APPROVAL

Date: 12/21/09

[Signature]
 City Engineer

THIS PERMIT IS NOT VALID UNTIL ISSUED AND POSTED IN CITY RECORDS

Issued By: Nicole Clark

Dated: 1/22/10

Request for Processing Encroachment

Case No. P09-0268 & P09-0269

2242 University Avenue
Riverside, CA 92507

APN: 221-022-032

Proposed encroachment:

1. Four (4) trellis columns in their entirety (2'-8") are 3'-8" within the landscape dedication (public right-of-way). However, the trellises are within 0'-0" from the back of the existing sidewalk.
2. A portion of the concrete curb that runs parallel to the drive-thru falls within the landscape dedication. The curb face is on P.L. so 6" of concrete encroach onto the right-of-way for about 162'-7" in length

EXHIBIT ENCLOSED (Sheet 2 of 2)

Request for Processing Encroachment

Case No. P09-0268 & P09-0269

2242 University Avenue
Riverside, CA 92507

APN: 221-022-032

Proposed encroachment:

1. Four (4) trellis columns in their entirety (2'-8") are 3'-8" within the landscape dedication (public right-of-way). However, the trellises are within 0'-0" from the back of the existing sidewalk.
2. A portion of the concrete curb that runs parallel to the drive-thru falls within the landscape dedication. The curb face is on P.L. so 6" of concrete encroach onto the right-of-way for about 162'-7" in length.

EXHIBIT ENCLOSED (Sheet 2 of 2)

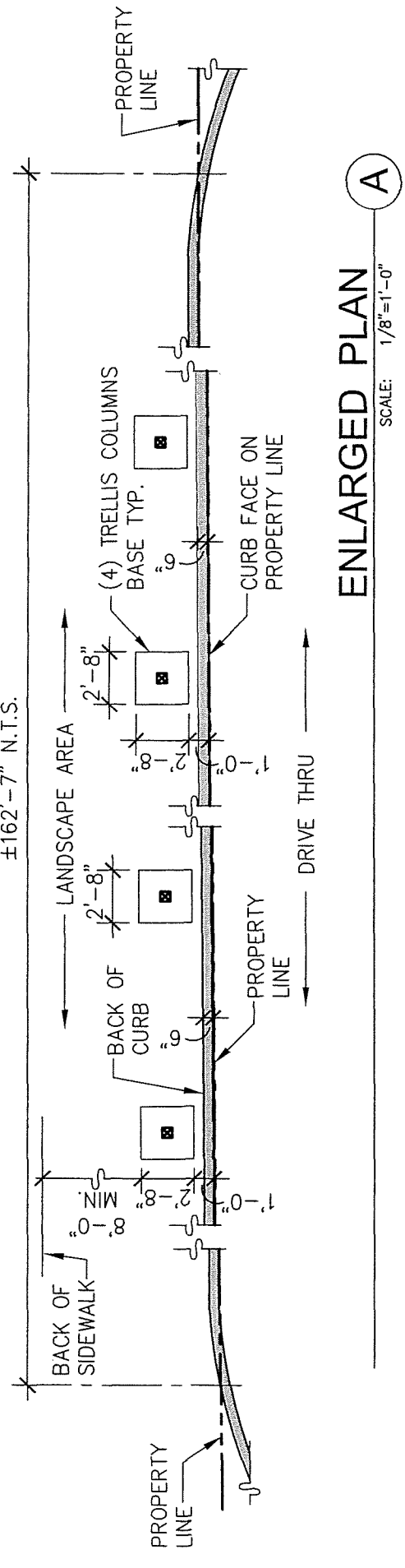
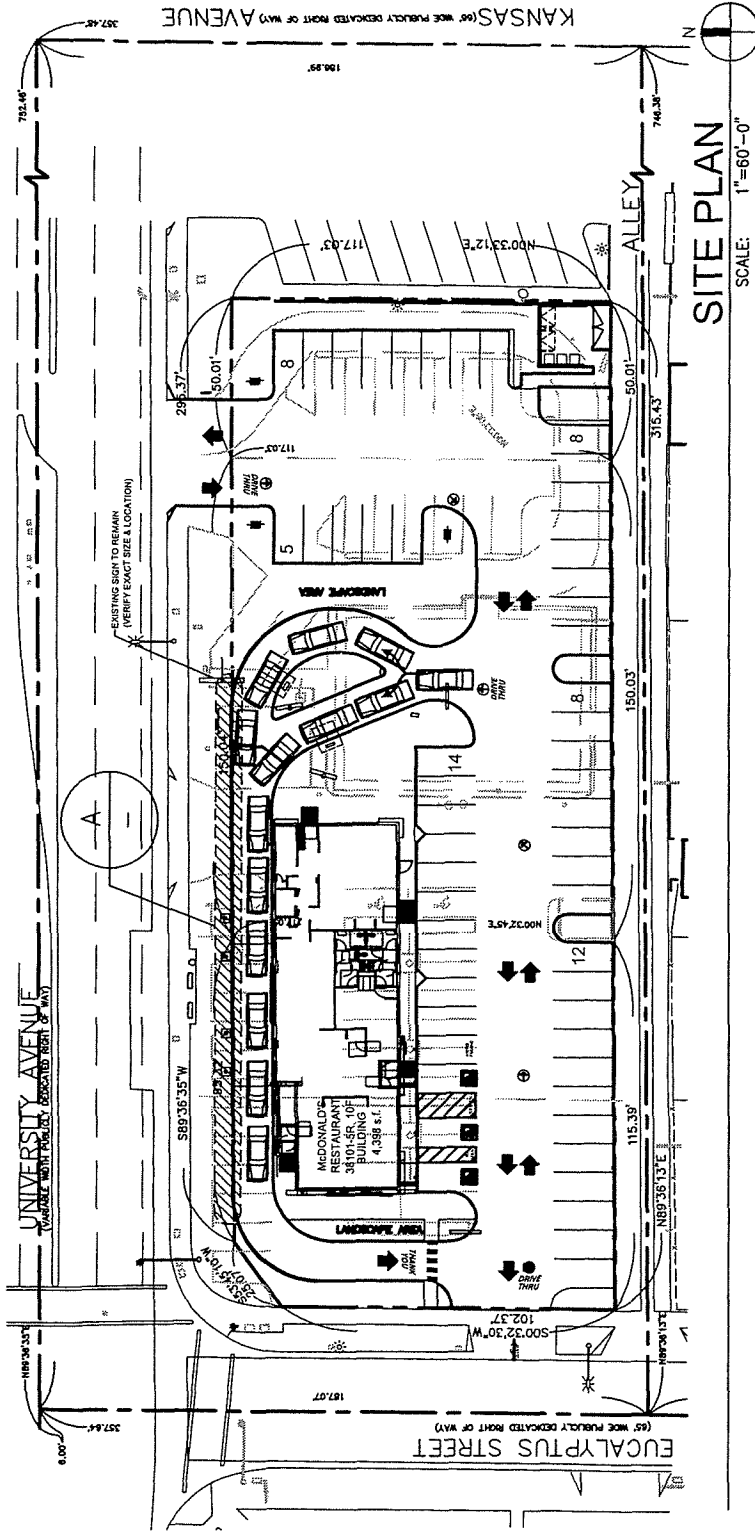

architectural
planning
interiors
graphics
site development
interior design
1100 California 95818
Folsom, California
95630
709.448.1591

WARE MALCOMB
Leading Design for Commercial Real Estate

PROJECT:
MCDONALD'S - 2242 UNIVERSITY AVE.
JOB NO.:
IRV08-0164-00

DATE :
DEC. 14, 2009
SCALE:
AS SHOWN

SHEET
20F2