



ENCROACHMENT PERMIT
Storm Drain Connection
City of Riverside - Public Works Dept.
951-826-5341

Issuance of this permit shall not be construed as a waiver of any other applicable permit or requirement, and is only revocable permission to use the land for the purpose described.

Owner: CITY OF RIVERSIDE - PARK AND REC
Location:
A.P.N.:

Encroachment: CONNECT TO CITY STORM DRAIN PER ATTCHED EXHIBITS

The above-described encroachment being shown on Exhibit A attached hereto.

Upon issuance of this permit, I agree to comply with the attached terms and conditions.

Date: 8/13/10
 Date: _____

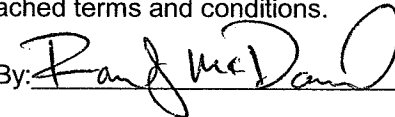
By: 
 By: _____

Applicant
 CITY OF RIVERSIDE - PARK AND REC

Contractor/Developer

ENCROACHMENT PERMIT APPROVAL

This permit has been reviewed and approved by the Departments listed below provided the attached terms and conditions are adhered to:

- P/W ENGINEERING
- P/W TRAFFIC
- P/U WATER

FINAL APPROVAL

Date: 8/16/10

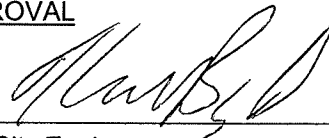
 City Engineer

THIS PERMIT IS NOT VALID UNTIL ISSUED AND POSTED IN CITY RECORDS

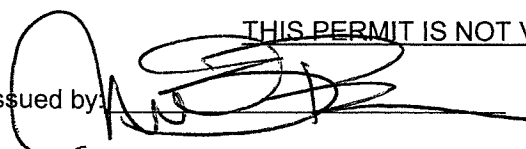
Issued by: 

Dated: 8/12/2010



City of Riverside

The following are requirements that need to be met for your permit #PW10-0364 .

- 1: Permittee acknowledges that the area of encroachment is owned or controlled by the City of Riverside.
- 2: Permittee acknowledges that the described property could be needed for a proposed or planned public improvement and the City may revoke this permit. Upon written notice of revocation, the permittee shall, within the time prescribed by the City, remove all improvements placed, constructed or maintained. If the permittee fails to abide by the removal order of the City, the City shall have the right to remove and destroy the improvements without reimbursement to the permittee. The cost of such removal shall be paid by the permittee to the City and shall constitute a debt owed to the City.
- 3: Permittee waives the right of claim, loss, damage or action against the City resulting from revocation, termination, removal of improvements or any action of the City, its officers, agents or employees taken in accordance with the terms herein.
- 4: If the Public Works Director of the City of Riverside finds that the permittee is in default of the terms of this permit, that shall be cause for revocation.
- 5: Permittee herewith agrees to hold the City of Riverside harmless from and against all claims demands, costs, losses, damages, injuries, actions for damages and/or injuries, and liability in connection with the construction, encroachment, and/or maintenance to be done by permittee within the described property.
- 6: Prior to any construction taking place on City controlled property, permittee shall obtain a Construction Permit or Street Opening Permit from the City Public Works Department.
- 7: The permittee agrees to insure that construction of their improvements will not interfere in any way with any existing City or utility facilities.
- 8: Permittee acknowledges that existing city or utility facilities will require future maintenance, reconstruction, and revisions and that facilities may be added, any of which may result in removal or alteration of the permittee's improvements without reimbursement to the permittee.
- 9: Prior to construction, permittee shall contact Underground Service Alert to field locate existing utility lines. Any conflicts discovered will void the permit until acceptable revisions are made. It shall be Permittee's responsibility to determine the location and required clearances from all public and private utility, sewer and drainage facilities prior to drilling and shall only drill in compliance with such clearance requirements.
- 10: All on-site catch basins and inlets must have a properly installed and maintained drainage water filtration system to Public Works Specifications.
- 11: Permittee acknowledges that there are existing public works and public utility facilities that may interfere with the proposed improvement. All existing utilities, sewers and storm drains must be field located (pot-holed) prior to installation of the proposed facilities.
- 12: Permittee acknowledges that all maintenance of the drain line between its connection with the line in the street and the right of way line is the responsibility of the permittee.

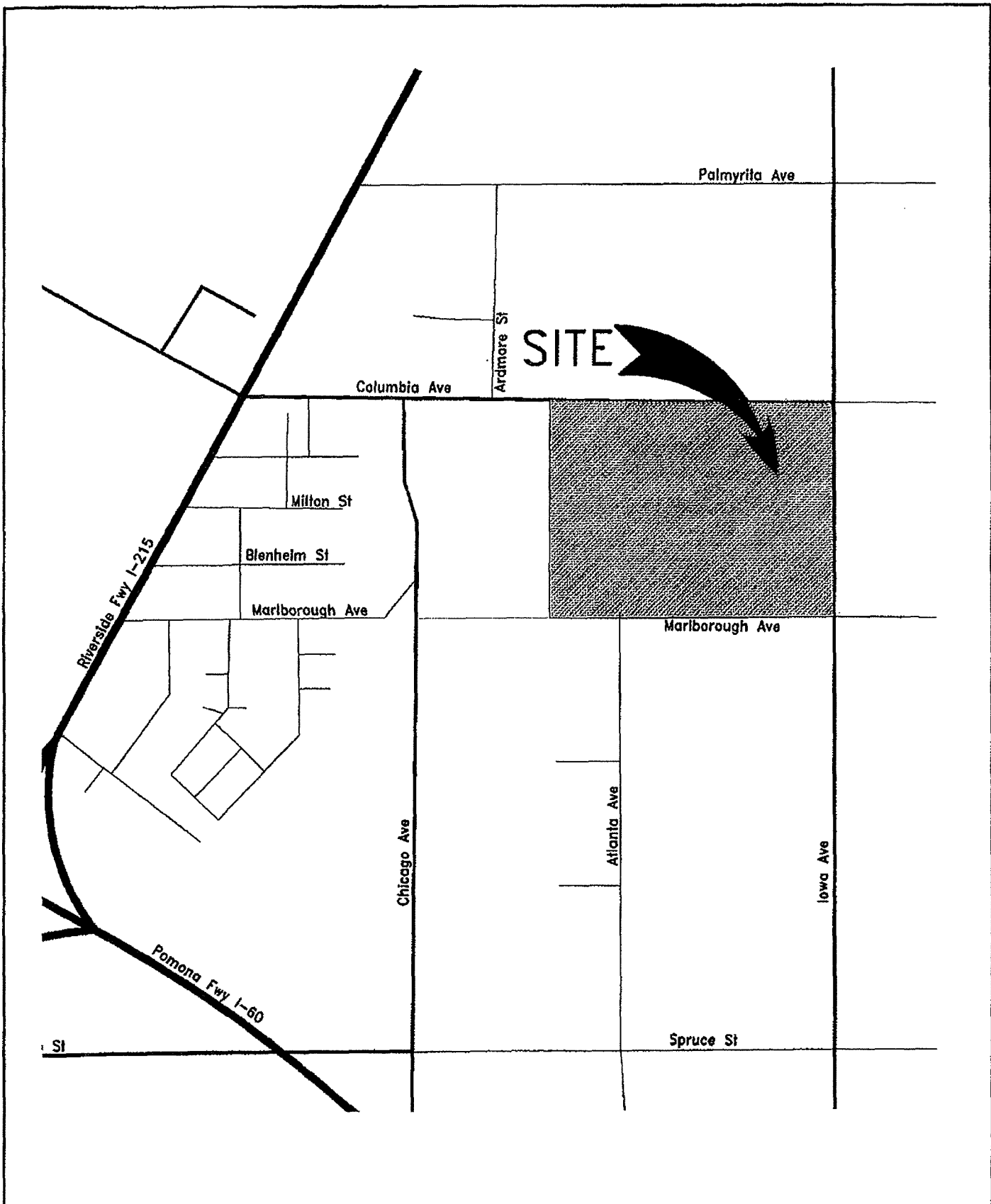

**DAVID EVANS
AND ASSOCIATES INC.**
4200 Concoors Dr., Suite 200
Ontario California 91764
Phone: 909.481.5750
Fax: 909.481.5757



SCALE = 1"=20'
DRAW: WXH
REVIEW: GNR
AUG 2010

VICINITY MAP
STORM DRAIN CONNECTION
1410 IOWA AVENUE
RIVERSIDE, CA 92507

COLUMBIA AVE

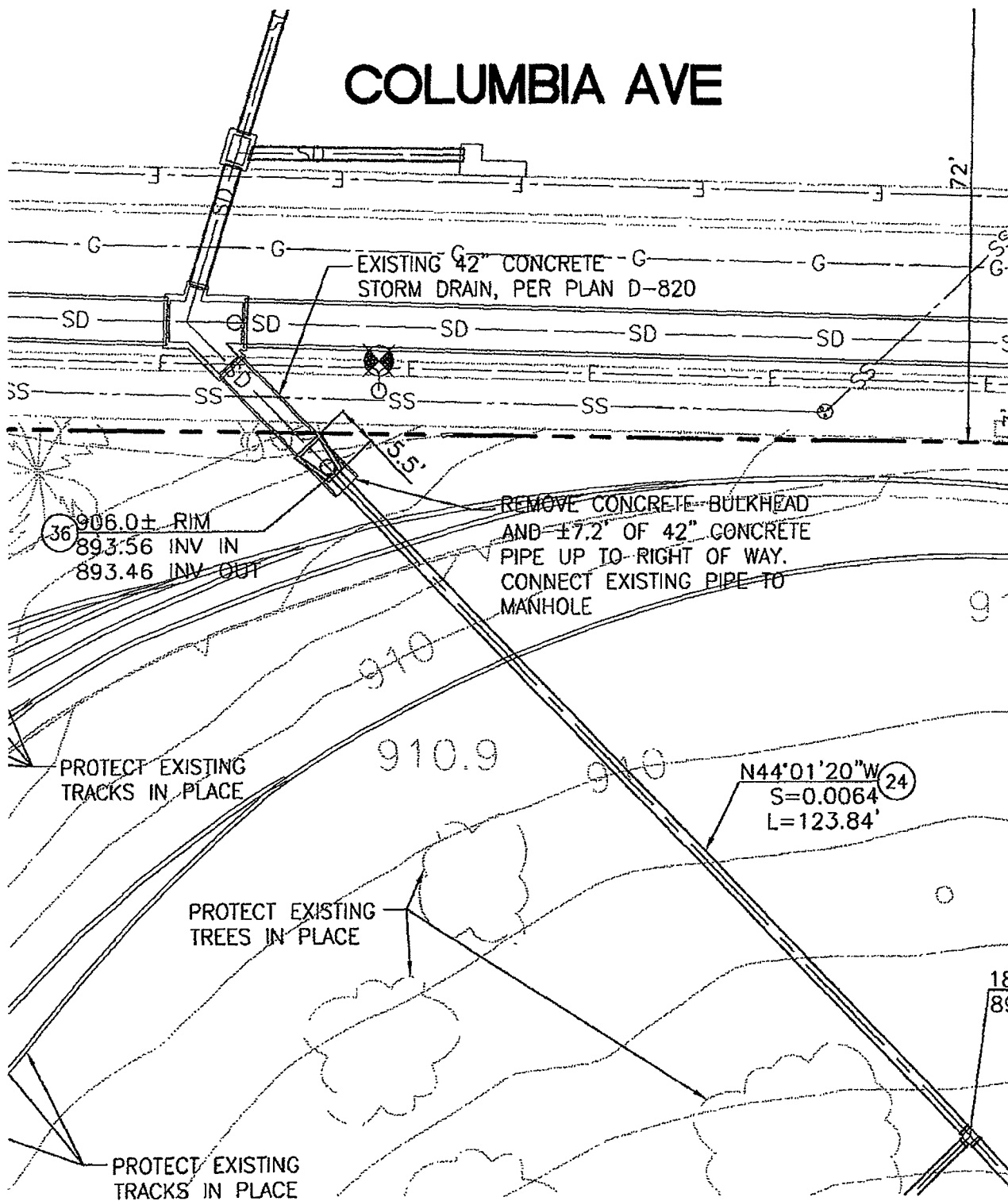

- (24) INSTALL 18" HDPE PIPE
- (36) CONSTRUCT MANHOLE EZ PER CITY OF RIVERSIDE STD. DWG. NO. 431



**DAVID EVANS
AND ASSOCIATES INC.**
4200 Concours Dr., Suite 200
Ontario California 91764
Phone: 909.481.5750
Fax: 909.481.5757



SCALE = 1"=20'

DRAW: WXH

REVIEW: GNR

AUG 2010

FIGURE 1

STORM DRAIN CONNECTION
1410 IOWA AVENUE
RIVERSIDE, CA 92507

E10-0364

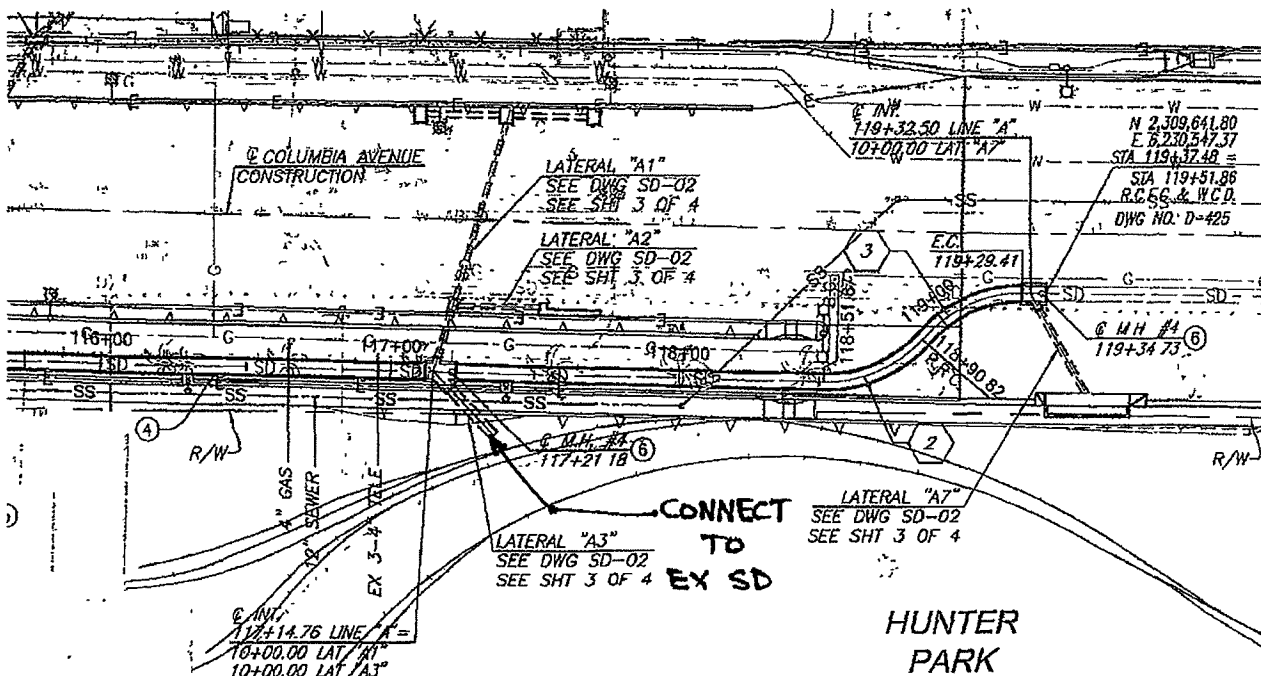

CURVE DATA

D	L	T	BC	EC	N (PI)	E (PI)
56°47'58"	44.61'	24.33'	109+97.74	110+42.35	2,309,647.56	6,229,637.63
49°51'21"	39.16'	20.92'	118+51.67	118+90.82	2,309,611.33	6,230,491.09
49°07'25"	38.58'	20.57'	118+90.82	119+29.41	2,309,642.26	6,230,518.74

PROJECT NO	D-820
	SD-01
SHIFT OF	
PROJECT NO'S	1-0-122
DRAWING NO	1-364
SHIFT NO	62
	2A of 4

FLOOD CONTROL	<p align="center">CITY OF RIVERSIDE COLUMBIA AVENUE OVERPASS AT BNSF RAILROAD PLAN AND PROFILE THORNTON STORM DRAIN RELOCATION STA 109+17.75 TO STA 119+37.48</p>	PROJECT NO'S	1-0-122
DISTRICT		DRAWING NO	1-364
BY APPROVED BY		SHIFT NO	62
DATE	7-22-2008		2A of 4

Partial Plan Set Related to Hunter Park 1-15-09



DAVID EVANS AND ASSOCIATES INC.
 4200 Concoors Dr., Suite 200
 Ontario California 91764
 Phone: 909.481.5750
 Fax 909.481.5757



SCALE = 1"=20'
 DRAW: WXH
 REVIEW: GNR
 AUG 2010

FIGURE 1A - PLAN
 STORM DRAIN CONNECTION
 1410 IOWA AVENUE
 RIVERSIDE, CA 92507

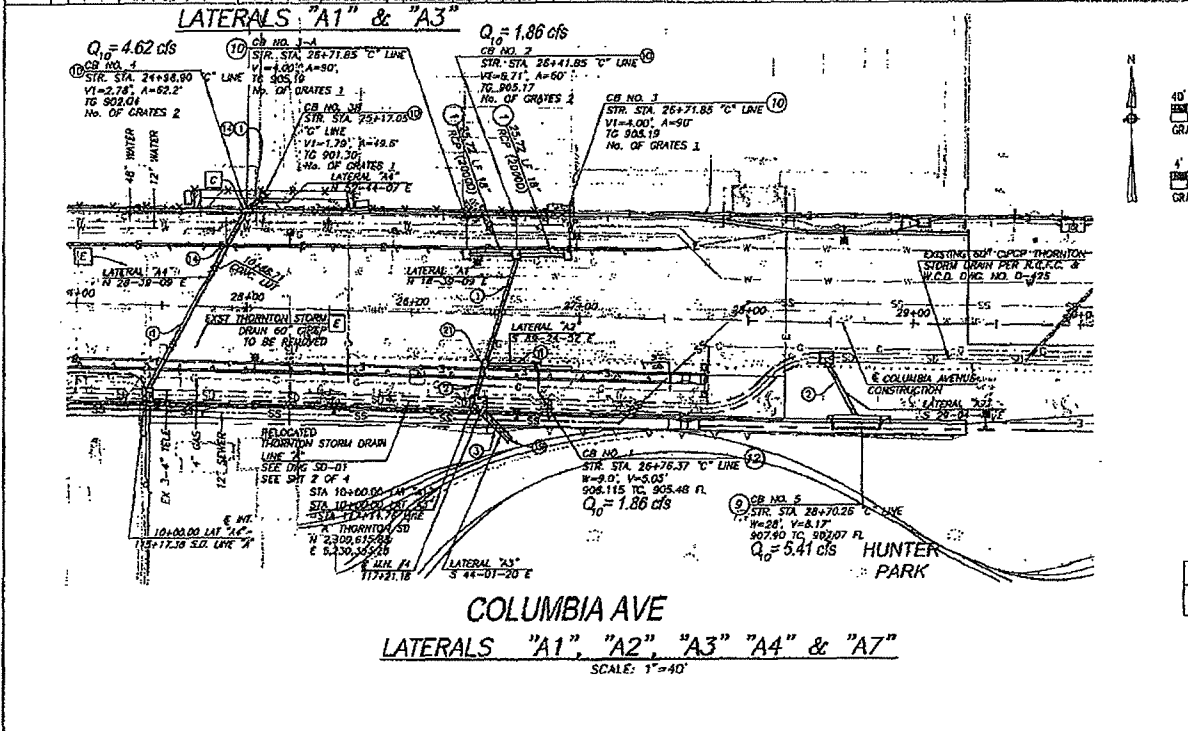
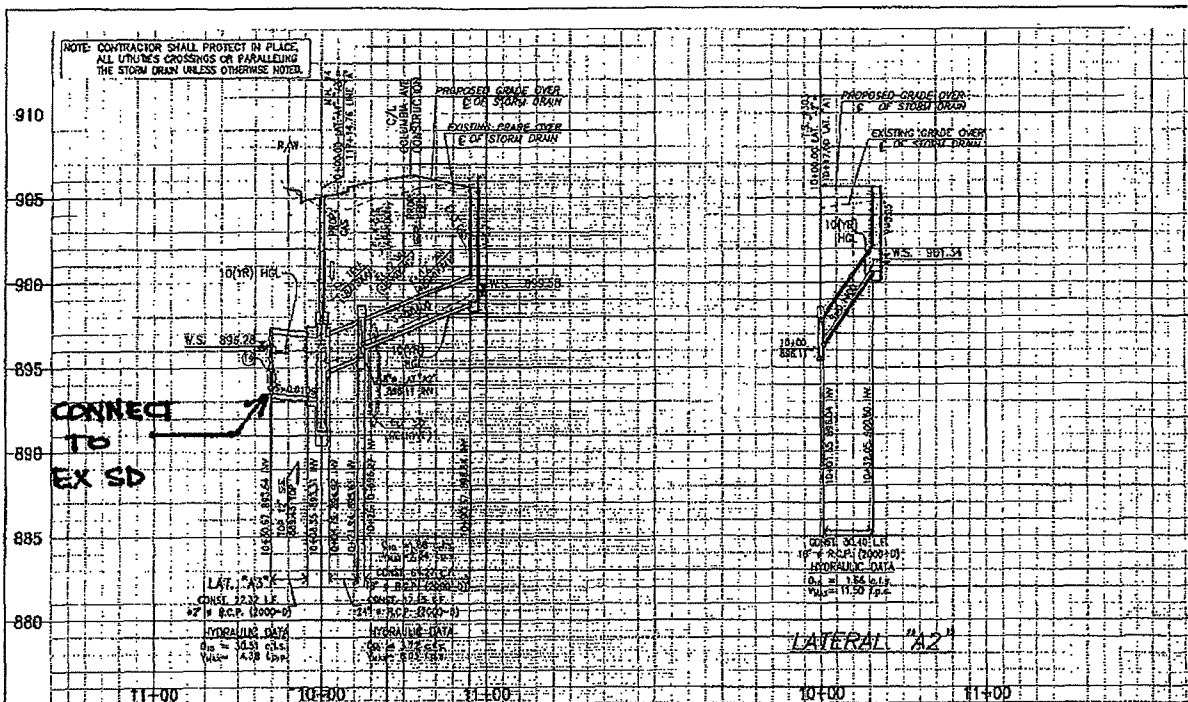

Elevation shown on this drawing is based on the datum of 100 feet above mean sea level. All elevations are in feet unless otherwise noted.

Don't Dig-USA! You Call U.S.A. Toll Free	BENCHMARK	REVISIONS	ENGINEER	PROJECT	CITY OF RIVERSIDE
--	-----------	-----------	----------	---------	-------------------



DAVID EVANS AND ASSOCIATES INC.
 4200 Concourse Dr., Suite 200
 Ontario California 91764
 Phone: 909.481.5750
 Fax: 909.481.5757



SCALE = 1"=20'
 DRAW: WXH
 REVIEW: GNR
 AUG 2010

FIGURE 1B - PROFILE
 STORM DRAIN CONNECTION
 1410 IOWA AVENUE
 RIVERSIDE, CA 92507

E10-0364