

ENCROACHMENT PERMIT

Pursuant to Resolution No. 11065 of the City of Riverside, permission is hereby granted to USA/FAIRFIELD REALTY FUND LTD.
3179 Temple Avenue, Suite 170
Pomona, CA 91768-3241

its heirs and assigns, hereinafter referred to as "Permittee" to use and occupy the following described property.

A portion of the southeasterly 5' of Lots 11 and 12 together with a portion of the northwesterly 10' of Lots 13 and 14, Block 7 of the Lands of the Riverside Land and Irrigation Company as shown by map on file in Book 1 of Maps at Page 70 thereof, records of San Bernardino County, California, as shown on the attached Exhibit "A",

in accordance with the terms hereof.

1. Permittee shall use and occupy the described property only in the manner and for the purposes as follows: Construction and maintenance of two 18" R.C.P. which shall drain a private drainage system into the public storm drain system (the Arlington-Monroe Storm Drain Channel) as shown on the attached Exhibit "A".

1A. Permittee herewith agrees to hold the City of Riverside harmless from and against all claims, demands, costs, losses, damages, injuries, action for damages and/or injuries, and liability growing or arising out of or resulting from any flooding upon and/or across Permittee's property.

2. Permittee, by acceptance of the benefits hereunder, acknowledges title to the property to be in the City of Riverside and waives any right to contest the validity of the dedication or grant.

3. Permittee acknowledges that the described property is the site of a proposed or planned public improvement and that, accordingly, all rights and privileges of use permitted shall cease and expire upon notice of revocation by the City. Upon the expiration or revocation, Permittee shall, within the time prescribed by the City, remove all improvements or obstructions placed, constructed or maintained by the Permittee. If the Permittee fails to abide by the removal order of the City within the time prescribed, the City shall have the right to remove and destroy the improvements without reimbursement to the Permittee and the cost of such removal shall be paid by the Permittee to the City of Riverside and shall constitute a debt owed to the City of Riverside.

4. Permittee, by acceptance hereof, waives the right of claim, loss, damage or action against the City of Riverside arising out of or resulting from revocation, termination, removal of the improvements or any action of the City of Riverside, its officers, agents or employees taken in accordance with the terms hereof.

5. Finding and determination by the City Council of the City of Riverside that the Permittee, or his heirs and assigns or successors in interest, are in default of the terms hereunder shall be cause for revocation.

6. Permittee herewith agrees to hold the City of Riverside harmless from and against all claims, demands, costs, losses, damages, injuries, action for damages and/or injuries, and liability growing or arising out of or in connection with the construction, encroachment, and/or maintenance to be done by Permittee or his agents, employees or contractors within the described property.

DATED: December 14, 1989 CITY OF RIVERSIDE, a municipal corporation

By [Signature] Mayor

Attest ALICE A. HARE City Clerk

The foregoing is accepted by:

By Karen E. Lindquist
Assistant City Clerk

USA/Fairfield Realty Fund, Ltd.
(Signature(s) of Permittee)

BY USA Properties Fund, Inc., G.P.
TITLE

BY [Signature], Its Vice President
Steven Gall 12-4-89 TITLE

APPROVED AS TO CONTENT

[Signature]
Department Head

APPROVED AS TO FORM

[Signature]
City Attorney

CITY MANAGER APPROVAL

[Signature]
City Manager

CALIFORNIA

AVENUE

MONROE

STREET

PERMIT
AREA "A"

13

R.L. & L. CO.
M.B. 1/70 SB

BLOCK 7

PERMIT
AREA "B"

R/W LINE

R/W LINE

14

SCALE 1"=100'

ENCROACHMENT PERMIT

EXHIBIT "A"
SHEET 1 OF 4

E-1137

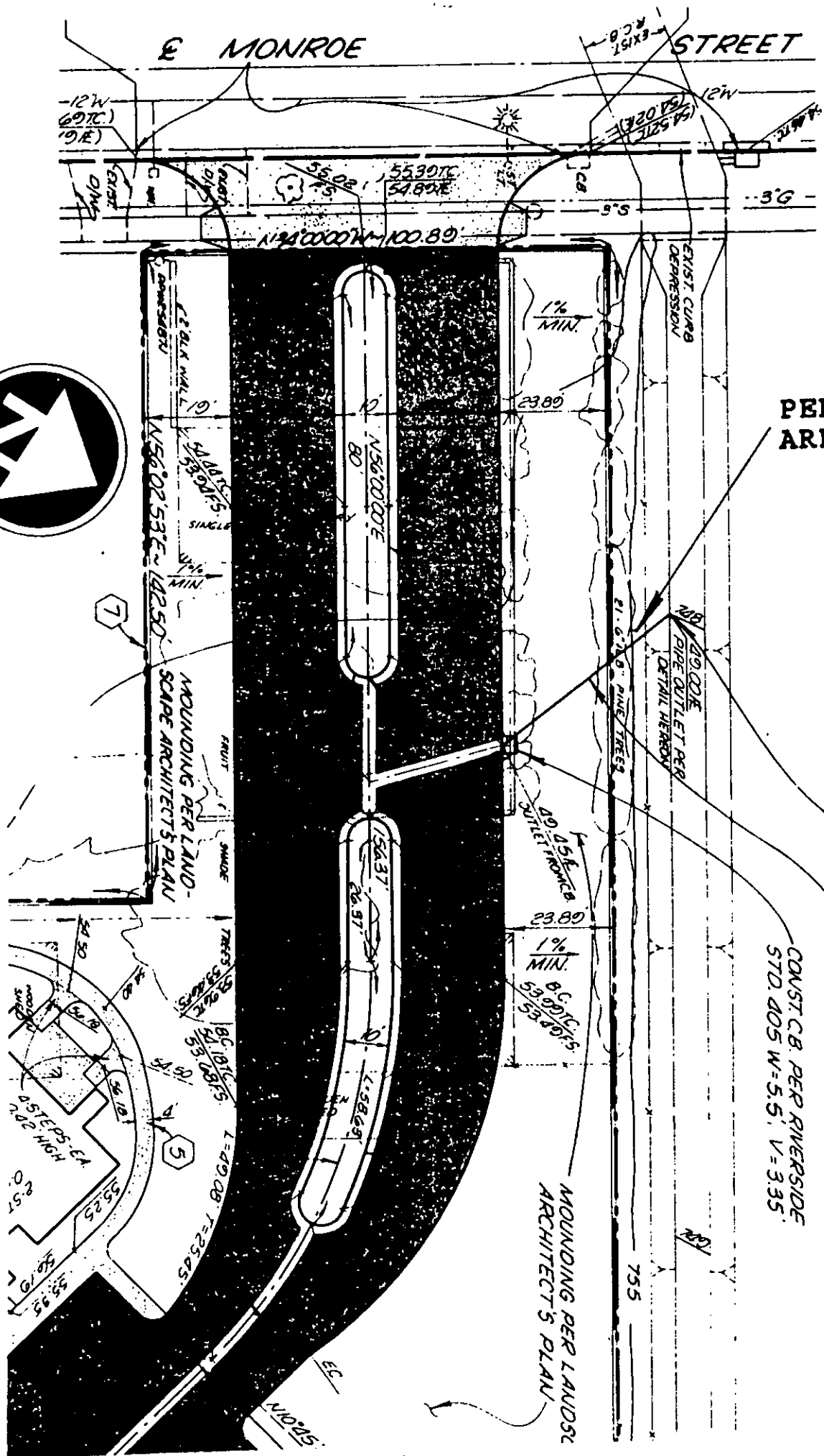

PERMIT AREA "A"

INSTALL 18" RCP @ 1% MIN.
 CONST. C.B. PER RIVERSIDE
 STD. DOS W=5.5' V=3.35'

CONST. PIPE CONNECTION TO CHANNEL
 PER DETAIL HEREON. A=515' B=10'

SCALE: 1" = 30'

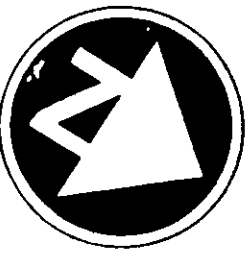

ENCROACHMENT PERMIT

EXHIBIT "A"
 SHEET 2 OF 4

E-1137

CONST. PIPE CONNECTION TO CHANNEL PER DETAIL HEREON
A = 45° B = 2.0'

CONST. TRANSITION FROM BOX TO PIPE PER DETAIL HEREON
INSTALL 18" RCP PER (P)

INSTALL 2 EA RECTANGULAR PIPES - 15 1/8" x 9 1/2"
(MANUFACTURED BY INDOASCO) PLACE D=4'-10 1/2"
WIRE FABRIC IN SLEEVES ABOVE THE PIPE

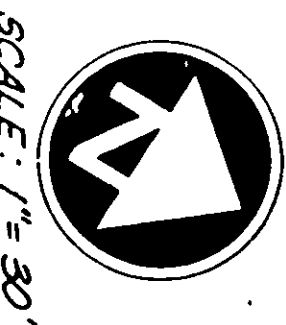
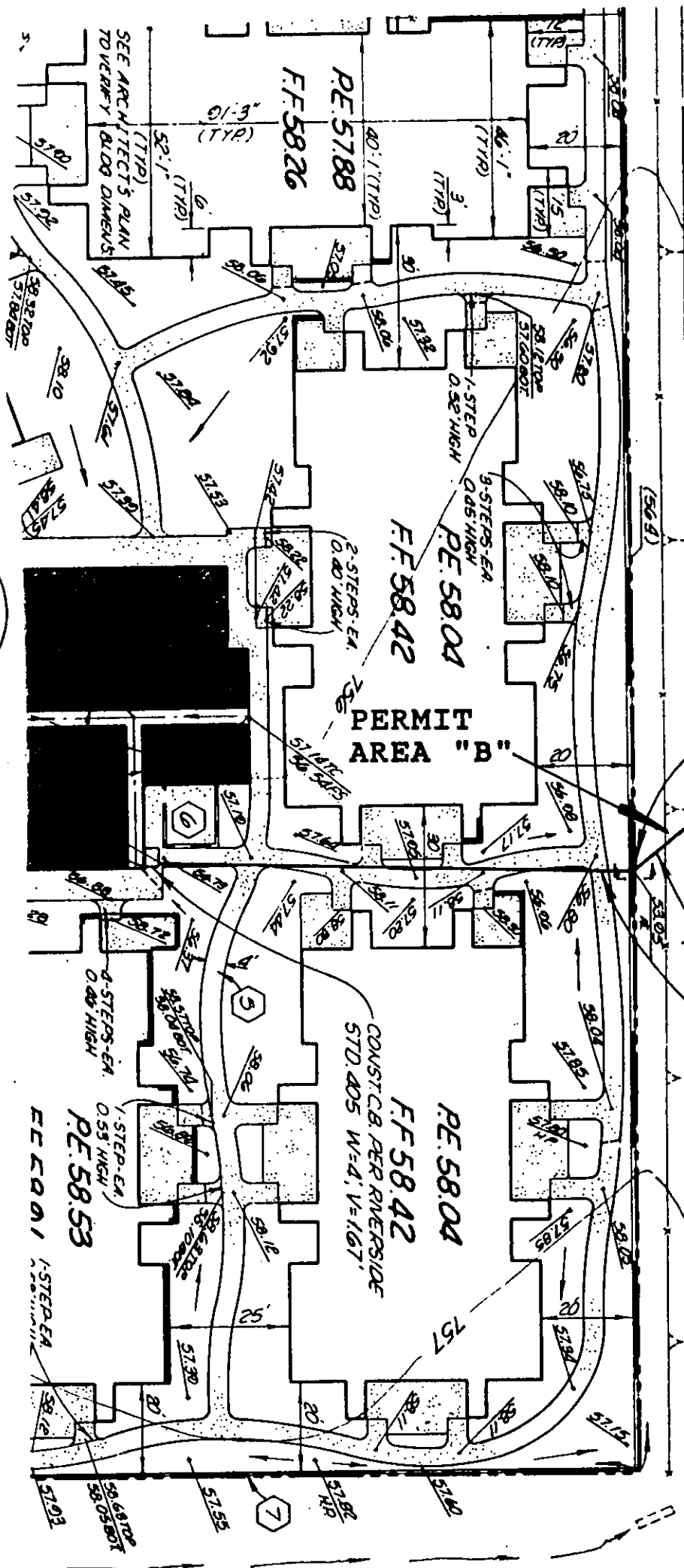

SCALE: 1" = 30'

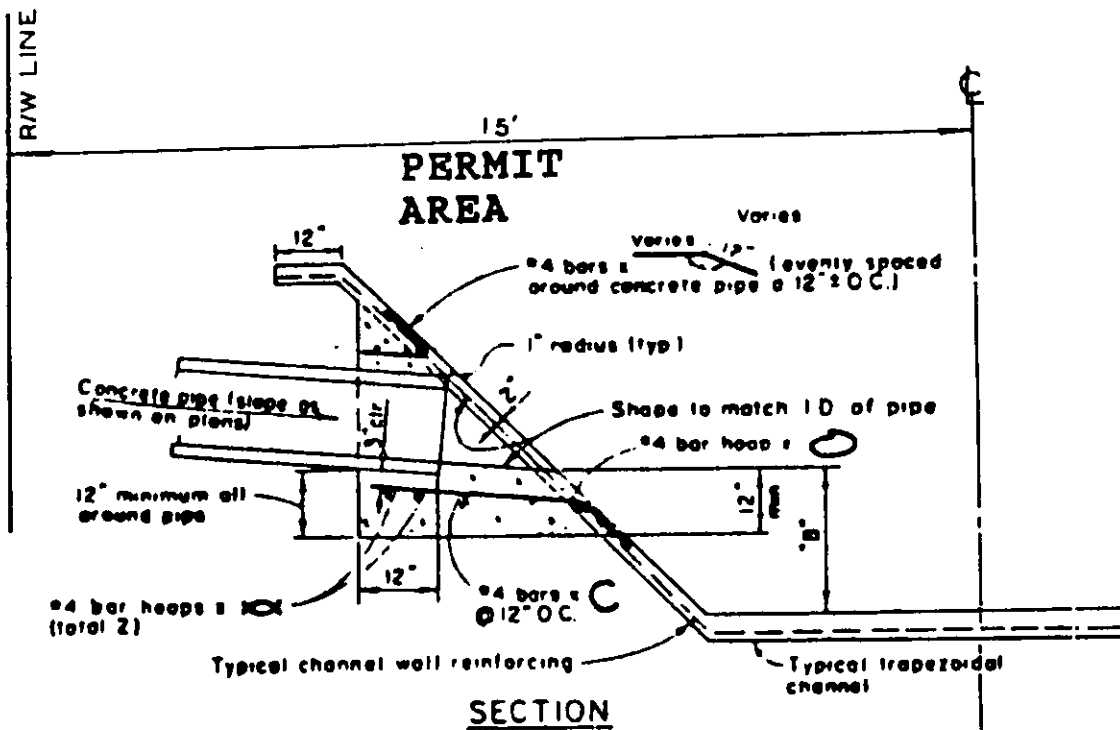

NOTE Diameter of concrete pipe, angle "A" and dimension "B" to be as shown on the plans

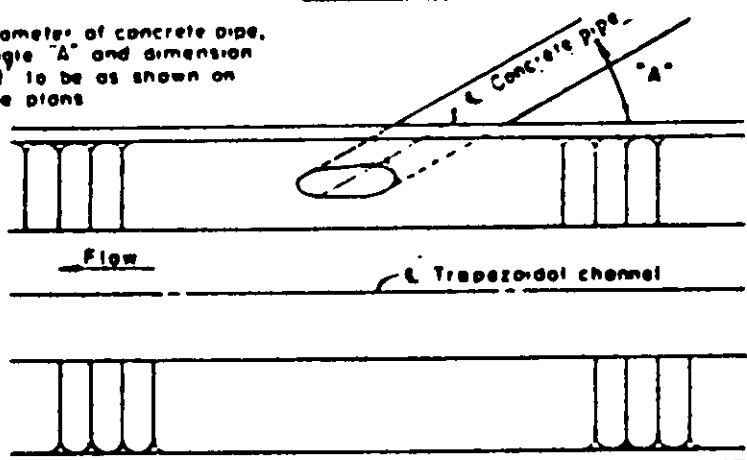

PLAN
CONCRETE PIPE
CONNECTION DETAIL
ABM OR CONCRETE
LINED TRAPEZOIDAL CHANNEL
 NO SCALE