

APPLICATION FOR ENCROACHMENT PERMIT
(to be completed by applicant)

SAM HALLER, the XOwner Lessee of the property located at 8205 INDIANA AVENUE in the City of Riverside, Assessors Parcel No. 231-134-018 hereby requests permission to INSTALL AND MAINTAIN OUTDOOR LIGHTING AND CONDUIT

in the public right of way of INDIANA AVENUE /or the _____ easement at the rear/ side/ front of said property. The attached drawing shows the requested encroachment. Upon issuance of this permit, I agree to comply with the attached terms and conditions.

Date 9-10-92 x [Signature]

.....
ENCROACHMENT PERMIT APPROVAL
(to be completed by City)

This permit shall become effective upon the approval of the Departments listed below. Issuance of this permit shall not be construed as a waiver of any other applicable permit or requirement, but is only revocable permission to use the land for the purpose described.

- Public Utilities Water Brian Simpson 10/16/02
- Public Utilities Electric William F. Mairand
- N/A Planning _____
- Parks and Recreation [Signature]
- _____ (other) _____
- _____ (other) _____

Upon obtaining the above signatures, return this permit to the Public Works Department for final approval.

Date 10/20/92 [Signature]
Public Works Director

Encroachment Permit No. E-1222

TERMS AND CONDITIONS

The following indicated terms and conditions apply to encroachment permit no. E-1222.

1. Permittee acknowledges that the area of encroachment is owned or controlled by the City of Riverside.
2. Permittee acknowledges that the described property could be needed for a proposed or planned public improvement and the City may revoke this permit. Upon written notice of revocation, the permittee shall, within the time prescribed by the City, remove all improvements placed, constructed or maintained. If the permittee fails to abide by the removal order of the City, the City shall have the right to remove and destroy the improvements without reimbursement to the permittee. The cost of such removal shall be paid by the permittee to the City and shall constitute a debt owed to the City.
3. Permittee waives the right of claim, loss, damage or action against the City resulting from revocation, termination, removal of improvements or any action of the City, its officers, agents or employees taken in accordance with the terms herein.
4. If the City Council of the City of Riverside finds that the permittee is in default of the terms of this permit, that shall be cause for revocation.
5. Permittee herewith agrees to hold the City of Riverside harmless from and against all claims demands, costs, losses, damages, injuries, actions for damages and/or injuries, and liability in connection with the construction, encroachment, and/or maintenance to be done by permittee within the described property.
6. Prior to any construction taking place on City controlled property, permittee shall obtain a Construction Permit or Street Opening Permit from the City Public Works Department.
7. The permittee agrees to insure that construction of their improvements will not interfere in any way with existing City or utility facilities. The existing facilities will require future maintenance, reconstruction and revisions and facilities may be added, any of which may result in removal or alteration of the permittee's improvements without

reimbursement to the permittee. Prior to construction, Permittee shall contact Underground Service Alert to field locate existing utility lines. Any conflicts discovered will void the permit until acceptable revisions are made.

8. other Permittee shall hold the City harmless from any damage to the lighting during routine maintenance of the street trees.

ADAMS

3500



S1 Fwy

CB 5/28-2

POR

Relinquished State Hwy 28 DIANA AVE. D3367
Map Book 2 Page 141

INDIANA AVENUE

3400

D 4016
D 4444

3507 12 3495 11 100 3501 3502 3503 3504 3505 3506 3507 3508 3509 3510 3511 3512 3513 3514 3515 3516 3517 3518 3519 3520 3521 3522 3523 3524 3525 3526 3527 3528 3529 3530 3531 3532 3533 3534 3535 3536 3537 3538 3539 3540 3541 3542 3543 3544 3545 3546 3547 3548 3549 3550 3551 3552 3553 3554 3555 3556 3557 3558 3559 3560 3561 3562 3563 3564 3565 3566 3567 3568 3569 3570 3571 3572 3573 3574 3575 3576 3577 3578 3579 3580 3581 3582 3583 3584 3585 3586 3587 3588 3589 3590 3591 3592 3593 3594 3595 3596 3597 3598 3599 3600

CROWELL STREET

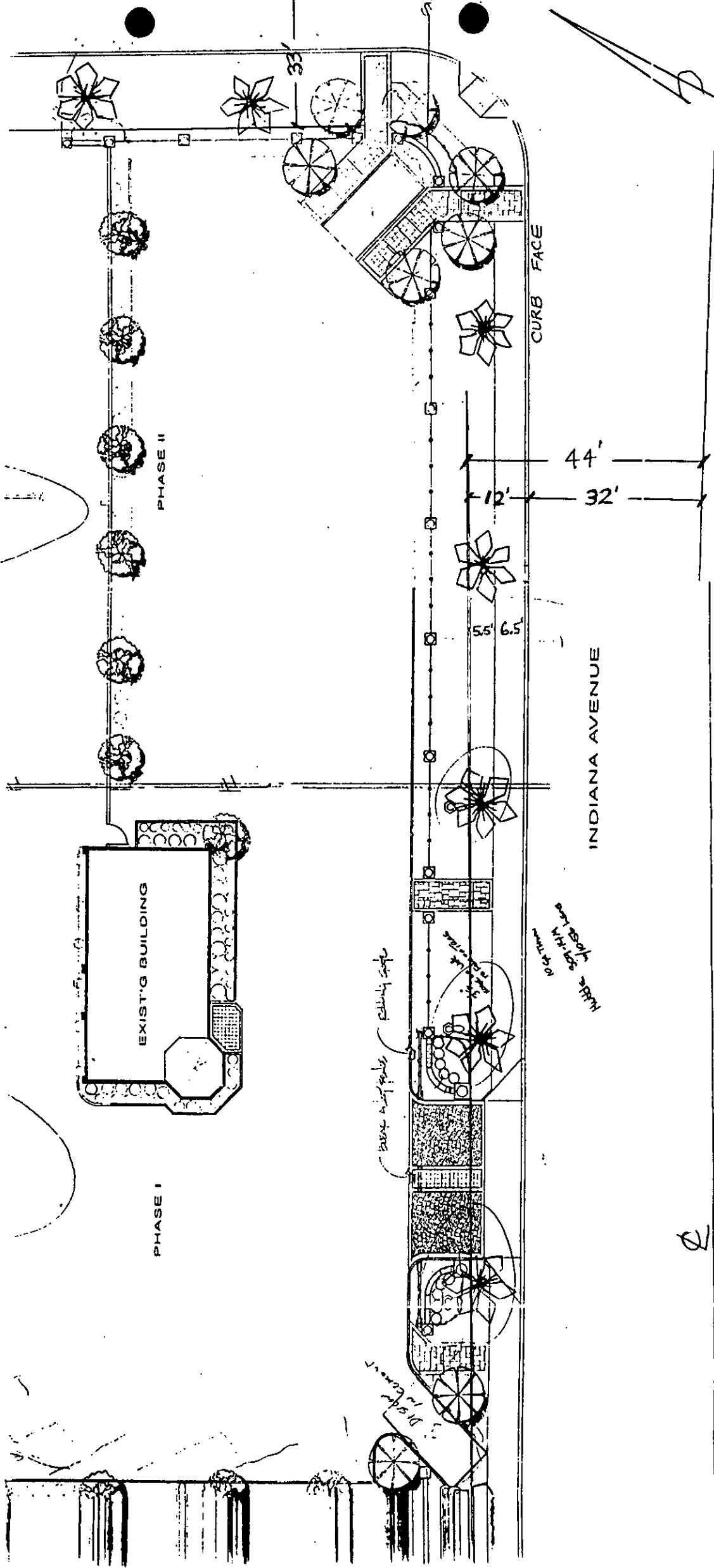

INDIANA AVENUE

CURB FACE

PHASE II

PHASE I

EXIST'G BUILDING

EXIST'G BUILDING

WALKWAY 5'0" WIDE WITH 6" CURB

DRAFT



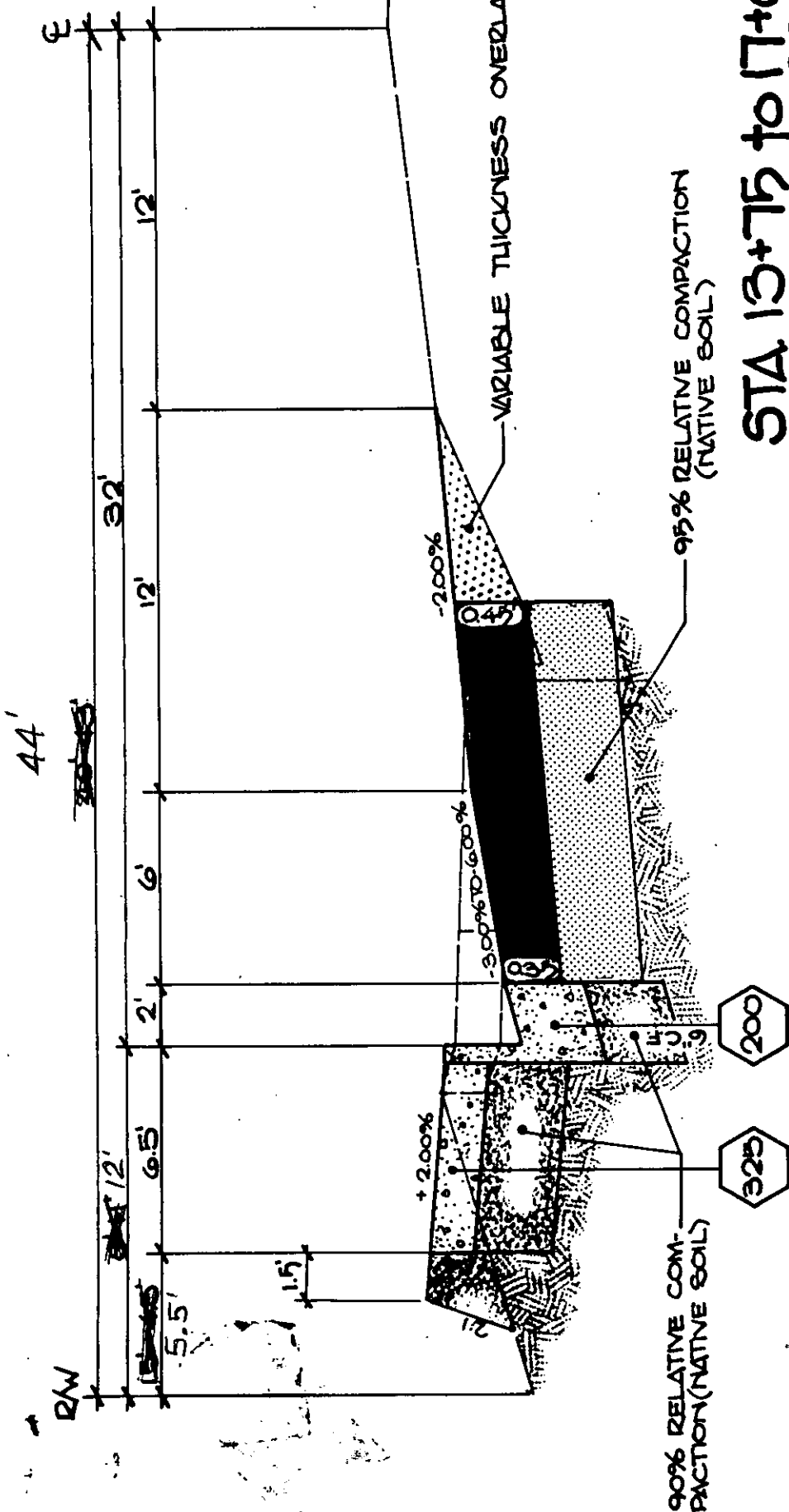

STA. 13+75 to 17+00
 STA. 17+00 to 23+60 (no
 STA. 23+60 to 29+85
 STA. 29+85 to 36+70 (no

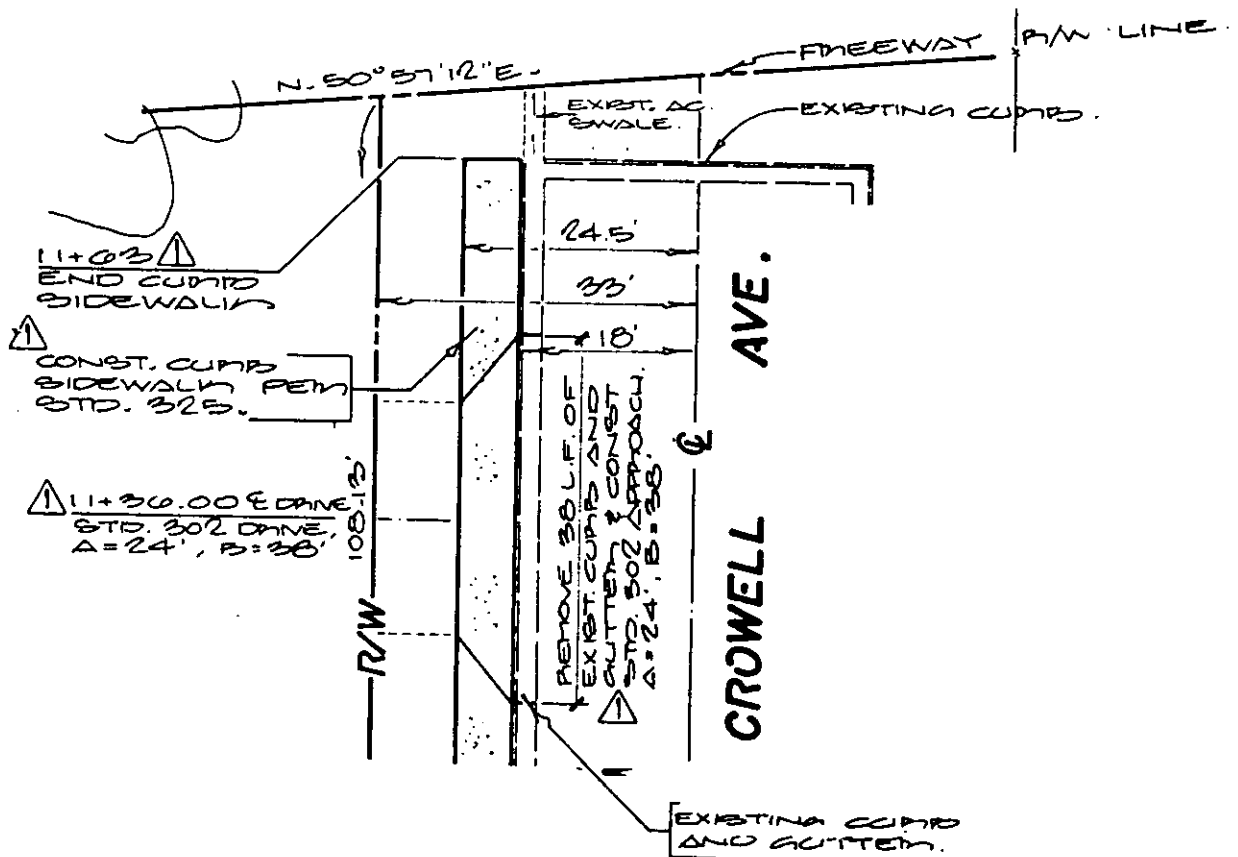
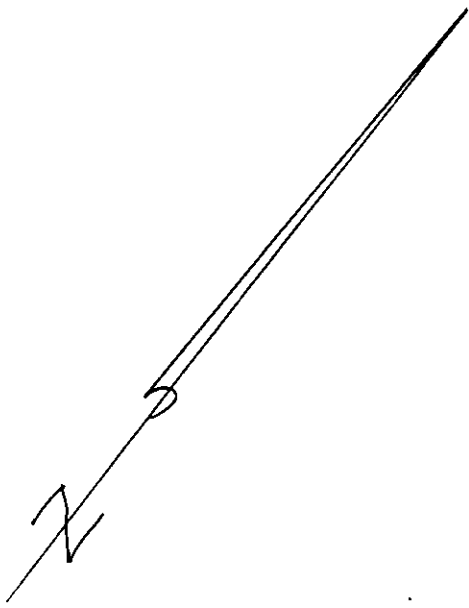

R-1924
SHT. 4