

ENCROACHMENT PERMIT

(to be completed by applicant)

SANTA ANA WATERSHED PROJECT AUTHORITY, the X Owner Lessee of the property located at 11600 STERLING in the city of Riverside, Assessors Parcel No. 132-020-042 & 043 hereby requests permission to CONSTRUCT, OPERATE & MAINTAIN A PRIVATE 14" WATERLINE

in the public right of way of MAGNOLIA AVE & FILMORE ST. /or the _____ easement at the rear/ side/ front of said property. The attached drawing shows the requested encroachment. Upon issuance of this permit, I agree to comply with the attached terms and conditions.

Date 3/25/96 X [Signature]

.....
ENCROACHMENT PERMIT APPROVAL

(to be completed by City)

G-
79-5

This permit shall become effective upon the approval of the Departments listed below. Issuance of this permit shall not be construed as a waiver of any other applicable permit or requirement, but is only revocable permission to use the land for the purpose described.

- X Public Utilities Water [Signature] 3/18/96
- X Public Utilities Electric [Signature] 3/18/96
- _____ Planning _____
- X Parks and Recreation [Signature] 3/20/96
- X (other) TRAFFIC ENGR [Signature] 3/27/96
- _____ (other) _____

Upon obtaining the above signatures, return this permit to the Public Works Department for final approval.

Date 3/28/96 ^{WMA} [Signature]
Public Works Director

Encroachment Permit No. E-1339

TERMS AND CONDITIONS

The following indicated terms and conditions apply to encroachment permit no. E-1339.

1. Permittee acknowledges that the area of encroachment is owned or controlled by the City of Riverside.
2. Permittee acknowledges that the described property could be needed for a proposed or planned public improvement and the City may revoke this permit. Upon written notice of revocation, the permittee shall, within the time prescribed by the City, remove all improvements placed, constructed or maintained. If the permittee fails to abide by the removal order of the City, the City shall have the right to remove and destroy the improvements without reimbursement to the permittee. The cost of such removal shall be paid by the permittee to the City and shall constitute a debt owed to the City.
3. Permittee waives the right of claim, loss, damage or action against the City resulting from revocation, termination, removal of improvements or any action of the City, its officers, agents or employees taken in accordance with the terms herein.
4. If the City Council of the City of Riverside finds that the permittee is in default of the terms of this permit, that shall be cause for revocation.
5. Permittee herewith agrees to hold the City of Riverside harmless from and against all claims demands, costs, losses, damages, injuries, actions for damages and/or injuries, and liability in connection with the construction, encroachment, and/or maintenance to be done by permittee within the described property.
6. Prior to any construction taking place on City controlled property, permittee shall obtain a Construction Permit or Street Opening Permit from the City Public Works Department.
7. The permittee agrees to insure that construction of their improvements will not interfere in any way with existing City or utility facilities. The existing facilities will require future maintenance, reconstruction and revisions and facilities may be added, any of which may result in removal or alteration of the permittee's improvements without

reimbursement to the permittee. Prior to construction, Permittee shall contact Underground Service Alert to field locate existing utility lines. Any conflicts discovered will void the permit until acceptable revisions are made.

8. Other _____

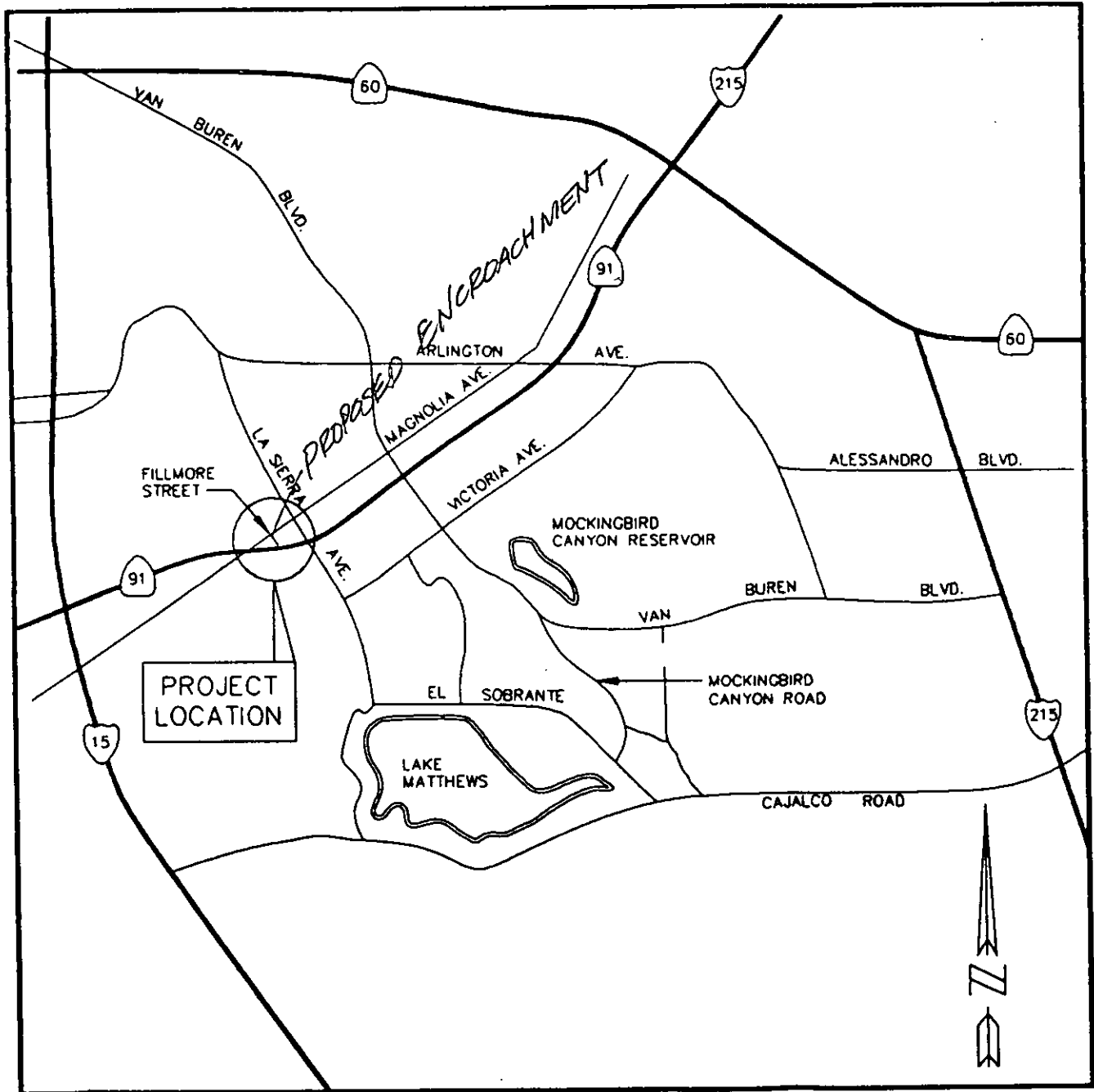

VICINITY MAP
N.T.S.

CLASS 150 WATERLINE

RESTRAINED JOINTS

RESTRAINED JOINTS

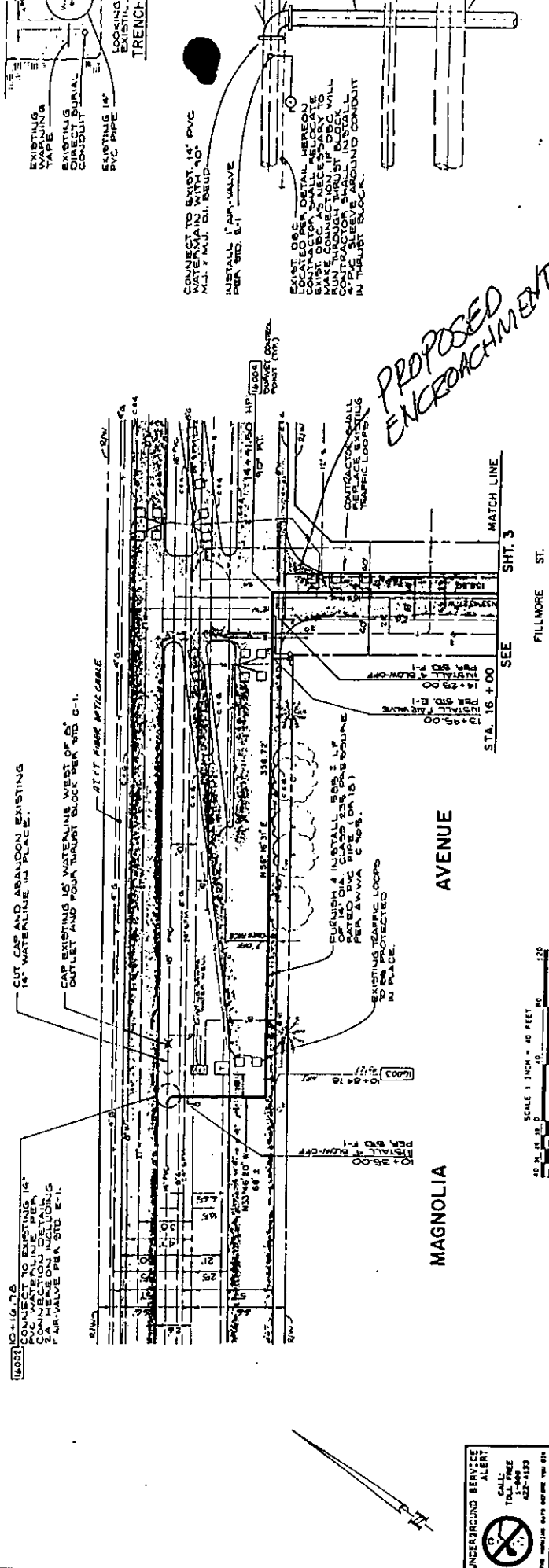
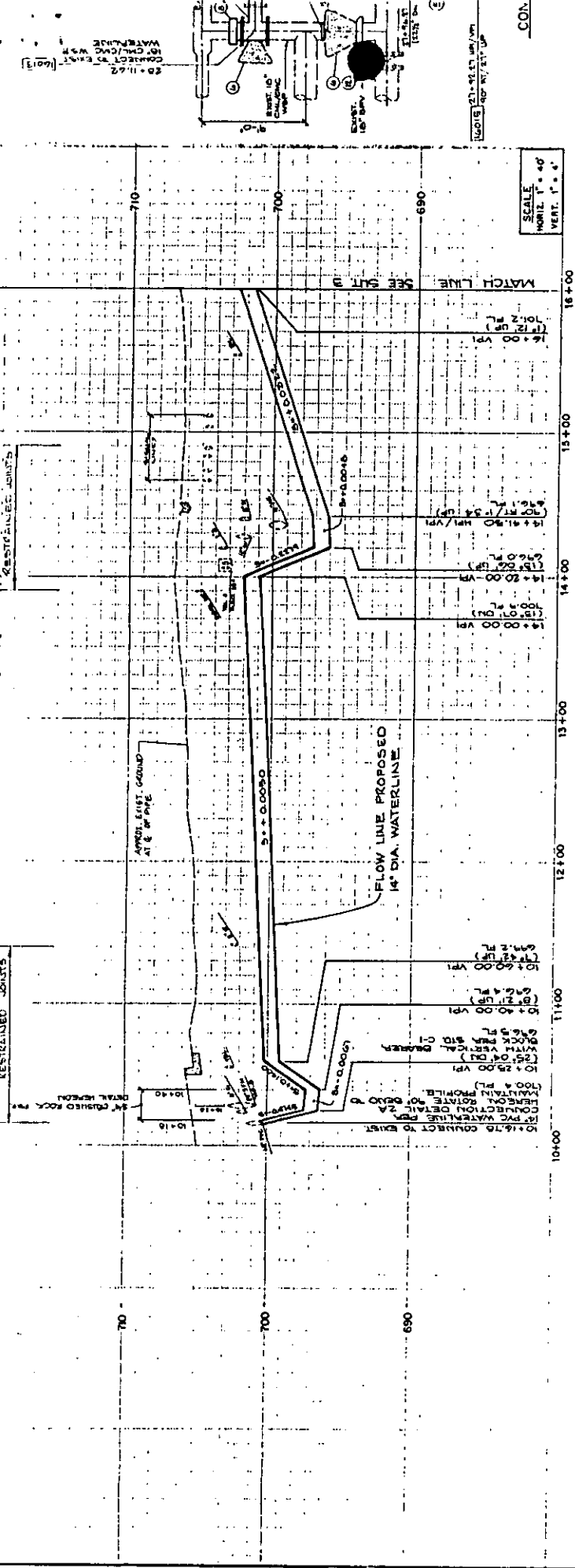

PROPOSED ENCROACHMENT

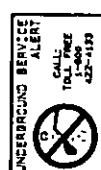

UNDERGROUND SERVICE ALERT
CALL TOLL FREE
1-800-4-A-SHIELD

SCALE 1 INCH = 40 FEET

FILLMORE ST.

SEE SHT. 3

STA. 16+00

CONNE

APPROVED BY DATE 3/10/94
 PREPARED BY DATE 2/10/94
 PROJECT NO. 16602
 SHEET NO. 17

ALBERT A. WEBB ASSOCIATES
 CIVIL ENGINEERS
 3788 MCCRAY ST. BERKELEY, CA 94706
 PH. (925) 848-1370

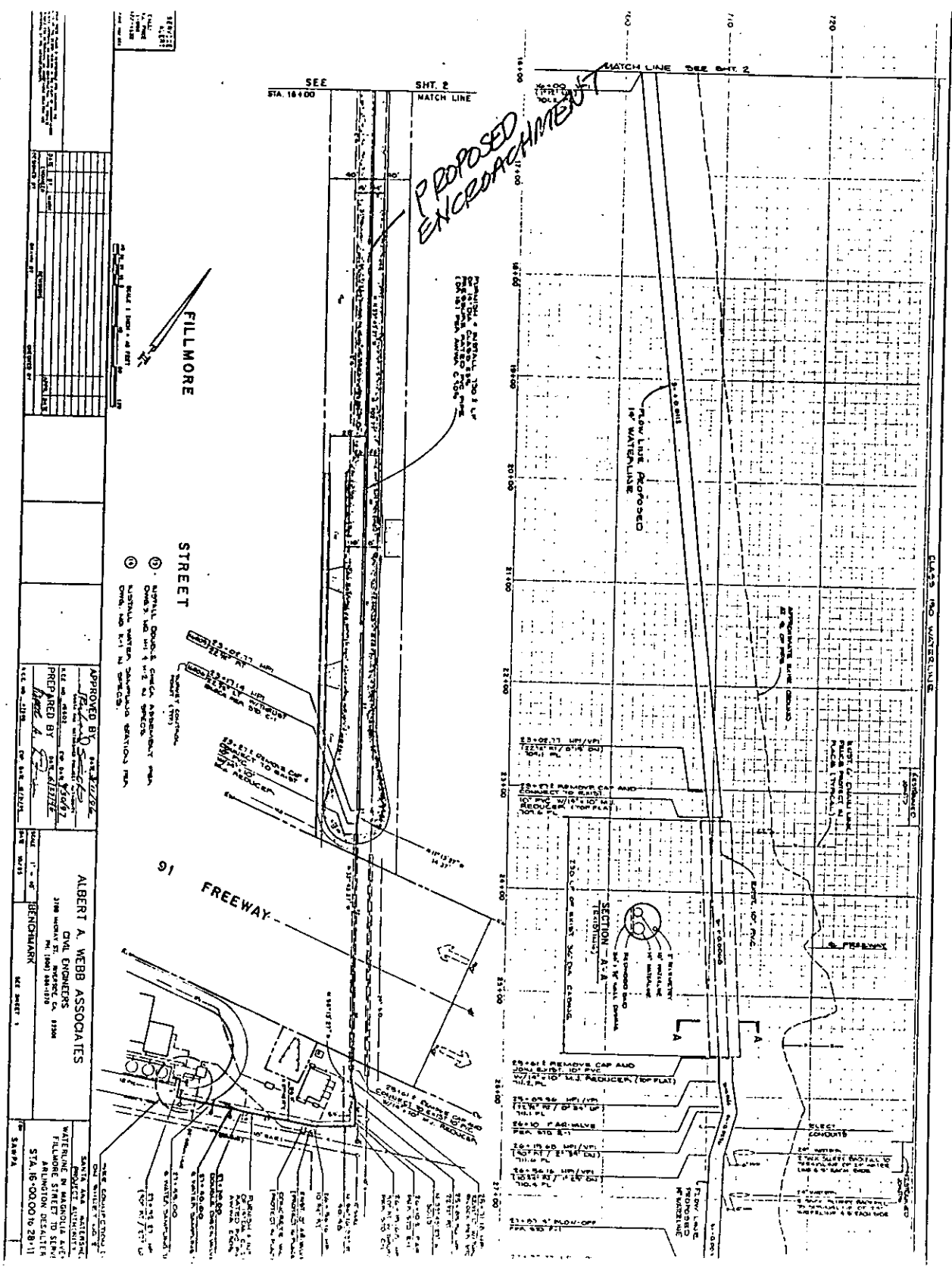

NO.	DESCRIPTION	DATE	BY
1	DESIGNED	10/15/71	ALBERT A. WEBB
2	CHECKED	10/15/71	ALBERT A. WEBB
3	APPROVED	10/15/71	ALBERT A. WEBB
4	REVISION		
5	REVISION		
6	REVISION		
7	REVISION		
8	REVISION		
9	REVISION		
10	REVISION		
11	REVISION		
12	REVISION		
13	REVISION		
14	REVISION		
15	REVISION		
16	REVISION		
17	REVISION		
18	REVISION		
19	REVISION		
20	REVISION		

- 1. APPROVAL OF THIS PLAN BY THE CITY ENGINEER IS A NECESSARY CONDITION FOR THE CONSTRUCTION OF THIS PROJECT.
- 2. ALL WORK SHALL BE IN ACCORDANCE WITH THE CITY SPECIFICATIONS AND THE STANDARD SPECIFICATIONS FOR WATER MAINS AND APPURTENANCES.
- 3. ALL MATERIALS SHALL BE OF THE BEST QUALITY AND SHALL BE SUBJECT TO INSPECTION AND TESTING BY THE CITY ENGINEER.
- 4. ALL WORK SHALL BE COMPLETED WITHIN THE SPECIFIED TIME FRAME.
- 5. ALL WORK SHALL BE DONE IN ACCORDANCE WITH THE CITY SCHEDULE OF WORK.

APPROVED BY: *Albert A. Webb*
 CIVIL ENGINEER
 ALBERT A. WEBB ASSOCIATES
 3100 WASHINGTON ST., SUITE 200
 ARLINGTON, TEXAS 76010
 PHONE: (817) 261-1111

ALBERT A. WEBB ASSOCIATES
 CIVIL ENGINEERS
 3100 WASHINGTON ST., SUITE 200
 ARLINGTON, TEXAS 76010
 PHONE: (817) 261-1111

DATE: 10/15/71
 DRAWN BY: *ALBERT A. WEBB*
 CHECKED BY: *ALBERT A. WEBB*
 APPROVED BY: *ALBERT A. WEBB*