

**ENCROACHMENT PERMIT  
NON-ASSIGNABLE**

The County of Riverside, a political subdivision of the State of California, the Lessee of the property located at 2724 Gateway Drive, in the City of Riverside, Assessors Parcel No. 291-450-065, hereby requests permission to construct and maintain a private fiber optic cable and conduit within the public right of way of Valley Springs Parkway and Gateway Drive as shown on **EXHIBIT A** attached hereto.

Upon issuance of this permit, I agree to comply with the attached terms and conditions.

Date November 29, 2001

BY: Judy Williams

Date \_\_\_\_\_

BY: \_\_\_\_\_

Applicants Address: Robert Perea, Data Network Engineer  
c/o COUNTY OF RIVERSIDE  
4080 Lemon Street, 10<sup>th</sup> Floor, P.O. Box 1589  
Riverside, CA. 92502-1589

Phone 955-3694

**ENCROACHMENT PERMIT APPROVAL**

This permit shall become effective upon the approval of the Departments listed below. Issuance of this permit shall not be construed as a waiver of any other applicable permit or requirement, and is only revocable permission to use the land for the purpose described.

Public Utilities Water - Brian Simpson N/A BS

Public Utilities Electric - Pat Hohl [Signature]

Parks and Recreation - Terry Nielsen [Signature] 12/13/01

Planning - Jeff Belier [Signature] 12/14/01

**APPLICANT: Upon obtaining the above signatures, return this permit to the Public Works Department for final approval.**

**FINAL APPROVAL**

Date 12/07/2001

[Signature]  
Tom Boyd, Interim Public Works Director

## TERMS AND CONDITIONS

1. Permittee acknowledges that the area of encroachment is owned or controlled by the City of Riverside.
2. Permittee acknowledges that the described property could be needed for a proposed or planned public improvement and the City may revoke this permit. Upon written notice of revocation, the Permittee shall, within the time prescribed by the City, remove all improvements placed, constructed or maintained. If the Permittee fails to abide by the removal order of the City, the City shall have the right to remove and destroy the improvements without reimbursement to the Permittee. The cost of such removal shall be paid by the Permittee to the City and shall constitute a debt owed to the City.
3. Permittee waives the right of claim, loss, damage or action against the City resulting from revocation, termination, removal of improvements or any action of the City, its officers, agents or employees taken in accordance with the terms herein. Permittee acknowledges that any rights granted by this Encroachment Permit are not assignable to any other party.
4. If the Public Works Director of the City of Riverside finds that the Permittee is in default of the terms of this permit, that shall be cause for revocation.
5. Permittee herewith agrees to hold the City of Riverside harmless from and against all claims demands, costs, losses, damages, injuries, actions for damages and/or injuries, and liability in connection with the construction, encroachment, and/or maintenance to be done by Permittee within the described property.
6. Prior to any construction taking place on City controlled property, Permittee shall obtain a Construction Permit or Street Opening Permit from the City Public Works Department.
7. The Permittee agrees to insure that construction of their improvements will not interfere in any way with any existing City or utility facilities.
8. Permittee acknowledges that existing city or utility facilities will require future maintenance, reconstruction, and revisions and that facilities may be added, any of which may result in removal or alteration of the Permittee's improvements without reimbursement to the Permittee.
9. Prior to construction, Permittee shall contact Underground Service Alert to field locate existing utility lines. Any conflicts discovered will void the permit until acceptable revisions are made. It shall be Permittee's responsibility to determine the location and required clearances from all public and private utility, sewer and drainage facilities prior to drilling and shall only drill in compliance with such clearance requirements.

**NOTE: SEWER AND STORM DRAIN FACILITIES ARE NOT MARKED AS A PART OF THE DIG ALERT PROGRAM. IT IS THE RESPONSIBILITY OF THE APPLICANT TO DETERMINE THE ACTUAL LOCATION OF THESE FACILITIES.**

**Special Departmental Conditions Attached:** YES

SPECIAL DEPARTMENTAL CONDITIONS  
Public Works Department

Permittee acknowledges that the proposed encroachment of a private communication duct may not be shown as a public utility and therefore may not be marked under existing Underground Service Alert guidelines. Permittee further acknowledges that the City will continue to issue Street Opening Permits for the installation of other facilities and that the issuance of these permits may result in accidental damage to Permittee's facilities.

Permittee herewith agrees to hold the City of Riverside harmless from and against all claims, demands, costs, losses, damages, injuries, actions for damages and/or injuries, and liability in connection with any accidental damage caused to Permittee's facilities by any future construction, and/or maintenance done by City, its agents, officers, and assigns or as a result of the City's issuance of Street Opening Permits or Construction Permits in the described area.

Acknowledgment of Special Departmental Conditions:

Date November 29, 2001

By Judy Williams

Phone (909) 955-4941

Title Procurement Contract Specialist

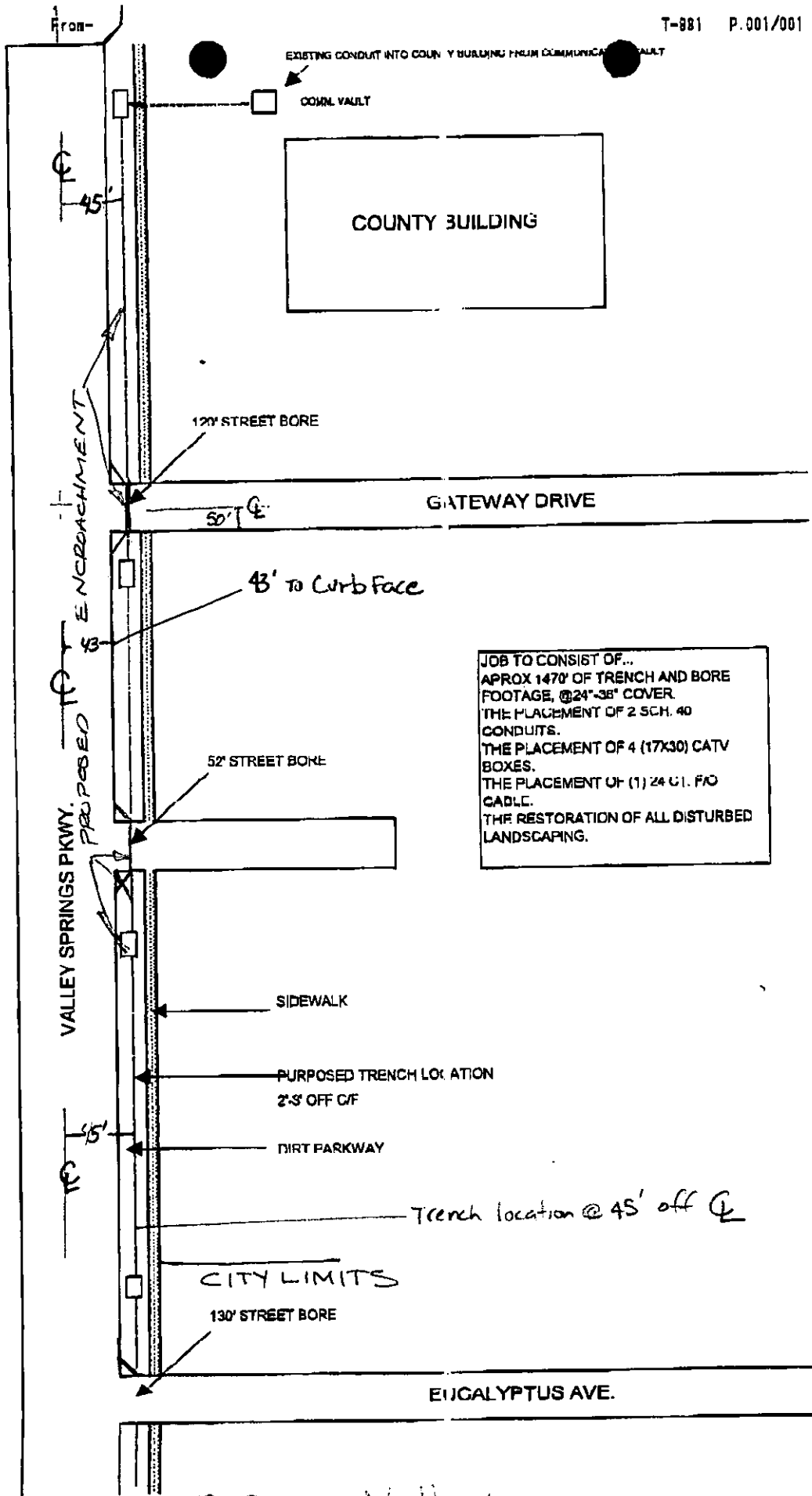

JOB TO CONSIST OF...  
 APPROX 1470' OF TRENCH AND BORE  
 FOOTAGE, @24"-36" COVER.  
 THE PLACEMENT OF 2 SCH. 40  
 CONDUITS.  
 THE PLACEMENT OF 4 (17X30) CATV  
 BOXES.  
 THE PLACEMENT OF (1) 24 G1. F/O  
 CABLE.  
 THE RESTORATION OF ALL DISTURBED  
 LANDSCAPING.

moreno Valley

**SPECIAL DEPARTMENT CONDITIONS**  
**Public Utilities Department**

City of Riverside Public Utilities Department has underground electric distribution structures and facilities including conduits, vaults, CST's, switches, cables and street lights which must be protected in place by the permittee. These facilities are located in the public right-of-way area along the permittee's proposed construction site on the east side of Valley Springs Pkwy (see the attached drawings). The permittee shall have all the underground facilities located and identified by USA (Underground Service Alert), Phone # 1-800-227-2600, before they proceed with the construction of their structures and facilities. As a general rule, the permittee's trench and structures must be at least 6 feet away from the City's electric structures, including vaults, switches, CST'S and any padmounted structures, and buried at least at 6 feet depth below the established grade. Additionally, if the permittee's conduits must cross the utility conduits, the permittee must ensure a minimum one foot separation is maintained between them. The permittee shall ensure their structures/facilities are installed such that the minimum clearance requirements, stated above, from the City's electric facilities are met. If such clearances can not be maintained, the permittee will be required to relocate the proposed facilities to an alternate location.

Date: Dec. 3, 2001

By: 

Phone: (909) 826-5830

Title: Senior Electrical Engineer