

ENCROACHMENT PERMIT

9450 INDIANA AVE

Brakemaster Inc., the Lessee of the property located at in the City of Riverside, hereby requests permission to construct and maintain surface drains tied into the City Storm Drain System as shown on EXHIBIT A attached hereto.

Upon issuance of this permit, I agree to comply with the attached terms and conditions.

Date 12/7/2001

BY: [Signature]

Date

BY: [Signature]

Applicant: Brakemaster 9450 Indiana Avenue Riverside, CA.

Representative: O'Malley Engineering Corp. 720 West Sixth St. Corona CA. 909-734-0633

ENCROACHMENT PERMIT APPROVAL

This permit shall become effective upon the approval of the Departments listed below. Issuance of this permit shall not be construed as a waiver of any other applicable permit or requirement, and is only revocable permission to use the land for the purpose described.

- Public Utilities Water - Brian Simpson (Signature) 12/4/01
Public Utilities Electric - Pat Hohl (Signature) 12-4-01
Parke and Recreation - Torry Nielson
Planning - Jeff Bolier

APPLICANT: Upon obtaining the above signatures, return this permit to the Public Works Department for final approval.

FINAL APPROVAL

Date 12/5/01

[Signature] Thomas Boyd, Interim Public Works Director

TERMS AND CONDITIONS

1. Permittee acknowledges that the area of encroachment is owned or controlled by the City of Riverside.
2. Permittee acknowledges that the described property could be needed for a proposed or planned public improvement and the City may revoke this permit. Upon written notice of revocation, the permittee shall, within the time prescribed by the City, remove all improvements placed, constructed or maintained. If the permittee fails to abide by the removal order of the City, the City shall have the right to remove and destroy the improvements without reimbursement to the permittee. The cost of such removal shall be paid by the permittee to the City and shall constitute a debt owed to the City.
3. Permittee waives the right of claim, loss, damage or action against the City resulting from revocation, termination, removal of improvements or any action of the City, its officers, agents or employees taken in accordance with the terms herein.
4. If the Public Works Director of the City of Riverside finds that the permittee is in default of the terms of this permit, that shall be cause for revocation.
5. Permittee herewith agrees to hold the City of Riverside harmless from and against all claims demands, costs, losses, damages, injuries, actions for damages and/or injuries, and liability in connection with the construction, encroachment, and/or maintenance to be done by permittee within the described property.
6. Prior to any construction taking place on City controlled property, permittee shall obtain a Construction Permit or Street Opening Permit from the City Public Works Department.
7. The permittee agrees to insure that construction of their improvements will not interfere in any way with any existing City or utility facilities.
8. Permittee acknowledges that existing city or utility facilities will require future maintenance, reconstruction, and revisions and that facilities may be added, any of which may result in removal or alteration of the permittee's improvements without reimbursement to the permittee.
9. Prior to construction, permittee shall contact Underground Service Alert to field locate existing utility lines. Any conflicts discovered will void the permit until acceptable revisions are made. It shall be Permittee's responsibility to determine the location and required clearances from all public and private utility, sewer and drainage facilities prior to drilling and shall only drill in compliance with such clearance requirements.

NOTE: SEWER AND STORM DRAIN FACILITIES ARE NOT MARKED AS PART OF THE DIG ALERT PROGRAM. IT IS THE RESPONSIBILITY OF THE APPLICANT TO DETERMINE THE ACTUAL LOCATION OF THESE FACILITIES.

Special Departmental Conditions Attached: YES

SPECIAL DEPARTMENTAL CONDITIONS



Public Works:

10. All on-site catch basins and inlets must have a properly installed and maintained fossil filter to Public Works Specifications.
11. Permittee acknowledges that there are existing public works and public utility facilities that may interfere with the proposed improvement. All existing utilities, sewers and storm drains **must be field located (pot-holed)** prior to installation of the proposed facilities.
12. Permittee acknowledges that all maintenance of the drain line between its connection with the line in the street and the right of way line is the responsibility of the permittee.

Acknowledgement of Special Conditions:

Date 12/7/2001

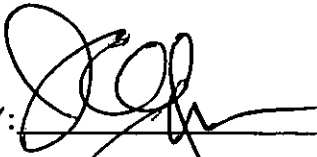
Date _____

BY:  _____
BY:  _____

BRAKEMASTER
9450 INDIANA AVENUE
RIVERSIDE, CA



NOV 29 2001
DEPT. OF PUBLIC WORKS

REVISION

INDIANA AVENUE

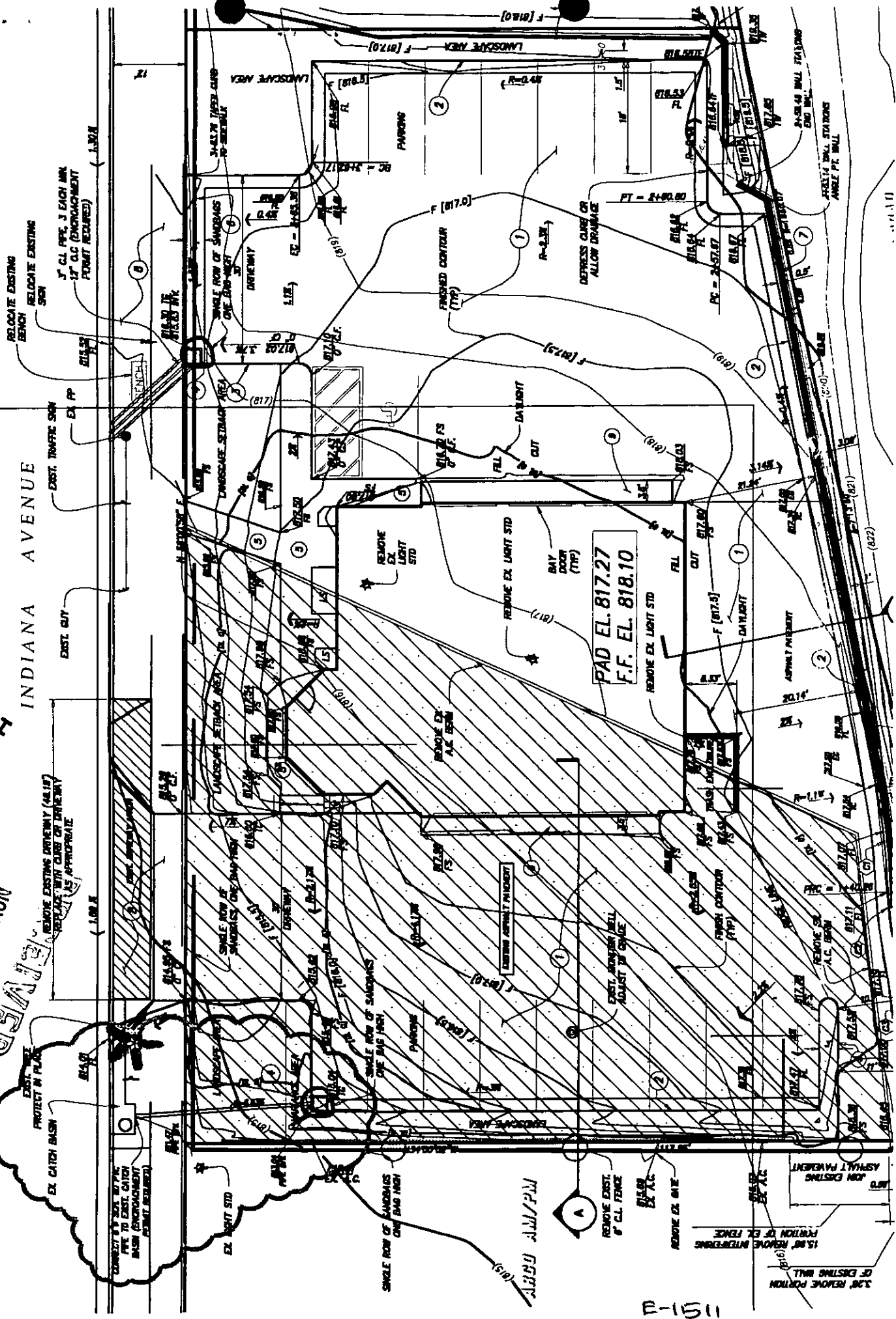

P-1511