

ENCROACHMENT PERMIT

AMBERHILL – SANTA BARBARA, LLC, the Owners of the property located at Sun Blossom Court and Moss Road – Tract 29766 in the City of Riverside, hereby requests permission to construct and maintain a **“First Flush” storm water capture and filter system** as shown on **STORM DRAIN PLAN D-707**, a reduced copy of which is attached hereto.

Upon issuance of this permit, I agree to comply with the attached terms and conditions.

Date 8-23-02

BY: 

Date _____

BY: _____

Applicants Address:
Amberhill- Santa Barbara
325 Magnolia Avenue
Corona CA. 92879
Attn : Joe Sebellia 909-322-6297

ENCROACHMENT PERMIT APPROVAL

This permit shall become effective upon the approval of the Departments listed below. Issuance of this permit shall not be construed as a waiver of any other applicable permit or requirement, and is only revocable permission to use the land for the purpose described.

~~Public Utilities Water – Brian Simpson~~ _____

~~Public Utilities Electric – Pat Hohl~~  8-22-02

~~Parks and Recreation – Terry Nielson~~ _____

~~Planning – Jeff Bolior~~ _____

APPLICANT: Upon obtaining the above signatures, return this permit to the Public Works Department for final approval.

FINAL APPROVAL

Date 8/23/02

Thomas Boyd, Interim Public Works Director

TERMS AND CONDITIONS

1. Permittee acknowledges that the area of encroachment is owned or controlled by the City of Riverside.
2. Permittee acknowledges that the described property could be needed for a proposed or planned public improvement and the City may revoke this permit. Upon written notice of revocation, the permittee shall, within the time prescribed by the City, remove all improvements placed, constructed or maintained. If the permittee fails to abide by the removal order of the City, the City shall have the right to remove and destroy the improvements without reimbursement to the permittee. The cost of such removal shall be paid by the permittee to the City and shall constitute a debt owed to the City.
3. Permittee waives the right of claim, loss, damage or action against the City resulting from revocation, termination, removal of improvements or any action of the City, its officers, agents or employees taken in accordance with the terms herein.
4. If the Public Works Director of the City of Riverside finds that the permittee is in default of the terms of this permit, that shall be cause for revocation.
5. Permittee herewith agrees to hold the City of Riverside harmless from and against all claims demands, costs, losses, damages, injuries, actions for damages and/or injuries, and liability in connection with the construction, encroachment, and/or maintenance to be done by permittee within the described property.
6. Prior to any construction taking place on City controlled property, permittee shall obtain a Construction Permit or Street Opening Permit from the City Public Works Department.
7. The permittee agrees to insure that construction of their improvements will not interfere in any way with any existing City or utility facilities.
8. Permittee acknowledges that existing city or utility facilities will require future maintenance, reconstruction, and revisions and that facilities may be added, any of which may result in removal or alteration of the permittee's improvements without reimbursement to the permittee.
9. Prior to construction, permittee shall contact Underground Service Alert to field locate existing utility lines. Any conflicts discovered will void the permit until acceptable revisions are made. It shall be Permittee's responsibility to determine the location and required clearances from all public and private utility, sewer and drainage facilities prior to drilling and shall only drill in compliance with such clearance requirements.

NOTE: SEWER AND STORM DRAIN FACILITIES ARE NOT MARKED AS PART OF THE DIG ALERT PROGRAM. IT IS THE RESPONSIBILITY OF THE APPLICANT TO DETERMINE THE ACTUAL LOCATION OF THESE FACILITIES.

Special Departmental Conditions Attached: YES

SPECIAL DEPARTMENTAL CONDITIONS

Public Works:

10. Permittee acknowledges that there are existing public works and public utility facilities that may interfere with the proposed improvement. All existing utilities, sewers and storm drains **must be field located (pot-holed)** prior to installation of the proposed facilities.
12. Permittee acknowledges that all maintenance of this drain system is the responsibility of the permittee.

 CASH TOLL FREE
 1-800-227-2800
 THE OFFICIAL SIGN SERVICE FOR THE STATE OF CALIFORNIA

PRIVATE ENGINEERING NOTE









CITY OF INGLEWOOD, CALIFORNIA
 DEPARTMENT OF PUBLIC WORKS
 APPROVED BY:
 DIVISION OF PUBLIC WORKS
 DATE:

TRACT NO. 29766
 STORM DRAIN PLAN
 LANE 4
 PROJECT NO. D-207
 SHEET NO. 2 OF 3
 FILE NO.

NO.	DESCRIPTION	DATE
1	DESIGNED BY	
2	CHECKED BY	
3	APPROVED BY	
4	DATE	
5	SCALE	
6	PROJECT NO.	
7	SHEET NO.	
8	TOTAL SHEETS	
9	DATE	
10	SCALE	
11	PROJECT NO.	
12	SHEET NO.	
13	TOTAL SHEETS	
14	DATE	
15	SCALE	
16	PROJECT NO.	
17	SHEET NO.	
18	TOTAL SHEETS	
19	DATE	
20	SCALE	

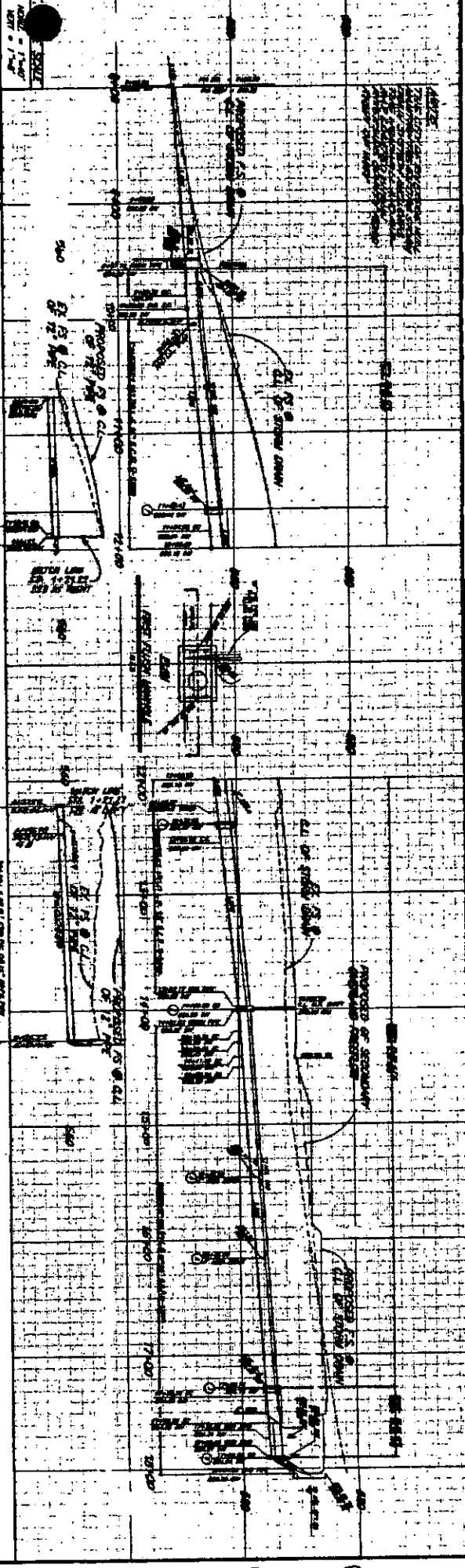
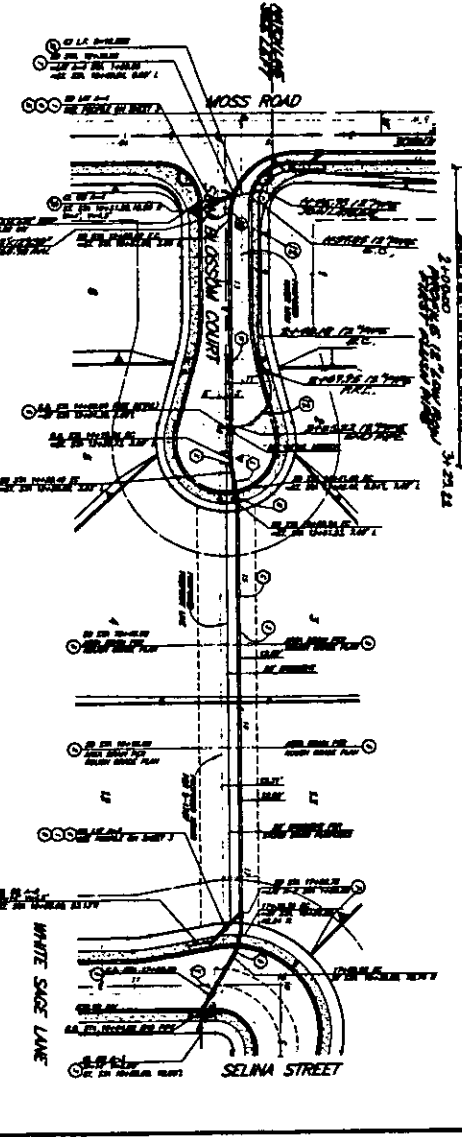
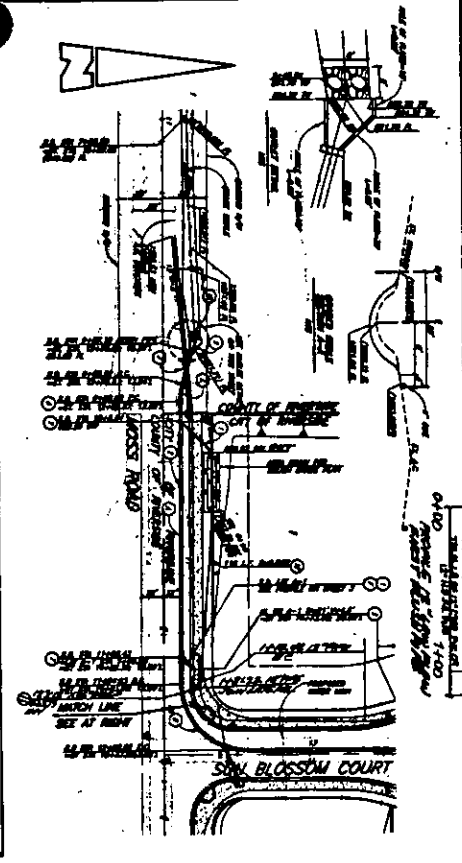
SPECIAL NOTE (GENERAL)
 1. THIS PLAN IS A PART OF A SET OF PLANS FOR THE CONSTRUCTION OF A STORM DRAINAGE SYSTEM FOR TRACT NO. 29766, LANE 4, INGLEWOOD, CALIFORNIA. THE ENGINEER HAS CONDUCTED A VISUAL INSPECTION OF THE SITE AND HAS FOUND IT TO BE SUITABLE FOR THE PROPOSED WORK. THE ENGINEER HAS NOT CONDUCTED ANY TESTS OR INVESTIGATIONS TO DETERMINE THE EXISTING CONDITIONS OF THE SOIL OR THE UNDERGROUND UTILITIES. THE ENGINEER HAS NOT CONDUCTED ANY TESTS OR INVESTIGATIONS TO DETERMINE THE EXISTING CONDITIONS OF THE SURFACE WATER. THE ENGINEER HAS NOT CONDUCTED ANY TESTS OR INVESTIGATIONS TO DETERMINE THE EXISTING CONDITIONS OF THE AIR. THE ENGINEER HAS NOT CONDUCTED ANY TESTS OR INVESTIGATIONS TO DETERMINE THE EXISTING CONDITIONS OF THE GROUNDWATER. THE ENGINEER HAS NOT CONDUCTED ANY TESTS OR INVESTIGATIONS TO DETERMINE THE EXISTING CONDITIONS OF THE VEGETATION. THE ENGINEER HAS NOT CONDUCTED ANY TESTS OR INVESTIGATIONS TO DETERMINE THE EXISTING CONDITIONS OF THE ADJACENT PROPERTIES. THE ENGINEER HAS NOT CONDUCTED ANY TESTS OR INVESTIGATIONS TO DETERMINE THE EXISTING CONDITIONS OF THE PUBLIC UTILITIES. THE ENGINEER HAS NOT CONDUCTED ANY TESTS OR INVESTIGATIONS TO DETERMINE THE EXISTING CONDITIONS OF THE PUBLIC HIGHWAYS. THE ENGINEER HAS NOT CONDUCTED ANY TESTS OR INVESTIGATIONS TO DETERMINE THE EXISTING CONDITIONS OF THE PUBLIC WATER SUPPLY. THE ENGINEER HAS NOT CONDUCTED ANY TESTS OR INVESTIGATIONS TO DETERMINE THE EXISTING CONDITIONS OF THE PUBLIC SEWERAGE. THE ENGINEER HAS NOT CONDUCTED ANY TESTS OR INVESTIGATIONS TO DETERMINE THE EXISTING CONDITIONS OF THE PUBLIC TRASH COLLECTION. THE ENGINEER HAS NOT CONDUCTED ANY TESTS OR INVESTIGATIONS TO DETERMINE THE EXISTING CONDITIONS OF THE PUBLIC STREET LIGHTING. THE ENGINEER HAS NOT CONDUCTED ANY TESTS OR INVESTIGATIONS TO DETERMINE THE EXISTING CONDITIONS OF THE PUBLIC PARKS AND RECREATION. THE ENGINEER HAS NOT CONDUCTED ANY TESTS OR INVESTIGATIONS TO DETERMINE THE EXISTING CONDITIONS OF THE PUBLIC LIBRARIES. THE ENGINEER HAS NOT CONDUCTED ANY TESTS OR INVESTIGATIONS TO DETERMINE THE EXISTING CONDITIONS OF THE PUBLIC MUSEUMS. THE ENGINEER HAS NOT CONDUCTED ANY TESTS OR INVESTIGATIONS TO DETERMINE THE EXISTING CONDITIONS OF THE PUBLIC THEATERS. THE ENGINEER HAS NOT CONDUCTED ANY TESTS OR INVESTIGATIONS TO DETERMINE THE EXISTING CONDITIONS OF THE PUBLIC CINEMAS. THE ENGINEER HAS NOT CONDUCTED ANY TESTS OR INVESTIGATIONS TO DETERMINE THE EXISTING CONDITIONS OF THE PUBLIC GYMNASIUMS. THE ENGINEER HAS NOT CONDUCTED ANY TESTS OR INVESTIGATIONS TO DETERMINE THE EXISTING CONDITIONS OF THE PUBLIC SWIMMING POOLS. THE ENGINEER HAS NOT CONDUCTED ANY TESTS OR INVESTIGATIONS TO DETERMINE THE EXISTING CONDITIONS OF THE PUBLIC BATHS. THE ENGINEER HAS NOT CONDUCTED ANY TESTS OR INVESTIGATIONS TO DETERMINE THE EXISTING CONDITIONS OF THE PUBLIC HOTELS. THE ENGINEER HAS NOT CONDUCTED ANY TESTS OR INVESTIGATIONS TO DETERMINE THE EXISTING CONDITIONS OF THE PUBLIC RESTAURANTS. THE ENGINEER HAS NOT CONDUCTED ANY TESTS OR INVESTIGATIONS TO DETERMINE THE EXISTING CONDITIONS OF THE PUBLIC CATERING SERVICES. THE ENGINEER HAS NOT CONDUCTED ANY TESTS OR INVESTIGATIONS TO DETERMINE THE EXISTING CONDITIONS OF THE PUBLIC TRAVEL AGENCIES. THE ENGINEER HAS NOT CONDUCTED ANY TESTS OR INVESTIGATIONS TO DETERMINE THE EXISTING CONDITIONS OF THE PUBLIC TOUR OPERATORS. THE ENGINEER HAS NOT CONDUCTED ANY TESTS OR INVESTIGATIONS TO DETERMINE THE EXISTING CONDITIONS OF THE PUBLIC TRANSPORTATION SERVICES. THE ENGINEER HAS NOT CONDUCTED ANY TESTS OR INVESTIGATIONS TO DETERMINE THE EXISTING CONDITIONS OF THE PUBLIC AIRLINES. THE ENGINEER HAS NOT CONDUCTED ANY TESTS OR INVESTIGATIONS TO DETERMINE THE EXISTING CONDITIONS OF THE PUBLIC RAILROADS. THE ENGINEER HAS NOT CONDUCTED ANY TESTS OR INVESTIGATIONS TO DETERMINE THE EXISTING CONDITIONS OF THE PUBLIC BUSES. THE ENGINEER HAS NOT CONDUCTED ANY TESTS OR INVESTIGATIONS TO DETERMINE THE EXISTING CONDITIONS OF THE PUBLIC TRUCKS. THE ENGINEER HAS NOT CONDUCTED ANY TESTS OR INVESTIGATIONS TO DETERMINE THE EXISTING CONDITIONS OF THE PUBLIC TAXIS. THE ENGINEER HAS NOT CONDUCTED ANY TESTS OR INVESTIGATIONS TO DETERMINE THE EXISTING CONDITIONS OF THE PUBLIC RENTAL CARS. THE ENGINEER HAS NOT CONDUCTED ANY TESTS OR INVESTIGATIONS TO DETERMINE THE EXISTING CONDITIONS OF THE PUBLIC CAR SHARING SERVICES. THE ENGINEER HAS NOT CONDUCTED ANY TESTS OR INVESTIGATIONS TO DETERMINE THE EXISTING CONDITIONS OF THE PUBLIC BICYCLE SHARING SERVICES. THE ENGINEER HAS NOT CONDUCTED ANY TESTS OR INVESTIGATIONS TO DETERMINE THE EXISTING CONDITIONS OF THE PUBLIC SKATEBOARDING SERVICES. THE ENGINEER HAS NOT CONDUCTED ANY TESTS OR INVESTIGATIONS TO DETERMINE THE EXISTING CONDITIONS OF THE PUBLIC SURFING SERVICES. THE ENGINEER HAS NOT CONDUCTED ANY TESTS OR INVESTIGATIONS TO DETERMINE THE EXISTING CONDITIONS OF THE PUBLIC WATER SKIING SERVICES. THE ENGINEER HAS NOT CONDUCTED ANY TESTS OR INVESTIGATIONS TO DETERMINE THE EXISTING CONDITIONS OF THE PUBLIC WIND SURFING SERVICES. THE ENGINEER HAS NOT CONDUCTED ANY TESTS OR INVESTIGATIONS TO DETERMINE THE EXISTING CONDITIONS OF THE PUBLIC KAYAKING SERVICES. THE ENGINEER HAS NOT CONDUCTED ANY TESTS OR INVESTIGATIONS TO DETERMINE THE EXISTING CONDITIONS OF THE PUBLIC CANOEING SERVICES. THE ENGINEER HAS NOT CONDUCTED ANY TESTS OR INVESTIGATIONS TO DETERMINE THE EXISTING CONDITIONS OF THE PUBLIC ROWING SERVICES. THE ENGINEER HAS NOT CONDUCTED ANY TESTS OR INVESTIGATIONS TO DETERMINE THE EXISTING CONDITIONS OF THE PUBLIC SAILBOATING SERVICES. THE ENGINEER HAS NOT CONDUCTED ANY TESTS OR INVESTIGATIONS TO DETERMINE THE EXISTING CONDITIONS OF THE PUBLIC MOTORBOATING SERVICES. THE ENGINEER HAS NOT CONDUCTED ANY TESTS OR INVESTIGATIONS TO DETERMINE THE EXISTING CONDITIONS OF THE PUBLIC WATER SKIING SERVICES. THE ENGINEER HAS NOT CONDUCTED ANY TESTS OR INVESTIGATIONS TO DETERMINE THE EXISTING CONDITIONS OF THE PUBLIC WIND SURFING SERVICES. THE ENGINEER HAS NOT CONDUCTED ANY TESTS OR INVESTIGATIONS TO DETERMINE THE EXISTING CONDITIONS OF THE PUBLIC KAYAKING SERVICES. THE ENGINEER HAS NOT CONDUCTED ANY TESTS OR INVESTIGATIONS TO DETERMINE THE EXISTING CONDITIONS OF THE PUBLIC CANOEING SERVICES. THE ENGINEER HAS NOT CONDUCTED ANY TESTS OR INVESTIGATIONS TO DETERMINE THE EXISTING CONDITIONS OF THE PUBLIC ROWING SERVICES. THE ENGINEER HAS NOT CONDUCTED ANY TESTS OR INVESTIGATIONS TO DETERMINE THE EXISTING CONDITIONS OF THE PUBLIC SAILBOATING SERVICES. THE ENGINEER HAS NOT CONDUCTED ANY TESTS OR INVESTIGATIONS TO DETERMINE THE EXISTING CONDITIONS OF THE PUBLIC MOTORBOATING SERVICES.



E-1529