

ENCROACHMENT PERMIT

Pursuant to Resolution No. 11065 of the City of Riverside, permission is hereby granted to Main Street L.T.D.  
3597 Main Street  
Riverside, CA 92501

its heirs and assigns, hereinafter referred to as "Permittee" to use and occupy the following described property. That portion of Sixth Street, a public right of way, adjacent to the southwesterly line of Range 7, Block 5 of the Town of Riverside as shown by map on file in Book 7 of Maps, at Page 17 thereof, records of San Bernardino County, California, hereinafter referred to as Right of Way No. 2, and all that portion of Main Street, a public right of way, adjacent to the southeast line of said Range 7 in Block 5, hereinafter referred to as Right of Way No. 1,

in accordance with the terms hereof.

1. Permittee shall use and occupy the described property only in the manner and for the purposes as follows:

1. To construct and maintain two outside eating areas.
  - (a.) Area - 1 8' x 17' on Main Street
  - (b.) Area - 2 8' x 24' on Sixth StreetNote: These areas will be defined by rectangular exposed aggregate concrete planters approximately 2' x 2' x 7'
2. To install and maintain concrete planters (exposed aggregate concrete) as shown on the site/floor plan labeled Exhibit "A".  
Note: These planters will be next to the building on both Sixth and Main Streets.
3. To install and maintain awnings projecting into the sidewalk right-of-way on both Sixth and Main Streets.
4. All of these items are shown on Exhibit "A" attached and made part hereof by this reference.

2. Permittee, by acceptance of the benefits hereunder, acknowledges title to the property to be in the City of Riverside and waives any right to contest the validity of the dedication or grant.

3. Permittee acknowledges that the described property is the site of a proposed or planned public improvement and that, accordingly, all rights and privileges of use permitted shall cease and expire upon notice of revocation by the City. Upon the expiration or revocation, Permittee shall, within the time prescribed by the City, remove all improvements or obstructions placed, constructed or maintained by the Permittee. If the Permittee fails to abide by the removal order of the City within the time prescribed, the City shall have the right to remove and destroy the improvements without reimbursement to the Permittee and the cost of such removal shall be paid by the Permittee to the City of Riverside and shall constitute a debt owed to the City of Riverside.

4. Permittee, by acceptance hereof, waives the right of claim, loss, damage or action against the City of Riverside arising out of or resulting from revocation, termination, removal of the improvements or any action of the City of Riverside, its officers, agents or employees taken in accordance with the terms hereof.

5. Finding and determination by the City Council of the City of Riverside that the Permittee, or his heirs and assigns or successors in interest, are in default of the terms hereunder shall be cause for revocation.

6. Permittee herewith agrees to hold the City of Riverside harmless from and against all claims, demands, costs, losses, damages, injuries, action for damages and/or injuries, and liability growing or arising out of or in connection with the construction, encroachment, and/or maintenance to be done by Permittee or his agents, employees or contractors within the described property.

DATED: 3-5-82

CITY OF RIVERSIDE, a municipal corporation

By Robert G. Bester Mayor Pro Tempore

Attest Alicia A. New City Clerk

The foregoing is accepted by:

[Signature]  
(Signature(s) of Permittee)  
\_\_\_\_\_  
\_\_\_\_\_  
\_\_\_\_\_  
\_\_\_\_\_

APPROVED AS TO CONTENT

[Signature]  
Department Head

APPROVED AS TO FORM

[Signature]  
City Attorney

CITY MANAGER APPROVAL

[Signature]  
City Manager

VICINITY MAP

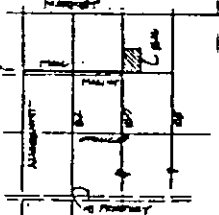

**SITE ANALYSIS**

OWNER: [illegible]  
 ARCHITECT: [illegible]  
 DATE: [illegible]  
 SCALE: [illegible]

- KEY TO SITE:
1. EXISTING BUILDING
  2. EXISTING DRIVE
  3. EXISTING DRIVE
  4. EXISTING DRIVE
  5. EXISTING DRIVE
  6. EXISTING DRIVE
  7. EXISTING DRIVE
  8. EXISTING DRIVE
  9. EXISTING DRIVE
  10. EXISTING DRIVE
  11. EXISTING DRIVE
  12. EXISTING DRIVE
  13. EXISTING DRIVE
  14. EXISTING DRIVE
  15. EXISTING DRIVE
  16. EXISTING DRIVE
  17. EXISTING DRIVE
  18. EXISTING DRIVE
  19. EXISTING DRIVE
  20. EXISTING DRIVE
  21. EXISTING DRIVE
  22. EXISTING DRIVE
  23. EXISTING DRIVE
  24. EXISTING DRIVE
  25. EXISTING DRIVE
  26. EXISTING DRIVE
  27. EXISTING DRIVE
  28. EXISTING DRIVE
  29. EXISTING DRIVE
  30. EXISTING DRIVE
  31. EXISTING DRIVE
  32. EXISTING DRIVE
  33. EXISTING DRIVE
  34. EXISTING DRIVE
  35. EXISTING DRIVE
  36. EXISTING DRIVE
  37. EXISTING DRIVE
  38. EXISTING DRIVE
  39. EXISTING DRIVE
  40. EXISTING DRIVE
  41. EXISTING DRIVE
  42. EXISTING DRIVE
  43. EXISTING DRIVE
  44. EXISTING DRIVE
  45. EXISTING DRIVE
  46. EXISTING DRIVE
  47. EXISTING DRIVE
  48. EXISTING DRIVE
  49. EXISTING DRIVE
  50. EXISTING DRIVE
  51. EXISTING DRIVE
  52. EXISTING DRIVE
  53. EXISTING DRIVE
  54. EXISTING DRIVE
  55. EXISTING DRIVE
  56. EXISTING DRIVE
  57. EXISTING DRIVE
  58. EXISTING DRIVE
  59. EXISTING DRIVE
  60. EXISTING DRIVE
  61. EXISTING DRIVE
  62. EXISTING DRIVE
  63. EXISTING DRIVE
  64. EXISTING DRIVE
  65. EXISTING DRIVE
  66. EXISTING DRIVE
  67. EXISTING DRIVE
  68. EXISTING DRIVE
  69. EXISTING DRIVE
  70. EXISTING DRIVE
  71. EXISTING DRIVE
  72. EXISTING DRIVE
  73. EXISTING DRIVE
  74. EXISTING DRIVE
  75. EXISTING DRIVE
  76. EXISTING DRIVE
  77. EXISTING DRIVE
  78. EXISTING DRIVE
  79. EXISTING DRIVE
  80. EXISTING DRIVE
  81. EXISTING DRIVE
  82. EXISTING DRIVE
  83. EXISTING DRIVE
  84. EXISTING DRIVE
  85. EXISTING DRIVE
  86. EXISTING DRIVE
  87. EXISTING DRIVE
  88. EXISTING DRIVE
  89. EXISTING DRIVE
  90. EXISTING DRIVE
  91. EXISTING DRIVE
  92. EXISTING DRIVE
  93. EXISTING DRIVE
  94. EXISTING DRIVE
  95. EXISTING DRIVE
  96. EXISTING DRIVE
  97. EXISTING DRIVE
  98. EXISTING DRIVE
  99. EXISTING DRIVE
  100. EXISTING DRIVE

OWNER: [illegible]  
 DEVELOPER: [illegible]

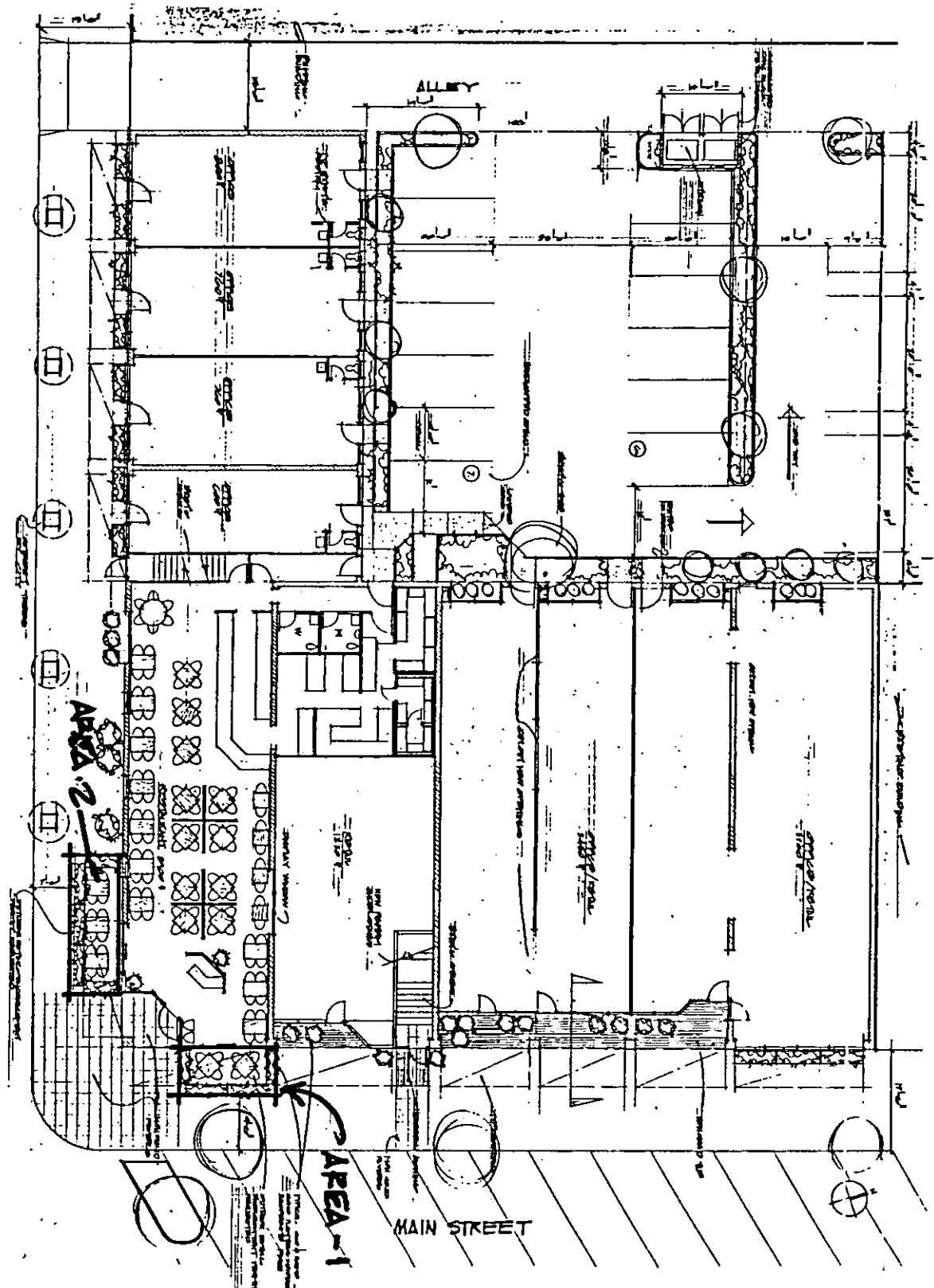

EXHIBIT "A"

SITE FLOOR PLAN



MAIN STREET  
 6TH. & MAIN ST. RIVERSIDE, CA.

Jeffrey T. Garner S.A. Architect  
 17848 Sky Park Circle Irvine, CA 92614 949-261-0101

E-825