

March 24, 1987

J. D. Alton, Inc.
16510 Aston Street
Irvine, CA 92714

RE: Encroachment Permit, 8690 California Avenue, Mobile Oil Corporation
Station

Gentlemen:

A certain amount of time has passed without communication from you or indication of any further work taking place at the site of this permit. As a follow-up to this permit prior to terminating it, I felt it necessary to contact you to get answers to these questions:

1. Have you completed all your work at the site covered by this permit?
2. Are there any wells remaining within public right-of-way at the site?
3. Have the wells been filled according to our specifications, and will a closure report be submitted as described in Item 1(a) as of the permit?
4. Were there any results derived from your work in that area that would be of benefit to the City? If so, by what means could the City obtain a copy of your test results since we maintain records of such things on an ongoing basis?

Please contact me as soon as possible so we may put this project to rest. On the possibility that you will be back in to take further tests over the years, we would appreciate an as-built map of the location of each well. It is our understanding that these are not in the pavement, but are in the parkway.

Should you have any questions, please feel free to call me at (714) 787-7347.

Very truly yours,

William D. Gardner
Deputy Public Works Director - Engineering

George Hutchinson
Surveyor

WDG/GH/1737Y/k

PUBLIC WORKS DEPT.		INITIAL	INFO	ACTION	DATE
DIRECTOR					
DEPUTY-ENGR.					
DEPUTY-FIELD					
ADM. ASST.					
SEWER PLANT					
SOLID WASTE					
STREETS					
TRAF. ENGR.					
CAP. PROJ.					
LAND DEV.					
SVY./L. SVC.					
INSPECTION					
SPEC. PROJ.					
CLEMICAL					
FILE	Attach to E-950				
Y-REF					
F. U. DATE					

ENCROACHMENT PERMIT

Pursuant to Resolution No. 11065 of the City of Riverside, permission is hereby granted to

J. T. Alton, Inc. - Consultant
8690 California Avenue

their heirs and assigns, hereinafter referred to as "Permittee" to use and occupy the following described property. That portion of the public street right of way of California Avenue adjacent to Parcel 6 as shown on Record of Survey on file in Book 41, at Page 98 of Records of Survey, Records of Riverside County, California, as shown by attached Exhibit "A";

in accordance with the terms hereof.

1. Permittee shall use and occupy the described property only in the manner and for the purposes as follows: Drilling, monitoring and maintenance of test wells for determination of the limits of possible hydrocarbon contamination in the areas shown by attached Exhibit "A". Permittee shall first drill in Area 1. If no evidence of contamination is found, this permit shall terminate automatically. If evidence of contamination is found in Area 1, the Permittee shall then be allowed to drill in Area 2. If no evidence of contamination is found in Area 2, this permit shall terminate automatically. If evidence of contamination is found in Area 2, the Permittee shall be allowed to drill in Area 3 subject to administrative approval by the Public Works Department, and providing the following conditions are met.

1a. Test wells will be approximately 15' deep with 4" I.D. casing. The casing will be capped and locked. A surface utility box will be installed, grouted, and made traffic-worthy. The wells will be periodically monitored for ground water depth and quality. After data has been collected and the wells are no longer needed, they shall be filled according to specifications from the Public Works Department, and a closure report submitted to the Public Works Department with an as-built schematic of the closed wells.

1b. Required traffic control measures, while drilling and monitoring in the street, will include delineator cones, signs, and orange vested traffic control personnel. Drilling will not commence prior to 6:30 A.M. and continue no later than 4:00 P.M. The permittee must notify the Public Works Department of the exact drilling date.

1c. Contractor shall obtain street opening permit prior to any work in the right of way.

2. Permittee, by acceptance of the benefits hereunder, acknowledges title to the property to be in the City of Riverside and waives any right to contest the validity of the dedication or grant.

3. Permittee acknowledges that the described property is the site of a proposed or planned public improvement and that, accordingly, all rights and privileges of use permitted shall cease and expire upon notice of revocation by the City. Upon the expiration or revocation, Permittee shall, within the time prescribed by the City, remove all improvements or obstructions placed, constructed or maintained by the Permittee. If the Permittee fails to abide by the removal order of the City within the time prescribed, the City shall have the right to remove and destroy the improvements without reimbursement to the Permittee and the cost of such removal shall be paid by the Permittee to the City of Riverside and shall constitute a debt owed to the City of Riverside.

4. Permittee, by acceptance hereof, waives the right of claim, loss, damage or action against the City of Riverside arising out of or resulting from revocation, termination, removal of the improvements or any action of the City of Riverside, its officers, agents or employees taken in accordance with the terms hereof.

5. Finding and determination by the City Council of the City of Riverside that the Permittee, or his heirs and assigns or successors in interest, are in default of the terms hereunder shall be cause for revocation.

6. Permittee herewith agrees to hold the City of Riverside harmless from and against all claims, demands, costs, losses, damages, injuries, action for damages and/or injuries, and liability growing or arising out of or in connection with the construction, encroachment, and/or maintenance to be done by Permittee or his agents, employees or contractors within the described property.

DATED: Aug 12, 1985

CITY OF RIVERSIDE, a municipal corporation

By Al Brown Mayor

Attest Alice O. Blue City Clerk

The foregoing is accepted by:

Jeffery W. Wiegand ^{KMK}
(Signature(s) of Permittee)
Vice President

APPROVED AS TO CONTENT

William D. Gardner
Department Head

APPROVED AS TO FORM

John Woodhead
City Attorney

CITY MANAGER APPROVAL

Robert C. Jensen
City Manager

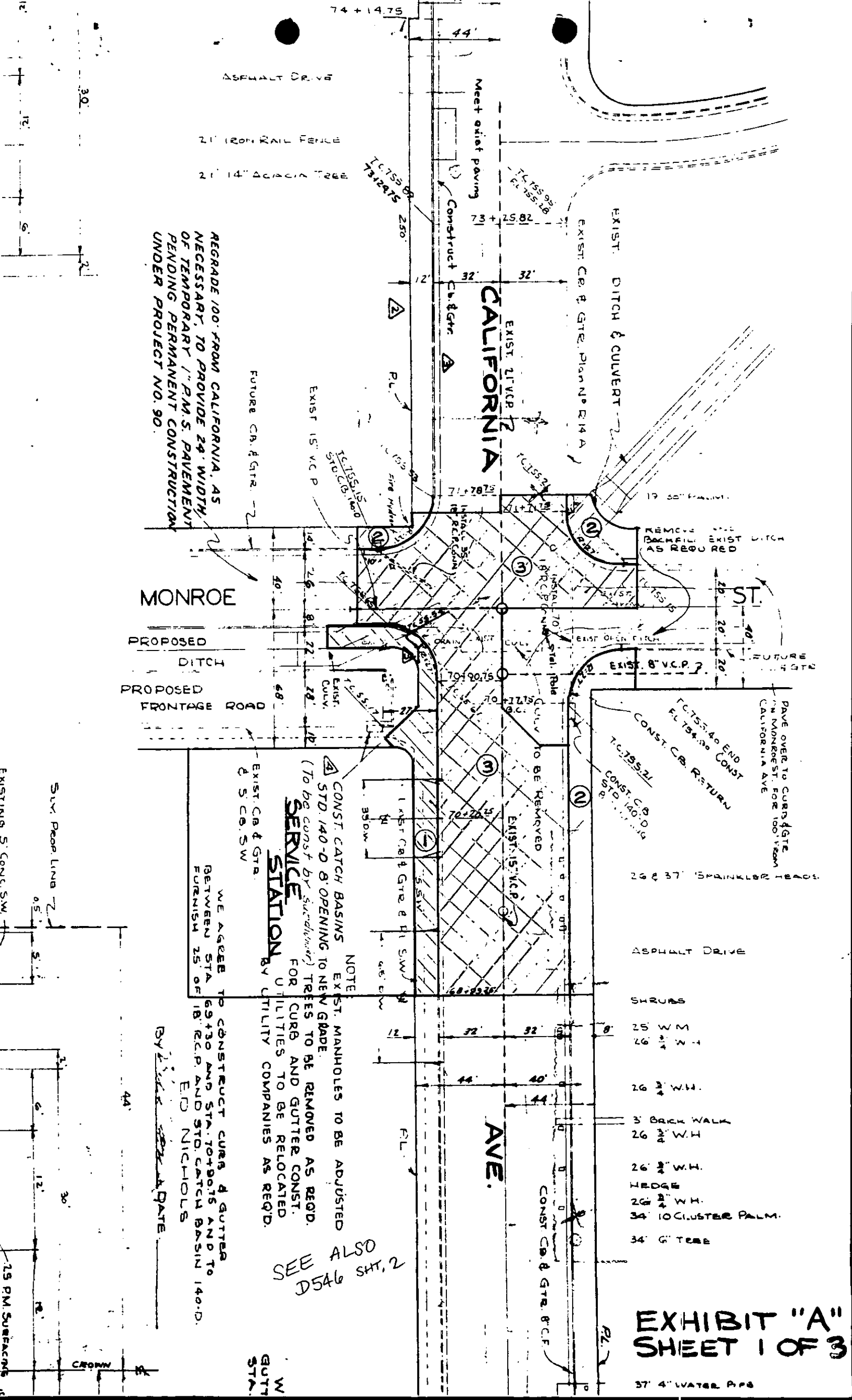

REGRADE 100' FROM CALIFORNIA, AS NECESSARY, TO PROVIDE 24' WIDTH OF TEMPORARY 1" P.M.S. PAVEMENT UNDER PROJECT NO. 90.

NOTE
 CONST. CATCH BASINS EXIST. MANHOLES TO BE ADJUSTED STD. 140-D OPENING TO NEW GRADE.
 (To be const. by subcontractor) TREES TO BE REMOVED AS REQD. FOR CURB AND GUTTER CONST. UTILITIES TO BE RELOCATED BY UTILITY COMPANIES AS REQD.

WE AGREE TO CONSTRUCT CURB & GUTTER BETWEEN STA. 69+30 AND STA. 70+90.5 AND TO FURNISH 25' OF 18" R.C.P. AND STD. CATCH BASIN 140-D. END NICHOLS

BY DATE

SEE ALSO
 D546 SHT. 2

EXHIBIT "A"
SHEET 1 OF 3

37" 4" WATER P.P.S.

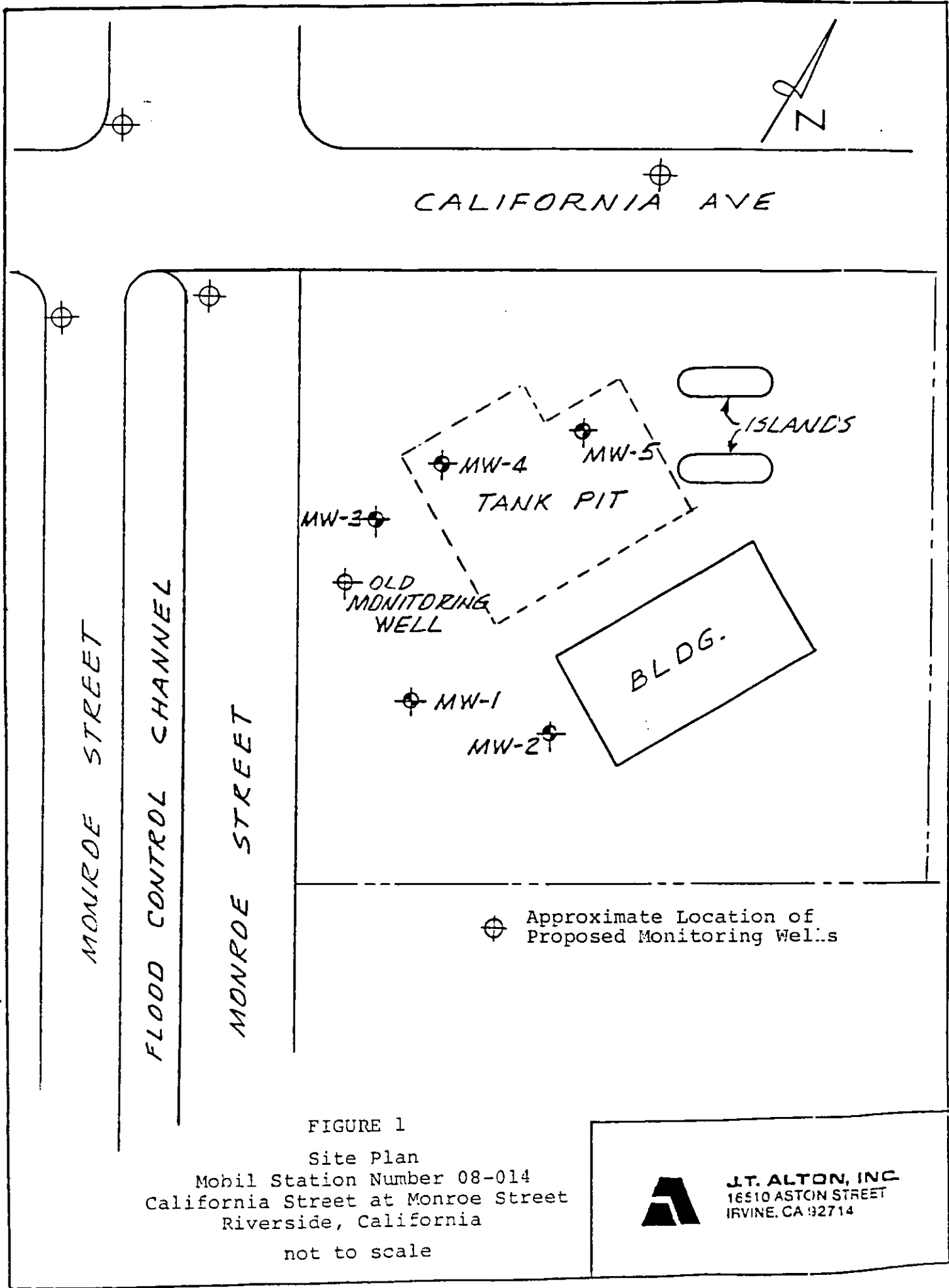

FIGURE 1

Site Plan
 Mobil Station Number 08-014
 California Street at Monroe Street
 Riverside, California
 not to scale



J.T. ALTON, INC.
 16510 ASTON STREET
 IRVINE, CA 92714

SEE ALSO
 DSA6 SHT. 2

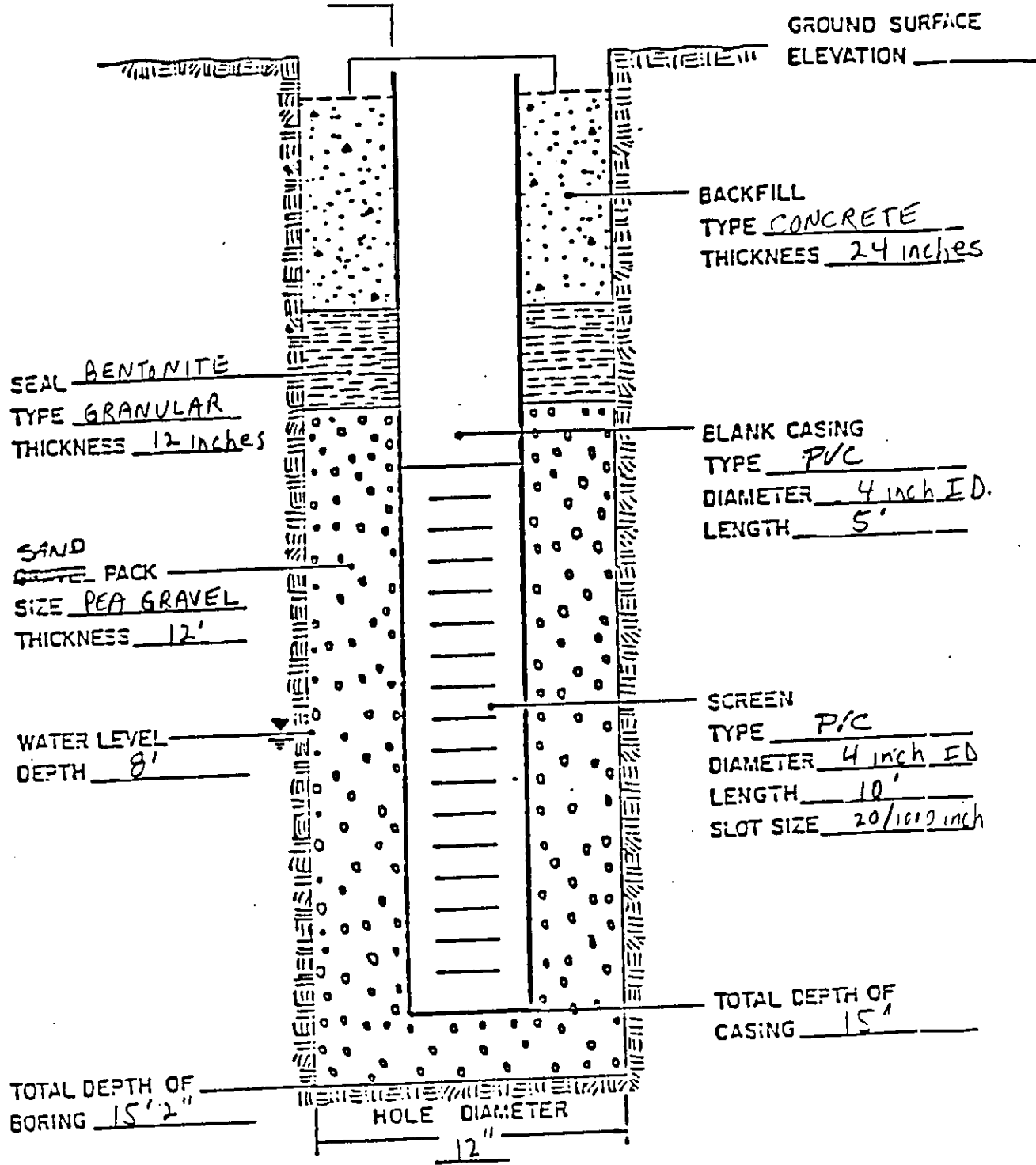

MONITORING WELL SCHEMATIC



J.T. ALTON, INC.
16510 ASTON STREET
IRVINE, CA 92714

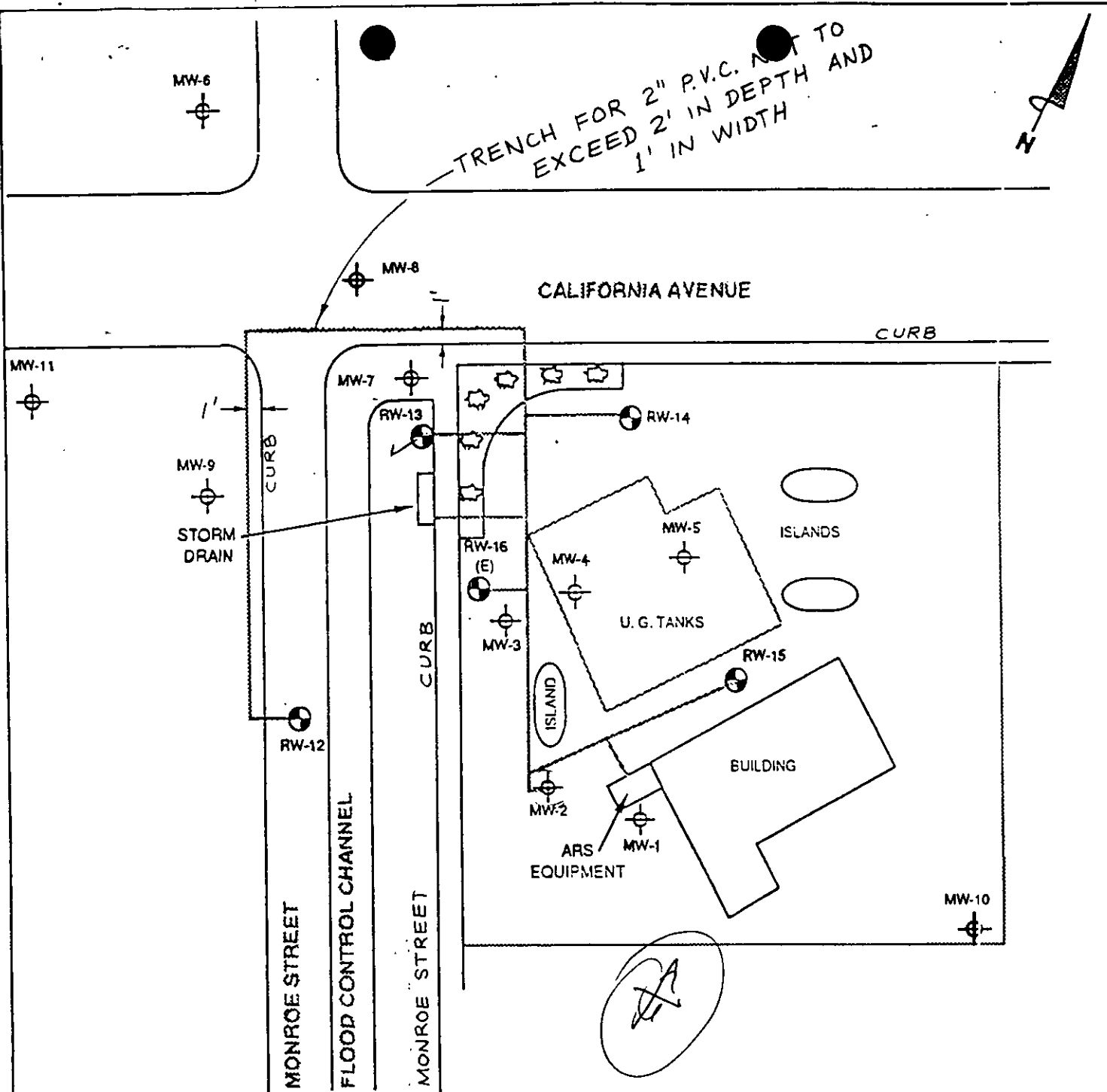





FIGURE 2: SITE PLAN SHOWING LOCATIONS OF GROUND WATER MONITORING WELLS AND PROPOSED ARS FACILITIES

Mobil Station 18-D8H
California Avenue at Monroe Street
Riverside, California

SEE ALSO D546 SHT. 2

LEGEND

-  Monitoring Well Location
-  Old Monitoring Well Location
-  Proposed Trenching
-  Proposed Recovery Well Location

NOTES: Offsite well locations and structures are approximate.
ARS = Automatic Recovery System

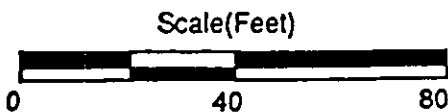

CHECKED BY: *GN*
DATE: 4/23/91
DRAWN BY: *J*
DATE: 4/23/91



ALTON GEOSCIENCE
25A Technology Drive, Suite 200
Irvine, California 92718

FIGURE 2: MONITORING WELL CONSTRUCTION DETAIL

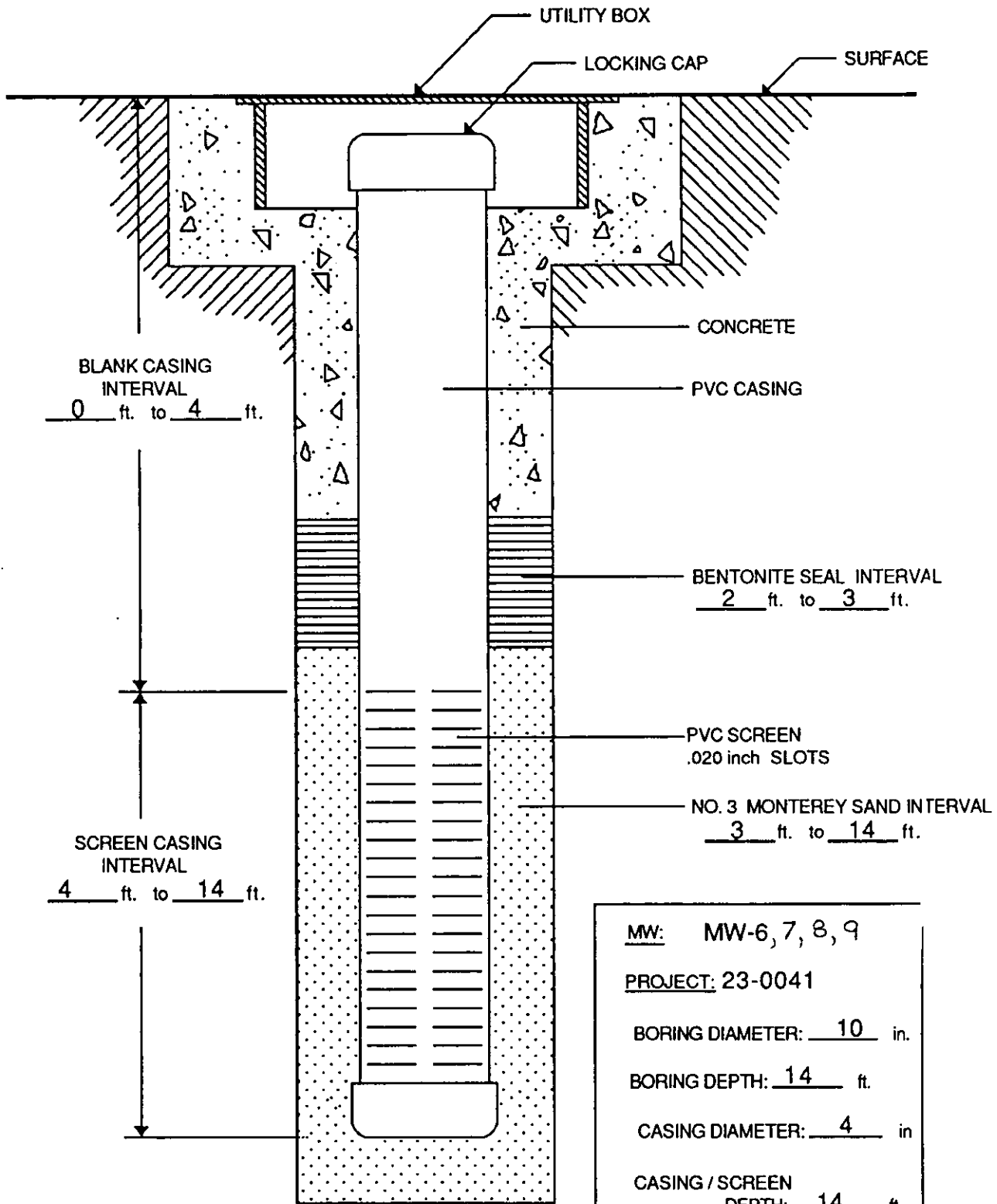

MW: MW-6, 7, 8, 9

PROJECT: 23-0041

BORING DIAMETER: 10 in.

BORING DEPTH: 14 ft.

CASING DIAMETER: 4 in

CASING / SCREEN DEPTH: 14 ft.

NOTE: DRAWING IS NOT TO SCALE



ALTON GEOSCIENCE
25A Technology Drive, Suite 200
Irvine, California 92718

BORING LOG

PROJECT 08-014 Riverside
 LOCATION California / Monroe
 TYPE 10" HSA

DATE 8/30/85
 BY JH
 BORING HOLE # 6

DEPTH	SAMPLE	MATERIALS ENCOUNTERED
3 1/2' ↓ 5'	4/6/12	Soft, moist, lt brn.-tn, silty clay; sandy, NO H.C. odor
8 1/2' ↓ 10'	7/11/15	Loose, wet, tn, clayey sand, NO H.C. odor
12 1/2' ↓ 14'	4/5/8	Very loose, wet, tn, clayey sand, NO H.C. odor very loose, wet, tn, sand, coarse, NO H.C. odor
		T.O. = 14'

BORING LOG

PROJECT 08-014 Riverside
 LOCATION California / Monroe
 TYPE 10" HSA

DATE 8/30/85
 BY JH
 BORING HOLE # 7

DEPTH	SAMPLE	MATERIALS ENCOUNTERED
3 1/2' ↓ 5'	S/13/17	stiff, damp-dry, dk. brn., silty clay, moderate H.C. odor
8 1/2' ↓ 10'	7/14/20	loose, wet, brn. sand, very strong H.C. odor, 3" of grn. clay in bottom of sampler
12 1/2' ↓ 14'	15/16/24	med dense, saturated, grn., sand, coarse, strong H.C. odor, upper 12" of sampler
		2" layer of med dense, moist, lt. brn., silty clay with little or no H.C. odor
		4" of loose, moist, lt. brn. sand, fine grained, NO H.C. odor
		TD = 14'

BORING LOG

PROJECT 08-014 Riverside
 LOCATION California / Monroe
 TYPE 10" HSA

DATE 8/30/85
 BY RH
 BORING HOLE # 8

DEPTH	SAMPLE	MATERIALS ENCOUNTERED
3 1/2 ↓ 5	10/16/80	med. stiff, dry-damp, Lt. Grn. - white, clayey silt, NO H.C. odor, Homogeneous
8 1/2 ↓ 10	10/11/17	stiff, damp-moist, Grn., silty clay, NO H.C. odor Lower 2" of sample, loose, moist, Lt. Grn. sand
12 1/2 ↓ 14	11/14/80	Loose, wet, Lt. Grn sand, fine grained, NO H.C. odor, Homogeneous
		T.D. = 14'

BORING LOG

PROJECT 08-014 Riverside
 LOCATION California / Monroe
 TYPE 10" HSA

DATE 8/30/85
 BY TS4
 BORING HOLE # 9

DEPTH	SAMPLE	MATERIALS ENCOUNTERED
7 1/2 ↓ 5	11/5/7	Loose, dry, Lt. brn., fine sand, NO H.C. odor pac-tel conduit can be seen in hole
8 1/2 ↓ 10	8/9/12	Loose, damp, Lt. brn. clayey silt, NO H.C. odor
13 1/2 ↓ 15	8/13/30	Stiff, wet, Lt. brn., fine sand, NO H.C. odor
		T.D. = 15'