

ENCROACHMENT PERMIT

Pursuant to Resolution No. 11065 of the City of Riverside, permission is hereby granted to Riverside Transit Agency

its heirs and assigns, hereinafter referred to as "Permittee" to use and occupy the following described property. Those portions of the public street right of way as shown by attached Exhibit "A",

RECEIVED
SEP 09 1985

CITY MANAGER'S OFFICE

in accordance with the terms hereof.

1. Permittee shall use and occupy the described property only in the manner and for the purposes as follows: Construction and maintenance of bus shelters and concrete pads encroaching various amounts into the public street right of way as shown by attached Exhibit "A":

1a. Bus shelters shall be of the design and construction approved by the City of Riverside. A copy of the specifications is on file with the Public Works Department.

1b. Permittee's contractor shall obtain a street opening permit from the Public Works Department prior to any construction in the street right of way.

1c. All bus shelter locations must be approved by the Public Works Department Traffic Engineering Division.

1d. If any of the bus shelters are removed, the sidewalk shall be restored to its original condition.

1e. Shelters may be added to or deleted from this permit by requesting the Public Works Department Engineering Division in writing for permission. Individual changes shall conform to conditions 1a thru 1d.

2. Permittee, by acceptance of the benefits hereunder, acknowledges title to the property to be in the City of Riverside and waives any right to contest the validity of the dedication or grant.

3. Permittee acknowledges that the described property is the site of a proposed or planned public improvement and that, accordingly, all rights and privileges of use permitted shall cease and expire upon notice of revocation by the City. Upon the expiration or revocation, Permittee shall, within the time prescribed by the City, remove all improvements or obstructions placed, constructed or maintained by the Permittee. If the Permittee fails to abide by the removal order of the City within the time prescribed, the City shall have the right to remove and destroy the improvements without reimbursement to the Permittee and the cost of such removal shall be paid by the Permittee to the City of Riverside and shall constitute a debt owed to the City of Riverside.

4. Permittee, by acceptance hereof, waives the right of claim, loss, damage or action against the City of Riverside arising out of or resulting from revocation, termination, removal of the improvements or any action of the City of Riverside, its officers, agents or employees taken in accordance with the terms hereof.

5. Finding and determination by the City Council of the City of Riverside that the Permittee, or his heirs and assigns or successors in interest, are in default of the terms hereunder shall be cause for revocation.

6. Permittee herewith agrees to hold the City of Riverside harmless from and against all claims, demands, costs, losses, damages, injuries, action for damages and/or injuries, and liability growing or arising out of or in connection with the construction, encroachment, and/or maintenance to be done by Permittee or his agents, employees or contractors within the described property.

DATED: Sept. 24, 1985

CITY OF RIVERSIDE, a municipal corporation

By [Signature] Mayor

Attest [Signature] City Clerk

The foregoing is accepted by:

[Signature]
(Signature(s) of Permittee)

APPROVED AS TO CONTENT

[Signature]
Department Head

APPROVED AS TO FORM

[Signature]
City Attorney

CITY MANAGER APPROVAL

[Signature]
City Manager

UCR

APARTMENTS

WATKINS DRIVE

APARTMENTS

SITE* |

APARTMENTS

BIG SPRINGS RD.

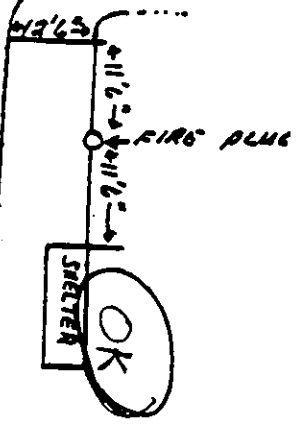

ANGEL'S RESTURANT

A
NORTH

EXHIBIT "A"
SHEET 1 OF 19

①

Winchell

AVE.

BANK OF AMERICA

P
North

SHEET 2 OF 19



University

THIRTY

Town Square Center

CHICAGO

Security Pacific Bank

Site 2

(2)

K-MART
ALBERTSONS

IOWA

↑ NORTH

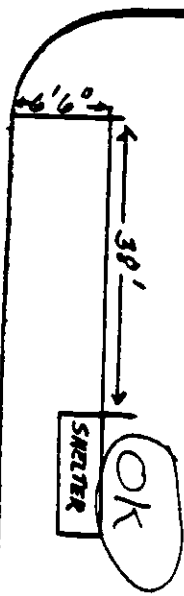

✓
SHEET 3 OF 19

BLAINE

SITE # 3

3

5A

ARLINGTON

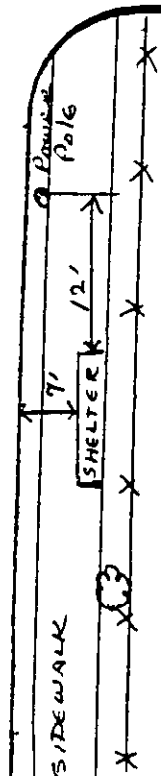

SHEET 4 OF 19

SEARS
PARKING LOT

ENTRANCE TO
SEARS

BANK OF
AMERICA

SITC & 5A



APTS.

CANYON CREST DRIVE

80
PRO
TRACE



CONCRETE
PAD -
EXISTING
STOP

SHELTER

SIDEWALK

62'9"

12'8"

ENTRANCE -
CANYON CREST
TOWNE CENTER

SITE #7

ALTERNATE LOCATION -
(REPLACEMENT FOR WHITE
PARK SITE)

CANYON CREST TOWN CENTER

CANYON CREST TOWN CENTER

✓
SHEET 5 OF 10

BANK OF AMERICA

ARLINGTON

STREET

BUS STOP SIGN

SIDEWALK

7' SHELTER



DEL TACO

STREET

8A

CALIFORNIA

22

14 TH

MARKET

SHE. TER

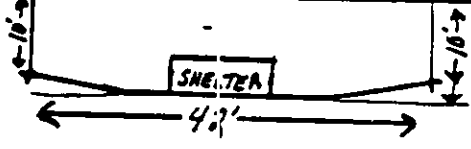

COMMUNITY HOSPITAL

OK IF back of shelter
is 10' from curb

SHEET 7 OF 19

(b)

RIVERSIDE
PLAZA

NORTH
↑

SUGGESTED SHELTER
LOCATION

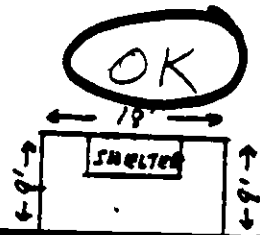

DE ANZA

SITING

BEAUTY

10

✓
SHEET 8 OF 19

SUNNYSIDE

DE ANZA

OK
SHELTER

20'

10'

PLAZA ENTRANCE ROAD

RIVERSIDE
PLAZA

North
↑

Site 11

11

✓
SHEET 9 OF 19

CENTRAL JR. HIGH

sidewalk is \approx 4' wide.
OK IF located adjacent
to sidewalk, NOT on
it.

Bus Stop Sign

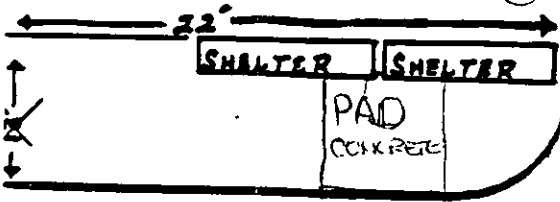

REQUIRES
PAD

MAGNOLIA

SITES #
12 & 13

RCC

(12)
(13)

TERRACINA

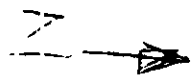
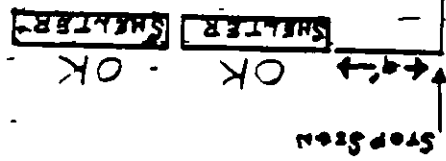

RCC

SHEET 10 OF 10

(160)

BARKER
BRO'S.

EXXON
STATION

14A

APR 19 1941

DEANZA

CROCKER
BANK
BLDG.

ARC
STATION

PARKING
LOT

15' 9"

SHELTER

BUS STOP SIGN

CENTRAL

ADULT HIGH SCHOOL
PARKING LOT

PROPOSED LOCATION,
BUT PERMISSION FROM
PROPERTY OWNER NEEDS
TO BE OBTAINED.

SHELTER

SHELTER

SIDEWALK

STREET RIGHT-OF-WAY

UNACCEPTABLE -
ADDS TO EXISTING
SIGHT DISTANCE PROBLEM

MAGNOLIA

SCHOOL CIRCLE

→ Z

MAGNOLIA

SITE 15A

15A

ALTERNATE LOCATION -
ADULT EDUCATION HIGH
SCHOOL - RECOMMENDED BY
TECHNICAL REVIEW BOARD

ADULT
EDUCATION
HIGH SCHOOL

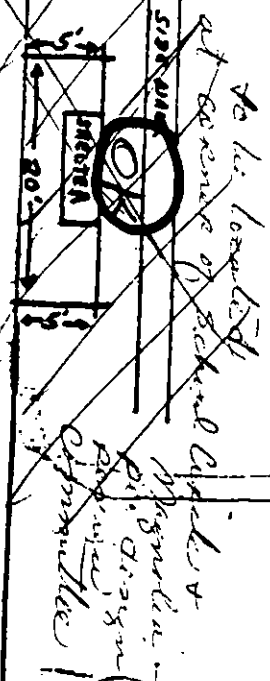

↑
NORTH

PICTURES (19) (20)

(21) (22) (23)

SHEET 13 OF 19

MASNOLIA

BROCKTON
ARCADE

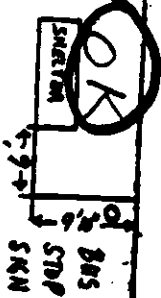

SITE # 16

~~16~~
(16)

PICTURES (23)(24)

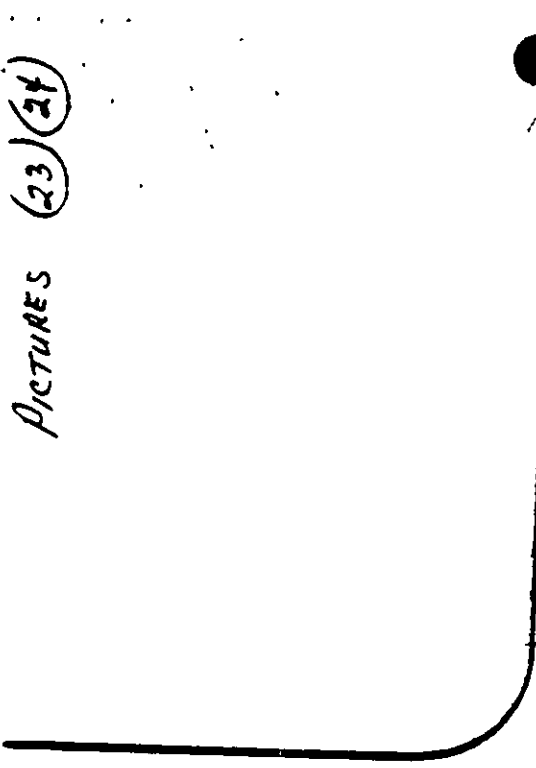

MALL SERVICE ROAD

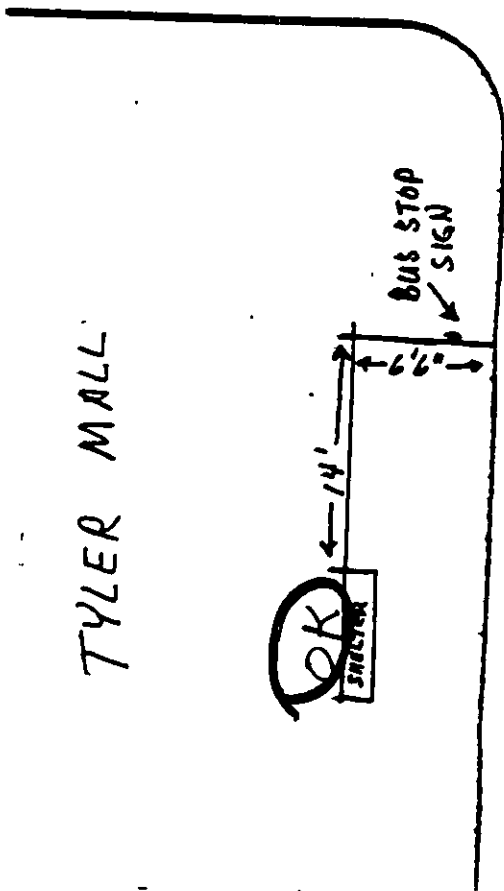

MAGNOLIA

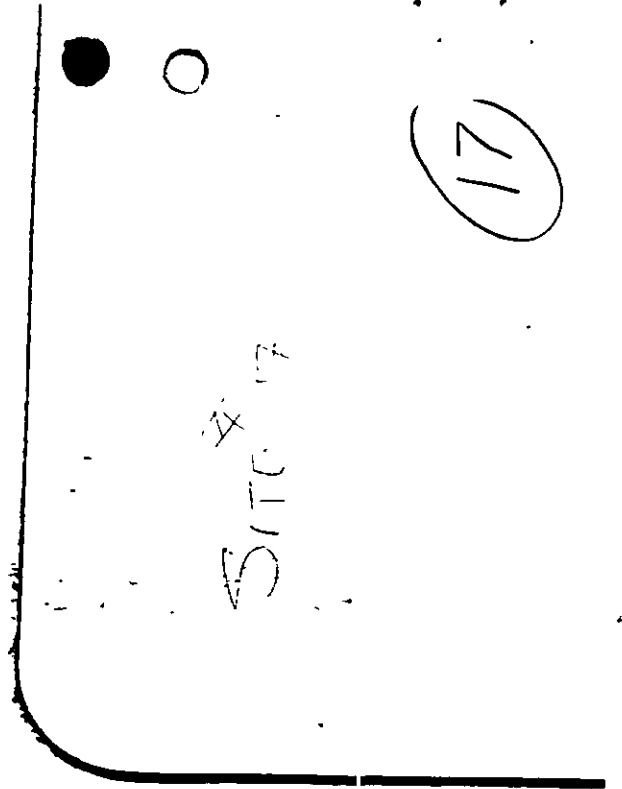

SERVICE ROAD

SITE # 17

(17)

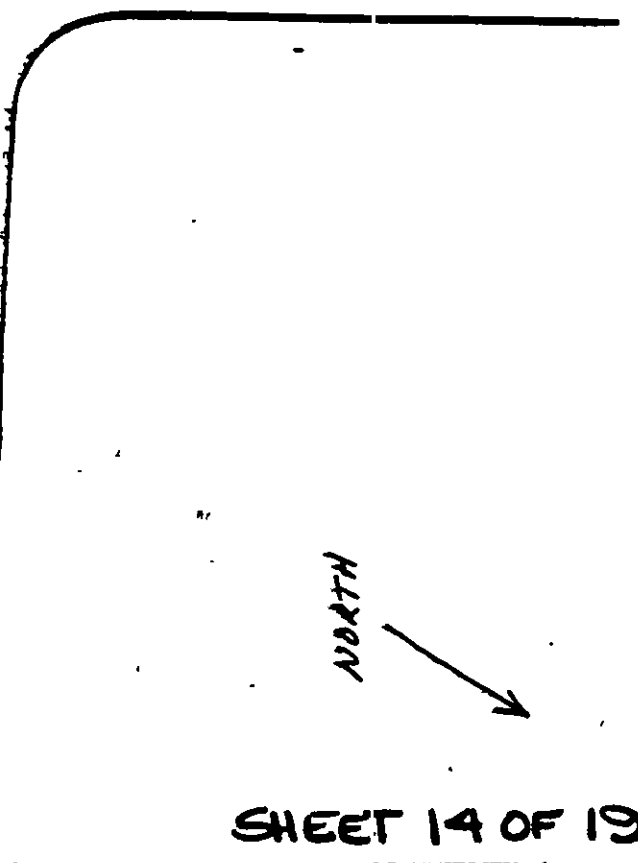

NORTH



MOBLEY AVE.

KRAZY
BREAD

7/11
MINI-MART

HOLE AVE.

70 feet east of
corner of fence.
(adjacent to driveway
into apt.)
Shelton

SMITH
70.53 15'

Block wall

CHURCH

NORTH
↑

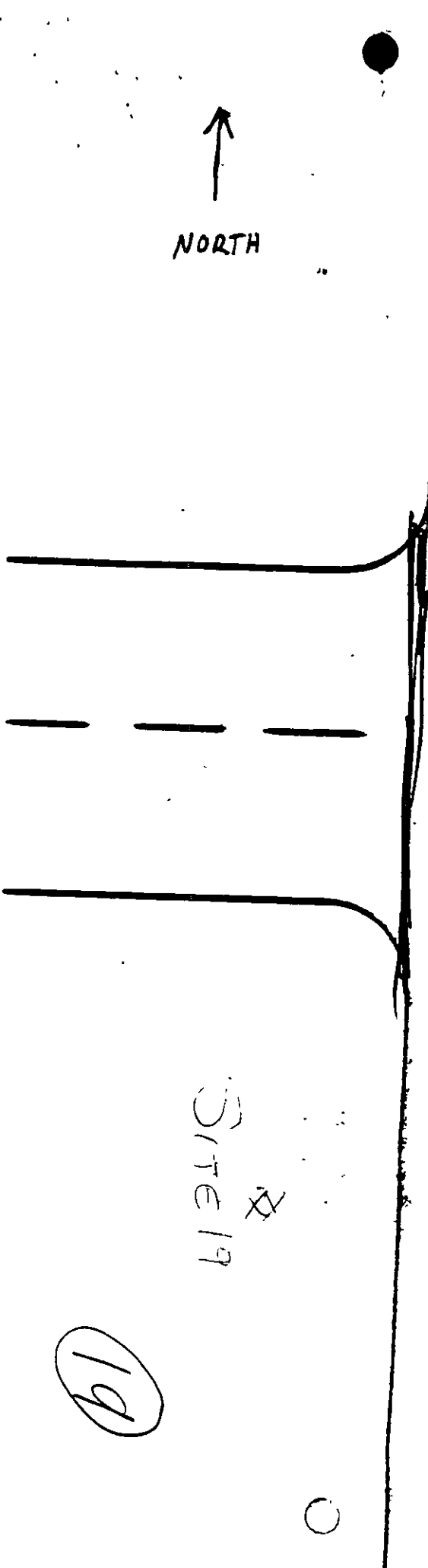

SITE 19

19

STAEETER

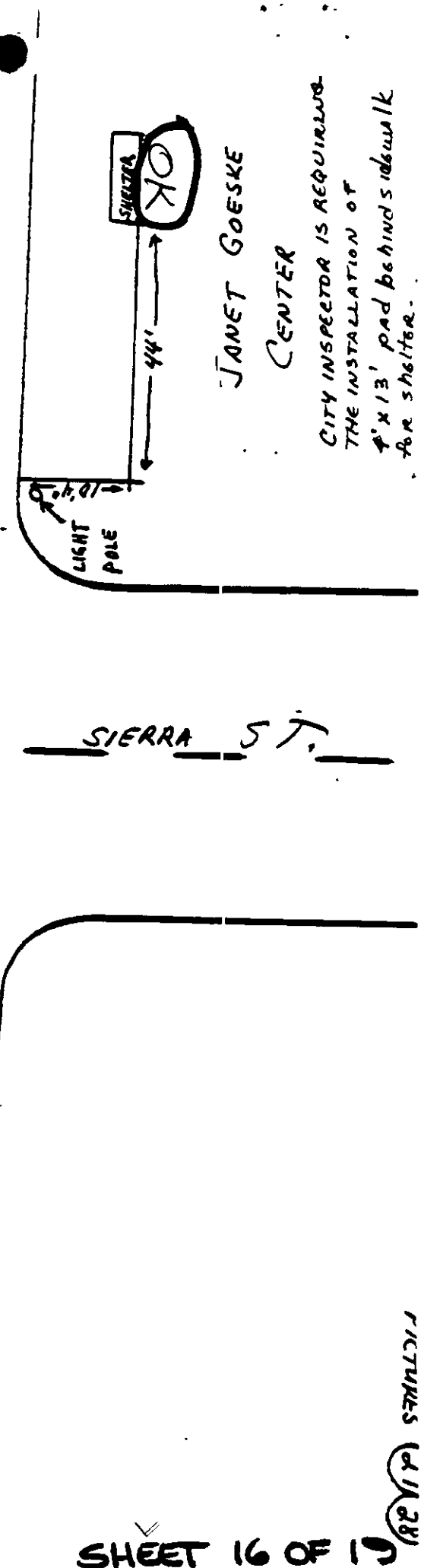

SIERRA
OK

44'

JANET GOESKE
CENTER

LIGHT
POLE

SIERRA ST.

CITY INSPECTOR IS REQUESTING
THE INSTALLATION OF
4'x13' pad behind sidewalk
for shelter.

PARK

OK IF this location

CITY INSPECTOR
REQUIRED THE
SHELTERS TO BE
MOVED BEHIND SIDEWALK

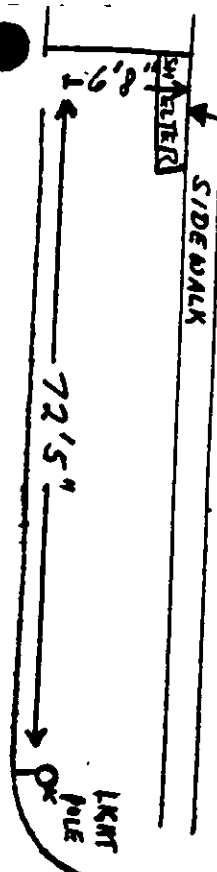

I GUESS IT
STARTS HERE.
I'LL CHECK
WITH RTA

PENNSYLVANIA

KANSAS

PICTURES (29) (30)

NORTH

SHEET 17 OF 19

SITE # 20

CHURCH

NO. SHEET(SHOW)

20

GENERAL
Hospital

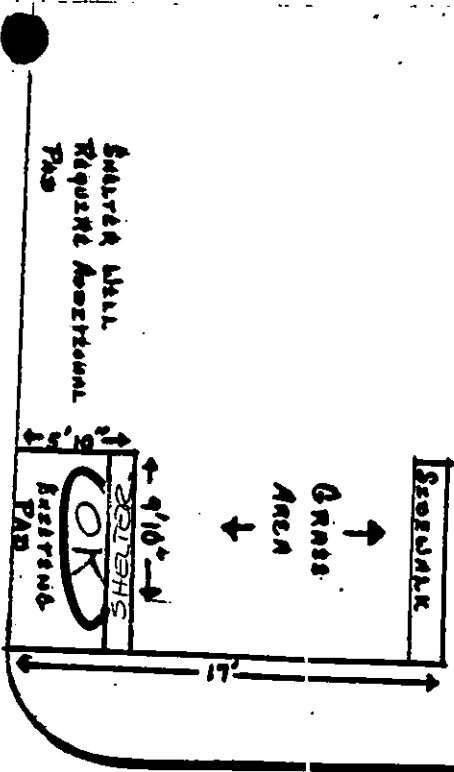

HARRISON

A
North

- PICTURES
- (37)
 - (32)
 - (33)
 - (34)
 - (31)
 - (36)

N. 2. CONC
WITH A 11. 2101
1111

Dimensioning
doesn't work

with new 36'
and radiuses,
the shells would
hang out over
curb face

SUBURBAN
BRIDGE
\$340000

HARRISON

MAN'S SIGN
TOP



will be
removed

MUIR

MAGNOLIA

Site #
21422

(21422)

RIVERSIDE
PLAZA

PARKING
LOT

FLOWER B&D
SHELTER

streetlights

tree

SITE # 23

RIVERSIDE
PLAZA

CENTRAL

CENTRAL

OK IF proposed location
will allow 4' of pedestrian
passage

North
↓

PICTURE

37

CONSIDER ALTERNATE SITE
This location is only
200 ft ± west of newly
constructed bus bay
opposite San Diego Ave.

23