

COUNTY OF RIVERSIDE, STATE OF CALIFORNIA
RIVERSIDE COUNTY FLOOD CONTROL AND WATER CONSERVATION DISTRICT

ENCROACHMENT PERMIT

City of Riverside
P. O. Box 826
Riverside, California 92501

Riverside, California

17 February, 19 70

Att: Mr. William D. Gardner
Chief Public Works Engineer

2 February, 19 70

In compliance with your request of _____ and subject to all the terms, conditions and restrictions written below or printed as general or special provisions on any part of this form

PERMISSION IS HEREBY GRANTED TO City of Riverside to construct a portion of "Southwest Industrial Sewer System" within La Sierra Storm Channel right of way between Pierce Street and La Sierra Avenue. Said installation shall be as per City of Riverside drawing No. S-762, Sheets 12D thru 17D, dated 1 January 1970 and accompanying specifications.

NOTE: The tops of all manholes within District R/W shall be placed a minimum of 3 inches below grade of maintenance road.

see pocket file for map

This permit is to be strictly construed and no work other than that specifically mentioned above is authorized hereby. Performance of the work shall be deemed to be acceptance by the Permittee of all terms and conditions of this permit.

This permit shall be void unless work herein contemplated shall have been completed before 1 July, 19 70

RECOMMENDED FOR APPROVAL:

APPROVED:

By s/K. L. Edwards
DESIGN
By s/M. William Holsinger
RIGHT OF WAY
By s/J. C. Vincent
PERMIT ENGINEER

s/John W. Bryant
JOHN W. BRYANT
CHIEF ENGINEER

*DWG No 1-160
S. No 27 to 37*

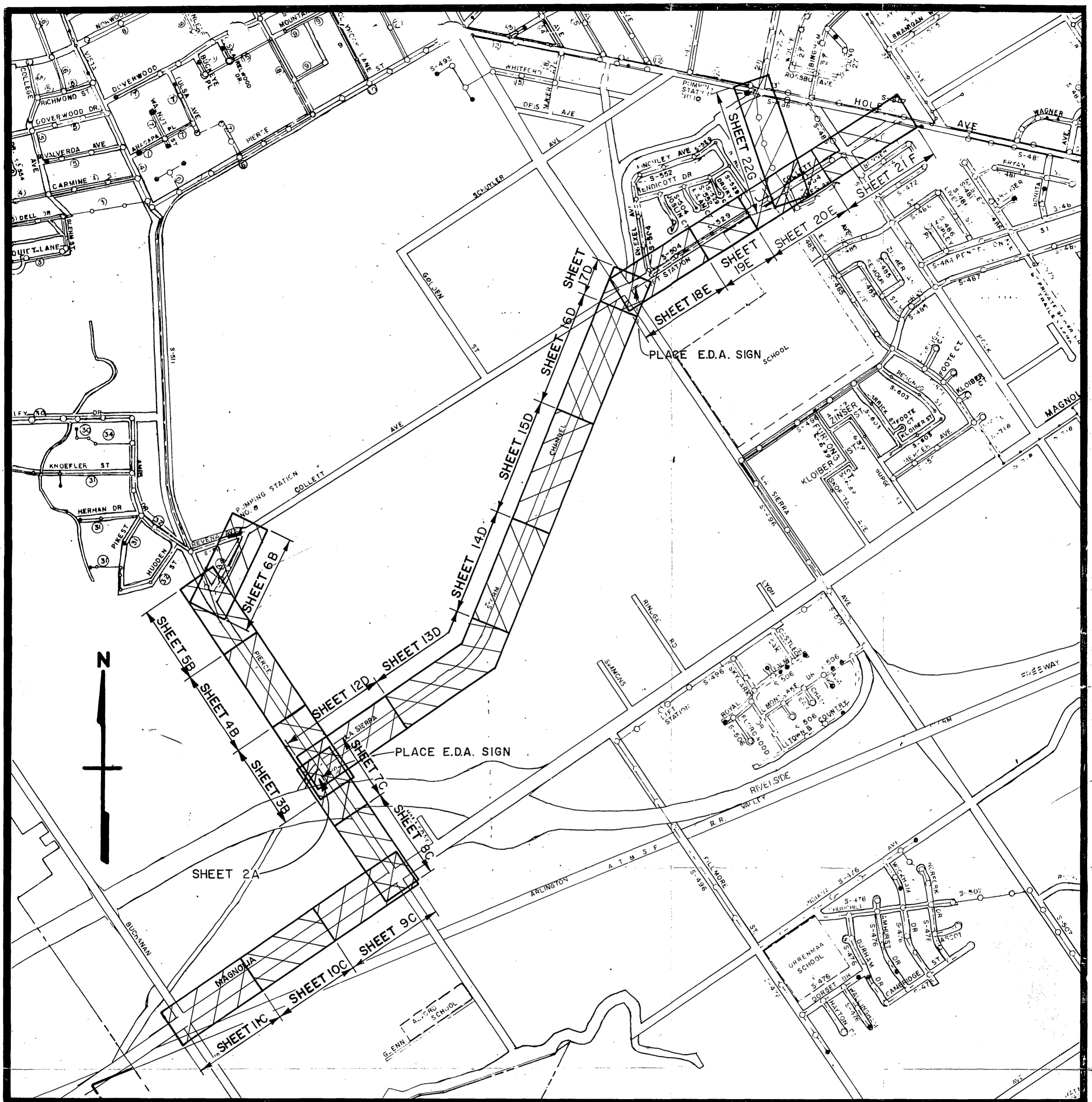

PROJECT LOCATION PLAN

