

Recording requested by:

DOCUMENTARY
TRANSFER TAX = \$0.00
NO CONSIDERATION

And when recorded, mail to:

SURVEYOR
City of Riverside
Public Works Department
3900 Main Street
Riverside, California 92522

2019-0334392

08/29/2019 08:56 AM

*****Customer Copy Label*****

The paper to which this label is affixed
has not been compared with the
filed/recorded document

Peter Aldana
County Of Riverside
Assessor-County Clerk-Recorder

FOR RECORDER'S OFFICE USE ONLY

Project: P19-0138
Por. APN: 226-332-022 & 023
Address: 6289 Palm Avenue

**LL-P19-0138
PARCEL A**

**NOTE TO COUNTY RECORDER:
DO NOT ACCEPT FOR RECORDING IF AN ADDITIONAL COVER SHEET IS ATTACHED.**

CITY OF RIVERSIDE
CERTIFICATE OF COMPLIANCE
FOR LOT MERGER

Property Owner(s): **Palm Ave. Storage, LLC, a California limited liability company**

Pursuant to Section 66412 of the Government Code of the State of California and Section 18.100 of the Riverside Municipal Code, a Certificate of Compliance for Lot Merger is hereby issued creating the **ONE (1)** parcel of real property located in the City of Riverside, County of Riverside, State of California, as described in **Exhibit "A"** attached hereto and incorporated herein by this reference, and which parcel complies with the California Subdivision Map Act and Title 18 of the Riverside Municipal Code.

THE ISSUANCE OF THIS CERTIFICATE OF COMPLIANCE DOES NOT SUPERSEDE, MODIFY OR AFFECT ANY REQUIREMENTS OF THE BUILDING OR ZONING REGULATIONS OF THE CITY OF RIVERSIDE.

CITY APPROVAL:

CITY OF RIVERSIDE
PUBLIC WORKS – SURVEY DIVISION

Curtis C. Stephens, L.S. 7519
City Surveyor



By: *Curtis C. Stephens* *8/22/19*
Curtis C. Stephens, L.S. 7519 Date

ACKNOWLEDGMENT

A notary public or other officer completing this certificate verifies only the identity of the individual who signed the document to which this certificate is attached, and not the truthfulness, accuracy, or validity of that document.

State of California
County of Riverside } ss

On August 22, 2019, before me, Teresa Sophia Maryanski,
notary public, personally appeared, Curtis C. Stephens

who proved to me on the basis of satisfactory evidence to be the person(s) whose name(s) is/are subscribed to the within instrument and acknowledged to me that he/she/they executed the same in his/her/their authorized capacity(ies), and that by his/her/their signature(s) on the instrument the person(s), or the entity upon behalf of which the person(s) acted, executed the instrument.

I certify under PENALTY OF PERJURY under the laws of the State of California that the foregoing paragraph is true and correct.

WITNESS my hand and official seal.

Teresa Sophia Maryanski

Notary Signature



EXHIBIT "A"

CITY OF RIVERSIDE

LOT MERGER NO. LL-P19-0138

Parcel A

The Northerly 100.00 feet of the Southerly 183.00 feet of the South three-quarters of the South-half of the Northeast quarter of the Northeast quarter of Section 33, Township 2 South, Range 5 West, San Bernardino Meridian, in the City of Riverside, Riverside County, California.

EXCEPTING THEREFROM the Easterly 40.00 feet, which is in Palm Avenue.

ALSO EXCEPTING THEREFROM that certain parcel of land as described in Grant of Easement recorded July 11, 2019 as Instrument No. 2019-0253832, of Official Records of said County.

Containing 2.89 acres, more or less.

This description was prepared by me or under my direction.

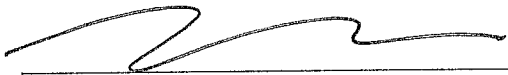

William Rohal L.S. 8805

Date 8-15-2019

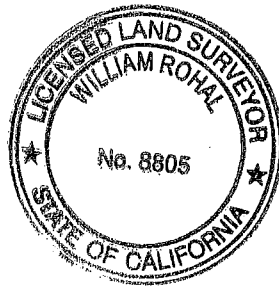

DESCRIPTION APPROVAL:

BY:  8/22/19
DATE

FOR: CURTIS C. STEPHENS, L.S. 7519
CITY SURVEYOR

