

OWNERS' CERTIFICATE

WE HEREBY CERTIFY THAT WE ARE THE ONLY PARTIES HAVING ANY RECORD, TITLE OR INTEREST IN THE LAND SUBDIVIDED AS SHOWN HEREON AND WE CONSENT TO THE PREPARATION AND RECORDATION OF THIS PARCEL MAP.

W. A. BUDD CORP., A CALIFORNIA CORPORATION

[Signature] VICE President
[Signature] Secretary

IN THE CITY OF RIVERSIDE, COUNTY OF RIVERSIDE, CALIFORNIA

PARCEL MAP 8798

SHOWING A DIVISION OF A PORTION OF LOT 4 OF EL GRANDE TRACT, AS SHOWN BY MAP ON FILE IN BOOK 5 AT PAGE 174 OF MAPS, RECORDS OF RIVERSIDE COUNTY, CALIFORNIA.

NOVEMBER 1976

HAWKINS ROBERTSON & ASSOC.
RIVERSIDE, CALIFORNIA.

SCALE 1"=60'

RECORDER'S CERTIFICATE

FILED ON THIS 14 DAY OF March, 1977, AT 3:50 P.M. IN BOOK 33 OF PARCEL MAPS AT PAGE 18, AT THE REQUEST OF THE CITY ENGINEER.

W. D. BALOGH, COUNTY RECORDER

BY *[Signature]* DEPUTY

SUB. GTEE FIRST AMERICAN TITLE INSURANCE CO.

FEE \$5.00

NO. 42294

SURVEYOR'S CERTIFICATE

THIS MAP WAS PREPARED BY ME OR UNDER MY DIRECTION AND IS BASED ON A FIELD SURVEY IN CONFORMANCE WITH THE REQUIREMENTS OF THE SUBDIVISION MAP ACT AT THE REQUEST OF RON FRITTS IN OCTOBER 1976. I HEREBY CERTIFY THAT IT CONFORMS TO THE APPROVED TENTATIVE MAP AND THE CONDITIONS OF APPROVAL THEREOF, THAT ALL PROVISIONS OF APPLICABLE STATE LAW AND LOCAL ORDINANCES HAVE BEEN COMPLIED WITH.

[Signature]
CURTIS E. HAWKINS, L.S. 3163

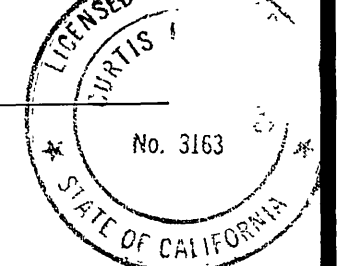

SURVEYOR'S NOTES

1. BEARINGS ARE BASED ON THE CENTER LINE OF INDIANA AVE. BEING N. 55° 59' 50" E. AS SHOWN BY MAP ON FILE IN BOOK 3 AT PAGE 93 OF PARCEL MAPS, RECORDS OF RIVERSIDE COUNTY, CALIF.
2. (O) INDICATES FOUND MONUMENTS AS NOTED.
3. (O) INDICATES SET 3/4" IRON PIPE AND PLASTIC PLUG STAMPED L.S. 3163, FLUSH, UNLESS OTHERWISE NOTED.
4. () INDICATES DISTANCES SHOWN ON EL GRANDE TRACT ON FILE IN BOOK 5 AT PAGE 174 OF MAPS, RECORDS OF RIVERSIDE COUNTY, CALIF., UNLESS OTHERWISE NOTED.

NOTARY ACKNOWLEDGEMENT

STATE OF CALIFORNIA } S.S.
COUNTY OF RIVERSIDE }

ON THIS 1st DAY OF March 1977, BEFORE ME the undersigned, NOTARY PUBLIC IN AND FOR SAID COUNTY AND STATE, PERSONALLY APPEARED R.E. Fritts known to me to be the Vice President, and Jean Krenzke known to me to be the Secretary of the CORPORATION THAT EXECUTED THE WITHIN INSTRUMENT ON BEHALF OF THE CORPORATION THEREIN NAMED AND ACKNOWLEDGED TO ME THAT SUCH CORPORATION EXECUTED THE WITHIN INSTRUMENT PURSUANT TO ITS BY-LAWS OR A RESOLUTION OF ITS BOARD OF DIRECTORS. WITNESS MY HAND AND OFFICIAL SEAL.

[Signature]
MY COMMISSION EXPIRES 3-20-78

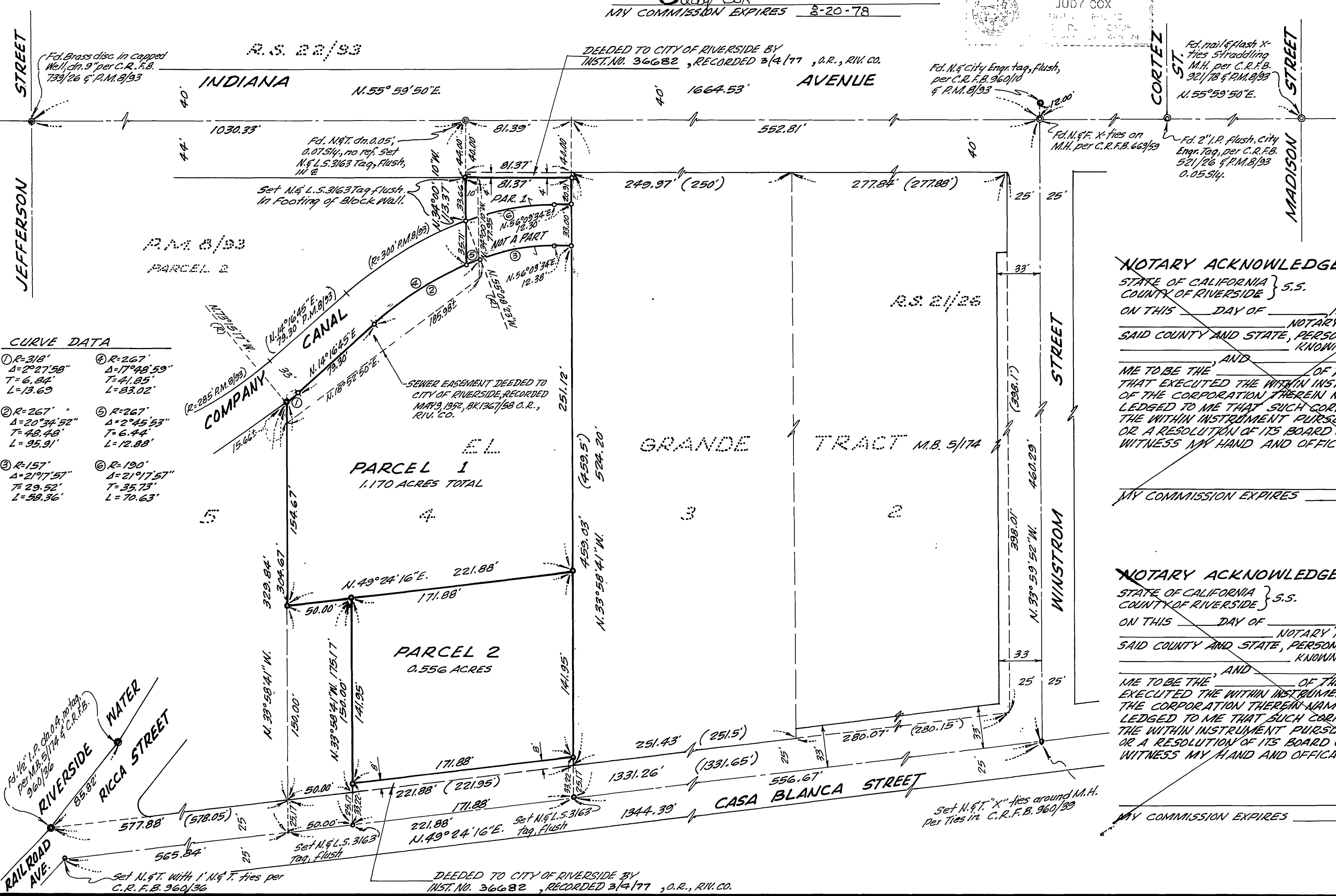
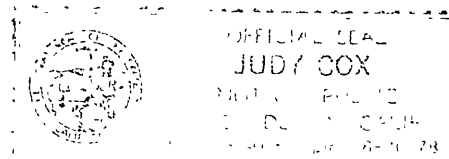

NOTARY ACKNOWLEDGEMENT

STATE OF CALIFORNIA } S.S.
COUNTY OF RIVERSIDE }
ON THIS ___ DAY OF ___ 1977, BEFORE ME ___ NOTARY PUBLIC IN AND FOR SAID COUNTY AND STATE, PERSONALLY APPEARED ___ KNOWN TO ME TO BE THE ___ AND ___ KNOWN TO ME TO BE THE ___ OF THE CORPORATION THAT EXECUTED THE WITHIN INSTRUMENT ON BEHALF OF THE CORPORATION THEREIN NAMED AND ACKNOWLEDGED TO ME THAT SUCH CORPORATION EXECUTED THE WITHIN INSTRUMENT PURSUANT TO ITS BY-LAWS OR A RESOLUTION OF ITS BOARD OF DIRECTORS. WITNESS MY HAND AND OFFICIAL SEAL.

CITY ENGINEER'S CERTIFICATE

THIS MAP HAS BEEN EXAMINED THIS 14th DAY OF March 1977, FOR CONFORMANCE WITH THE REQUIREMENTS OF THE SUBDIVISION MAP ACT AND TITLE 18 OF THE RIVERSIDE MUNICIPAL CODE.
JAMES F. MARTINEK, R.C.E. 8134
CITY ENGINEER

BY *[Signature]*
TENTATIVE MAP APPROVED NOVEMBER 18, 1976.

UTILITIES CERTIFICATE

I HEREBY CERTIFY AS FOLLOWS:
WATER FACILITIES
ALL FRONTAGE FEES AND ACREAGE FEES HAVE BEEN PAID ON PARCELS NO. 1 AND PARCEL NO. 2.
ELECTRIC FACILITIES
NO ELECTRIC FEES REQUIRED.

EASEMENTS
ALL PUBLIC UTILITY EASEMENTS SHOWN ARE SUFFICIENT FOR ALL REQUIREMENTS OF WATER AND ELECTRIC DIVISIONS OF THE DEPARTMENT OF PUBLIC UTILITIES OF THE CITY OF RIVERSIDE.

EVERETT C. ROSS
DIRECTOR OF PUBLIC UTILITIES

DATE: 3-10-77 BY: *[Signature]*

SIGNATURE OMISSION

UNDER THE PROVISIONS OF SECTION 66436 OF THE SUBDIVISION MAP ACT, THE FOLLOWING SIGNATURE HAS BEEN OMITTED:

AN EASEMENT FOR SENIER PURPOSES, IN FAVOR OF THE CITY OF RIVERSIDE, IN INSTRUMENT RECORDED MAY 9, 1952, IN BOOK 1367 AT PAGE 58 OF OFFICIAL RECORDS OF RIVERSIDE COUNTY, CALIFORNIA.

PM. 33/18

PM. 33/18