

SPECIFIC CONSTRUCTION NOTES

1 ABANDON EXISTING SEWER IN PLACE

2 EXISTING SEWER TO REMAIN IN SERVICE.

NUMBERS ABOVE 100 IN A HEXAGON ON THE PLAN REFER TO THE RESPECTIVE STANDARD DRAWING AND SHALL BE CONSTRUCTED ACCORDINGLY. UNLESS MODIFICATIONS ARE NOTED ON THE PLAN OR COVER SHEET. ANY NUMBER SHOWN BELOW THE STANDARD DRAWING NUMBER INDICATES THE SPECIFIC ALTERNATE TO BE CONSTRUCTED.

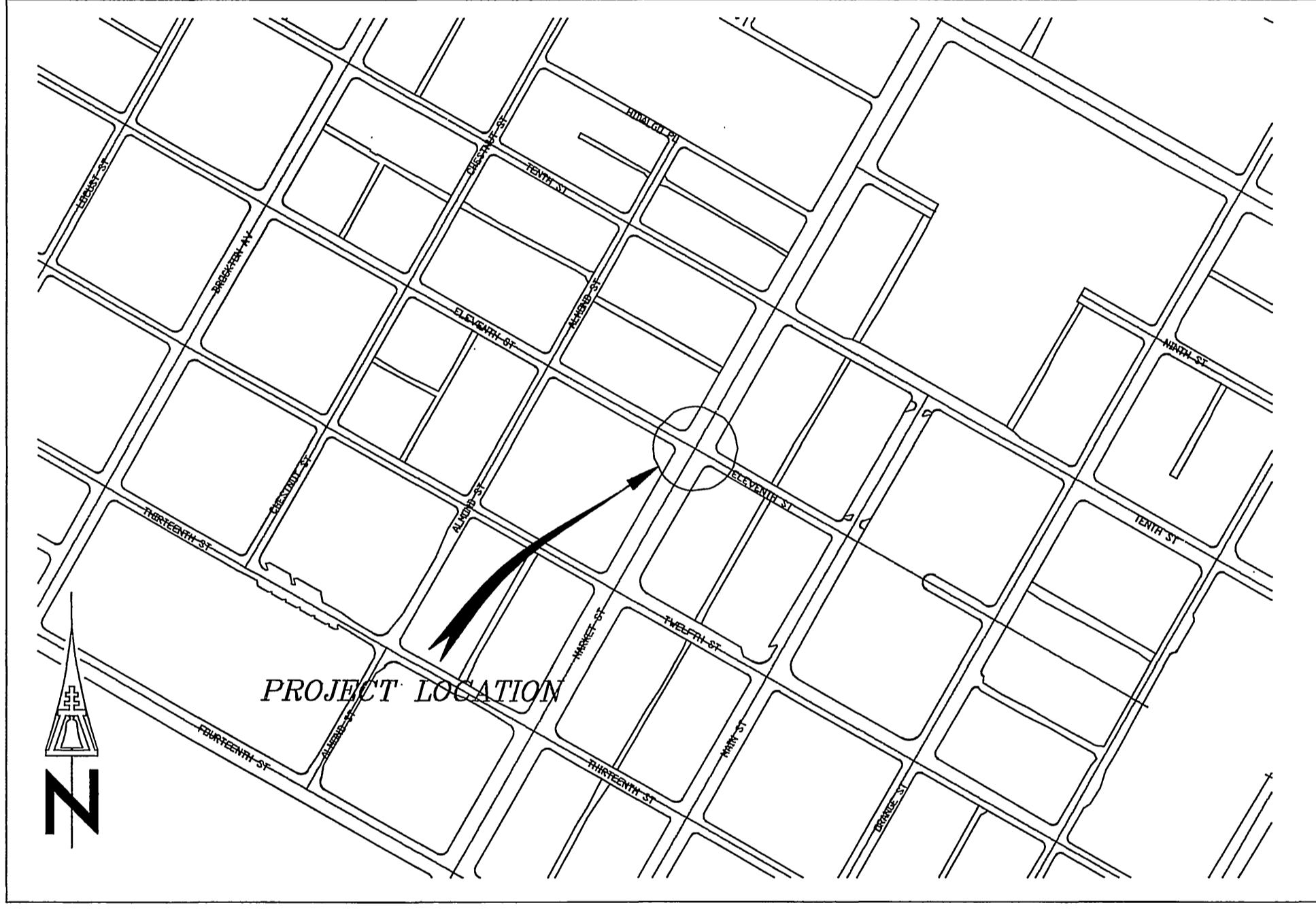

PROJECT LOCATION MAP
NTS

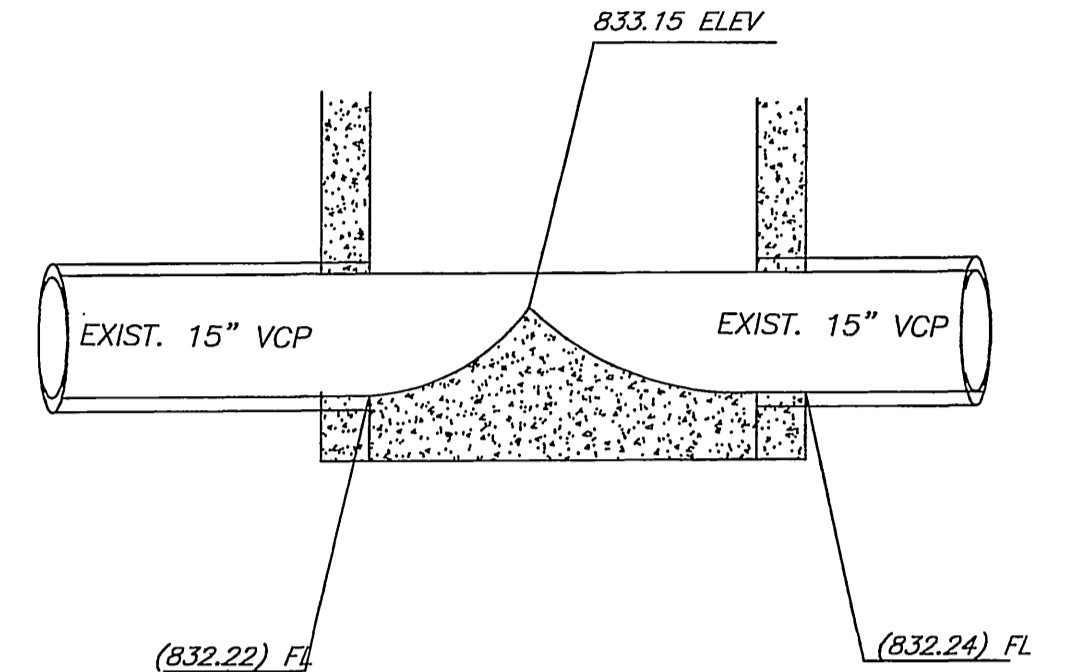
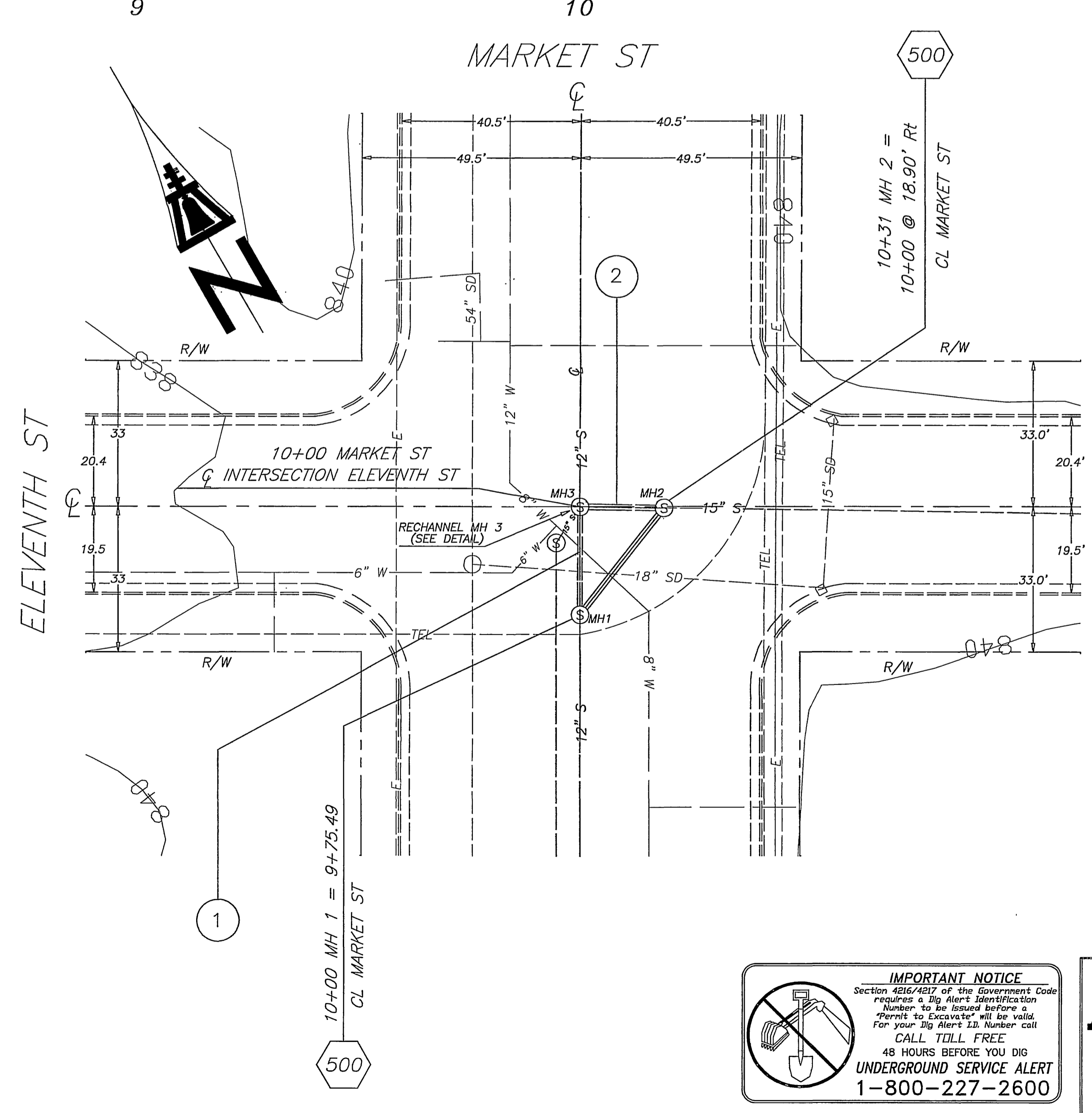

SECTION A-A

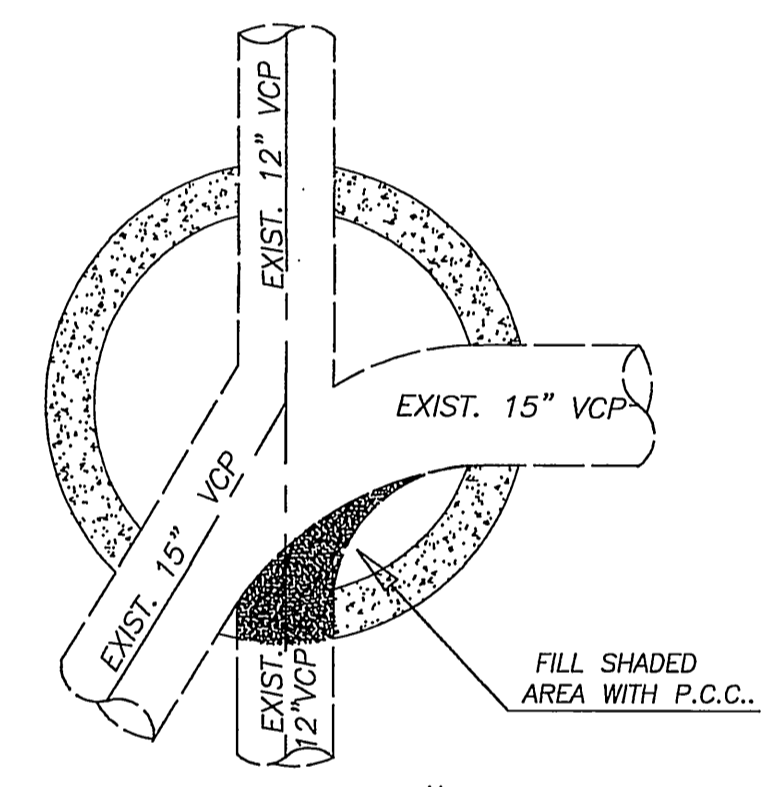

MANHOLE #3
CHANNEL DETAIL
SCALE: 1" = 4'

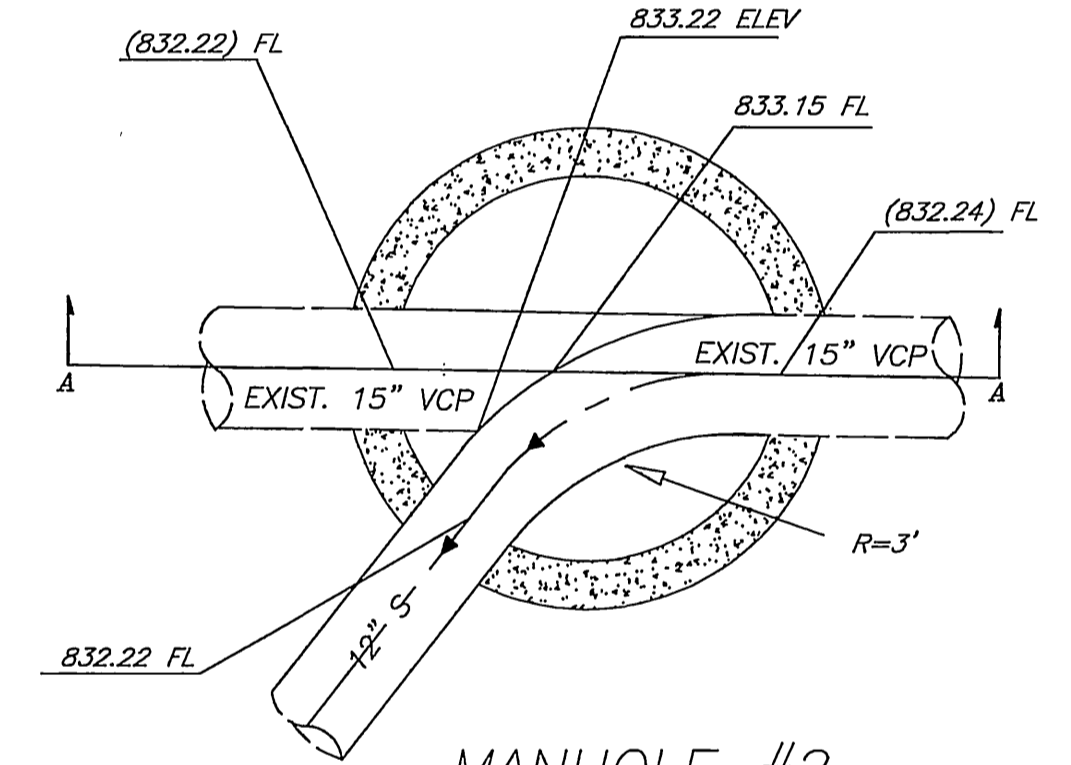

MANHOLE #2
CHANNEL DETAIL
SCALE: 1" = 4'

BENCHMARK
16-13 P.K. NAIL IN THE TOP OF CURB ALONG TENTH STREET 12 FEET SOUTHEASTERLY OF THE CURBRETURN AT THE MOST SOUTHERLY CORNER OF TENTH STREET AND MARKET STREET.
ELEV- 840.914

*AS-BUILT 1-11-06 LHM

IMPORTANT NOTICE
Section 4816.007 of the Government Code requires a Dig Alert Identification Number to be issued before a permit to excavate will be valid. For your Dig Alert ID Number call CALL TOLL FREE 48 HOURS BEFORE YOU DIG UNDERGROUND SERVICE ALERT 1-800-227-2600

ENGINEER IN RESPONSIBLE CHARGE
Lauren F. Caldwell
LAUREN F. CALDWELL
R.C.E. No. 39441 expires 12/31/05
DATE 2/26/04



MARK	REVISIONS	APPR.	DATE
DESIGNED BY	MLAMPING	DRAWN BY	MLAMPING
CHECKED BY			

CITY OF RIVERSIDE, CALIFORNIA
PUBLIC WORKS DEPARTMENT

APPROVED BY	BY	DATE	APPROVED BY
PRINCIPAL ENGINEER	<i>[Signature]</i>	2/26/04	<i>[Signature]</i>
INSPECTOR	<i>[Signature]</i>	2/26/04	<i>[Signature]</i>
SURVEYOR	<i>[Signature]</i>	2/26/04	<i>[Signature]</i>

DATE 2/26/04

MARKET AND 11TH STREETS
SEWER

HORIZONTAL SCALE: 1" = 20' VERTICAL SCALE: 1" = 4'

ACCT. NO. 976682303-440301XX
S-1823
SHEET 1 OF 1

INDEXED 7-15-04 LHM