

GENERAL CONSTRUCTION NOTES:

- 1 THE CONTRACTOR SHALL PROVIDE AND MAINTAIN TRAFFIC AS INDICATED IN THE ASSOCIATED PROJECT SPECIAL PROVISIONS.
- 2 CONSTRUCTION SHALL BE IN ACCORDANCE WITH THE CITY OF RIVERSIDE STANDARD DRAWINGS AND STANDARD SPECIFICATIONS FOR PUBLIC WORKS CONSTRUCTION, 2012 EDITION.
- 3 EXISTING UTILITIES SHOWN ON THIS PLAN ARE PLOTTED FROM UTILITY RECORDS. THE CONTRACTOR IS REQUIRED TO TAKE DUE PRECAUTIONARY MEASURES TO LOCATE AND PROTECT ALL UTILITIES WHETHER OR NOT SHOWN ON THIS PLAN.
- 4 CONFLICTING UTILITIES SHOWN WITHIN CONSTRUCTION AREA WILL BE RELOCATED PRIOR TO CONSTRUCTION.
- 5 ALL STREET PULL BOXES, GATE VALVES, MANHOLES, ETC, AFFECTED BY CONSTRUCTION, SHALL BE ADJUSTED TO THE PROPOSED GRADE.
- 6 PRIME CONTRACTOR BIDDING THIS WORK SHALL HAVE A CLASS "C-8" OR CLASS "A" LICENSE.
- 7 THE SEAM BETWEEN PASSES OF THE AC OVERLAY SHALL COINCIDE, AS CLOSE AS POSSIBLE, TO THE LANE LINES.
- 8 COLD MILLING SHALL BE AS DESCRIBED ON THE PLANS AND SPECIAL PROVISIONS OR AS DIRECTED BY THE ENGINEER.
- 9 ANY DISTRESSED EXISTING PAVEMENT SHALL BE REMOVED AND REPLACED AS DIRECTED BY THE ENGINEERING AFTER COLD-MILLING AND PRIOR TO PLACEMENT OF DGAC.
- 10 CONTRACTOR SHALL REMOVE ALL VEGETATION WITHIN ALL SIDEWALK PANELS WITHIN THE PROJECT LIMITS.
- 11 ALL EXISTING IMPROVEMENTS INCLUDING, BUT NOT LIMITED TO, CURB, GUTTERS, CROSS GUTTERS, SIDEWALK, DRIVEWAYS, PARKWAY CULVERTS, INLETS, ETC, SHALL BE PROTECTED IN PLACE UNLESS OTHERWISE NOTED.
- 12 EXISTING IRRIGATION SHALL BE PROTECTED OR MODIFIED, INCLUDING FURNISHING NEW MATERIALS, AS NECESSARY TO CONSTRUCT NEW CONCRETE IMPROVEMENTS.
- 13 ALL FENCE POSTS SHALL BE PROTECTED OR MODIFIED AS NECESSARY IF POST FOUNDATION IS WITHIN A SIDEWALK PANEL THAT HAS BEEN CALLED OUT FOR REPLACEMENT.
- 14 FOR ALLEY WAY DRIVEWAY APPROACHES, CONTRACTOR SHALL CONSTRUCT AC PAVEMENT OVERLAY BEHIND DRIVEWAYS TO PROVIDE ADEQUATE FLOW LINES.
- 15 ADEQUATE FLOW LINES SHALL BE MAINTAINED AT ALL LOCATIONS.

RIVERSIDE

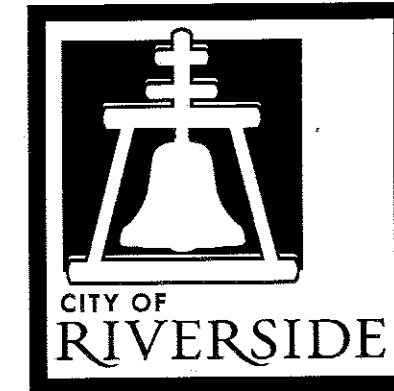

CALIFORNIA

**PUBLIC WORKS DEPARTMENT
SELKIRK AVENUE
STREET IMPROVEMENTS**

CONSTRUCTION NOTES:

- REMOVE AND REPLACE IN KIND EXISTING FACILITY. NUMBERS ABOVE 100 IN A HEXAGON ON THE PLAN REFER TO THE RESPECTIVE STANDARD DRAWING AND SHALL BE CONSTRUCTED ACCORDINGLY. ANY NOTE SHOWN BELOW THE STANDARD DRAWING NUMBER INDICATES THE SPECIFIC TYPE, ACTION, OR MODIFICATION TO BE CONSTRUCTED. DIMENSIONS OF NEW FACILITY SHALL BE MODIFIED AS NECESSARY, EXCLUDING ADA REQUIREMENTS, TO MATCH EXISTING FACILITY REMOVED.
- ADJ ADJUST TO GRADE, DESCRIPTION PER PLAN (---):
(GV) GATE VALVE. (WMB) WATER METER BOX, REPLACE ALL EXISTING PLASTIC WATER METER BOXES WITH CONCRETE BOXES SUPPLIED BY THE CITY PER SPECIAL PROVISIONS. CONTRACTOR IS RESPONSIBLE FOR OBTAINING FURNISHED ITEM FROM CITY YARD
- PIP PROTECT IN PLACE, DESCRIPTION PER PLAN (---):
(C&G) CURB AND GUTTER. (PP) POWER POLE. (GUY) GUY WIRE. (FH) FIRE HYDRANT. (CLF) CHAIN LINK FENCE. (WLL) WALL. (SL) STREET LIGHT POLE. (WM) WATER METER. (WLK) SIDEWALK. (GAS) UNDERGROUND GAS LINE. (MB) MAILBOX.
- REM REMOVE AND DISPOSE EXISTING, DESCRIPTION PER PLAN (---):
(BSH) BUSH. (RCK) ROCKS. (TREE) REMOVE TREE AS PART OF CLEARING AND GRUBBING. (T1) CLASS I TREE AND ROOTS.
- REL RELOCATE EXISTING TO PROPOSED LOCATION, DESCRIPTION PER PLAN (---):
(MB) MAILBOX. (CLF) REMOVE EXISTING AND REPLACE WITH NEW CHAIN LINK FENCE, RELOCATE TO PROPERTY LINE, INCLUDES SWINGING AND SLIDING GATES. (SNG) TRAFFIC SIGN.
- 200 CONSTRUCT CURB AND GUTTER PER CITY STD 200, CURB TYPE 1
- 302 CONSTRUCT DRIVEWAY PER CITY STD 302, TYPE CURB-1, WITH 2.5 FOOT APPROACH GRADE PER (---)
- 325 CONSTRUCT SIDEWALK PER CITY STD 325, PROVIDE 3' BY 3' CONTROL JOINTS AT ALL UTILITY POLE AND STREET LIGHT POLE LOCATIONS, WITH THE FOLLOWING TYPE OR MODIFICATION (---):
(CRB) = CONSTRUCT CURB SIDEWALK.
- RET CONSTRUCT PCC RETAINING CURB, POURED MONOLITHIC AT BACK OF SIDEWALK, INCLUDES HEIGHTS UP TO 18".
- PAV 6.5" DENSE GRADED ASPHALT CONCRETE (DGAC) OVER 95 PERCENT COMPACTED NATIVE.
- CM2 0.12' DEEP MINIMUM DEPTH COLD MILL OF EXISTING AC PAVEMENT.
- OL 0.12' MIN. DEPTH DENSE GRADED ASPHALT CONCRETE (DGAC) PAVEMENT OVERLAY.
- TRM TRIM OR GRIND EXISTING AS PART OF CLEARING AND GRUBBING, DESCRIPTION PER PLAN (---):
(BSH) TRIM BUSH. (TREE) TRIM TREE. (ROOT) GRIND TREE ROOTS.

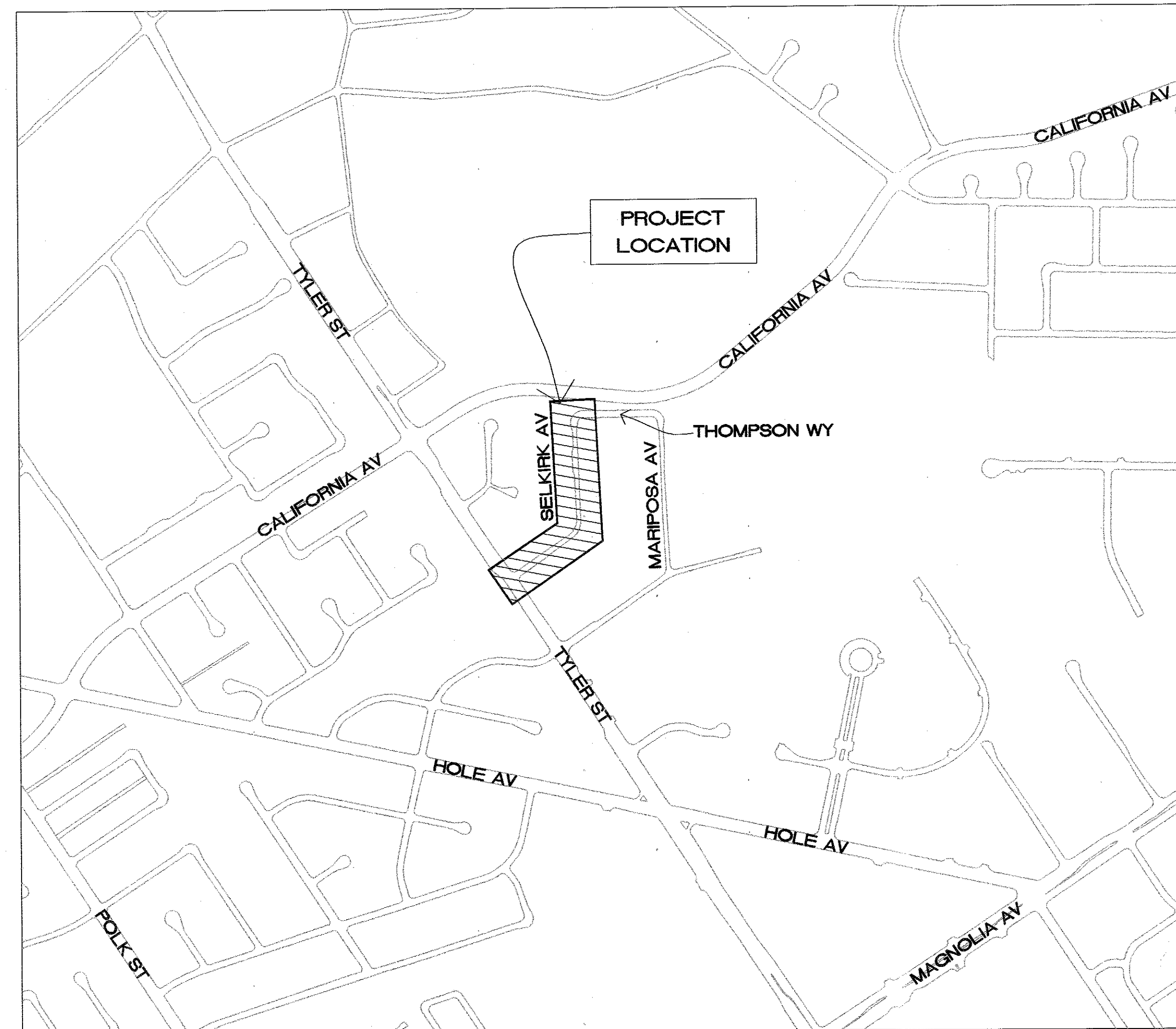

SHEET INDEX

| SHEET NO. | SHEET NAME (LIMITS) |
|-----------|------------------------|
| 1. | TITLE SHEET AND NOTES. |
| 2. | PLAN AND PROFILE |

LEGEND:

| | | | |
|--|--------------|--|--|
| | PROPOSED PCC | | EXISTING PCC |
| | PROPOSED AC | | COLDMILL TYPE CM1 (0.12') & DGAC OVERLAY (0.12') |

EXISTING TOPOGRAPHY:

- Sanitary Sewer M.H.
- Storm Drain M.H.
- Electric M.H.
- Water M.H.
- Power Pole with Mounted Street Light Mast Arm
- Gate Valve
- Electrical Test Station (Gas)
- Fire Hydrant

**LOCATION MAP
NTS**

- LEGEND**
- PROJECT LOCATION

Under Ground Service Alert of Southern California
Call: TOLL FREE 1-800-227-2600
TWO WORKING DAYS BEFORE YOU DIG

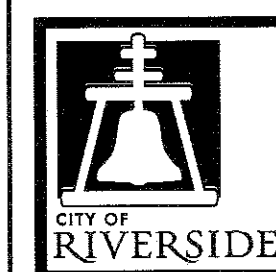

ENGINEER IN RESPONSIBLE CHARGE
Swetaben C. Patel
R.C.E. No. 72032 EXPIRES: 6-30-20

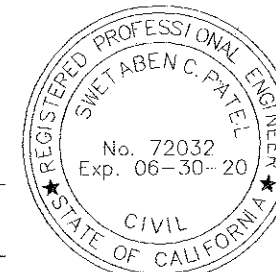

| MARK | REVISIONS | APPR. | DATE |
|-------------|-----------|----------|------|
| | | | |
| DESIGNED BY | AR | DRAWN BY | AR |
| CHECKED BY | SP | | |

**CITY OF RIVERSIDE, CALIFORNIA
DEPARTMENT OF PUBLIC WORKS**

| APPROVED BY | BY | DATE | APPROVED BY |
|---------------------|------|---------|-------------|
| ENGINEERING MANAGER | F.M. | 5/25/18 | |
| CONSTRUCTION ADMIN. | D.H. | 5/29/18 | |
| TRAFFIC DIVISION | R.H. | 5-18-18 | |
| STREETS DIVISION | | | |
| SURVEY | CS | 5/31/18 | |

**SELKIRK AVENUE
STREET IMPROVEMENTS**

TITLE SHEET AND NOTES

HORIZ. SCALE: VERT. SCALE:

AS BUILT - 03-21-2019

DESIGN WORK ORDER NO: 1813241
CONSTR. WORK ORDER NO: 1830943

R-4417

SHEET 1 OF 2

FILE NAME:

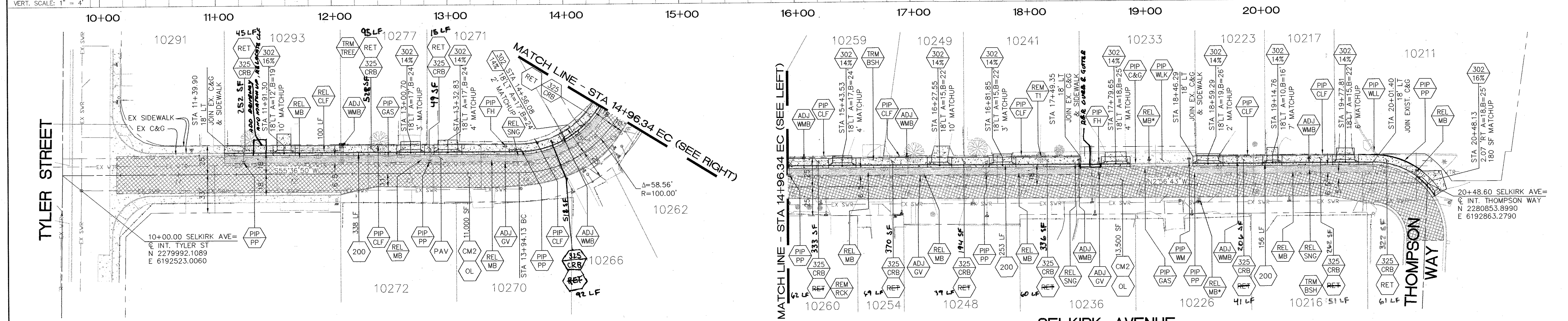
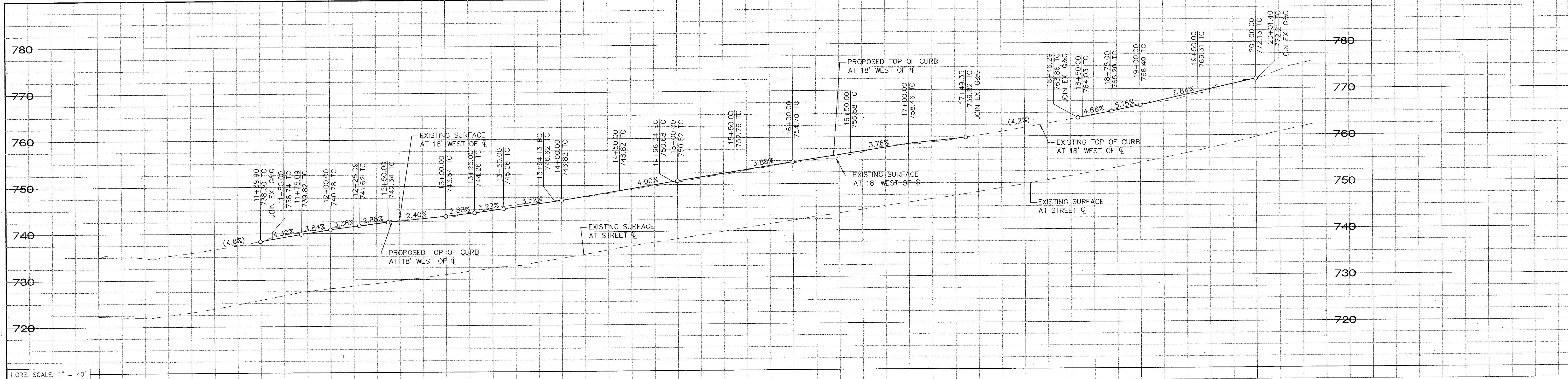

SELKIRK AVENUE

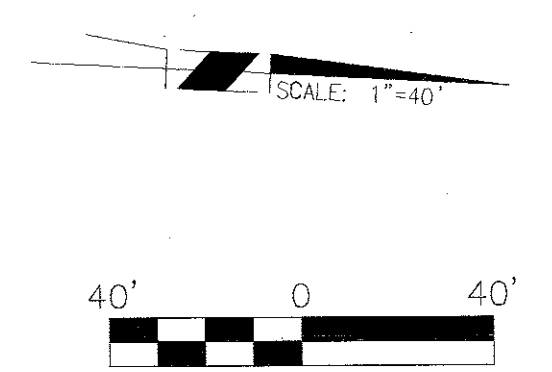
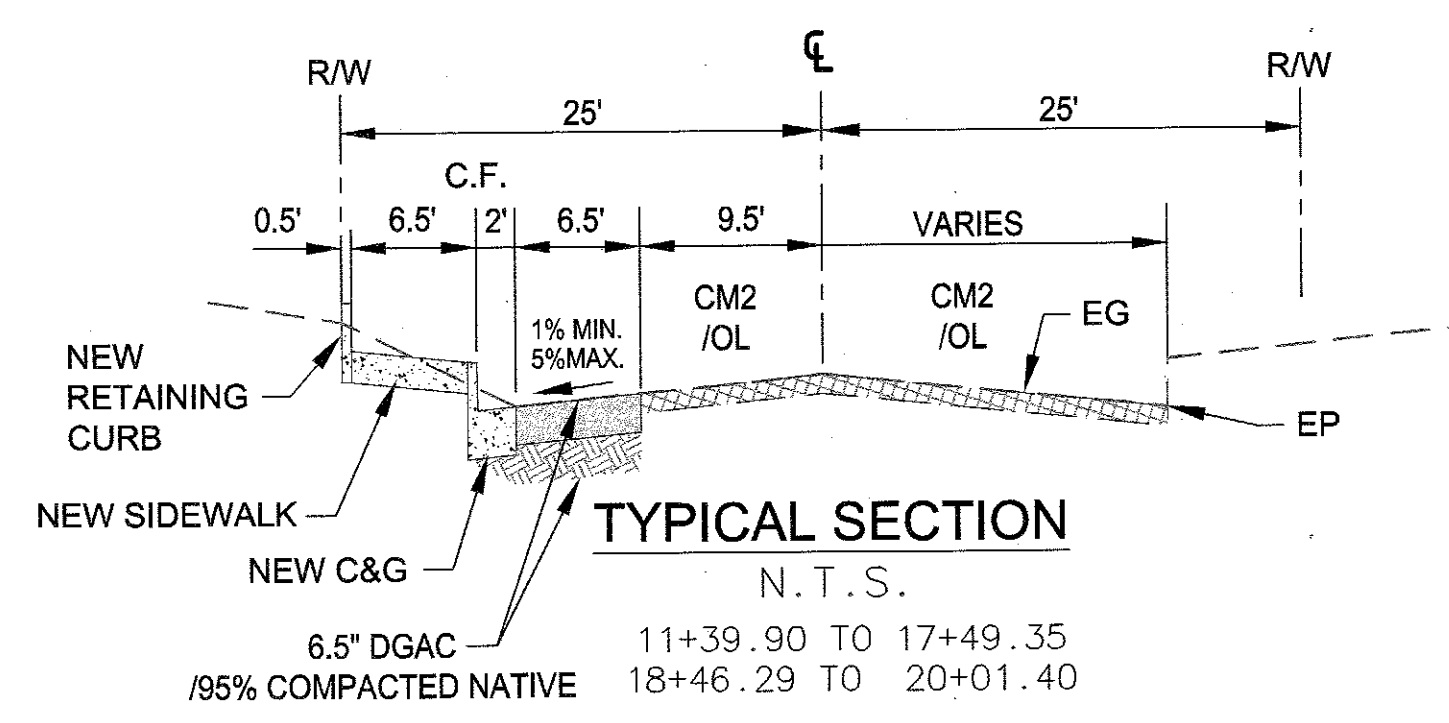
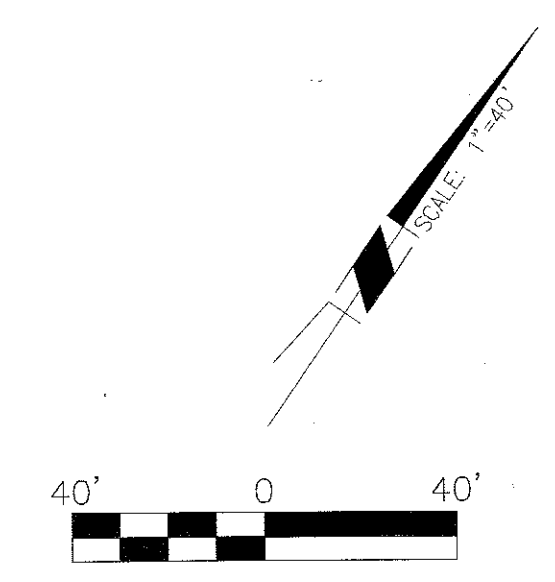

AG BUILT - 03-21-2019
 *CONTRACTOR TO COORDINATE WITH HOME OWNER FOR MAILBOX LOCATION.

Under Ground Service Alert of Southern California
 Call: TOLL FREE 1-800-227-2600
 TWO WORKING DAYS BEFORE YOU DIG

ENGINEER IN RESPONSIBLE CHARGE
 Swelaben C. Patel
 R.C.E. No. 72032 EXPIRES: 6-30-20

DESIGNED BY: AR DRAWN BY: AR CHECKED BY: SP

CITY OF RIVERSIDE, CALIFORNIA DEPARTMENT OF PUBLIC WORKS
 APPROVED BY: [Signature] DATE: 5/31/18
 CONSTRUCTION ADMIN. DATE: 5/29/18
 TRAFFIC DIVISION DATE: 5/26/18
 SURVEY DATE: 5/30/18

SELKIRK AVENUE STREET IMPROVEMENTS
 PLAN AND PROFILE
 R-4417
 SHEET 2 OF 2
 FILE NAME: R-4417-02.DWG