

Profile Scale: Horiz. 1"=40'
Vert. 1"=4'

Plan Scale: 1"=40'

GENERAL NOTES

1. Bench Mark: P.K. Nail in N.E. Corner of Sierra Vista & College Ave. Plan City R.D. 7052. Elevation 755.50 (City Datum)
2. All work shall be done in accordance with these Plans, Standard Specifications No. 601, and the Standard Drawings of the City of Riverside, Dept. of Public Works.
3. It shall be the responsibility of the contractor to clear the right-of-way in accordance with the provisions of the law, as it affects each utility, including irrigation lines and appurtenances and all as set to the City.
4. Prime coat, Joint Sealer, and Seal Coat are required.
5. The Developer will take a soil test to determine the requirement in impervious base material, after the streets have been prepared to rough grade.
6. Grading will require a permit under Ordinance No. 3093 for a curb or fill exceeding 100 cu. yds. or a fill over one foot in depth.

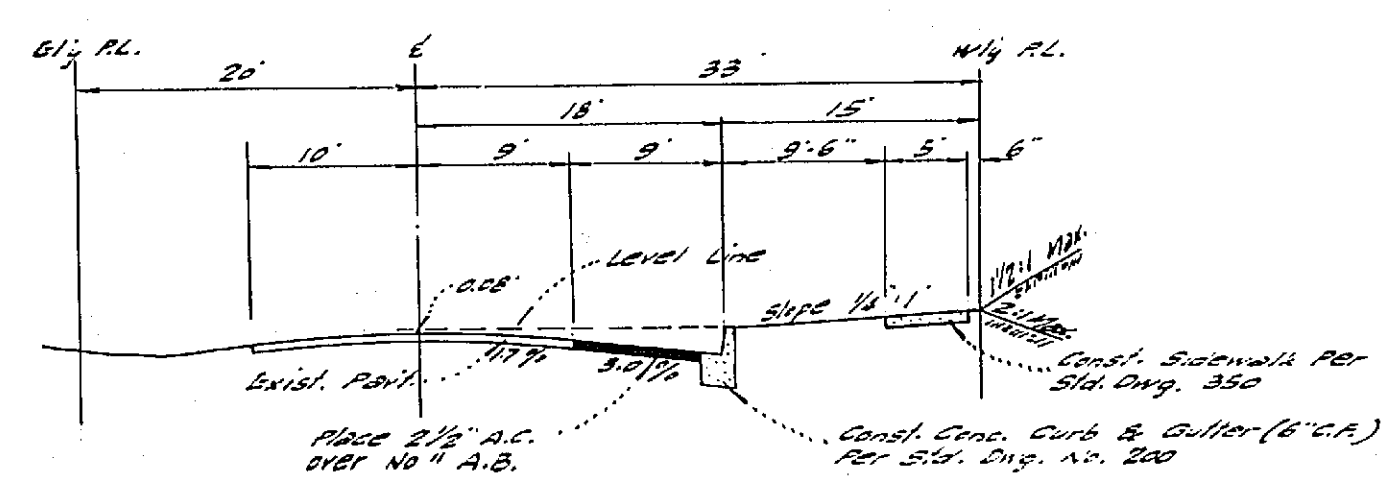

**TYPICAL SECTION AT STA. 2+71.02
WALNUT AVENUE
T.I. 5.0
NO SCALE**

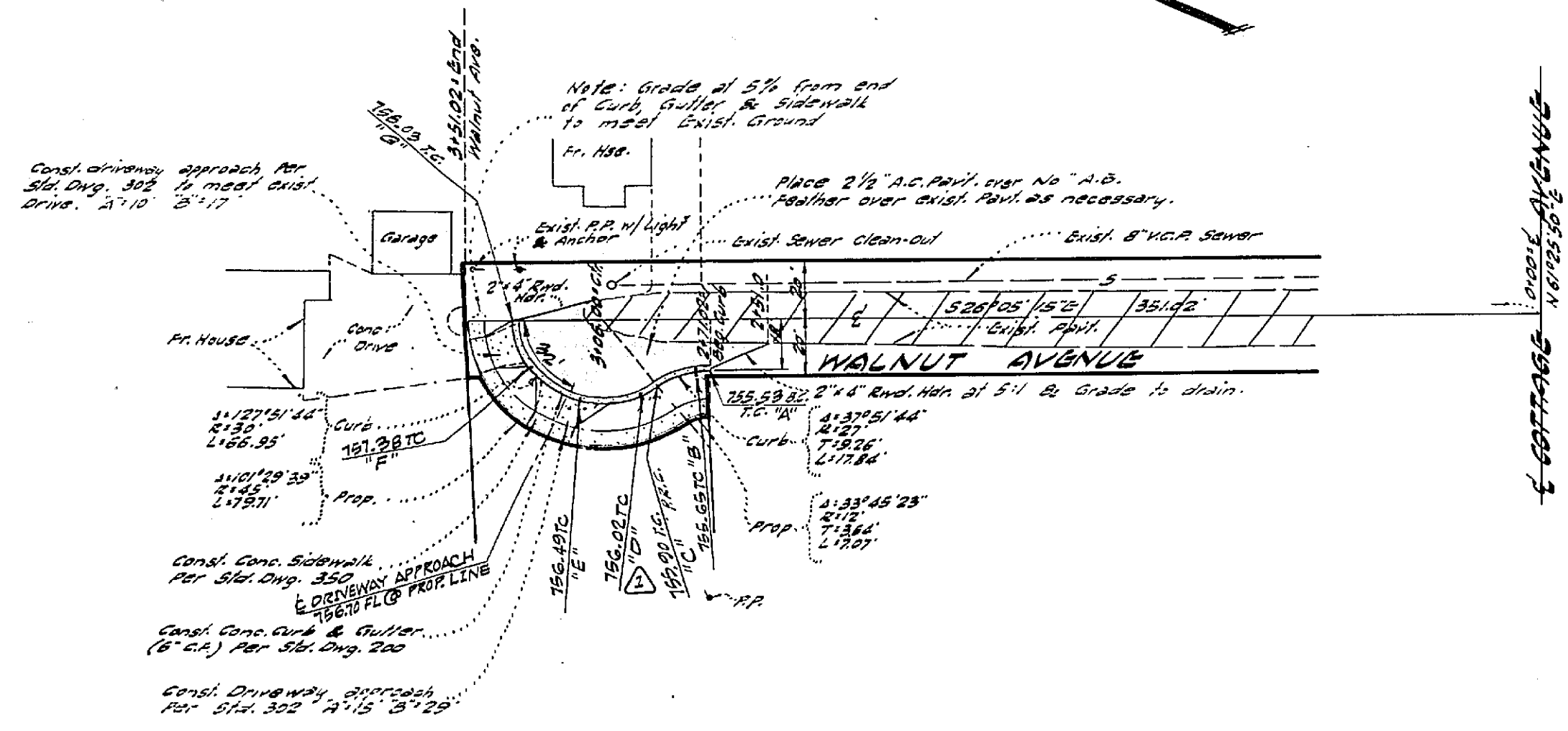

**PLAN & PROFILE
WALNUT AVENUE**

GARNER, TRACADAS & TROY
CIVIL ENGINEERING - LAND SURVEYING
360 NORTH ARROWHEAD AVENUE
SAN BERNARDINO, CALIFORNIA
Frank Tracadas
FRANK TRACADAS R.C.E. NO. 11447 DATE 3/2/65

REVISIONS		CITY OF RIVERSIDE, CALIFORNIA DEPARTMENT OF PUBLIC WORKS	
MARK	DATE	DESCRIPTION	PROJECT NO.
1	7/10/65	Lower Curb grade. By J.F. Davidson Associates APPROVED BY: <i>John Davidson</i> R.C.E. NO. 29889 W.P. [Signature]	PLAN & PROFILE R.S. NO. 877 WALNUT AVENUE - WEST SIDE 350' N'LY OF COTTAGE AVE.
DESIGNED BY	SUBMITTED BY	APPROVED BY	PROJECT NO.
DRAWN BY	FRANK TRACADAS	<i>Frank Tracadas</i> DIRECTOR OF PUBLIC WORKS	R-1015
CHECKED BY	RECOMMENDED BY	DATE	SHEET 1 OF 1
	<i>Pam Campbell</i> PUBLIC UTILITIES ENGINEER	3/3/65	3-15-65