

TYPICAL SECTION
WLY 1/2 PIERCE STREET
SCALE: HORIZ. NO SCALE
VERT. 1" = 2'

TYPICAL SECTION
T.I. 7
Scale: Horiz. No Scale
Vert. 1" = 2'

- GENERAL NOTES**
1. IT SHALL BE THE RESPONSIBILITY OF THE CONTRACTOR TO CLEAR THE RIGHT OF WAY IN ACCORDANCE WITH THE PROVISIONS OF LAW AS IT AFFECTS EACH UTILITY INCLUDING IRRIGATION LINES AND APPURTENANCES AND AT NO COST TO THE CITY.
 2. CONSTRUCTION SHALL BE IN ACCORDANCE WITH THE CITY OF RIVERSIDE, DEPARTMENT OF PUBLIC WORKS, SPECIFICATION NO. 461 AND STANDARD DRAWINGS.
 3. PRIME COAT, SEAL COAT, AND PAINT BINDER ARE REQUIRED.
 4. GRADING WILL REQUIRE A PERMIT UNDER ORDINANCE 3093 FOR A CUT OR FILL EXCEEDING 100 CUBIC YARDS, OR A FILL OVER ONE FOOT IN DEPTH.
 5. THE DEVELOPER SHALL ARRANGE FOR A TEST OF THE SOIL AT THE SUBGRADE LEVEL BY A SOILS ENGINEER. THICKNESS OF PAVEMENT AND THICKNESS AND TYPE OF AGGREGATE BASE SHALL BE DETERMINED BY THE SOILS ENGINEER AND SUBMITTED TO THE CITY OF RIVERSIDE FOR APPROVAL PRIOR TO CONSTRUCTION.
 6. TRIM EDGE OF EXISTING PAVEMENT, WHERE NEW PAVING JOINS EXISTING PAVEMENT, TO A CLEAN, STRAIGHT LINE. CONSTRUCT MATCH-UP PAVING AS SHOWN AND OVERLAY PAVING AS DIRECTED IN THE FIELD TO PRODUCE A SMOOTH CROWN SECTION.
 7. THE FINISHED SUBGRADE SHALL HAVE A COMPACTION OF NOT LESS THAN 90% FOR A DEPTH OF 6.5 FEET AS DETERMINED BY TEST METHOD NO. CALIF. 216 IMMEDIATELY PRIOR TO PLACEMENT OF THE COVER.
 8. EXISTING TRAFFIC SIGNS TO BE RELOCATED IN BACK OF SIDEWALK.
 9. EXISTING D/W APPROACHES TO BE RECONSTRUCTED PER C.R. STA. NO. 302 FOR CURB 3/4".

B.M. - 10' PK NAIL IN N.E. CURB RETURN - PIERCE AND SIERRA VISTA
ELEV. 743.999 CITY F.B. NO. 704 p. 19

J. F. DAVIDSON ASSOCIATES
CIVIL ENGINEERS - SURVEYORS - PLANNERS
RIVERSIDE, CALIFORNIA

APPROVED BY: *J. F. Davidson* DATE: 2/24/65
R.E. No. 868
DESIGNED BY: B.M. DRAWN BY: J.M. CHECKED BY: J.C.

CITY OF RIVERSIDE, CALIFORNIA
DEPARTMENT OF PUBLIC WORKS

APPROVED BY: *[Signature]* DATE: 5-10-65
OFFICE ENGINEER
TRAFFIC DIVISION
PARK DEPARTMENT
ASSISTANT CITY ENGINEER
PUBLIC UTILITIES DEPT.

STREET PLAN AND PROFILE
SIERRA VISTA AVE. - WLY SIDE
PIERCE ST. TO 300'± N'LY.
PIERCE ST. - WLY SIDE SIERRA
VISTA AVE. TO RALEY DRIVE
C.U.P. NO. C-10-645

PROJECT NO. 89 246
R-1018
SHEET 1 OF 2
FILE NO. 2787

Approved: *[Signature]* Date: 4/15/65
City Engineer

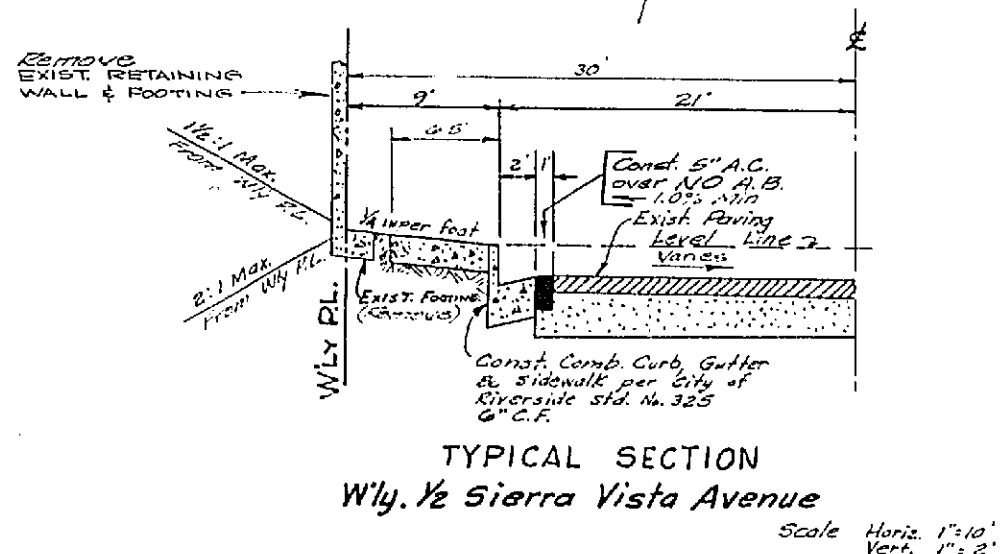
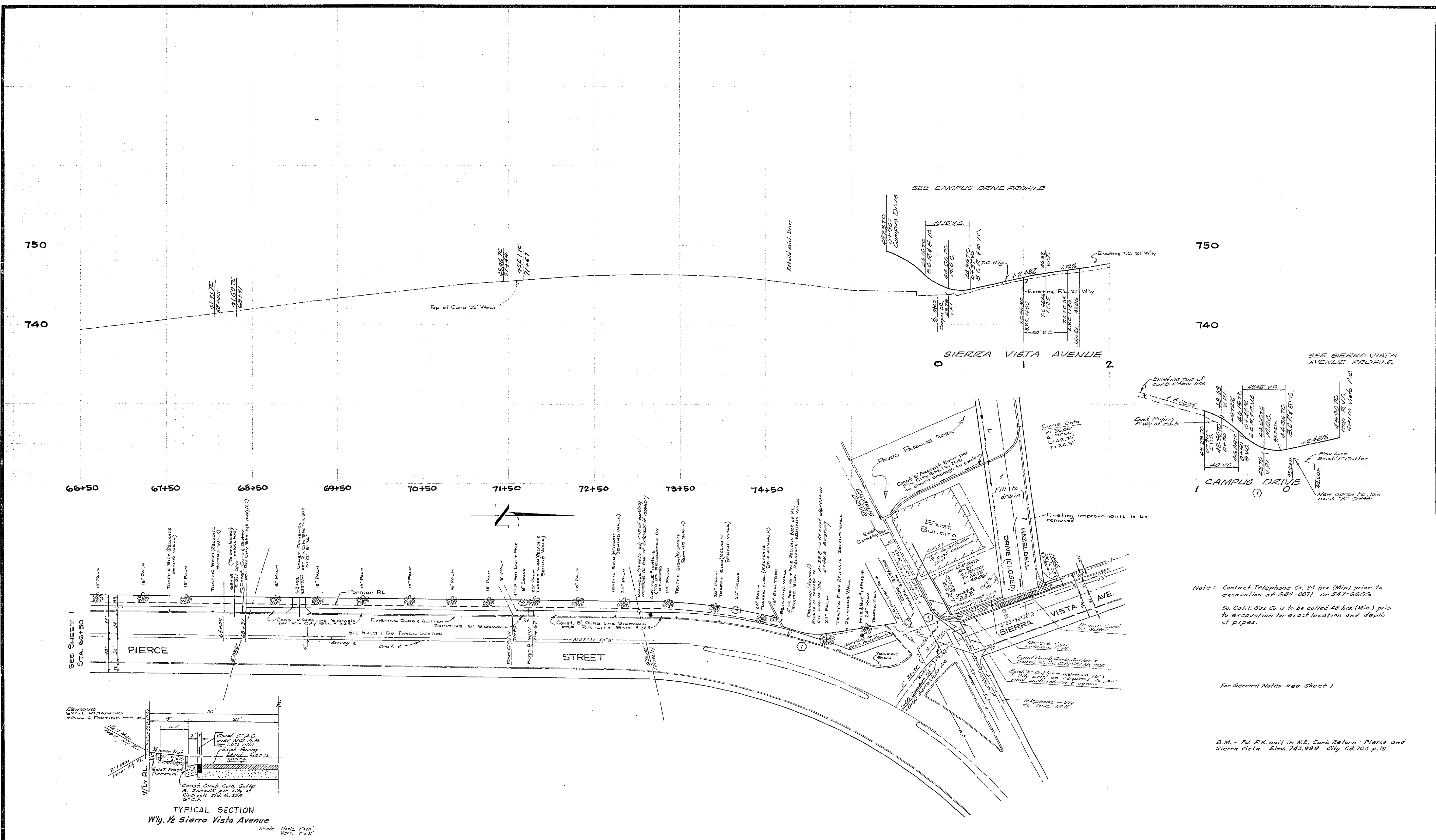

Note: Contact Telephone Co. 24 hrs. (Min) prior to excavation of 684-0071 or 547-6606.
So. Calif. Gas Co. is to be called 48 hrs. (Min) prior to excavation for exact location and depth of pipes.

For General Notes see Sheet 1

B.M. - Fd. R.K. nail in N.E. Curb Return - Pierce and Sierra Vista. Elev. 743.993 City KB. 704 p.19

J. F. DAVIDSON ASSOCIATES CIVIL ENGINEERS - SURVEYORS - PLANNERS RIVERSIDE, CALIFORNIA		CITY OF RIVERSIDE, CALIFORNIA DEPARTMENT OF PUBLIC WORKS		PROJECT NO. SS 246
APPROVED: <i>[Signature]</i> DATE 4/28/65 GEN. SUPT. AND CHIEF ENGINEER		APPROVED BY: <i>[Signature]</i> DATE 2/10/65 R.E. No. 862		R-1018
W.O. 337 FOR LA SIERRA COLLEGE F.B. 923/19 DESIGNED BY <i>[Signature]</i> DRAWN BY <i>[Signature]</i> CHECKED BY <i>[Signature]</i>		APPROVED BY: <i>[Signature]</i> DATE 5-10-65 OFFICE ENGINEER PARK DEPARTMENT TRAFFIC DIVISION ASSISTANT CITY ENG.		SHEET 2 OF 2 FILE NO. 2787
STREET PLAN AND PROFILE SIERRA VISTA AVE. - W'LY SIDE PIERCE ST. TO 300' ± N'LY. VISTA AVE. TO RALEY DRIVE. CUP N ^o C-10-645				
HORIZ. SCALE: 1" = 50' VERT. SCALE: 1" = 5'				