

**PROFILE**  
Scale: 1" = 20' Hor.  
1" = 2' Vert.

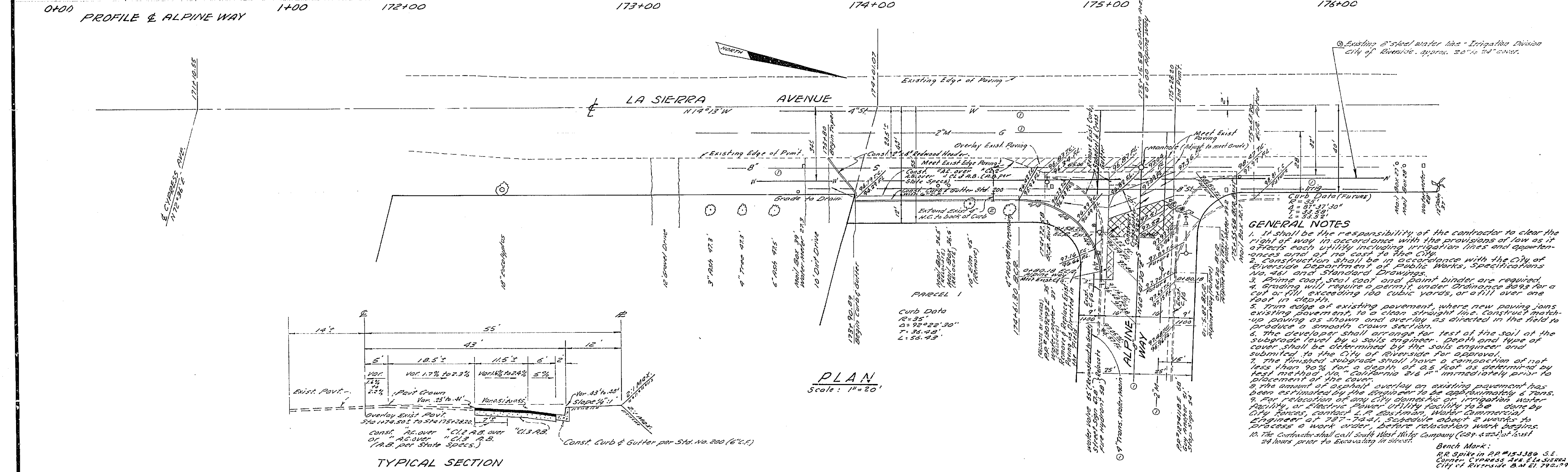

**TYPICAL SECTION  
LA SIERRA AVENUE**  
7.1.7  
No. 500

- GENERAL NOTES**
1. It shall be the responsibility of the contractor to clear the right of way in accordance with the provisions of law as it affects each utility including irrigation lines and appurtenances and of no cost to the City.
  2. Construction shall be in accordance with the City of Riverside Department of Public Works, Specifications No. 201 and Standard Drawings.
  3. Prime coat, seal coat and paint binder are required.
  4. Grading will require a permit under Ordinance 2025 for a cut or fill exceeding 100 cubic yards, or a fill over one foot in depth.
  5. Trim edge of existing pavement where new paving joins existing pavement to a clean straight line. Construct mark-up paving as shown and overlay as directed in the field to produce a smooth crown section.
  6. The developer shall arrange for a test of the soil at the subgrade level by a soils engineer. Depth and type of cover shall be determined by the soils engineer and submitted to the City of Riverside for approval.
  7. The finished subgrade shall have a compaction of not less than 90% for a depth of 0.5 feet as determined by field and laboratory tests.
  8. The amount of asphalt overlay on existing pavement has been determined by the City of Riverside as 2.0 inches.
  9. For relocation of any City domestic or irrigation water facility or placing power utility facility to be done by City, contact the Engineer, Water Department, City of Riverside, 700 N. 7th St., 2nd floor, to process a work order. Before relocation work begins.
  10. The Contractor shall notify the City of Riverside 24 hours prior to excavating in street.
- Bench Mark: 42.51 in 22' 15.380 S.E. Corner Cypress Ave & La Sierra City of Riverside B.M. 190.179

**CRAWLEY & HAWKINS**  
SURVEYORS AND ENGINEERS  
Riverside, California  
Approved: *George A. Crawley* Field Bk. 5478 Date 7-20-58  
J.A.E. 10-15-58

| NO. | REVISIONS                      | DATE    |
|-----|--------------------------------|---------|
| 1   | Added underground utilities    | 7-20-58 |
| 2   | Revised drawing                | 7-20-58 |
| 3   | Added irrigation lines to plan | 8-20-58 |

**CITY OF RIVERSIDE, CALIFORNIA**  
DEPARTMENT OF PUBLIC WORKS  
APPROVED BY: *[Signature]* DATE: 7-15-58  
OFFICE ENGINEER  
TRAFFIC DIVISION  
ASSISTANT CITY ENGINEER

**STREET PLAN & PROFILE**  
RIS 900  
**LA SIERRA AVENUE**  
EAST SIDE, FROM ALPINE WAY SLY 125'

PROJECT NO. **R-1079**  
SHEET **1** OF **1**  
FILE NO.

HORIZ. SCALE: 1" = 20' VERT. SCALE: 1" = 4'