

PLAN
SCALE 1" = 40'

MECLASKEY TRACT
M.B. 10-36-37

GENERAL NOTES:

- All construction shall be in accordance with standards and specifications No. 261 of the City of Riverside, Department of Public Works.
- Trim edge of paving to clean straight line. Construct match up paving and overlay existing paving as directed to produce smooth crown sections.
- It shall be the responsibility of the Contractor to clear the right-of-way in accordance with the provisions of law as it affects each utility, including irrigation lines and appurtenances and at no cost to the City.
- Prime Coat, Paint Binder and Seal Coat are required.
- Grading will require a permit under Ordinance 3093 for a cut or fill, exceeding 100 cubic yards or a fill over one foot in depth.
- CAUTION!! TRANSITE WATER LINE** - Contact L.P. Eastman Public Utility Dept. 787-7441 24 hrs prior to any excavation.
- The finish subgrade shall have a compaction of not less than 90% for a depth of 0.5 feet as determined by test No. California No. 216 immediately prior to placement of cover.
- Benchmark - RR spt. in p.p. # 612416 E. 750' North of Morris Street on Doolittle Avenue. EL. = 740.722
- Offset stakes will be set by the engineer at 12' intervals.

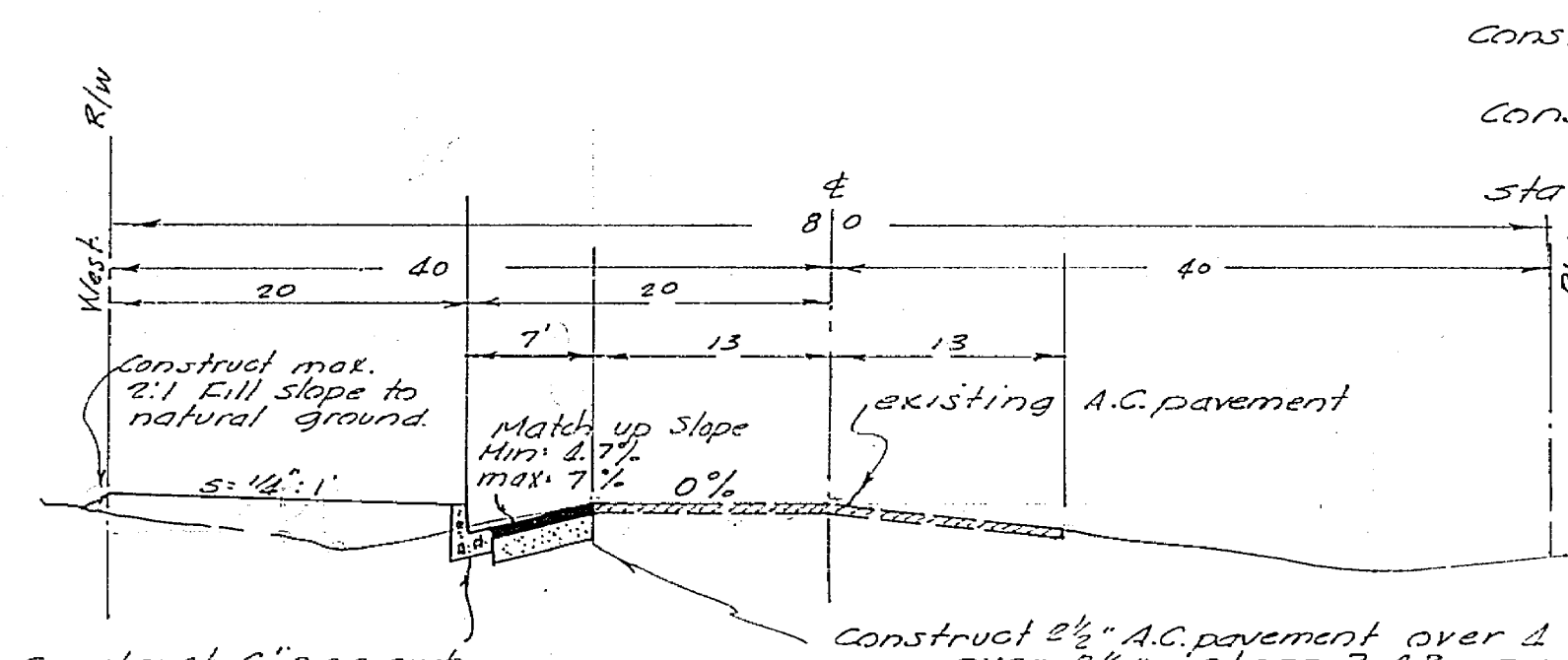

TYPICAL SECTION
DOOLITTLE AVENUE
NO SCALE
23+85.11 to 25+05.11
T.I. = 6.0

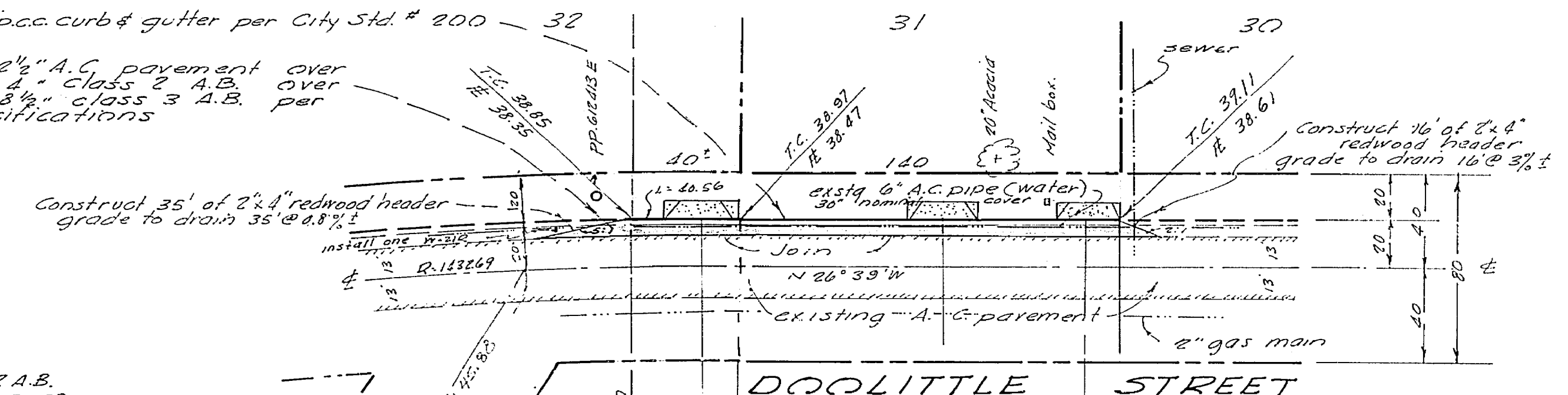

CURB CURVE DATA
R = 1432.69
Δ = 1° 35' 57"
L = 40.56

PUBLIC UTILITIES DEPARTMENT
Approved by
[Signature] 11-9-65
General Supl. & Chief Engr. - Electric

CITY OF RIVERSIDE, CALIFORNIA DEPARTMENT OF PUBLIC WORKS		PROJECT NO. R-1098	
APPROVED BY <i>[Signature]</i> OFFICE ENGINEER	DATE 11/13/65	APPROVED BY <i>[Signature]</i> CONTRACTOR OF PUBLIC WORKS	DATE 9/21/65
TRAFFIC DIVISION 11/16/65	ASSISTANT CITY ENG. 11/17/65	DATE 11-9-65	HORIZ. SCALE: 1" = 40' VERT. SCALE: 1" = 4'
DESIGNED BY	DRAWN BY	CHECKED BY	FILE NO.