

Remove existing paving and replace with 4" A.C. over 12" A.B. C.P.

R.B. P4/49-53

REVISIONS			CITY OF RIVERSIDE, CALIFORNIA DEPARTMENT OF PUBLIC WORKS	
MARK	DATE	DESCRIPTION		
			LA SIERRA AVENUE AND PIERCE PLACE INTERSECTION	
			PAVING REVISION	
DESIGNED BY	SUBMITTED BY	APPROVED BY	PROJ. NO.	
DRAWN BY J. Conie	MARKED BY TRAFFIC ENG.	DIRECTOR OF PUBLIC WORKS	R-1117-A	
CHECKED BY	RECOMMENDED BY	DATE	SHEET 1 OF 1	

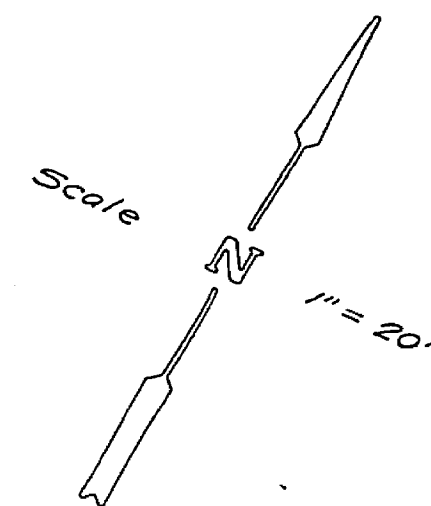
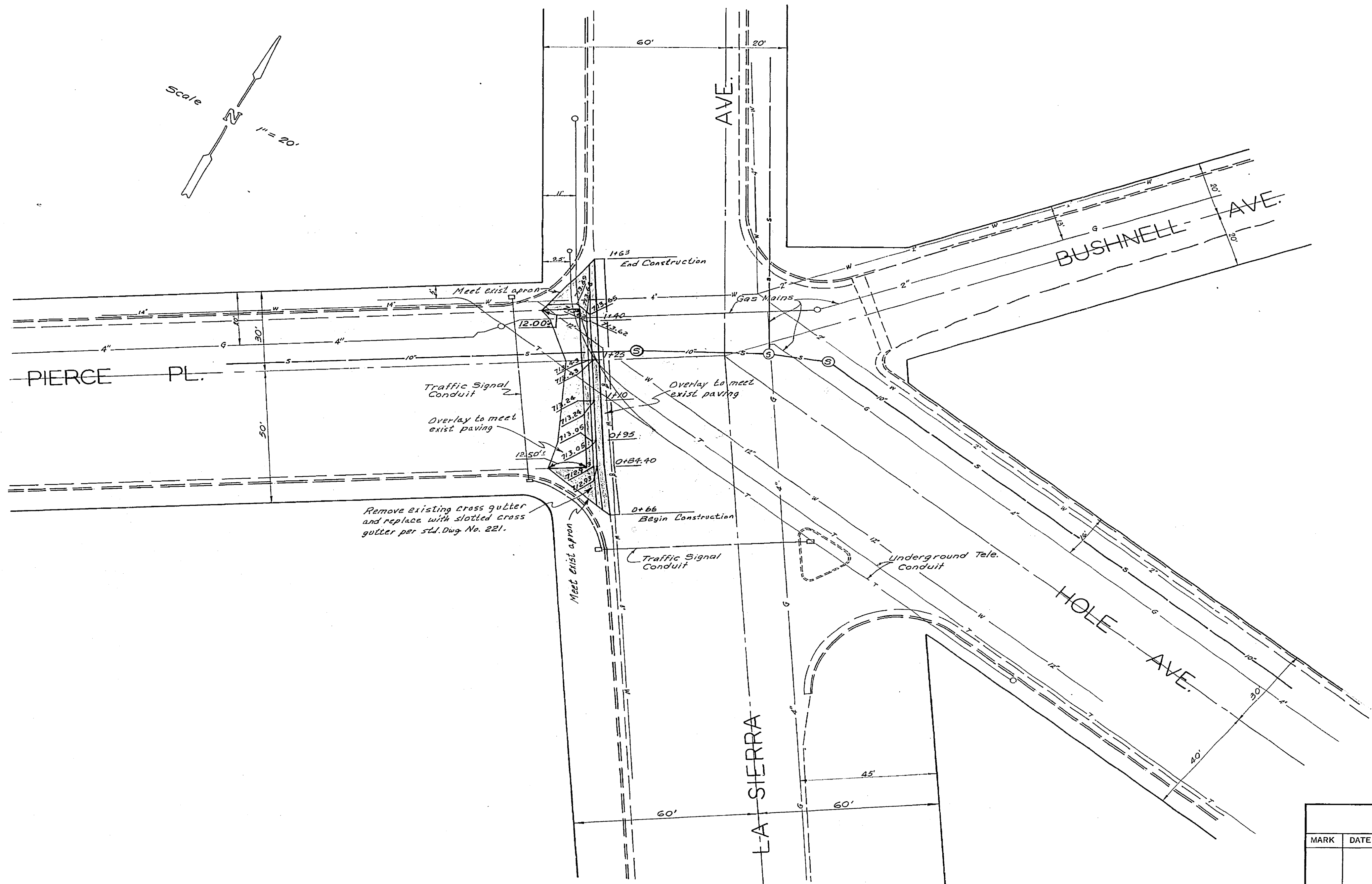

F.B. P4/49-53

REVISIONS			CITY OF RIVERSIDE, CALIFORNIA DEPARTMENT OF PUBLIC WORKS	
MARK	DATE	DESCRIPTION		
			LA SIERRA AVENUE AND PIERCE PLACE INTERSECTION	
			SLOTTED CROSS GUTTER	
DESIGNED BY R.R.S.	SUBMITTED BY P.B. [Signature]	APPROVED BY [Signature]	PROJ. NO. 3093	
DRAWN BY D. [Signature]	PARK DEPT. TRAFFIC DIV.	DIRECTOR OF PUBLIC WORKS	R-1117	
CHECKED BY Henry	RECOMMENDED BY William [Signature]	DATE 5-2-66	SHEET 1 OF 1	