

6.806

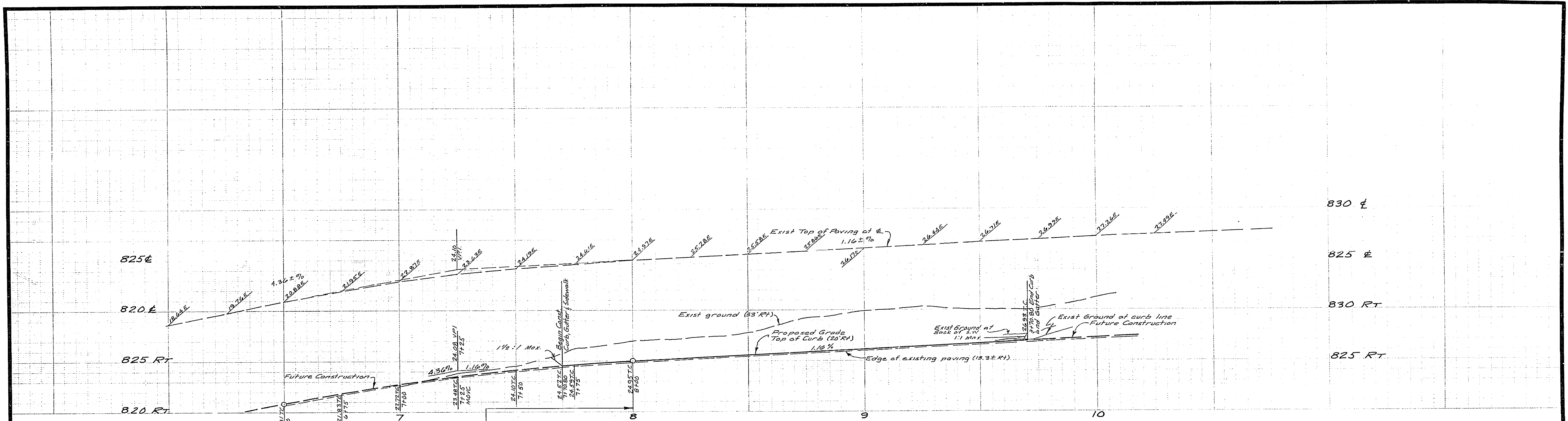

- GENERAL NOTES:**
- It shall be the responsibility of the contractor to clear the right of way in accordance with the provisions of law as it affects each utility including irrigation lines and appurtenances and at no cost to the City.
  - Construction shall be in accordance with the City of Riverside, Department of Public Works, Specifications No. 461 and Standard Drawings.
  - Prime coat, seal coat, and joint binder are required.
  - Grading will require a permit under Ordinance 3093 for a cut or a fill exceeding 100 cubic yards, or a fill over one foot in depth.
  - Trim edge of existing pavement where new paving joins existing pavement to a clean, straight line. Construct patch-up paving as shown and overlay as directed in the field to produce a smooth crown section.
  - The contractor shall arrange for a test of the soil at the subgrade level by a soils engineer. Depth and type of cover shall be determined by the soils engineer's test submitted to the City of Riverside for approval.
  - The finished subgrade shall have a compaction of not less than 90% for a depth of 0.5 foot, as determined by test method No. California 216-T immediately prior to placement of the cover.

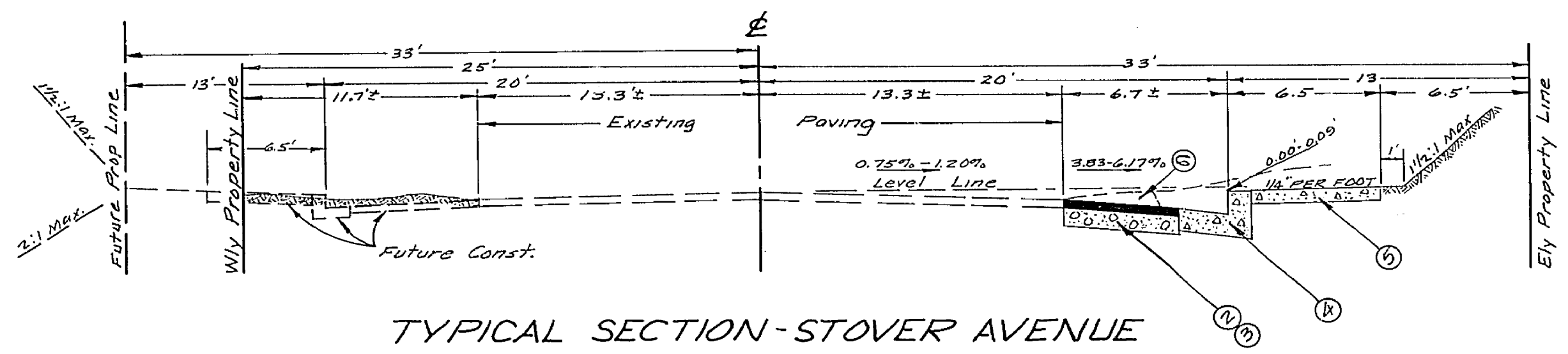
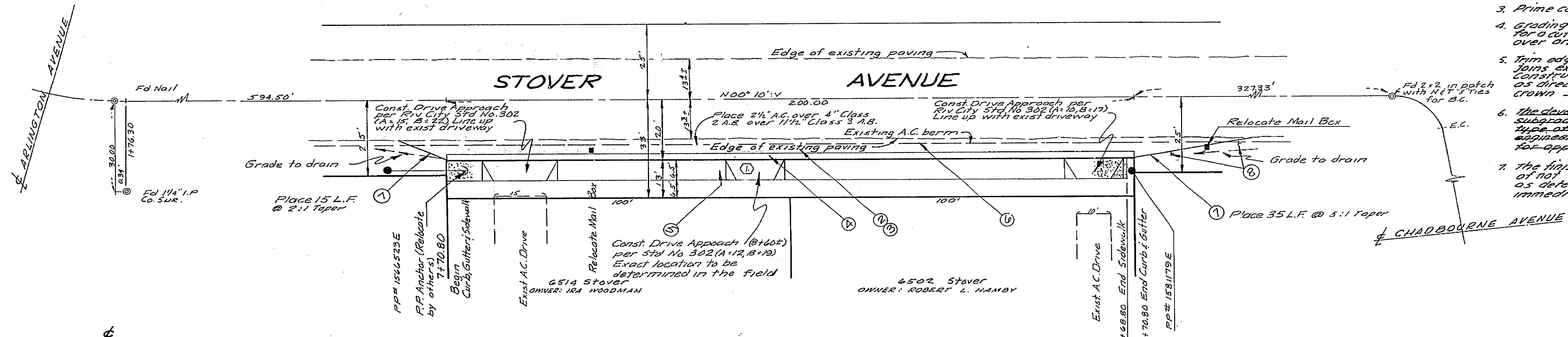

- CONSTRUCTION NOTES**
- Place 2 1/2" A.C. over 4" Class 2 A.B. over 1 1/4" Class 3 A.B.
  - Construct Conc. Curb and Gutter per City of Riv. Std. No. 200-6 C.F.
  - Construct Curb Sidewalk per City of Riv. Std. No. 325
  - Remove existing A.C. Berrm
  - Place 2" x 4" Redwood Header
  - Place 2 W-21-R (20' c-c)

TYPICAL SECTION-STOVER AVENUE

T.I. = 6  
NO SCALE

<b>CRAWLEY, HAWKINS &amp; HIEBER</b> ENGINEERS & SURVEYORS RIVERSIDE, CALIFORNIA FIELD BK. 84 APPROVED <i>[Signature]</i> DATE 12-10-65 RE. NO. 14307 J.D. 476	(C) Add Drive Approach (8'x20') (D) Add Drive Approach (8'x20')	CITY OF RIVERSIDE, CALIFORNIA DEPARTMENT OF PUBLIC WORKS		S.R. # _____ R = 10. <b>STREET PLAN &amp; PROFILE</b> <b>STOVER AVENUE</b> 770' - 970' NLY OF ARLINGTON OWNER: IRA WOODMAN 6514 STOVER OWNER: ROBERT L. HANBY 6502 STOVER BUILDING PERMIT	PROJECT NO. <b>R-1124</b> SHEET 1 OF 1 FILE NO.
		APPROVED BY _____ DATE 1-15-66 OFFICE ENGINEER PARK DEPARTMENT TRAFFIC DIVISION ASSISTANT CITY ENG.	APPROVED BY <i>[Signature]</i> DIRECTOR OF PUBLIC WORKS DATE 1-19-66	HORIZ. SCALE: 1" = 20' VERT. SCALE: 1" = 4'	