

BENCH MARK:  
STA. 54+19.12 TOP OF 1 1/4" IR. BRASS CAP - ELEV. 810.06

**STREET LIGHT NOTES & STANDARDS**

1. ALL STREET LIGHT STANDARDS AND PULLBOXES TO BE LOCATED IN THE FIELD.
2. ALL STREET LIGHT STANDARDS SHALL BE CHECKED FOR CLEARANCE OF DRIVEWAYS AND PLACED 1' FROM END OF CURB RETURNS.
3. SEE CITY OF RIVERSIDE DWG. NO. LI-1300B FOR LIGHT STANDARDS DETAILS AND DWG. NO. LI-1300S FOR PULLBOX DETAILS.
4. ALL CABLE TO BE AWG NO. 8 COPPER.
5. THIS IS A 2 WIRE 240 VOLT MULTIPLE SYSTEM.
6. ALL CONSTRUCTION TO COMPLY WITH CITY OF RIVERSIDE STREET LIGHT SPECIFICATIONS.
7. INSPECTIONS TO BE CALLED FOR AS OUTLINED IN SPECIFICATIONS.
8. FEED POINT TO BE DETERMINED.
9. FEED POINT TO BE CONFIRMED AT TIME OF CONSTRUCTION.
10. \$ 75.00 CONNECTION FEE TO BE PAID. DATE PAID
11. \$ 5.00 INSPECTION FEE TO BE PAID. DATE PAID

- INDICATES CITY OF RIVERSIDE MARBLEITE LIGHT STANDARD NO. 451A WITH 10,000L, 250W TYPE III "LINE MATERIAL" MERCURY VAPOR LUMINAIRE, CAT. NO. LW-3A2 OR APPROVED EQUAL.
- INDICATES NO. 3/4" PULLBOX "BROOKS PRODUCTS INC." OR APPROVED EQUAL.
- INDICATES 1" RIGID GALV. STEEL CONDUIT, EXCEPT AS NOTED.
- INDICATES FEED POINT.

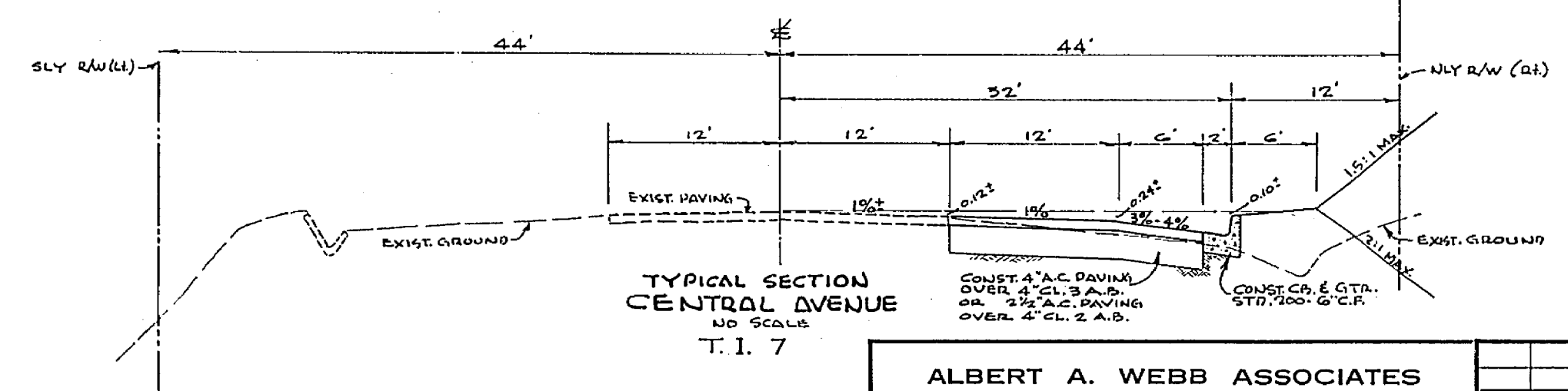
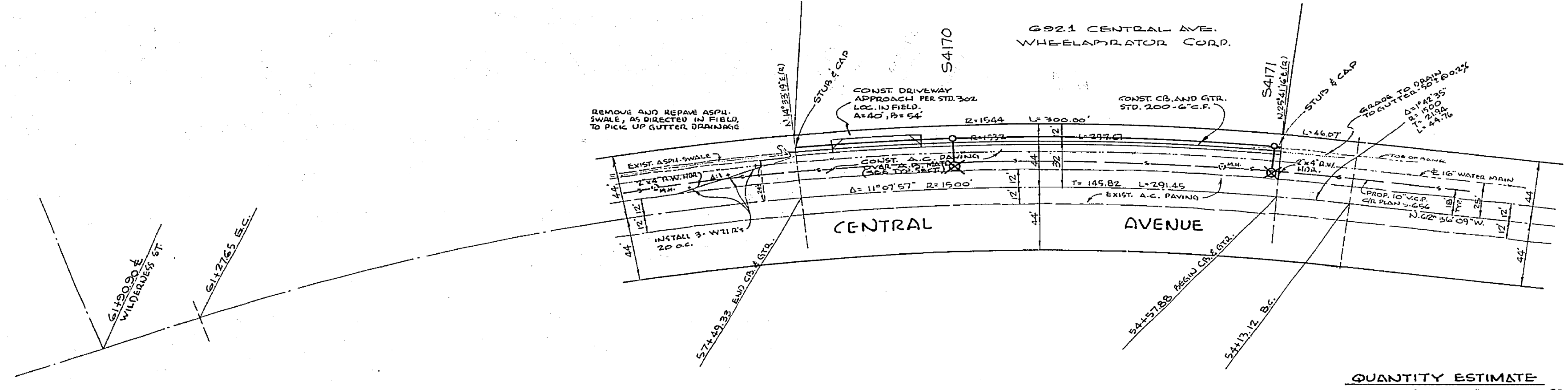

**QUANTITY ESTIMATE**

CURB & GUTTER, STD. 200-G.C.F.	298 LF.
A.C. PAVING (SEE TYP. SECT.)	6000 SF.
AGGREGATE BASE MATERIAL (SEE TYP. SECT.)	6000 SF.
2" x 4" REDWOOD HEADS	93 LF.
W 21/2" REFLECTOR	3 EA.

- GENERAL NOTES**
- (1) It shall be the responsibility of the contractor to clear the right of way in accordance with the provisions of law as it affects each utility, including irrigation lines and appurtenances, and at no cost to the City.
  - (2) Construction shall be in accordance with the City of Riverside, Department of Public Works, Specifications No. 461 and Standard Drawings.
  - (3) Prime coat, seal coat, and paint binder are required.
  - (4) Grading will require a permit under Ordinance 1993 for a cut or fill exceeding 100 cubic yards, or a fill over one foot in depth.
  - (5) The contractor shall arrange for a full-time utility engineer to be on-site during construction to locate and mark all existing utilities in accordance with the City of Riverside Design Standards.
  - (6) Trim edge of existing pavement, where new joints exist, to a clean, straight line. Grind and patch-up paving as shown and overlay paving as directed in the field to produce a smooth crown section.
  - (7) CITY OF RIVERSIDE PLAN 0.515 WAS USED AS BASIS FOR RECORD.
  - (8) THIS FINISHING SURFACE SHALL HAVE A COMPLETION OF NOT LESS THAN 2% FOR A DRAINAGE SLOPE AS DETERMINED BY THE ENGINEER. THE CONTRACTOR SHALL INDICATE THE PLACE OF COMPLETION OF SURFACE.

**NOTICE TO CONTRACTOR**

The existence and location of any underground utility pipes or structures shown on these plans are obtained by a search of the available records. To the best of our knowledge, there are no existing utilities except as shown on these plans.

The contractor is required to take due precaution to protect and guard the utility lines shown and any other lines shown on these plans.

APPROVED FOR STREET LIGHTS:  
*Don Campbell* 2-3-66  
CHIEF Supt. and Chief Eng. DATE

ALBERT A. WEBB ASSOCIATES  
CIVIL ENGINEERS  
RIVERSIDE, CALIFORNIA

APPROVED BY: *Ed Webb* DATE: 1/17/66  
R.E. No. 9876

MARK	REVISIONS	APPR.	DATE

CITY OF RIVERSIDE, CALIFORNIA  
DEPARTMENT OF PUBLIC WORKS

APPROVED BY: *Ed Webb* DATE: 2-9-66  
DIRECTOR OF PUBLIC WORKS

**STREET PLAN AND PROFILE**  
**CENTRAL AVENUE**  
NORTH SIDE - 360'± TO 690'± BY  
OF WILDERNESS ST. FOR M.P. ZONE  
OF WHEELABRATOR CORP.

PROJECT NO. 307  
L5-13153  
R-1139  
SHEET 1 OF 1  
FILE NO. 65-373 A

HORIZ. SCALE: 1" = 50' VERT. SCALE: 1" = 5'