

PROFILE
SCALE: Horiz. - 1" = 20'
Vert. - 1" = 4'

GENERAL NOTES

- If shown on the drawings by the contractor to clear the right of way in accordance with provisions of law that affects such utility, including provision lines and requirements and of no cost to the City.
- Construction shall be in accordance with the City of Riverside, Department of Public Works Specifications No. 401 and Standard Drawings.
- Prime coat, seal coat and paint binder are required.
- The finished subgrade shall have compaction of not less than 90% for a depth of 3 feet as determined by test method No. Calif. 216 immediately prior to placement of the course.
- Trim edges of existing pavement where new pavement joins existing pavement to a clean straight line. Construct match-up joints as shown and overlay paving as directed in the field to produce a smooth crown section. Quantity of overlay estimated to be 4 tons.
- Grading for street improvements will not require a grading permit.
- Contractor will contact Southern Water Company Phone Edgewood 6-1231, Valinda, Calif. Prior to relocation of water facilities.

CONSTRUCTION NOTES

- Remove existing A.C. pavement as req'd to produce a smooth section.
- Bring site to grade for new const. Grading will require a permit under Ordinance 3093 for a cut or fill exceeding 100 cubic yards, or a fill over 1 ft. in depth.
- Const. curb & gutter and depressed curb as shown per City of Riverside Std. No. 200 & curb face.
- Const. apron per City of Riverside Std. No. 220. W/ full cross gutter.
- Const. driveway approaches per City of Riverside Std. No. 302.
- Const. sidewalk as shown per City of Riverside Std. No. 350.

STREET LIGHT CONSTRUCTION

- All street light standards & pullboxes to be located in the field.
- All street light standards shall be checked for clearance of driveways & placed 1' from end of curb returns.
- See City of Riverside Drug M. L. 1-13008 for light standard details & Drug. M. L. 1-13001 for pullbox details.
- All cables to be AWG No 8 copper.
- This is a 2 wire, 120 volt multiple system.
- All construction to comply to City of Riverside Std. Specifications.
- Inspectors to be called as per specifications.
- Feed point to be confirmed at time of construction.
- \$ 75⁰⁰ Connection fee to be paid *date paid*
- \$ 50⁰⁰ inspection fee to be paid *date paid*

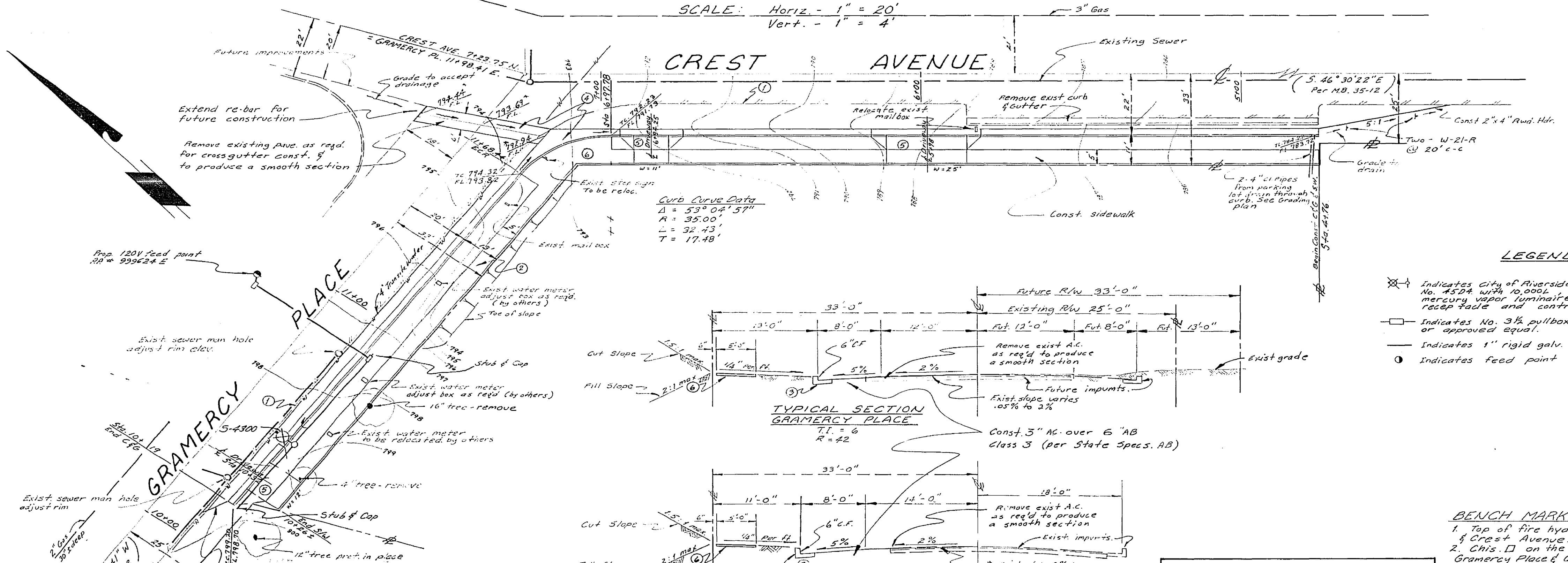

PLAN
SCALE: 1" = 20'

LEGEND

- ⊗ Indicates City of Riverside marbleite light standard "No. 4504 with 10,000, 250W, type II, "Line Material" mercury vapor luminaire with individual photoelectric rcs&p fade and control unit", Cat. No. LMA.6.A2
- Indicates No. 3 1/2 pullbox "Brooks Products Inc." or approved equal.
- Indicates 1" rigid galv. steel conduit, except as noted
- Indicates feed point

BENCH MARKS

- Top of fire hydrant - S.E. cor. Gramercy Place & Crest Avenue. Elev. - 794.95
 - Chis. D on the S/4 B.C.R. of the S.E. cor. Gramercy Place & Crest Ave. Elev. - 791.74
- The above B.M.'s were established from the B.M. @ the N.W. cor. Gramercy & Tyler Ave. R.R. spike in pole # 694665 H. Elev. - 768.617
F.B. 705/5, 17 F.B. 704/171

P.S.I. ENGINEERING CO.
JOB NO. 66-1715E DATE 8/66
Approved *[Signature]*
A.C.E. 14340

MARK	REVISIONS	APPR. DATE
1	Added General Note 7, 8, 9, 10, 11, 12, 13, 14, 15, 16, 17, 18, 19, 20, 21, 22, 23, 24, 25, 26, 27, 28, 29, 30, 31, 32, 33, 34, 35, 36, 37, 38, 39, 40, 41, 42, 43, 44, 45, 46, 47, 48, 49, 50, 51, 52, 53, 54, 55, 56, 57, 58, 59, 60, 61, 62, 63, 64, 65, 66, 67, 68, 69, 70, 71, 72, 73, 74, 75, 76, 77, 78, 79, 80, 81, 82, 83, 84, 85, 86, 87, 88, 89, 90, 91, 92, 93, 94, 95, 96, 97, 98, 99, 100	

CITY OF RIVERSIDE, CALIFORNIA
DEPARTMENT OF PUBLIC WORKS

APPROVED BY: *[Signature]*
OFFICE ENGINEER
PARK DEPARTMENT
TRAFFIC DIVISION
ASSISTANT CITY ENGINEER
DATE 9-7-66

STREET PLAN AND PROFILE
SOUTHERLY CORNER OF
GRAMERCY PLACE AND
CREST AVENUE
C-28-656

PROJECT NO. 55 331
R-1159
25-13189
SHEET 1 OF 1
FILE NO.

APPROVED FOR STREET LIGHTS
[Signature] 8-31-66
Gen. Super & Chief Engr. Date

DESIGNED BY PNE DRAWN BY PNE CHECKED BY KSCA