

RE. 716, 730, 731, 740
 B.M. PK. NAIL IN SLAB AT
 REAR OF COSMETOLOGY
 BLDG.
 ELEV. 850.296

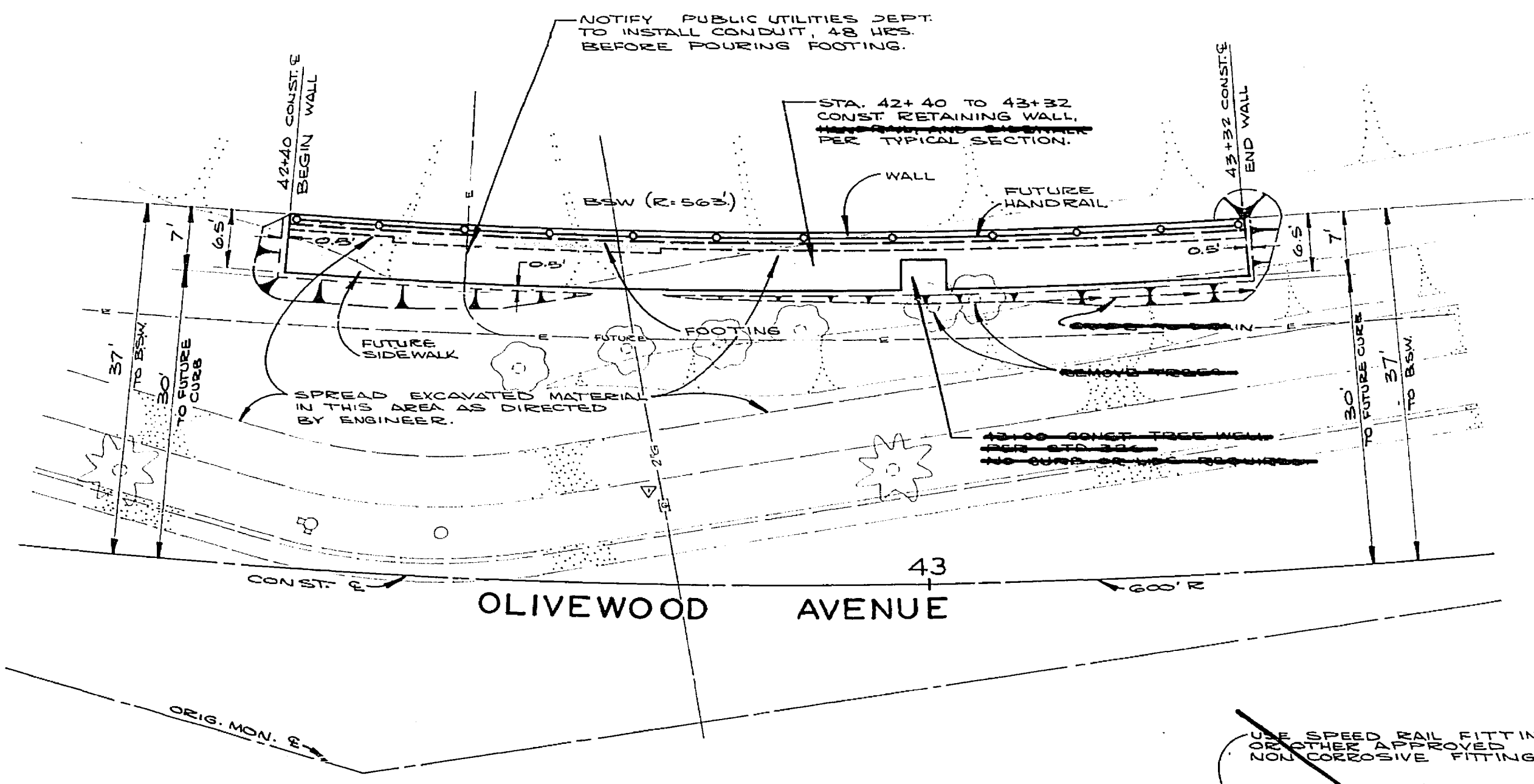

SIDEWALK AND HANDRAIL
 NOT A PART OF THIS CONTRACT

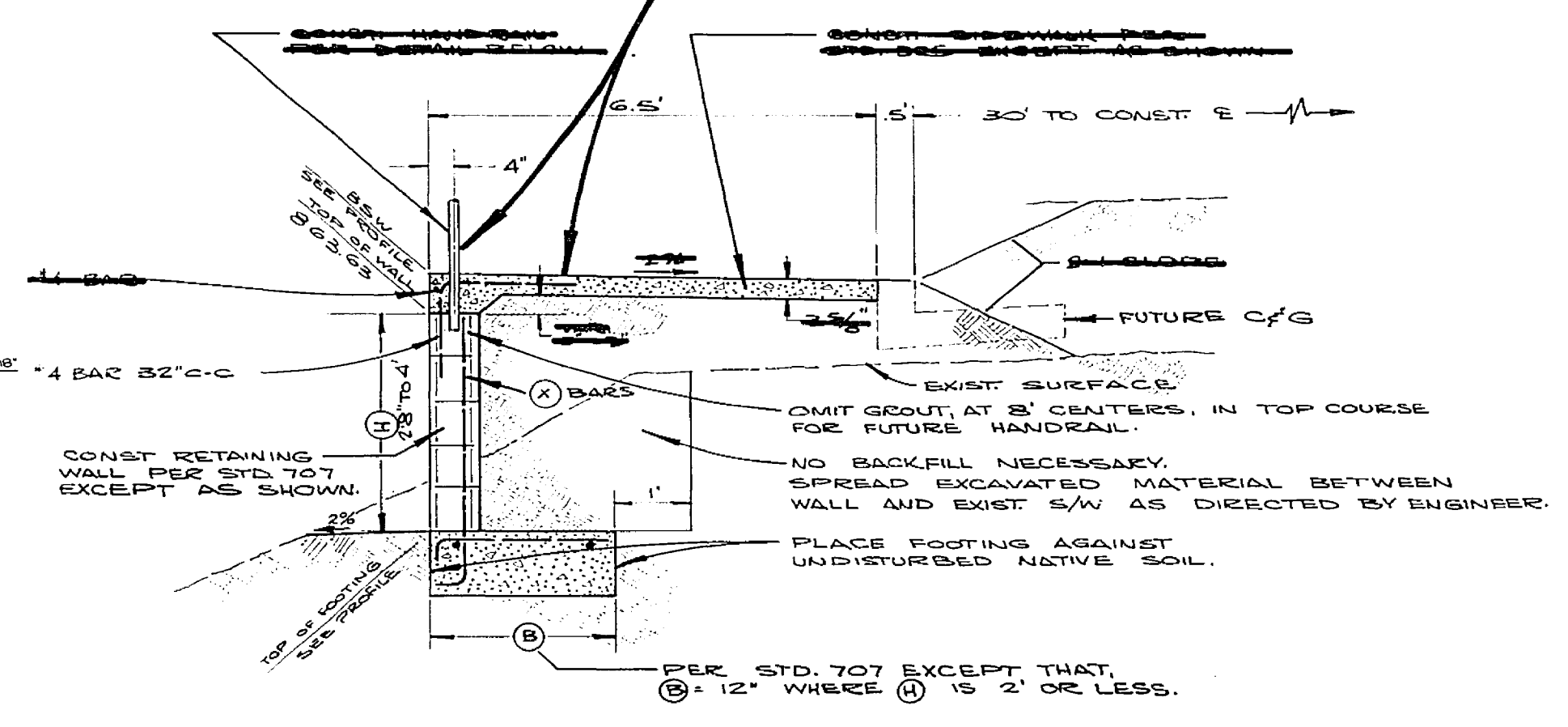

TYPICAL SECTION
 WALL NO. 1
 SCALE 1" = 2'

GENERAL NOTES

1. STRUCTURE BACKFILL SHALL BE NATIVE SOIL WITH 90% R.C.
2. THE TOP 6" OF SUBGRADE FOR FOOTINGS SHALL BE COMPACTED TO 90% R.C.

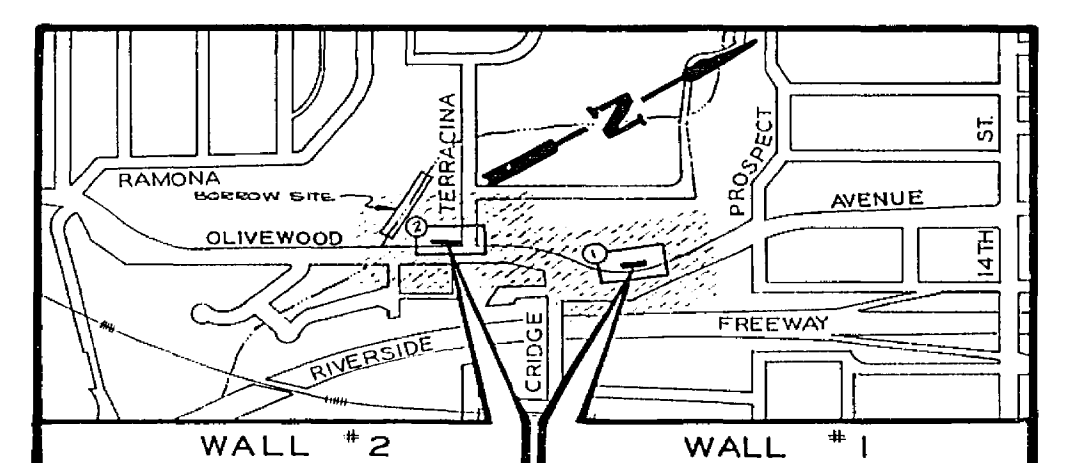

PROJECT LOCATION MAP
 SCALE 1" = 800'

RETAINING WALL NO. 1*



* WALL MAY BE CONSTRUCTED OF P.C.C. AT CONTRACTOR'S OPTION. P.C.C. SHALL BE 60-B-3000; USE SAME STEEL SCHEDULE.

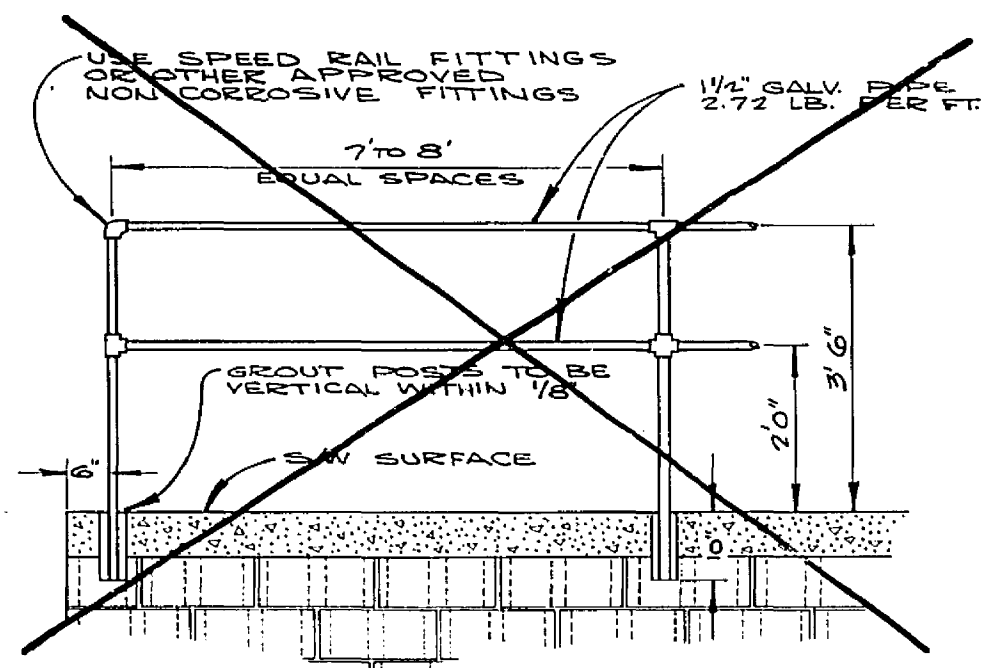

HANDRAIL DETAIL
 SCALE 1" = 2'

RIVERSIDE CITY COLLEGE		CITY OF RIVERSIDE, CALIFORNIA DEPARTMENT OF PUBLIC WORKS		PROJECT NO. 304
ADD EXIST. GAS SERVICE TO ST. 1/2" VC	4/1/65	APPROVED BY <i>William D. Gardner</i> SUPERVISOR OF PUBLIC WORKS	OLIVEWOOD AVENUE RETAINING WALLS	R-1176 W
NAME	REVISIONS	DATE	HORIZ. SCALE: 1" = 10'	VERT. SCALE: 1" = 4'
DESIGNED BY: <i>BSG</i>	DRAWN BY: <i>GW</i>	CHECKED BY: <i>BC</i>	DATE: <i>4/1/65</i>	SHEET 1 OF 2

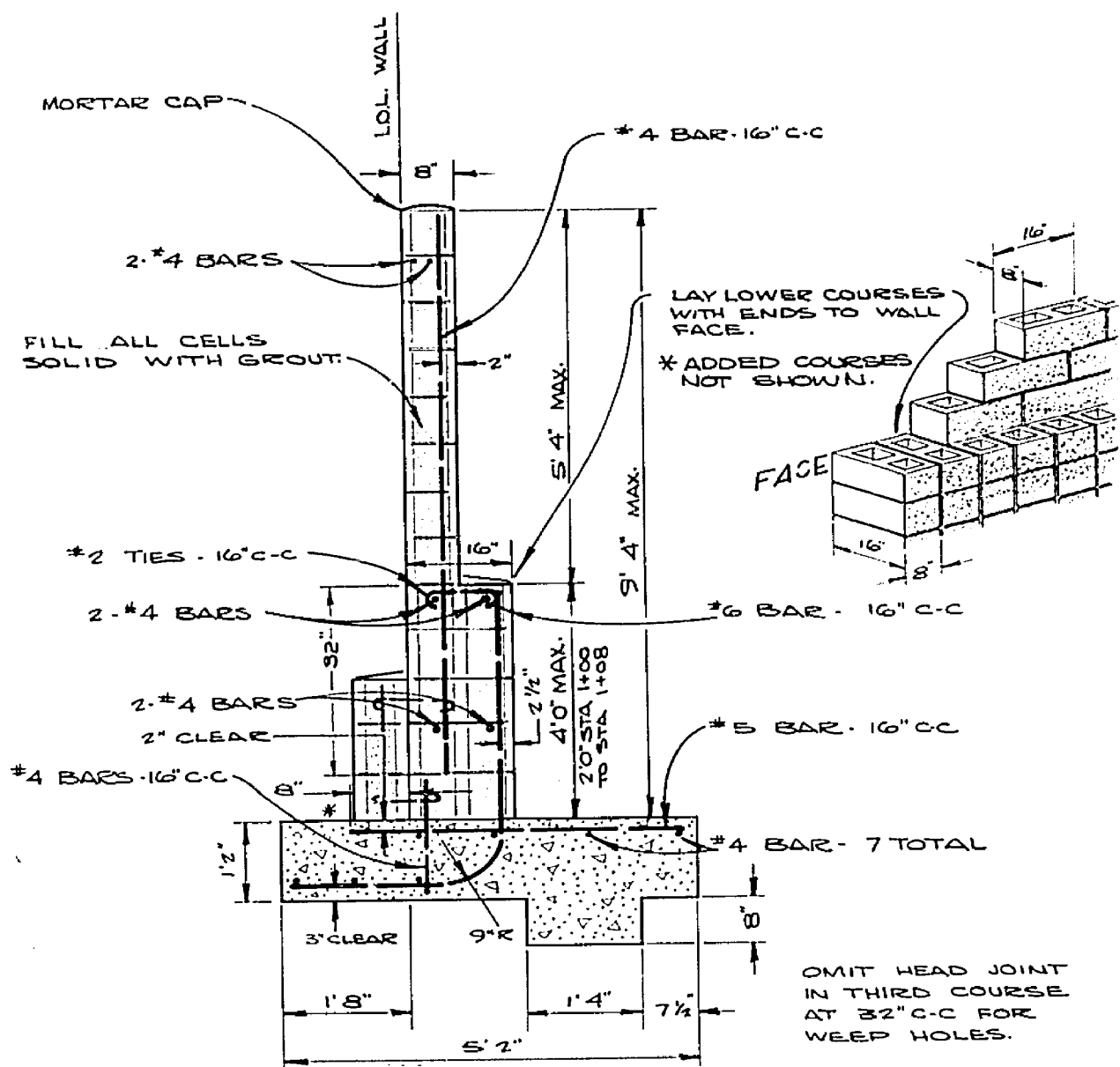

MASONRY WALL SECTION (ALTERNATE)
SCALE 1"=2'

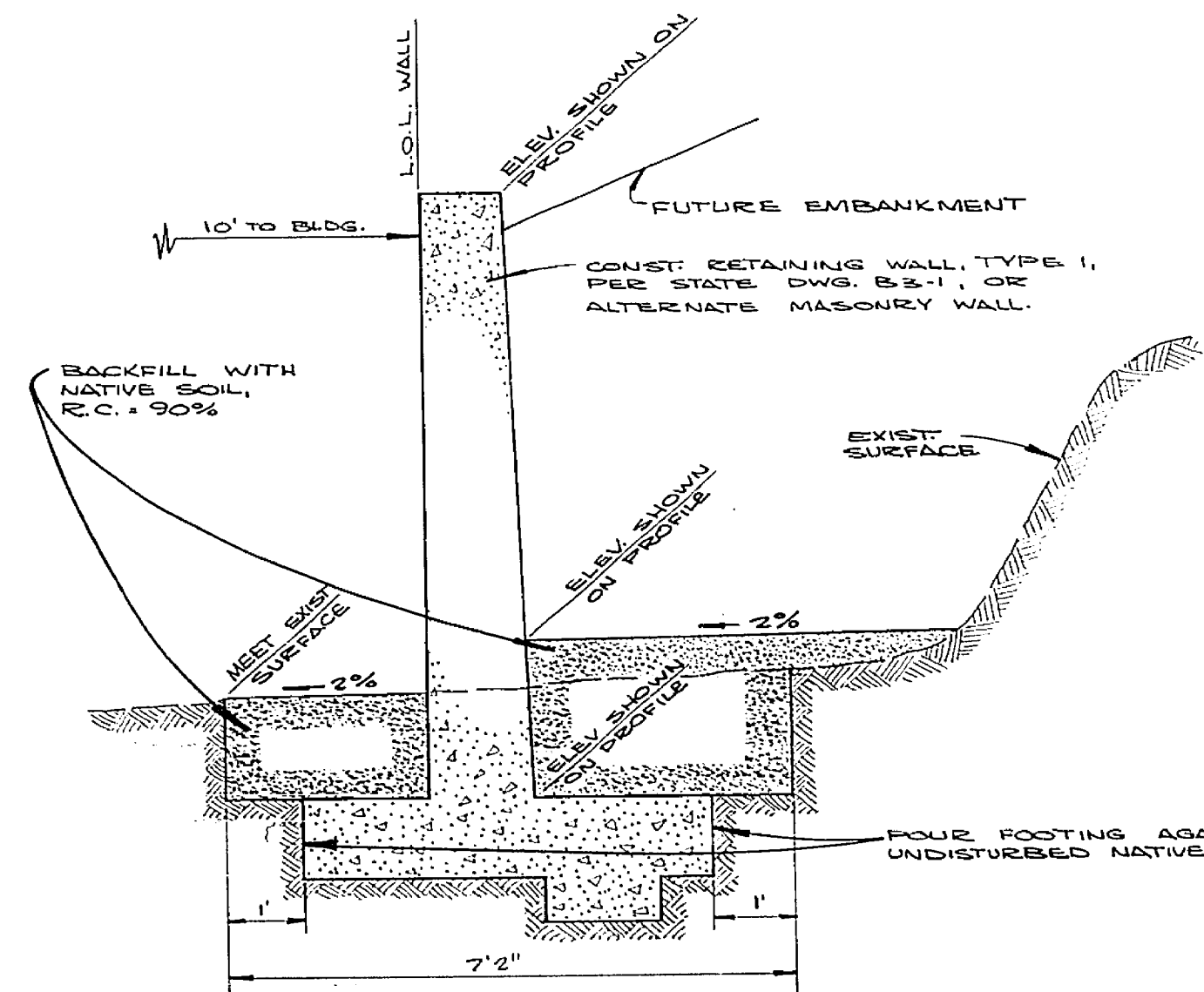

TYPICAL SECTION
SCALE 1"=2'

ABBREVIATIONS
 L.O.L. LAYOUT LINE
 BSW. BACK OF SIDEWALK
 R/W RIGHT OF WAY

RETAINING WALL # 2

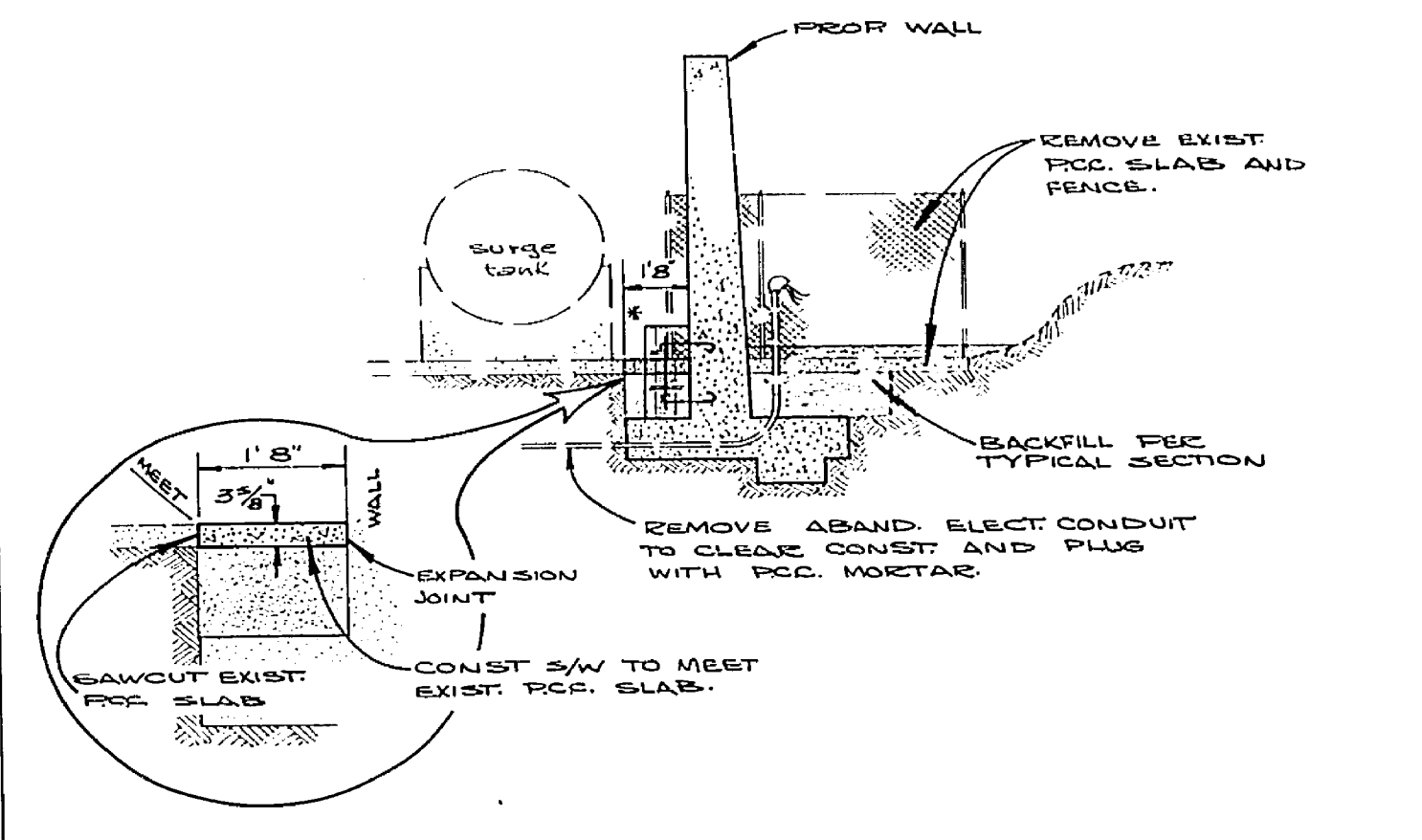
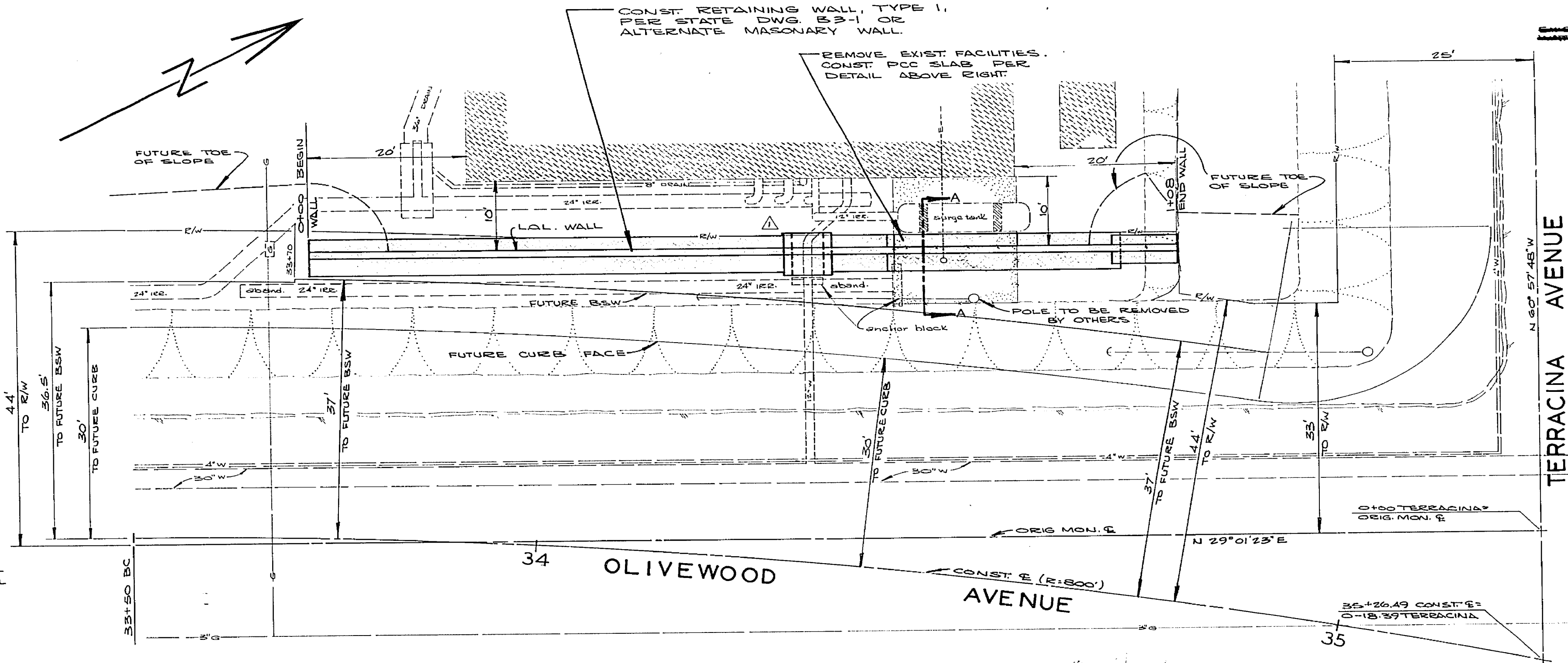
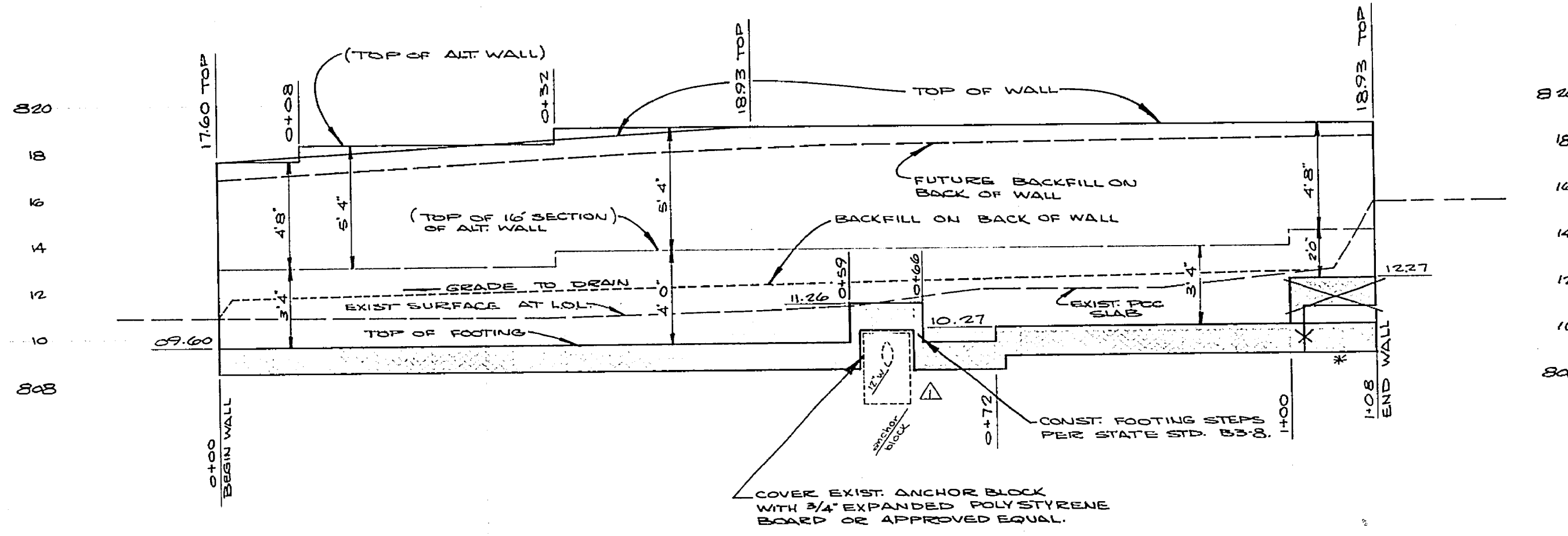

SECTION A-A

STA. 0+175 TO 0+282
 SCALE 1"=4'
 F.S. 716, 730, 731, 740
 B.M. P.K. NAIL IN EAST CURB ON OLIVEWOOD AVE.
 AT STA. 26+161
 ELEV. 820.159

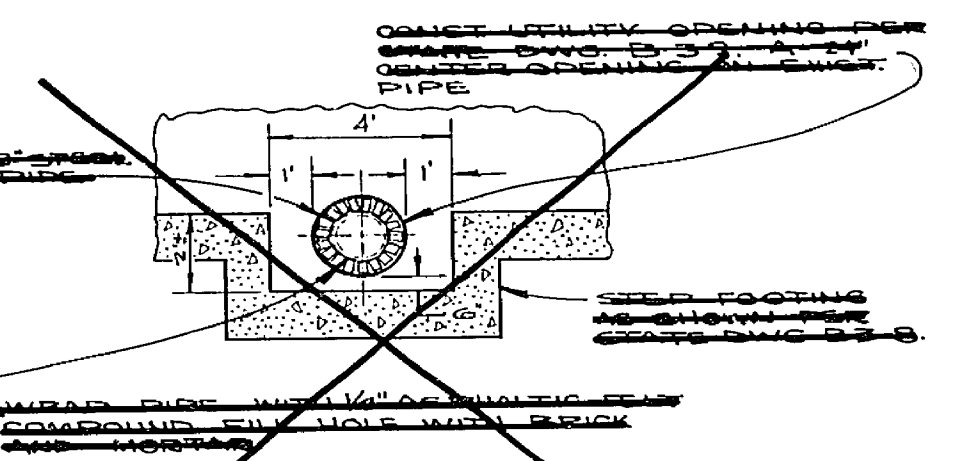

UTILITY OPENING DETAIL

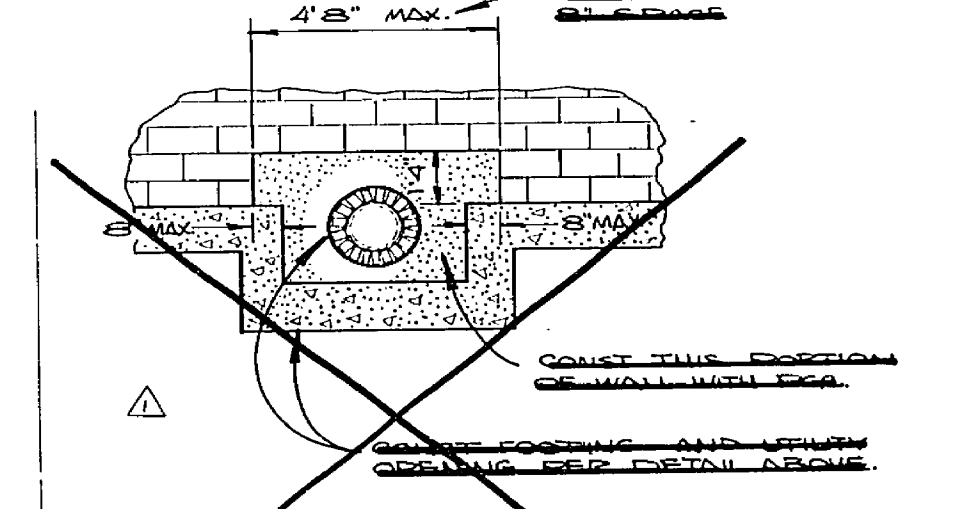

UTILITY OPENING DETAIL (ALTERNATE)

RIVERSIDE CITY COLLEGE
 GAGE CANAL
 1/3/70
 CITY OF RIVERSIDE, CALIFORNIA
 DEPARTMENT OF PUBLIC WORKS
 APPROVED BY
 William D. Gordon
 SUPERVISOR OF PUBLIC WORKS
 DATE 4/1/69
 OLIVEWOOD AVENUE
 RETAINING WALLS
 JURUPA AVE. TO PROSPECT AVE.
 R 1176W
 2 2