

- GENERAL NOTES:**
- It shall be the responsibility of the Contractor to clear the right of way in accordance with the provisions of law as it pertains to each utility, including irrigation lines and appurtenances and at no cost to the City.
  - Construction shall be in accordance with the City of Riverside Department of Public Works Specifications No. 461 and Standard Drawings.
  - Trim edge of existing paving where new paving joins existing pavement for a clean straight line. Also, place make-up paving as shown and overlay paving as directed in the field to produce a smooth crown section. Engineer estimates overlay to be 55 tons.
  - Prime coat and paint binder are required.
  - The finished sub-grade shall have a composition of not less than 90% for a depth of 0.5 FT. As determined by test Method No. Coll. 216 F immediately prior to placement of the cover.
  - Existing street name & stop signs to be relocated. Street name sign to be installed per std. 662.
  - Grading will require a permit under Ord. No. 3093 for a cut or fill exceeding 100 cu. yd. or fill over one ft. in depth.

**QUANTITY ESTIMATE**

|                                    |             |
|------------------------------------|-------------|
| Std. 200 Curb & gutter (8" C.F.)   | 297 L.F.    |
| Std. Sidewalk                      | 625 Sq.Ft.  |
| Remove exist. curb & gutter        | 340 L.F.    |
| Remove exist. sidewalk             | 625 Sq.Ft.  |
| 2 1/2" A.C. Paving and seal coat   | 3200 Sq.Ft. |
| 3" Imported Base Material          | 30 Cuyd.    |
| Recap with variable thickness A.C. | 4500 Sq.Ft. |
| 36" C.M.P. 1/2 Ga.                 | 199.41 L.F. |

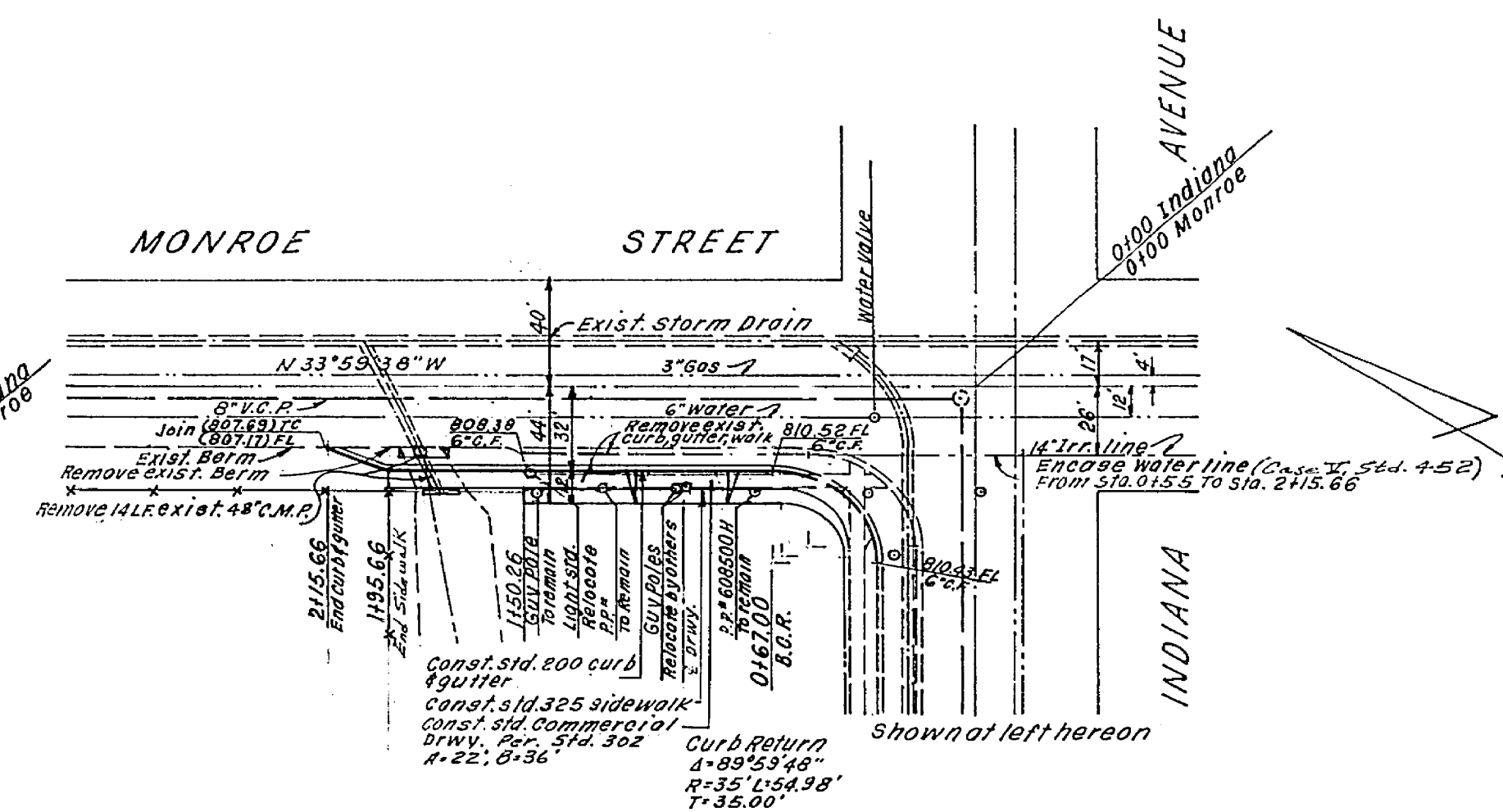
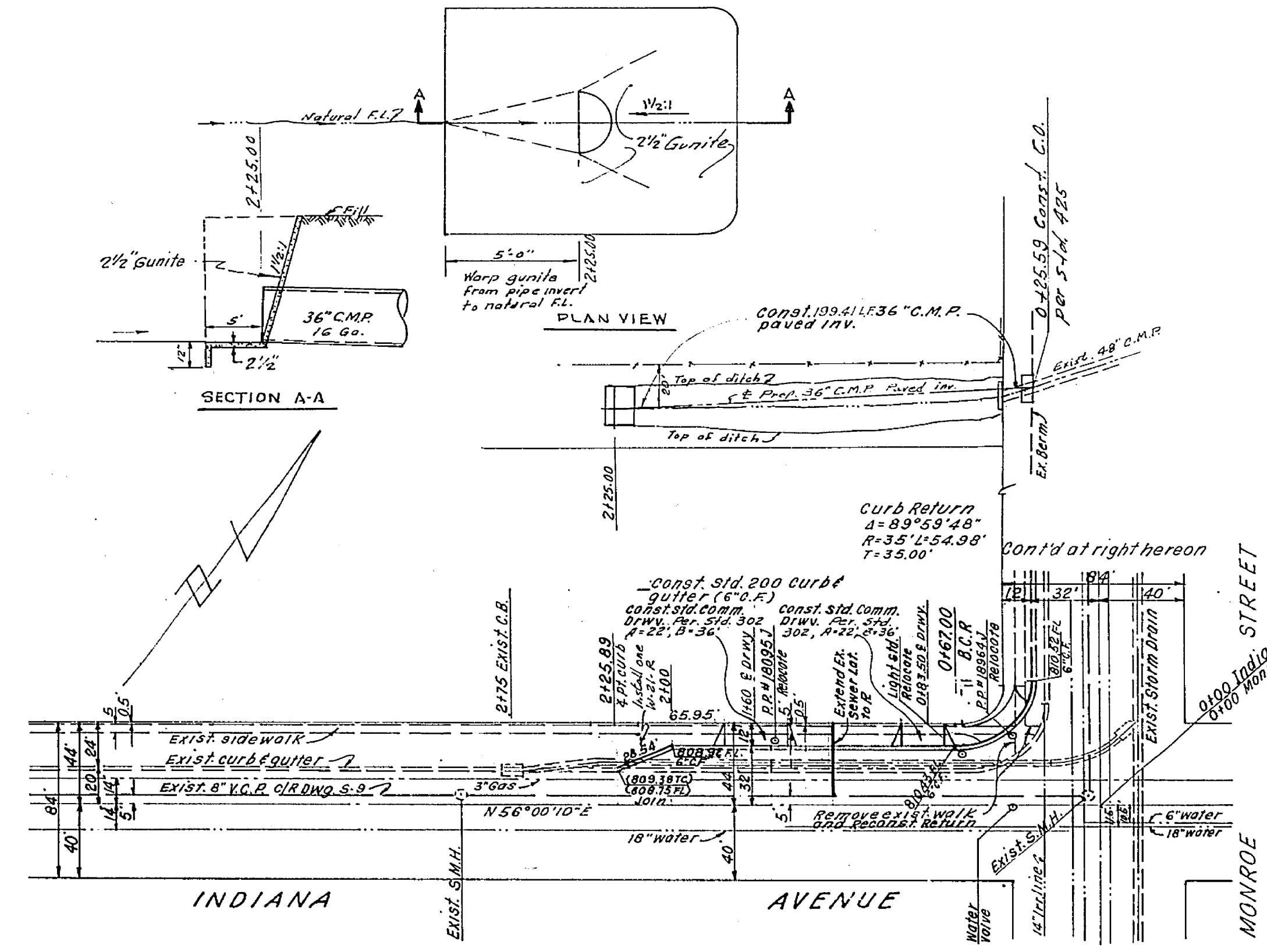
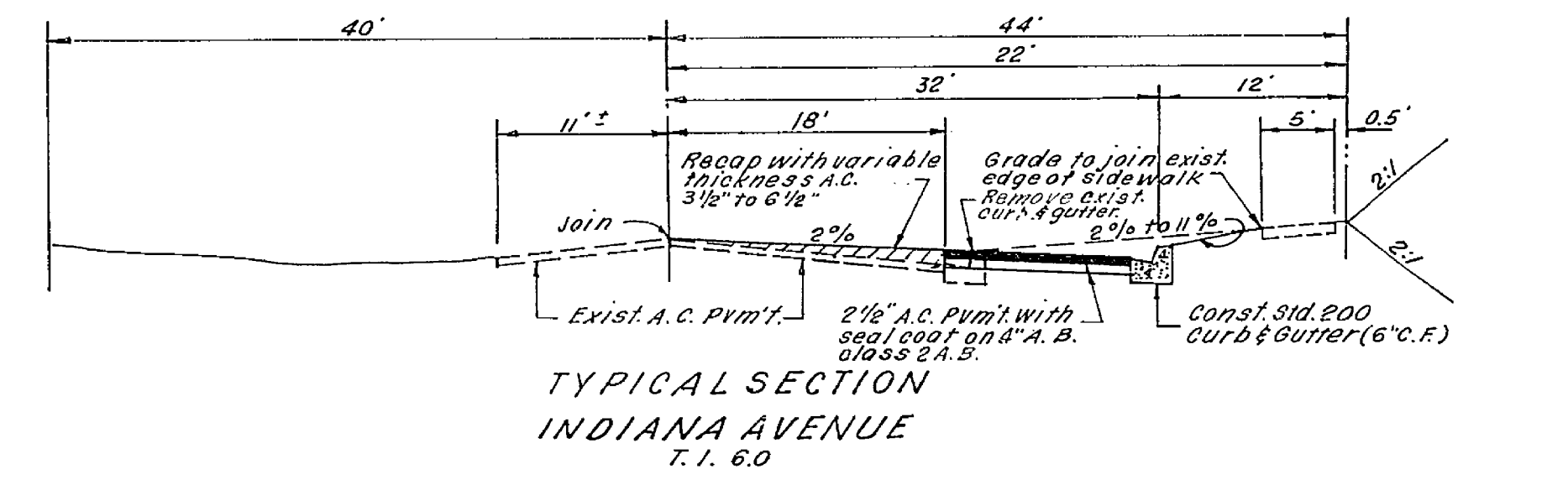
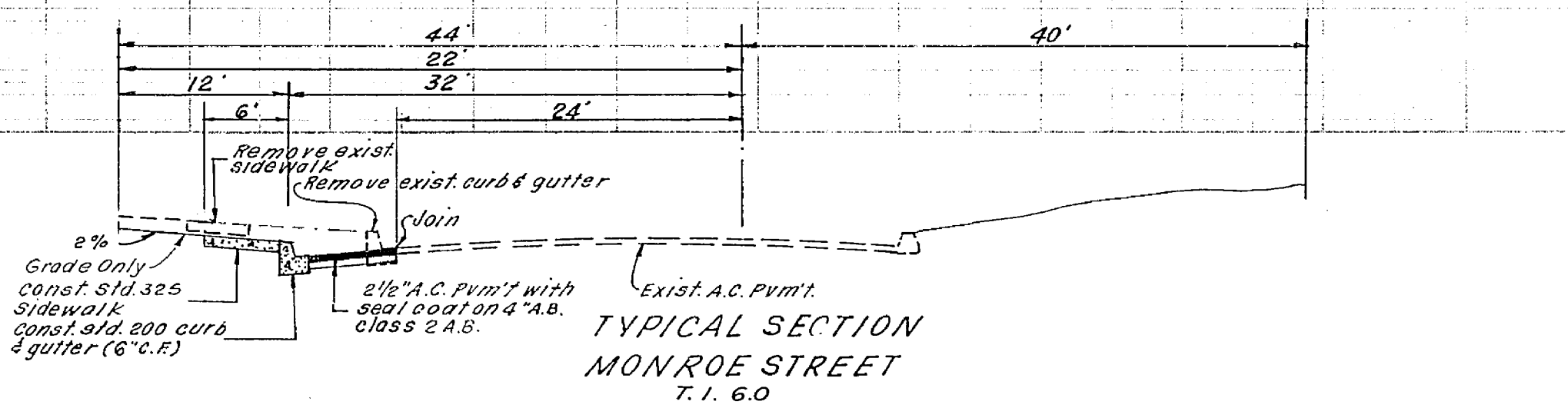

PLANS PREPARED BY:  
**E.L. PEARSON & ASSOCIATES**  
 12345 SO HAWTHORNE WAY,  
 HAWTHORNE, CALIFORNIA

| REVISION |      | DESCRIPTION |
|----------|------|-------------|
| MARK     | DATE |             |
|          |      |             |

S.R. 81 R-55 SS 343

CITY OF RIVERSIDE, CALIFORNIA  
 DEPARTMENT OF PUBLIC WORKS

**STREET PLAN & PROFILE**  
**INDIANA AVENUE**  
 MONROE ST TO 850' WESTERLY NORTH SIDE  
 MONROE STREET  
 INDIANA AVE. TO 150' NORTHERLY WEST SIDE  
**R-89-656**

|           |                    |          |                 |                          |
|-----------|--------------------|----------|-----------------|--------------------------|
| DATE      | SEPT. 6, 1966      | SCALE    | HORIZ. 1" = 50' | APPROVED BY              |
| DRAWN     | R.D.S.             | W.O.     | VERT. 1" = 50'  |                          |
| CHECKED   | W.F. I.            | F.B.     |                 | DIRECTOR OF PUBLIC WORKS |
| SIGNATURE | <i>[Signature]</i> | NO. 9157 |                 |                          |
| DATE      | 1-9-67             |          |                 | NO. R-1103               |
|           |                    |          |                 | SHEET 1 OF 1             |