

BENCH MARK. SPIKE IN LEAD AT M.O.C.
 IN CURB RETURN AT THE SOUTHEAST CORNER
 OF BROCKTON AVENUE AND 14TH STREET
 ELEV. 799.14' CITY OF RIVERSIDE P.B. 1/59.

- GENERAL NOTES:**
- IT SHALL BE THE RESPONSIBILITY OF THE CONTRACTOR TO CLEAR THE R/W IN ACCORDANCE WITH PROVISIONS OF LAW AS IT AFFECTS EACH UTILITY INCLUDING IRRIGATION LINES AND APPURTENANCES AND AT NO COST TO THE CITY
 - CONSTRUCTION SHALL BE IN ACCORDANCE WITH THE CITY OF RIVERSIDE DEPT. OF PUBLIC WORKS SPECIFICATION NO. 461 AND STANDARD DRAWINGS
 - PRIME COAT, SEAL COAT, & PAINT BINDER ARE REQUIRED
 - TRIM EDGE OF EXISTING PAVEMENT WHERE NEW PAVING JOINS EXISTING PAVEMENT TO A CLEAN STRAIGHT LINE. CONSTRUCT MATCH UP PAVING AS SHOWN AND OVERLAY PAVING AS DIRECTED IN THE FIELD TO PRODUCE A SMOOTH CROWN SECTION
 - FOR RELOCATION OF ANY CITY DOMESTIC OR IRRIGATION WATER FACILITY, OR ELECTRIC POWER UTILITY FACILITY TO BE DONE BY CITY FORCES, CONTACT THE CITY WATER COMMERCIAL ENGINEER AT 787-7641. SCHEDULE ABOUT 2 WEEKS TO PROCESS A WORK ORDER BEFORE RELOCATION WORK BEGINS.
 - GRADING WILL REQUIRE A PERMIT UNDER ORDINANCE 3093 FOR A CUT OR FILL EXCEEDING 100 CU YDS. OR A FILL OVER ONE FOOT IN DEPTH.
 - THE AMOUNT OF ASPHALT OVERLAY ON EXISTING PAVEMENT HAS BEEN ESTIMATED BY THE ENGINEER TO BE APPROX. 25 TONS
- STREET LIGHTING NOTES:**
- All street light standards and pullboxes to be located in the field.
 - All street light standards shall be checked for clearance of driveways and pipes from end of curb return.
 - See City of Riverside Drawing N° LI-1301 for light standard details
 - All wires to be AWG N°8 copper
 - This is a 2 wire 120 volt multiple system.
 - All construction to comply with City of Riverside Street Light Specification.
 - Inspections to be called for as outlined in specifications.
 - Feed point to be confirmed at time of construction.
 - \$5.00 inspection fee to be paid; (date paid)
 - The City of Riverside Traffic Engineering Division will pay \$ 75.00 toward the cost of this project to the Developer upon completion of the work and receipt of a statement from the Developer.
 - Excavation for street light standards, bases, pullboxes and conduits must be done after installation of curbs and gutters but before installation of sidewalks.
 - Backfill to be of type and compacted as specified by City of Riverside Public Works Department.
 - City of Riverside to connect street light cables to existing circuit.

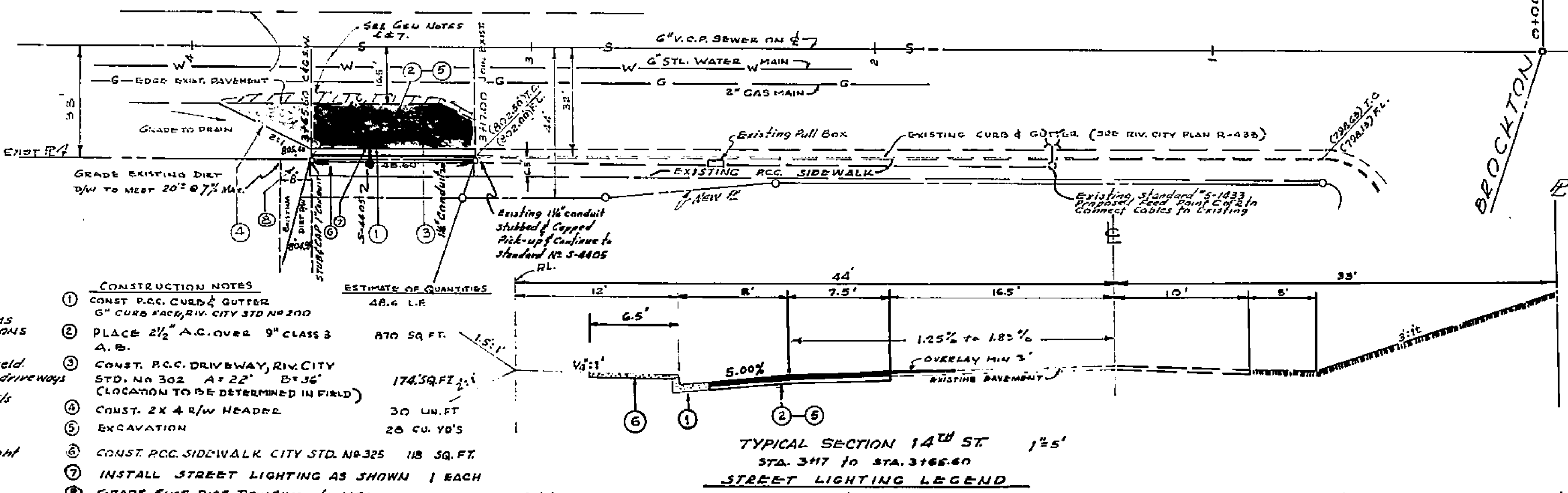

CONSTRUCTION NOTES

- CONST. R.C.C. CURB & GUTTER 6" CURB FACE, RIV. CITY STD. NO. 200
- PLACE 2 1/2" A.C. OVER 9" CLASS 3 A. B.
- CONST. R.C.C. DRIVEWAY, RIV. CITY STD. NO. 302 AT 22' B*36' (LOCATION TO BE DETERMINED IN FIELD)
- CONST. 2X 4 R/W HEADER
- EXCAVATION
- CONST. R.C.C. SIDEWALK CITY STD. NO. 325 118 SQ. FT.
- INSTALL STREET LIGHTING AS SHOWN | EACH
- GRADE EXIST. DIAT. DRIVEWAY TO MEET NEW FLOW LINE.

ESTIMATE OF QUANTITIES

48.4 L.F.	174.50 SQ. FT.	30 LIN. FT.	20 CU. YD'S	118 SQ. FT.
-----------	----------------	-------------	-------------	-------------

- STREET LIGHTING LEGEND**
- Indicates City of Riverside marbleite light standard N° 68101 with 20,000L, 400W, type III "Line Material" mercury vapor luminaire col. N° LM53AE or approved equal.
 - Indicates 1" rigid galv. steel conduit, except as noted
 - Indicates existing conduit
 - Indicates existing pullbox.
 - Indicates existing standard.

APPROVED F.I.R. STREET LIGHTS	THORNE SURVEYING SERVICE RIVERSIDE, CALIFORNIA C.V. BROWN JR. CIVIL ENGINEER	CITY OF RIVERSIDE, CALIFORNIA DEPARTMENT OF PUBLIC WORKS	STREET PLAN & PROFILE S.S. FOURTEETH STREET 317' TO 365.60' WLY OF BROCKTON AVE.	PROJECT NO. L5-13235
<i>E.B. Dugan</i> GENERAL SUPT. & CHIEF ENGINEER	APPROVED BY <i>[Signature]</i> RE 7702 DATE 11-22-66	APPROVED BY <i>[Signature]</i> DATE SEPT. 4, 1968	R-52-401	R-1211
DATE: 3/6 10 1967	DESIGNED BY C.V.B. DRAWN BY W.D.V. CHECKED BY C.V.B.	APPROVED BY <i>[Signature]</i> DATE SEPT. 4, 1968	HORIZ. SCALE: 1" = 20' VERT. SCALE: 1" = 4'	SHEET 1 OF 1