

738 LT

738 LT

738 E

738 E

738 RT

738 RT

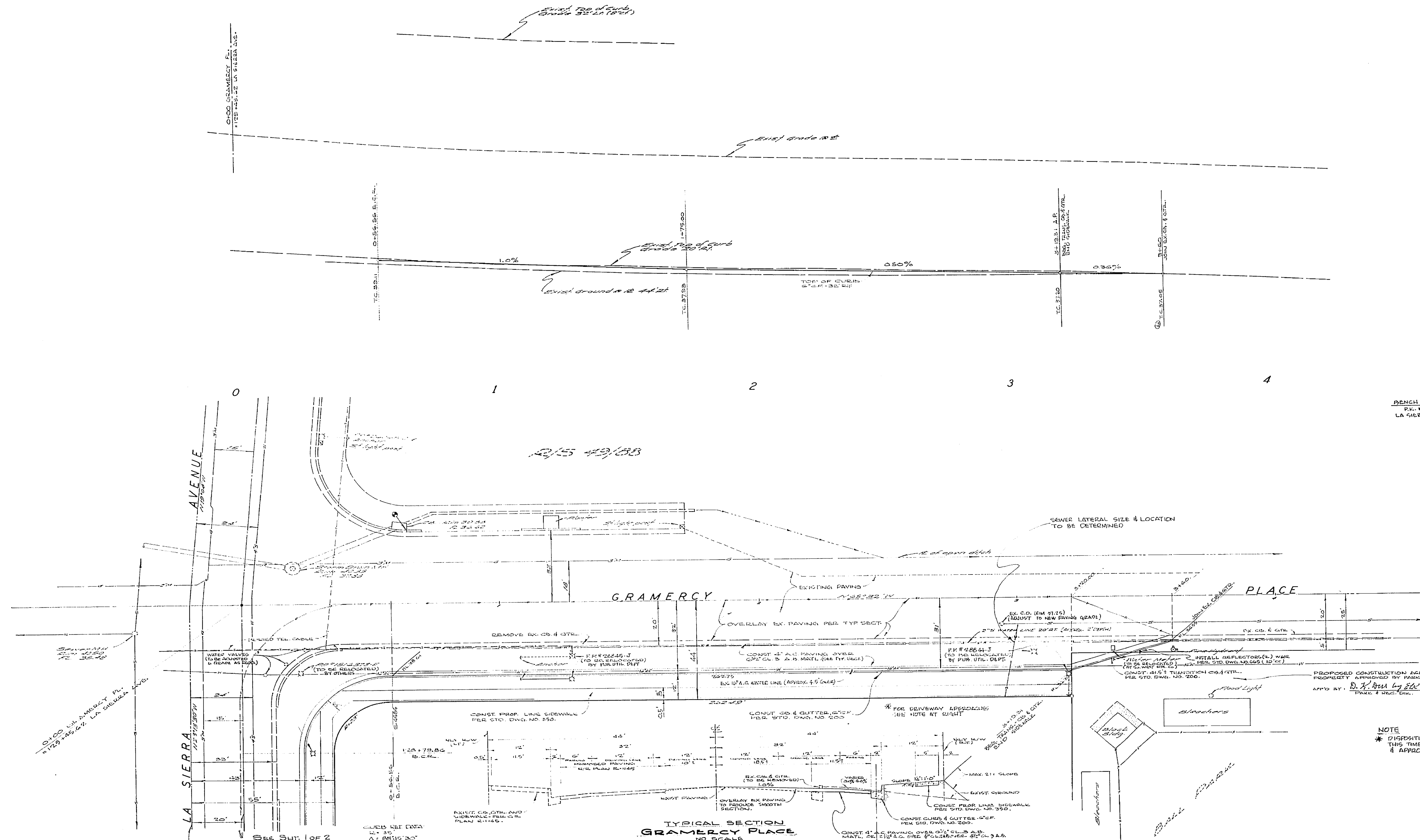

BENCH MARK: C.R. 704/132 (NEAR E.B. 100/64)
 P.K. NAIL IN S.E. CORN. RETURN, GRAMERCY AND
 LA SIERRA. ELEV. 740.215

2/15 49/88

NOTE
 * DISPOSITION OF DRIVEWAY APPROACHES NOT KNOWN AT THIS TIME - NUMBER, WIDTH & LOCATION TO BE DETERMINED & APPROVED AT TIME OF BUILDING PERMIT APPLICATION.

TYPICAL SECTION
 GRAMERCY PLACE
 NO SCALE
 T.I. & 7

ALBERT A. WEBB ASSOCIATES
 CIVIL ENGINEERS
 RIVERSIDE, CALIFORNIA
 APPROVED BY: *[Signature]* DATE: 7/19/67
 R.E. No. 9876

CITY OF RIVERSIDE, CALIFORNIA
 DEPARTMENT OF PUBLIC WORKS
 APPROVED BY: *[Signature]* DATE: 6-4-70
 OFFICE ENGINEER
 PARK DEPARTMENT
 TRAFFIC DIVISION
 ASSISTANT CITY ENGINEER

STREET PLAN AND PROFILE
 SOUTHEAST CORNER
 LA SIERRA AVE. — GRAMERCY PL.
 ZONING CASE R-27-667
 HORIZ. SCALE: 1" = 20' VERT. SCALE: 1" = 4'

PROJECT NO.
 L5-13250
 R-1241
 SHEET 2 OF 2
 FILE NO. 67-66-A

W.O. 67-66 FOR: RANCHO LA SIERRA F.B. 48250 DESIGNED BY: S.S.S. DRAWN BY: [Signature] CHECKED BY: [Signature]

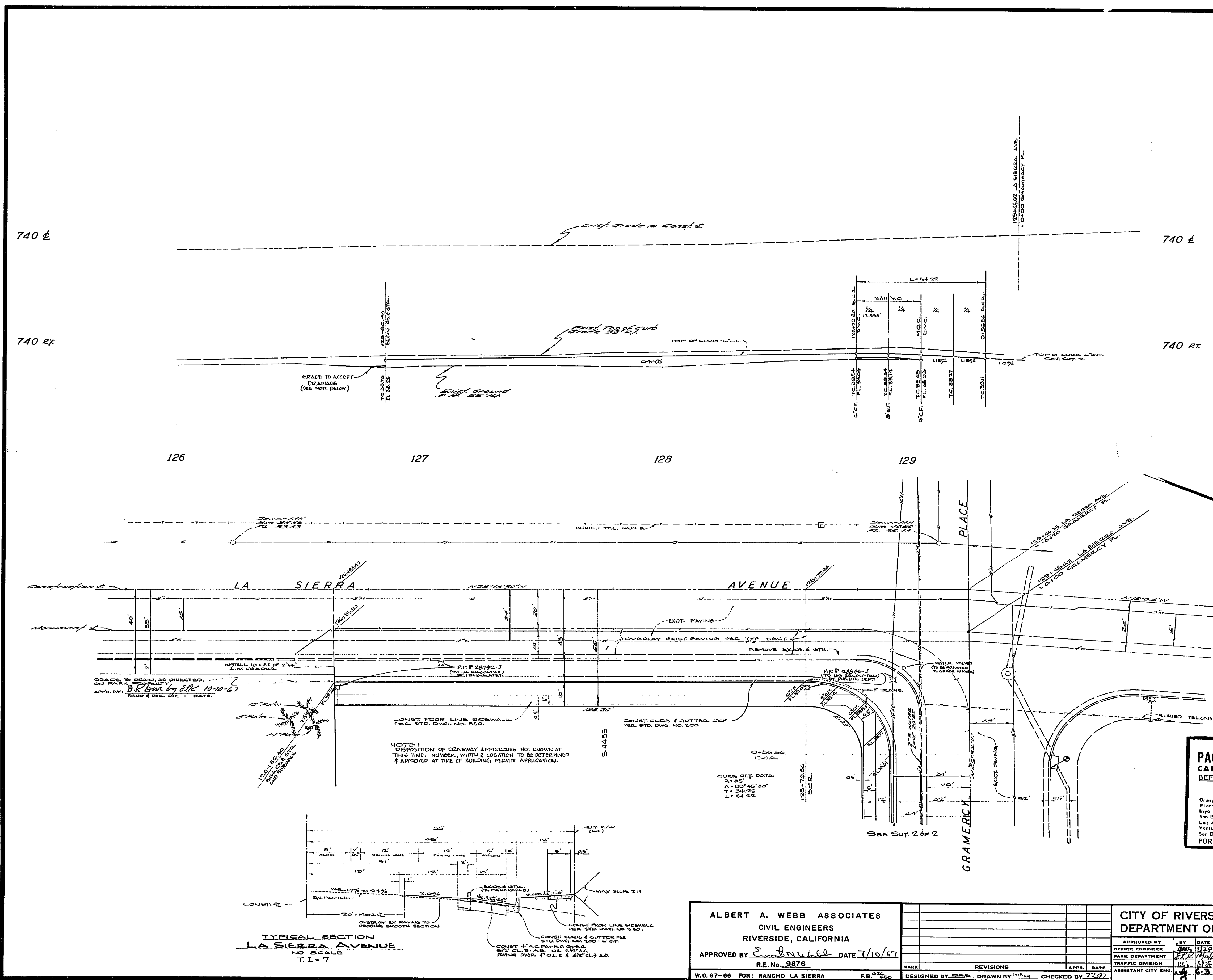

- STREET LIGHT NOTES**
1. ALL STREET LIGHT STANDARDS ARE SUBJECT TO BE APPROVED BY THE CITY ENGINEER, ACCORDING TO PLANS, AND APPROVED BY THE CITY ENGINEER.
 2. ALL STREET LIGHT STANDARDS SHALL BE CHECKED FOR COMPLIANCE WITH THE CITY ENGINEER'S REQUIREMENTS.
 3. EXCAVATION FOR STREET LIGHT STANDARDS SHALL BE DONE IN ACCORDANCE WITH THE CITY ENGINEER'S REQUIREMENTS.
 4. CONTRACTOR TO MAINTAIN A STREET OPENING PERMIT FROM THE CITY OF RIVERSIDE PUBLIC WORKS DEPARTMENT.
 5. CONTRACTOR TO BE RESPONSIBLE FOR THE PROTECTION OF ALL UTILITIES IN THE AREA OF THE STREET LIGHT STANDARDS.
 6. ALL CONSTRUCTION TO BE IN ACCORDANCE WITH THE CITY ENGINEER'S REQUIREMENTS.
 7. INSPECTION TO BE CALLED FOR AT OUTLINE IN SPECIFICATION # 118.
 8. THE TWO WIRE VOLT MULTIPLE SYSTEM.
 9. ALL CABLE TO BE AS SPECIFIED IN SPECIFICATION # 118.
 10. THE CITY OF RIVERSIDE PUBLIC WORKS DEPARTMENT SHALL BE RESPONSIBLE FOR THE PROTECTION OF ALL UTILITIES IN THE AREA OF THE STREET LIGHT STANDARDS.
 11. THE CITY OF RIVERSIDE PUBLIC WORKS DEPARTMENT SHALL BE RESPONSIBLE FOR THE PROTECTION OF ALL UTILITIES IN THE AREA OF THE STREET LIGHT STANDARDS.
 12. THE CITY OF RIVERSIDE PUBLIC WORKS DEPARTMENT SHALL BE RESPONSIBLE FOR THE PROTECTION OF ALL UTILITIES IN THE AREA OF THE STREET LIGHT STANDARDS.
 13. THE CITY OF RIVERSIDE PUBLIC WORKS DEPARTMENT SHALL BE RESPONSIBLE FOR THE PROTECTION OF ALL UTILITIES IN THE AREA OF THE STREET LIGHT STANDARDS.
 14. THE CITY OF RIVERSIDE PUBLIC WORKS DEPARTMENT SHALL BE RESPONSIBLE FOR THE PROTECTION OF ALL UTILITIES IN THE AREA OF THE STREET LIGHT STANDARDS.
 15. THE CITY OF RIVERSIDE PUBLIC WORKS DEPARTMENT SHALL BE RESPONSIBLE FOR THE PROTECTION OF ALL UTILITIES IN THE AREA OF THE STREET LIGHT STANDARDS.
 16. THE CITY OF RIVERSIDE PUBLIC WORKS DEPARTMENT SHALL BE RESPONSIBLE FOR THE PROTECTION OF ALL UTILITIES IN THE AREA OF THE STREET LIGHT STANDARDS.
 17. THE CITY OF RIVERSIDE PUBLIC WORKS DEPARTMENT SHALL BE RESPONSIBLE FOR THE PROTECTION OF ALL UTILITIES IN THE AREA OF THE STREET LIGHT STANDARDS.
 18. THE CITY OF RIVERSIDE PUBLIC WORKS DEPARTMENT SHALL BE RESPONSIBLE FOR THE PROTECTION OF ALL UTILITIES IN THE AREA OF THE STREET LIGHT STANDARDS.
 19. THE CITY OF RIVERSIDE PUBLIC WORKS DEPARTMENT SHALL BE RESPONSIBLE FOR THE PROTECTION OF ALL UTILITIES IN THE AREA OF THE STREET LIGHT STANDARDS.
 20. THE CITY OF RIVERSIDE PUBLIC WORKS DEPARTMENT SHALL BE RESPONSIBLE FOR THE PROTECTION OF ALL UTILITIES IN THE AREA OF THE STREET LIGHT STANDARDS.

BENCH MARK: CR. FB. 704/32 (ELEV. 740.215)
PI. NAIL IN S.E. CURB RETURN, GRAMERCY AND LA SIERRA. ELEV. 740.215

- CONSTRUCTION NOTES**
1. It shall be the responsibility of the contractor to obtain the right of way in accordance with the provisions of the City of Riverside, California, Department of Public Works, Specifications No. 401 and 501.
 2. Construction shall be in accordance with the City of Riverside, California, Department of Public Works, Specifications No. 401 and 501.
 3. Prime coat, seal coat, and paint binder are required.
 4. The contractor shall be responsible for the protection of all existing utilities in the area of the project.
 5. The contractor shall be responsible for the protection of all existing utilities in the area of the project.
 6. The contractor shall be responsible for the protection of all existing utilities in the area of the project.
 7. The contractor shall be responsible for the protection of all existing utilities in the area of the project.
 8. The contractor shall be responsible for the protection of all existing utilities in the area of the project.
 9. The contractor shall be responsible for the protection of all existing utilities in the area of the project.
 10. The contractor shall be responsible for the protection of all existing utilities in the area of the project.
 11. The contractor shall be responsible for the protection of all existing utilities in the area of the project.
 12. The contractor shall be responsible for the protection of all existing utilities in the area of the project.
 13. The contractor shall be responsible for the protection of all existing utilities in the area of the project.
 14. The contractor shall be responsible for the protection of all existing utilities in the area of the project.
 15. The contractor shall be responsible for the protection of all existing utilities in the area of the project.
 16. The contractor shall be responsible for the protection of all existing utilities in the area of the project.
 17. The contractor shall be responsible for the protection of all existing utilities in the area of the project.
 18. The contractor shall be responsible for the protection of all existing utilities in the area of the project.
 19. The contractor shall be responsible for the protection of all existing utilities in the area of the project.
 20. The contractor shall be responsible for the protection of all existing utilities in the area of the project.

**-CAUTION-
 PACIFIC TELEPHONE
 CABLES UNDERGROUND
 BEFORE EXCAVATING
 CALL COLLECT:**

7:30 A.M. to 5 P.M. & Holidays
 Other Hours
 Orange County 714-633-0811 714-547-6606
 Riverside County 714-684-0071 714-547-6606
 Inyo County 714-684-0071 714-547-6606
 San Bernardino County 714-684-0071 714-547-6606
 Los Angeles County 213-621-3111 24 HOUR SERVICE
 San Diego County 714-298-0936 714-232-0027

FOR FREE CABLE LOCATING SERVICE

QUANTITY ESTIMATE

CURB AND GUTTER-G.F.P. STD. DWG. NO. 200	541 LF.
CONCRETE SIDEWALK-STD. DWG. NO. 200	541 SF.
A.C. PAVING OVERLAY (SEE TYP. SECT.)	6500 SF.
A.R. MATERIAL (SEE TYP. SECT.)	92 SF.
PROP. LINE SIDEWALK, STD. DWG. NO. 200	6500 SF.
REFLECTORS - W212 - STD. DWG. NO. 605	2 EA.

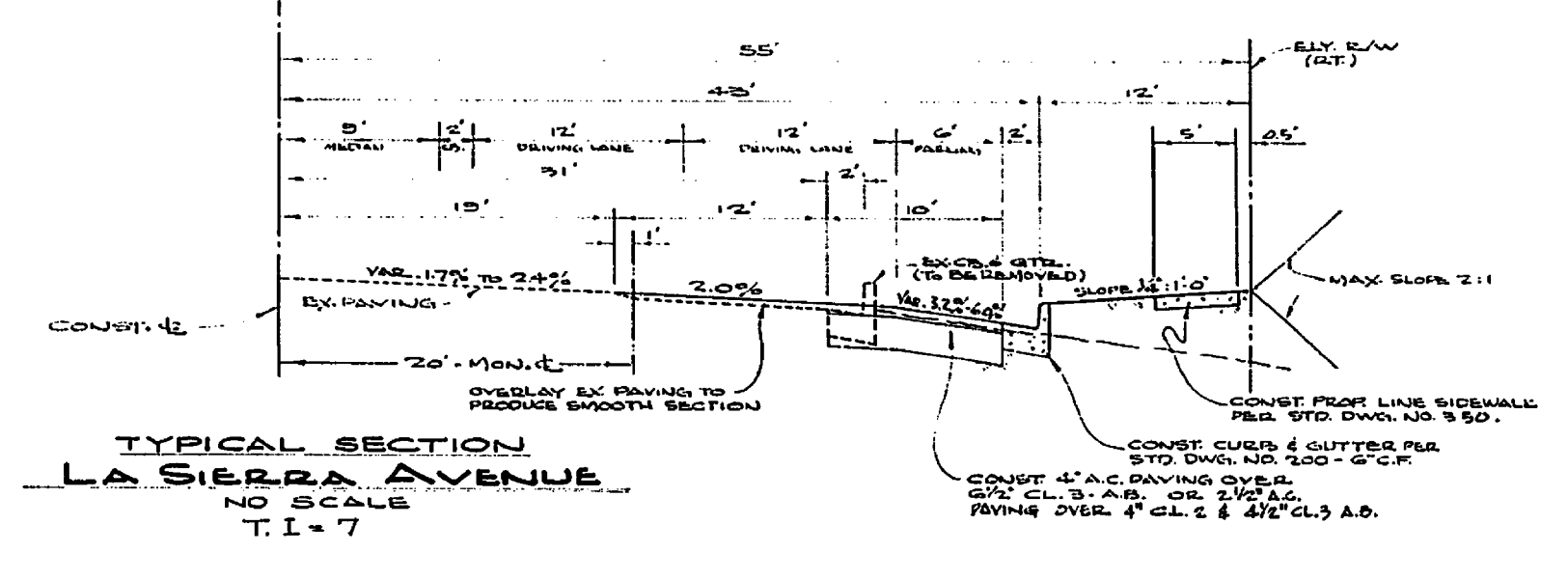

ALBERT A. WEBB ASSOCIATES CIVIL ENGINEERS RIVERSIDE, CALIFORNIA APPROVED BY: <i>[Signature]</i> DATE: 7/10/67 R.E. No. 9876 W.O. 67-66 FOR: RANCHO LA SIERRA F.B. 67-66	MARK REVISIONS APPR. DATE DESIGNED BY: <i>[Signature]</i> DRAWN BY: <i>[Signature]</i> CHECKED BY: <i>[Signature]</i>	CITY OF RIVERSIDE, CALIFORNIA DEPARTMENT OF PUBLIC WORKS APPROVED BY: <i>[Signature]</i> DATE: 6-4-70 OFFICE ENGINEER TRAFFIC DIVISION ASSISTANT CITY ENG.	STREET PLAN AND PROFILE SOUTHEAST CORNER LA SIERRA AVE. — GRAMERCY PL. ZONING CASE R-27-667	PROJECT NO. 357 L5-13250 R-1241 SHEET 1 OF 2 FILE NO. 67-66-A
		HORIZ. SCALE: 1" = 20' VERT. SCALE: 1" = 4'		