

890 LEFT

890 @

890 RIGHT

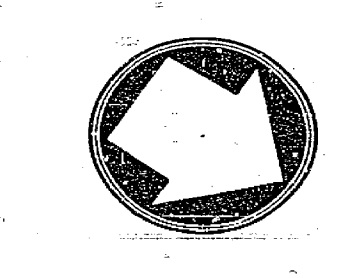

AVENUE
LINCOLN

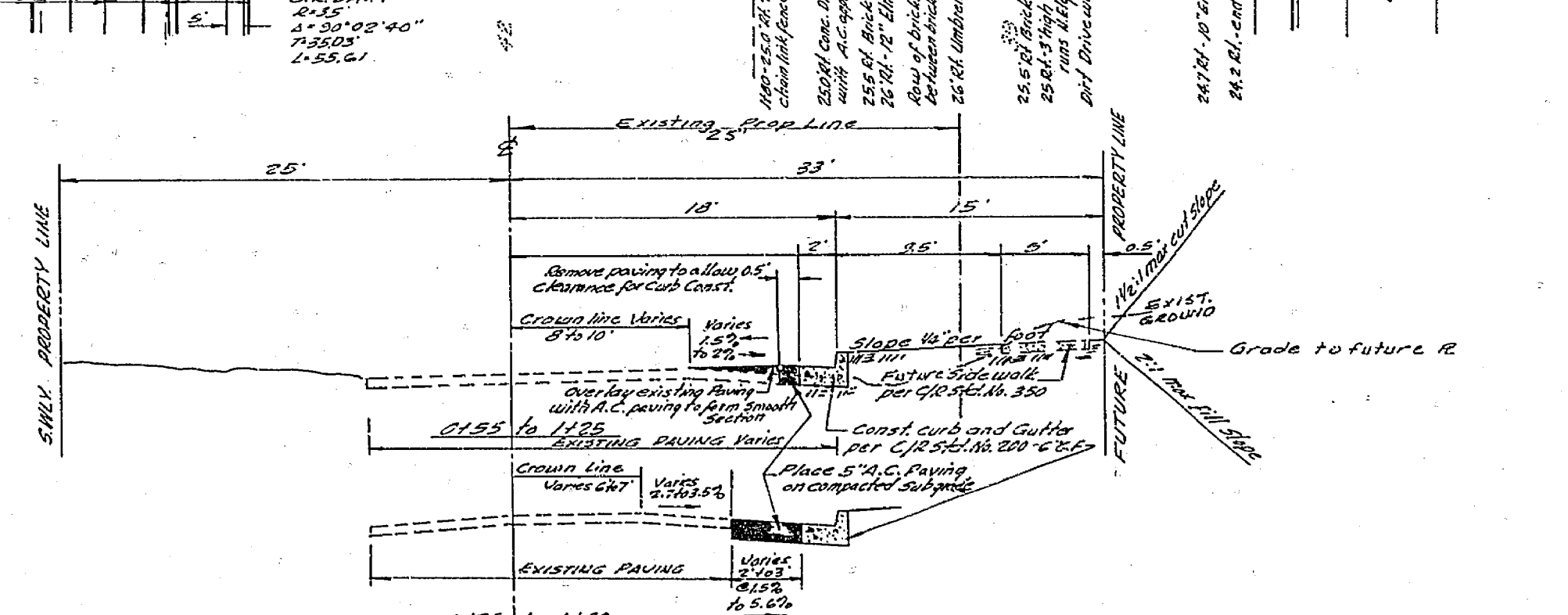
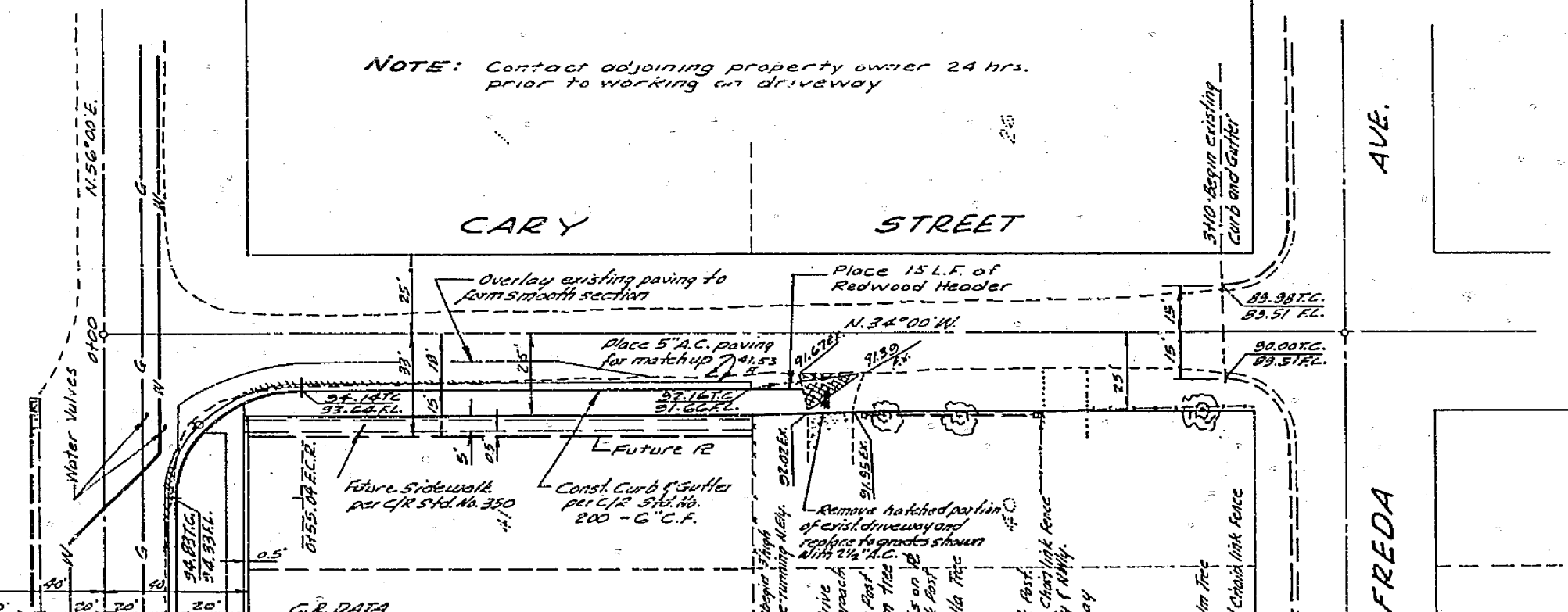

TYPICAL SECTION
CARY STREET
SCALE: 1/4" = 1'-0"
T. I. = 5

BENCH MARK "X" cut in outlet of fire hydrant 5.8' from Freda and Cary Street per G.S. 4400 ST. Elevation BM 92.9

CRAWLEY, HAWKINS & HIEBER
ENGINEERS and SURVEYORS
RIVERSIDE, CALIFORNIA 92502
APPROVED FOR STREET LIGHTS
APPROVED *George O. Crawley* DATE 4/26/68
GENERAL SUPERVISOR ENGINEER DATE

APPROVED BY *[Signature]* DATE 4-26-68
OFFICE ENGINEER
TRAFFIC DIVISION
APPROVED BY *[Signature]* DATE 6-17-68
DIRECTOR OF PUBLIC WORKS

CITY OF RIVERSIDE, CALIFORNIA
DEPARTMENT OF PUBLIC WORKS
APPROVED BY *[Signature]* DATE 6-17-68
OFFICE ENGINEER
TRAFFIC DIVISION
APPROVED BY *[Signature]* DATE 6-17-68
DIRECTOR OF PUBLIC WORKS

STREET PLAN & PROFILE
LINCOLN AVE. CARY STREET TO 1753
LINCOLN AVE. 180' EAST SIDE N.W.Y.
PROJECT NO. R-1288
SHEET 1 OF 1
FILE NO. 4130
HORIZ. SCALE: 1" = 40'
VERT. SCALE: 1" = 4'

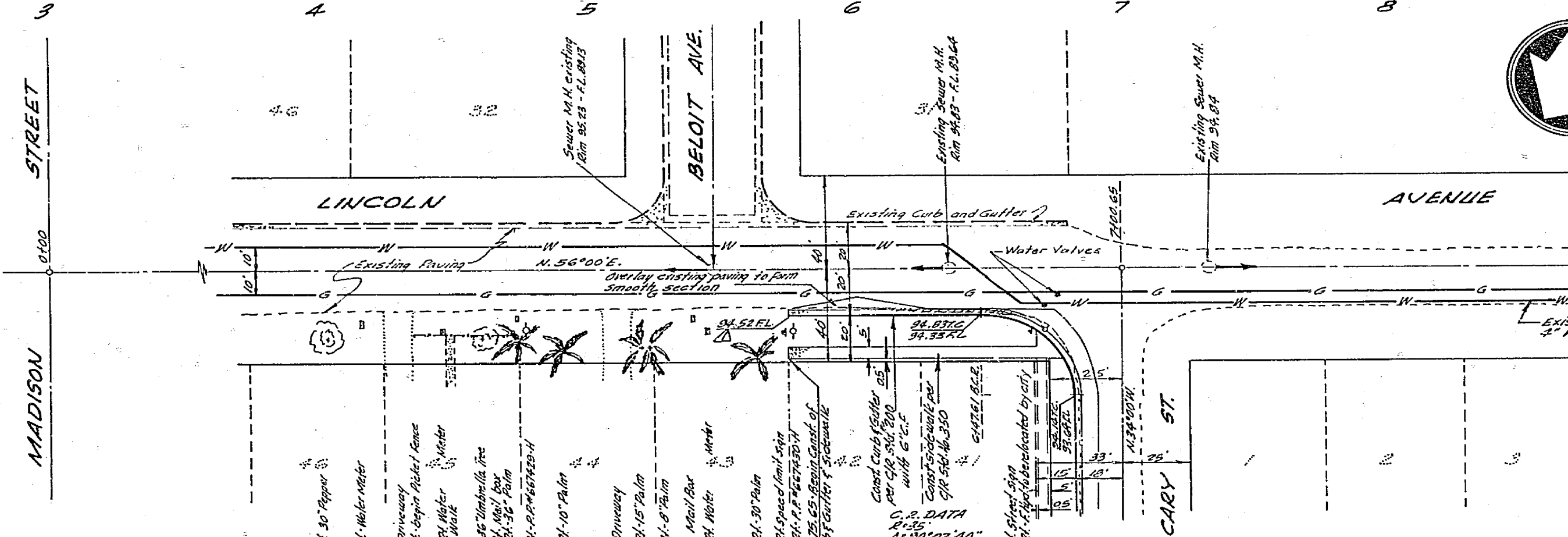
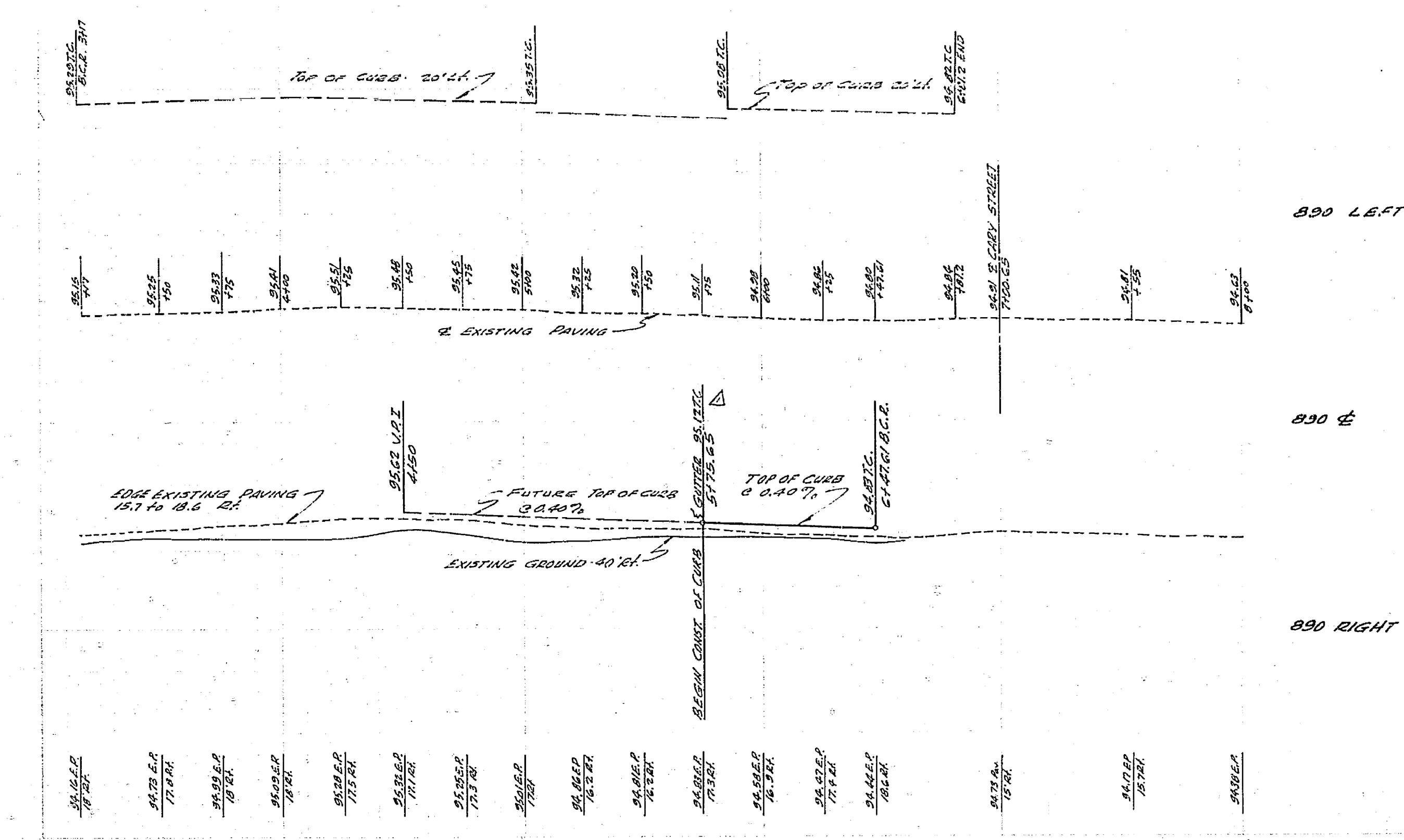

TYPICAL SECTION
LINCOLN AVENUE
SCALE: 1/4" = 1'-0"
T. I. = 6

- GENERAL NOTES**
1. Construction shall be in accordance with the City of Riverside, Department of Public Works Specifications No. 451 and Standard Drawings.
 2. It shall be the responsibility of the contractor to clear the right of way in accordance with the provisions of the law as to locate and utility including irrigation lines and easements and at no cost to the city.
 3. Prime coat, seal coat and paint binder are required.
 4. Grading will require a permit under Ordinance No. 3089 for cut or fill exceeding 100 cubic yards or a fill over one foot in depth.
 5. Trim edge of existing pavement where new paving joins existing paving to a clean straight edge. Construct match-up paving as shown and overlay as checked in the field to produce a smooth crown section. Engineer's estimate of pavement overlay is 3" plus.
 6. The finished subgrade shall have a composition of not less than 92% in a depth of 6" as determined by test Method No. "Emp-512" immediately prior to placement of the owner.
 7. The contractor shall notify Pacific Telephone 684-0071 (Cable locations) at least 24 hours before doing any excavating within the rightway.