

- STREET LIGHT NOTES**
- (1) All street light standards and pullboxes to be field located by contractor, according to plans, and approved by utilities personnel.
 - (2) All street light standards shall be checked for clearance of drive-ways, fire hydrants, and radius returns.
 - (3) Excavation for street light standard bases, pullboxes, and conduits must be done after installation of curbs and gutters, but before installation of sidewalks.
 - (4) Contractor to obtain a street opening permit from City of Riverside Public Works Department prior to any excavation in proposed or dedicated street Right-of-Way.
 - (5) Backfill to be of type and compacted as specified by City of Riverside Public Works Department Specification #461.
 - (6) All construction to comply with the latest revision of the City of Riverside Public Utilities Department Street Light Specification #119.
 - (7) Inspections to be called for as outlined in Specification #119.
 - (8) This is a two wire _____ volt multiple system.
 - (9) All cable to be as specified in Specification #119.
 - (10) Feed point to be confirmed at time of construction.

(11) See City of Riverside Ord. No. 11-12008 for Light Standard Details, Ord. No. 11-13008 for Pullbox Details.

UD \$ 5.32 connection and inspection fees to be paid; _____ (Date paid)

LEGEND

- ⊛ Indicates City of Riverside multiple light standard No. 425A with 1/2" O.D., 2 1/2" I.D. "Line Material" wire rope lamp luminaires, Cal. No. LM 43A2 or approved equal.
- ⊞ Indicates No. 3 1/2" pullbox Brooks Products Inc. or Quikset # 2-17 approved equal.
- Indicates 1" rigid galv steel conduit, except as noted.

NOTE: Existing driveway openings on Wilbur St. and Donald St. to be closed as directed by the Public Works Dept.

NOTE: SEE SHEET 2 FOR TYPICAL SECTION

Approved for Irrigation work
Albert A. Webb
 Civil Engineer
 Date: 8-7-68

Approved for Street Lights
Albert A. Webb
 Civil Engineer
 Date: 5-21-68

CAUTION
PACIFIC TELEPHONE
CABLES UNDERGROUND
BEFORE EXCAVATING

CALL COLLECT:
 7:30 A.M. to 5 P.M. Alter Hours
 Orange County 714-633-0811 714-547-6006
 Riverside County 714-684-0071 714-547-6606
 Inyo County 714-684-0071 714-547-6606
 San Bernardino County 714-684-0071 714-547-6606
 Los Angeles County 213-621-3111 24 HOUR SERVICE
 Ventura County 213-621-3111
 San Diego County 714-298-0595 714-232-0027

FOR FREE CABLE LOCATING SERVICE

ALBERT A. WEBB ASSOCIATES
 CIVIL ENGINEERS
 RIVERSIDE, CALIFORNIA

APPROVED BY *Albert A. Webb* DATE 8-11-68
 R.E. No. 9878

W.O. 68-101 FOR: St. Thomas Catholic Church F.B. 1003

CITY OF RIVERSIDE, CALIFORNIA
DEPARTMENT OF PUBLIC WORKS

APPROVED BY *Albert A. Webb* DATE 8-12-68
 OFFICE ENGINEER
 PARK DEPARTMENT
 TRAFFIC DIVISION
 ASSISTANT CITY ENG.

STREET PLAN & PROFILE
JACKSON STREET
 Wly Side, Between Magnolia Ave. & Hendry Ave.
 S.U.P. No. C-17-678

PROJECT NO.
R-1301

FILE NO.
68-101-A

QUANTITY ESTIMATE

Curb & Gutter Standard No. 200 (16" C&G)	569 LF
Sidewalk Standard No. 350	2,240 S.F.
2 1/2" A.C.	0,250 S.F.
Imported Base Material	1 EA
Driveway Approach Standard 302	1 EA
Catch Basin Standard 465 (Wapping)	28 LF
18" A.C. 2000	597 LF
Conduit Gutter Removal	2,640 S.F.
Sidewalk Removal	3 EA
W-24-R	2 EA
Police Area Rehabilitation	2 EA
Tree Removal	530 S.F.
Cross Gutter Standard No. 220	78 LF
4" Cast Iron Pipe	1 EA
Closure Box Standard No. 425	

BENCH MARK
 N24 in head in south curb return on Andrew St.
 47' Wly of Andrew on Donald Ave. South. Elev 808.415
 C.I.R. F.B. 650/33

- GENERAL NOTES**
- (1) It shall be the responsibility of the contractor to clear the Right of Way in accordance with the provisions of law as it affects such utility, including irrigation lines and appurtenances, and at no cost to the City.
 - (2) Construction shall be in accordance with the City of Riverside, Department of Public Works, Specifications Nos. 461 and Standard Drawings.
 - (3) Prime coat, seal coat, and paint binder are required.
 - (4) Grading will require a permit under Ordinance 1095 for a cut or fill exceeding 100 cubic yards, or a fill over one foot in depth.
 - (5) The subdivider shall arrange for a soil test to be made by a Civil Engineer after the streets have been graded to rough grade. Depth of base material and A.C. paving shall be determined by City of Riverside Design Standards and Test Procedures.
 - (6) Elevation of existing pavement, where new paving is to be placed, shall be a clean, straight line. Contractor match-up paving on shown and overlay paving as directed in the field to produce a smooth even section.

880
 880
 880

S.P. 720 R-58

MATCH LINE SEE SHEET 2

E-10

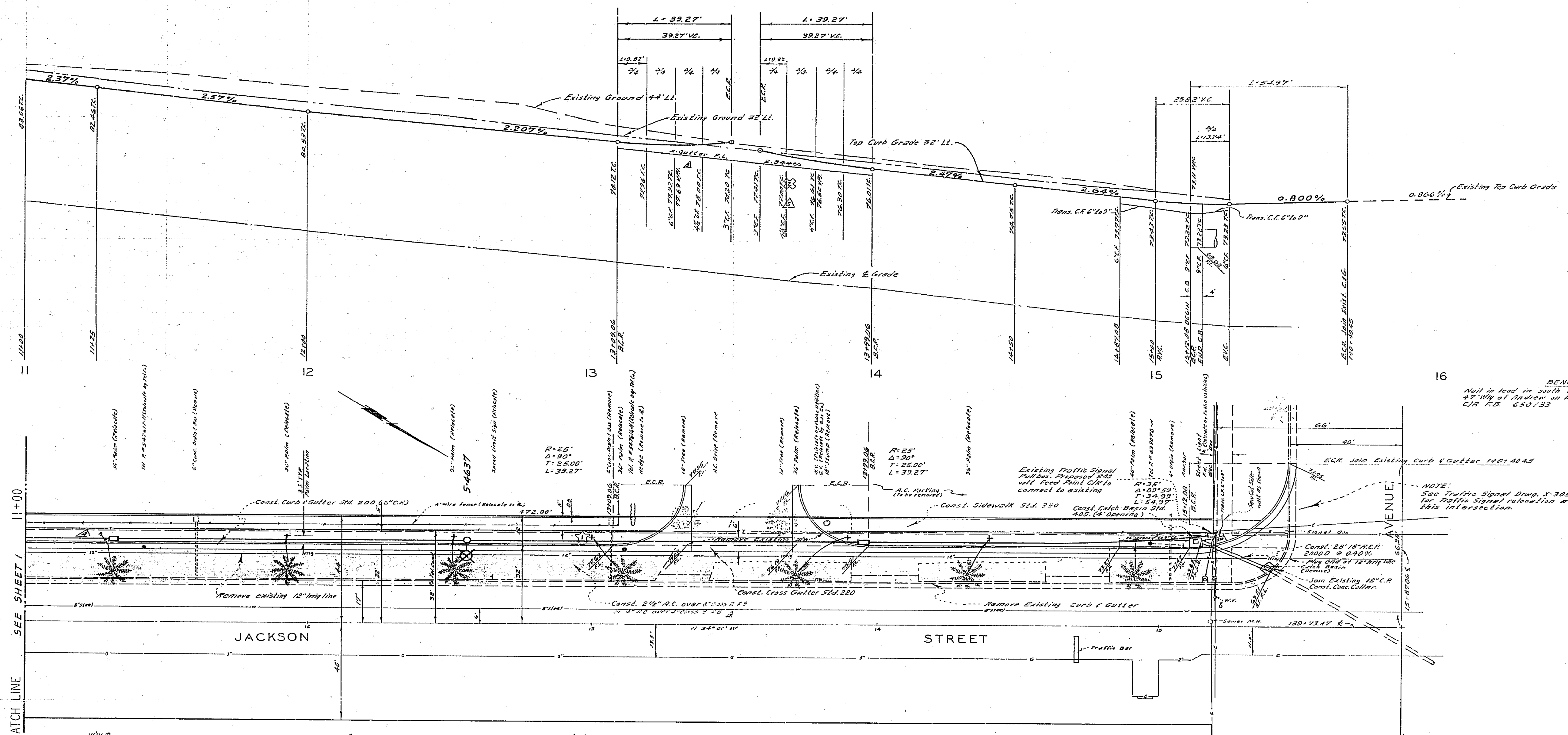

MATCH LINE SEE SHEET 1

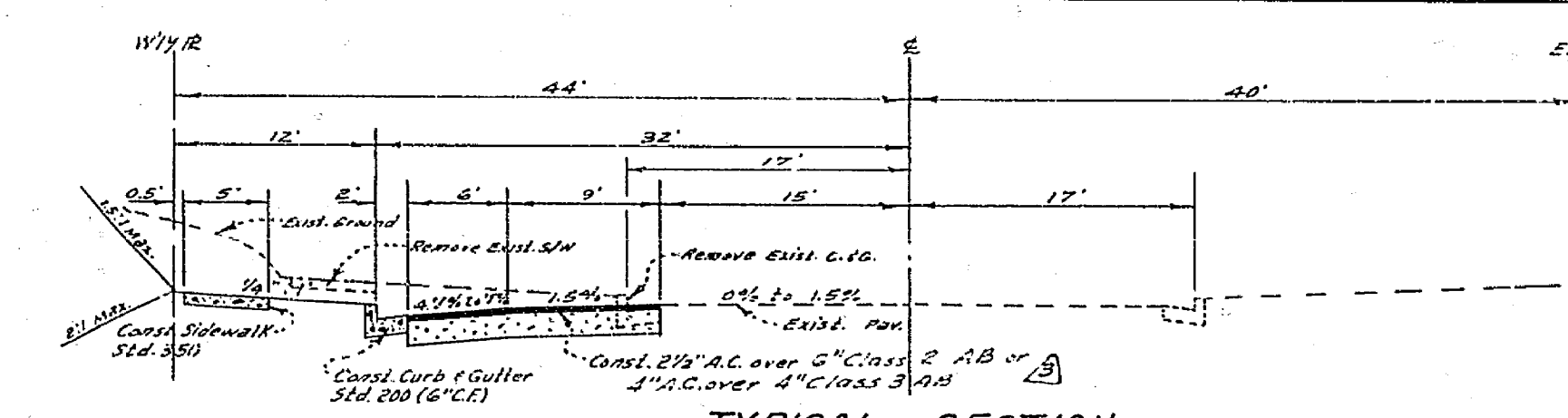

**TYPICAL SECTION
JACKSON STREET**
NO. SCALE
T.I. - 7

NOTE:
Driveway locations to be verified at
time of construction.

-CAUTION-
PACIFIC TELEPHONE
CABLES UNDERGROUND
BEFORE EXCAVATING

CALL COLLECT

7:30 A.M. to 5 P.M. & Holidays

Orange County	714-633-0811	714-547-5606
Riverside County	714-684-0971	714-547-5606
Inyo County	714-684-0071	714-547-5606
San Bernardino County	714-684-0071	714-547-5606
Los Angeles County	213-621-3111	24 HOUR SERVICE
Ventura County	213-621-3111	24 HOUR SERVICE
San Diego County	714-232-0071	714-232-0071

FOR FREE CABLE LOCATING SERVICE

ALBERT A. WEBB ASSOCIATES CIVIL ENGINEERS RIVERSIDE, CALIFORNIA APPROVED BY: <i>[Signature]</i> DATE: 8-11-68 R.E. No. 887.6 <small>W.O. 68-101 FOR St. Thomas Catholic Church F.B. 1003</small>		CITY OF RIVERSIDE, CALIFORNIA DEPARTMENT OF PUBLIC WORKS APPROVED BY: <i>[Signature]</i> DATE: 8-12-68 PARK DEPARTMENT TRAFFIC DIVISION ASSISTANT CITY ENG.		STREET PLAN & PROFILE JACKSON STREET <small>W/y Side, Between Magnolia Ave. & Hendry Ave.</small> G.U.P. No. C-17-678 HORIZ. SCALE: 1" = 20' VERT. SCALE: 1" = 4'		PROJECT NO. R-1301 L5-13311 SHEET 2 OF 2 FILE NO. 68-101-A	
--	--	--	--	---	--	---	--