

CAUTION: High Pressure gas line. Call Southern Calif Gas Co. 682-1660 24 hr prior to excavating.

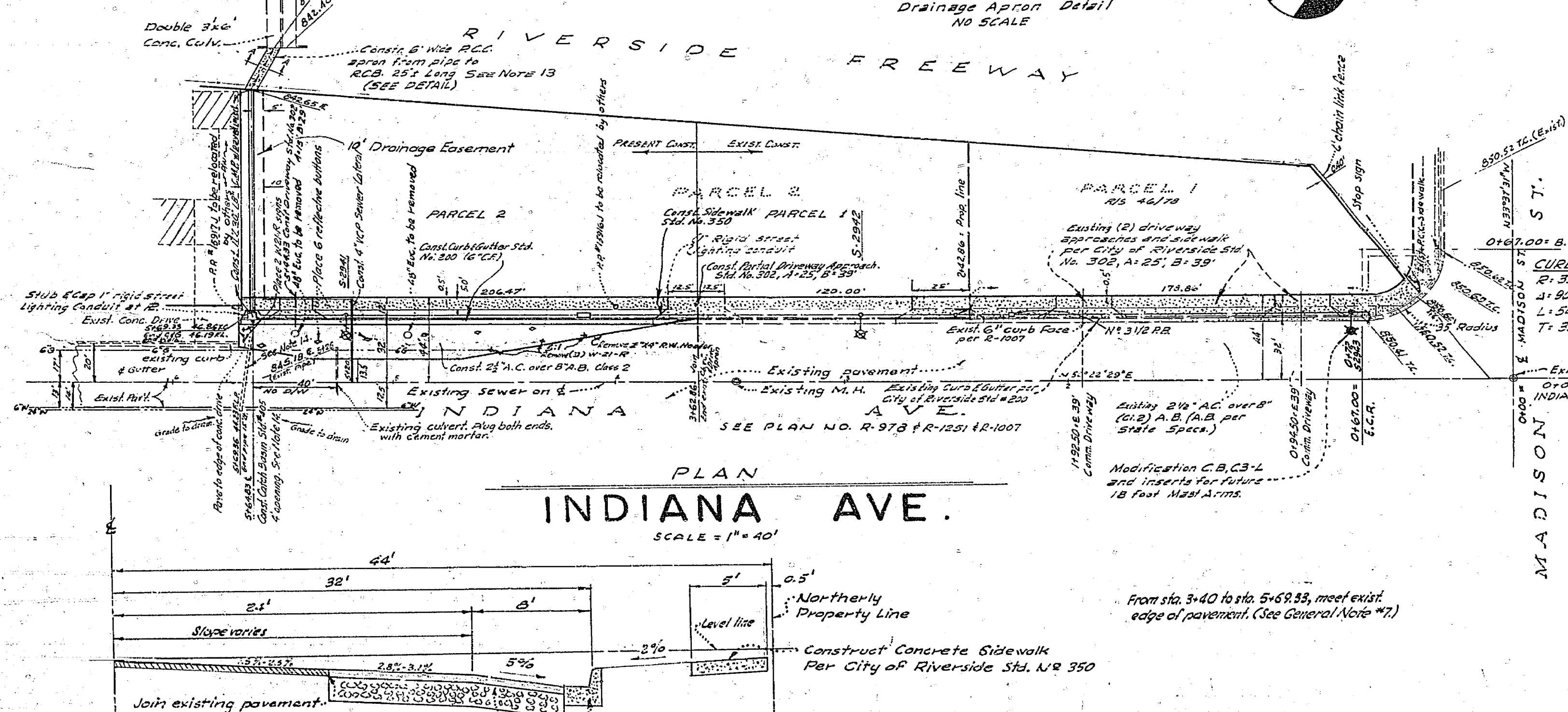
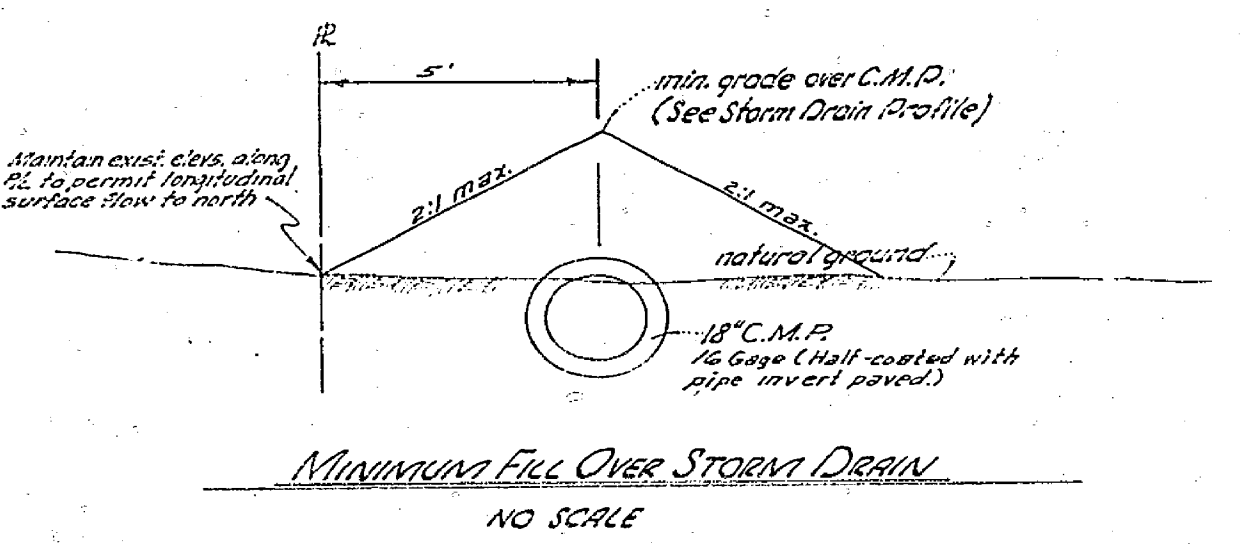
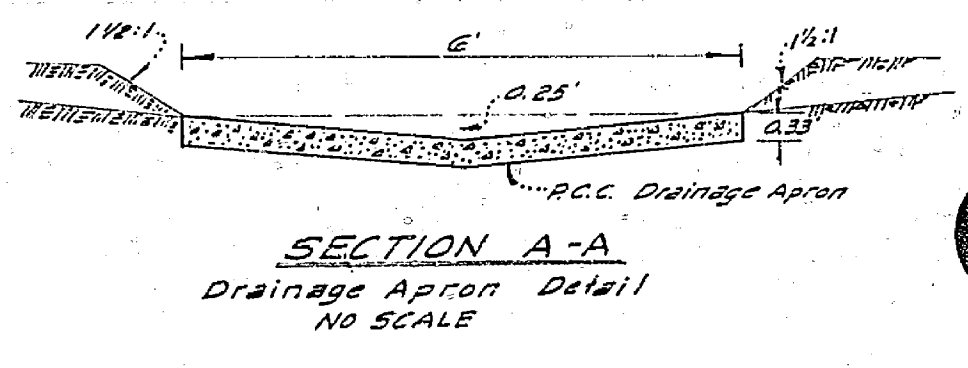

- STREET LIGHTING NOTES:**
1. Light Standards and Pole Spikes to be located in the Field.
 2. All Standards shall be checked for clearance of driveways and be placed 1' from end of curb return.
 3. Inspection shall be called for as outlined in the Specifications.
 4. All construction to comply with City of Riverside Light Dept Street Lighting Specifications.
 5. All Cables to be American wire Gage No. 8.
 6. 10,000 Lumen M.V. Luminaires shall be L.M. Cat # L.M. 43 AB unequal.
 7. The Traffic Division will pay for Traffic Signal modification.
 8. This system to be 2 wire, 200 V. Multiple.
 9. Feed Points to be Determined.
 10. Spacing of Standards shall be as shown on plans.
 11. 15' indicates Light Standard (City of Riverside Std. No. 4524 Marbelite W/10,000 Lumen M.V. Luminaires).
 12. 12' indicates Pole Spike (City of Riverside Std. No. 11-13001).
 13. 1" indicates 1" Conduit (Rigid Galvanized).
 14. 75' indicates CONNECTION SEE PLAN 2-9-65.
 15. 15' indicates Light Standard (City of Riverside Std. No. 6810 Marbelite W/20,000 Lumen M.V. Luminaires).
 16. 20,000 Lumen M.V. Luminaires shall be L.M. Cat. # L.M. 53A2 or equal.

- GENERAL NOTES:**
1. It shall be the responsibility of the contractor to clear the right of way in accordance with provisions of law as it affects each utility, including irrigation lines and appurtenances and of no cost to the city.
 2. Construction shall be in accordance with the City of Riverside, Department of Public Works Specifications No. 461 and Standard Drawings.
 3. Prime coat, seal coat and paint binder are required.
 4. Grading will require a permit under Ordinance 3093 for a cut or fill exceeding 100 cubic yards or a fill exceeding 1 foot in depth.
 5. The developer may arrange for a test of the soil of the subgrade level by a soils engineer. Thickness of pavement and thickness and type of aggregate base shall be determined by the soils engineer and submitted to the City of Riverside for approval.
 6. The finished subgrade shall have compaction of not less than 90% for a depth of 0.5 feet as determined by test method AASHTO T-99 immediately prior to placement of the concrete.
 7. Joint edges of existing pavement where new pavement joins existing pavement to a clean straight line. Construct match-up paving as shown and overlay paving as directed in the field to produce a smooth crown section. Engineer estimates width paving to be 1' on.
 8. Check with street lighting engineer for street light requirements. PH-686-1575, Ext. 361 (After Jan. 1, 1965 (787-7321).
 9. Sewer lateral shall be installed prior to placement of pavement and base.
 10. Bench Mark: Spike and lead in E. end of N. Woodwell on E. side of Madison St. 50' S. of Indiana Ave. City F.B. 499-75. Elev. 354.04'
 11. The contractor to negotiate with the City Engineer for that portion of construction exceeding 20' from the top of gutter prior to construction.
 12. The contractor will contact the Park and Recreation Dept. of the City of Riverside, 24 hours prior to concreting any portion of the parkway strip. The above mentioned Dept. will seal any necessary tree wells. (Call 787-7300).
 13. THE CONTRACTOR SHALL CONTACT THE STATE INSPECTOR 24 HRS PRIOR TO CONSTRUCTION. REF: ENGINE RELOCATION PERMIT No. 66E-769597, DRAIN PERMIT No. 66SE760593. (Call 888-8511).
 14. Plan 12-1251 provides for 18" x 18" CMP with paved invert of 0.45% for connection to catch basin at Sta. 5+64.83 from the southern side of Indiana Ave. Contractor is to extend this culvert, if it exists, into the catch basin or, if the culvert does not exist at time of construction, he shall install 41' of like material from the catch basin as shown hereon.

ONE HALF TYPICAL SECTION INDIANA AVENUE
Scale: Hor. 1" = 40' Vert. 1" = 2' T. 1.6

<p>CRAWLEY, HAWKINS & ASSOCIATES ENGINEERS AND SURVEYORS RIVERSIDE</p> <p>APPROVED: <i>George O. Crawley</i> DATE 10/10/68 REG. CIVIL ENGINEER NO. 9455</p> <p>11-12-68 DATE CHIEF ENGINEER</p>		<p>CITY OF RIVERSIDE, CALIFORNIA DEPARTMENT OF PUBLIC WORKS</p> <p>APPROVED BY: <i>[Signature]</i> DATE 11/22/68 OFFICE ENGINEER TRAFFIC DIVISION ASSISTANT CITY ENG.</p> <p>APPROVED BY: <i>[Signature]</i> DATE 11/22/68 DIRECTOR OF PUBLIC WORKS</p>		<p>PROJECT NO. R-1315</p> <p>INDIANA AVENUE (NORTH SIDE) FROM MADISON ST. TO 562.33 WESTERLY ZONING CASE NO. R-50-634 RECORD OF SURVEY 7951975 SHEET 1 OF 1</p> <p>HORIZ. SCALE: 1" = 40' VERT. SCALE: 1" = 4'</p>
--	--	--	--	--

INDIANA AVE