

735

730

725

720

735

730

725

730

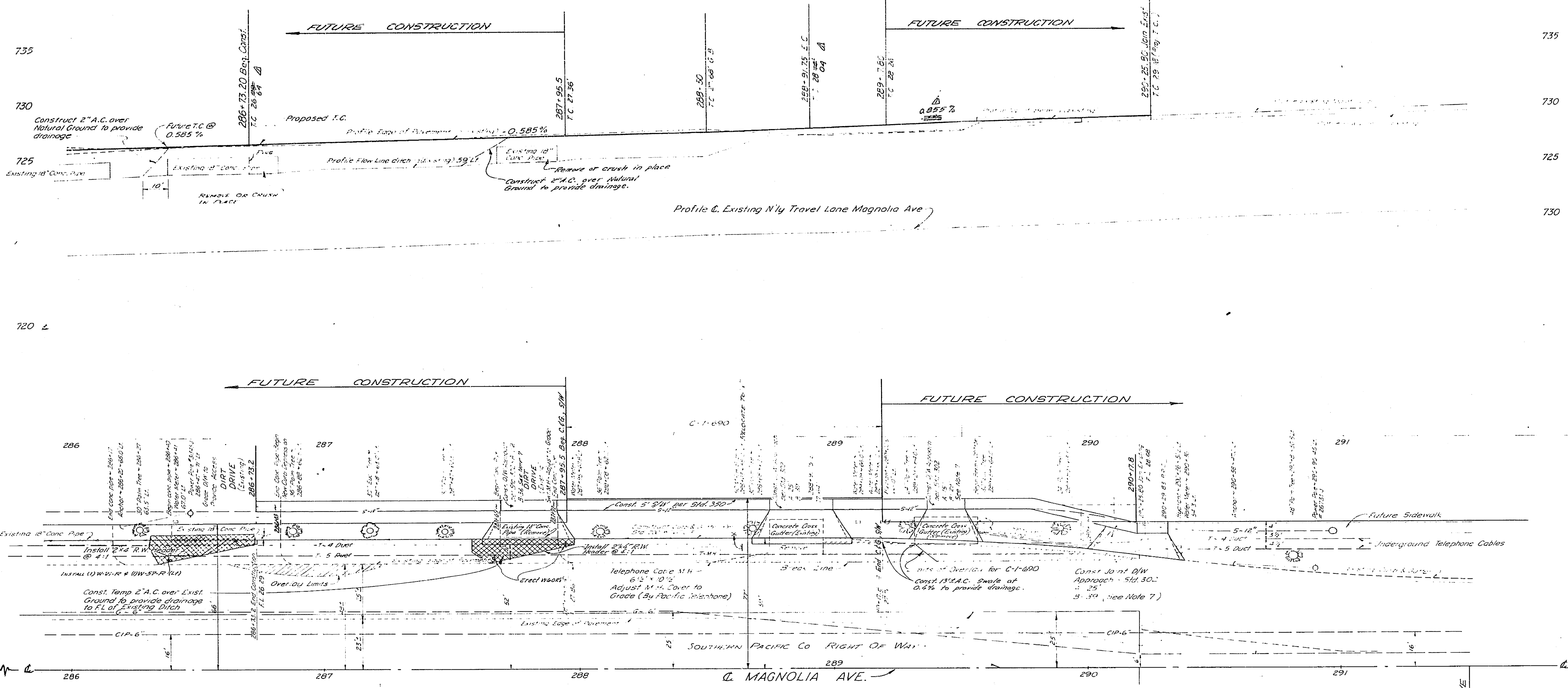

GENERAL NOTES

1. It shall be the responsibility of the contractor to clear the right-of-way in accordance with the provisions of law as it affects each utility including irrigation lines and appurtenances and at no cost to the City.
2. Construction shall be in accordance with the City of Riverside Department of Public Works, Specification No. 461 and Standard Drawings.
3. Prime coat, seal coat and paint binder are required.
4. Trim edge of existing pavement where new paving joins existing pavement to a smooth straight line. Construct match-up paving as shown and overlay paving as directed in the field to produce a smooth crown section. Engineer estimates overlay to be 13 tons.
5. For relocation of existing City irrigation water facility or electric power utility facility, to be done by City forces, contact Charles Hare, Water Commercial Engineer, at 787-7442. Schedule about 2 weeks to process a work order before relocation work begins.
6. For relocation of existing domestic water facility, contact Southwest Water Company at 689-4224.
7. Exact location of driveways to be determined at time of construction and as approved by the TRAFFIC ENGINEERS.

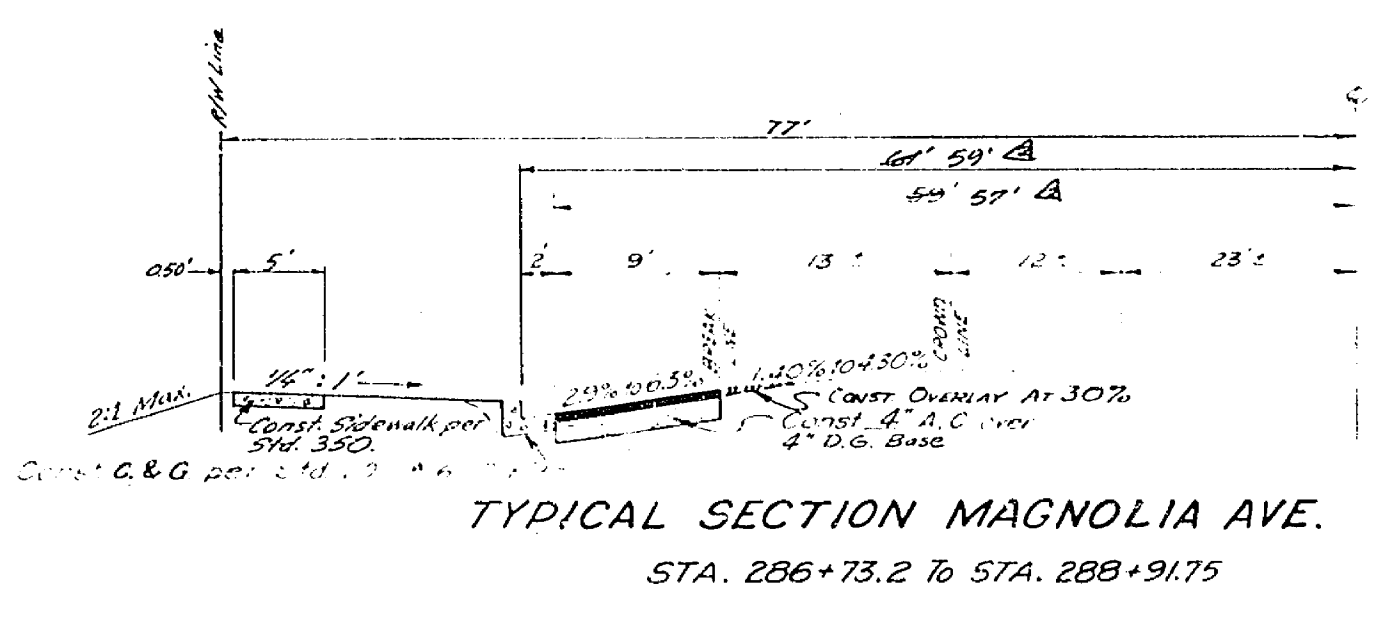

CURB CONSTRUCTION CURVE DATA

A	7° 39' 29"
P	1000.00'
L	133.66'
T	66.93'

TOTAL CURB CURVE DATA

A	7° 54' 14"
P	1000.00'
L	171.94'
T	85.97'

CAUTION
PACIFIC TELEPHONE
CABLES UNDERGROUND
BEFORE EXCAVATING
CALL COLLECT

After Hours
7:30 A.M. to 5 P.M. & Holidays

Orange County	714-933-0811	714-547-6606
Riverside County	714-684-0071	714-547-6606
Inyo County	714-684-0071	714-547-6606
San Bernardino County	714-684-0071	714-547-6606
Los Angeles County	213-421-3111	24 HOUR SERVICE
Ventura County	714-524-3111	24 HOUR SERVICE
San Diego County	714-528-0535	714-523-0027

FOR FREE CABLE LOCATING SERVICE

286+39.00 CONC. DRIVE
N.YE AVENUE

286+73.20 CONC. DRIVE
S. BAMBURDY DRIVE
STA. 287+50.38

B.M. ELEV 729.23 NPT AT
N.E. CORNER CONC. BLOCK
PLANTER AT MAGNOLIA DRIVE
IN TRAILER MARQUEE C.R. 78
234/80

J. F. DAVIDSON ASSOCIATES
CIVIL ENGINEERS - SURVEYORS - PLANNERS
RIVERSIDE, CALIFORNIA

APPROVED BY: [Signature] DATE 5-4-71
R.E. No. 14499

W.C. 2299 FOR KNO. 5/10/71

DESIGNED BY: [Signature] DRAWN BY: [Signature] CHECKED BY: [Signature]

CITY OF RIVERSIDE, CALIFORNIA
DEPARTMENT OF PUBLIC WORKS

APPROVED BY: [Signature] DATE 6/15/71
OFFICE ENGINEER
TRAFFIC DIVISION
ASSISTANT CITY ENG.

STREET PLAN & PROFILE
C-1-690
MAGNOLIA AVENUE
N'y. Side 600' to 900' E'y. Nye Ave.

HORIZ. SCALE: 1" = 20'
VERT. SCALE: 1" = 4'

PROJECT NO.
R-1388

SHEET 1 OF 1
FILE NO. 3368