

SCALE  
1" = 40' Horiz.  
1" = 4' Vertical

**BENCH MARK**  
P.K. Nail in N.E. Curb Return of PIERCE ST. and SIERRA VISTA  
Elev. 743.393 per City F.B. 4-704, page 19

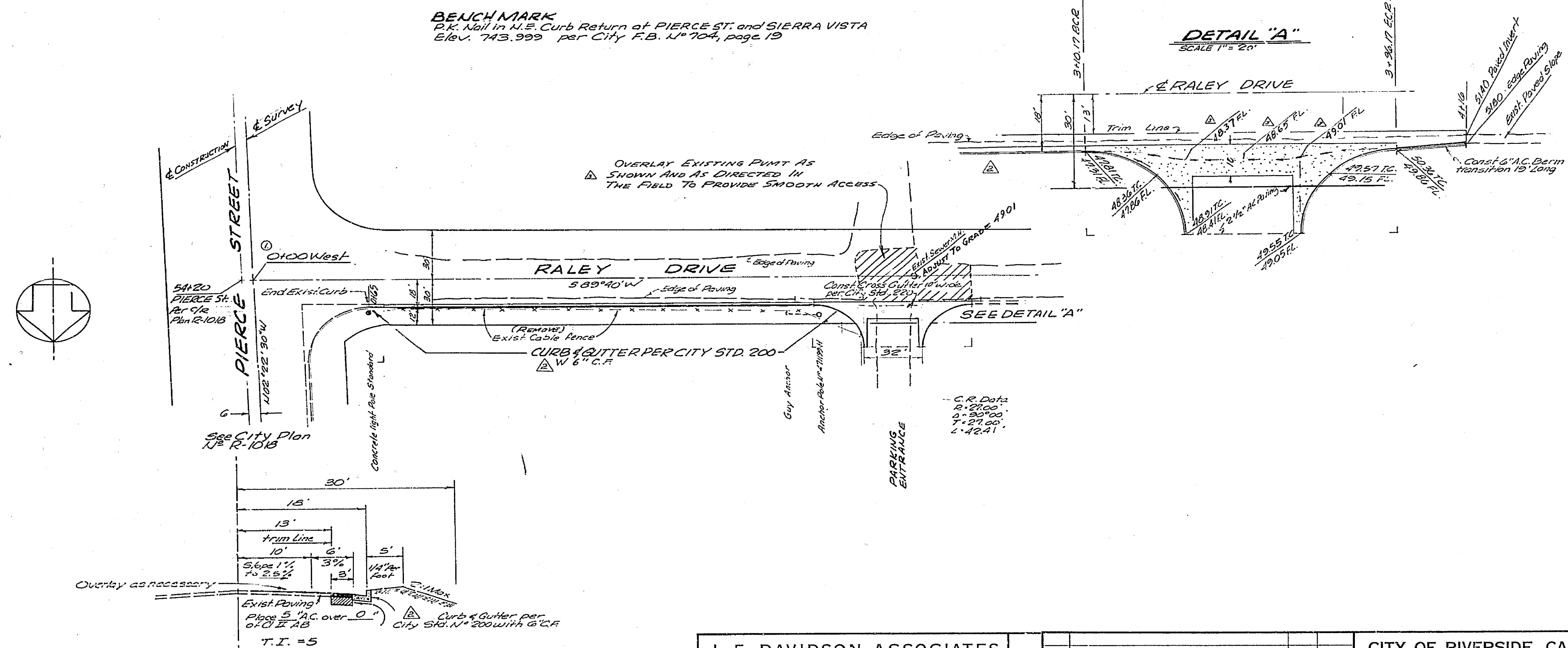

**TYPICAL SECTION  
N.W. SIDE - RALEY DRIVE  
IMPROVEMENTS**

**GENERAL NOTES**

1. It shall be the responsibility of the contractor to clear the right-of-way in accordance with the provisions of law as it affects such utility including irrigation lines and appurtenances and at no cost to the city.
2. Construction shall be in accordance with the City of Riverside Department of Public Works, specifications No. 461 and standard drawings.
3. Prime coat, seal coat and paint binder are required.
4. Grading will require a permit under ordinance 3093 for a cut or fill exceeding 100 cubic yards, or a fill over one foot in depth.
5. Trim edge of existing pavement where new paving joins existing pavement to a smooth straight line. Construct match-up paving as shown and overlay paving as directed in the field to produce a smooth crown section. Engineer estimates overlay to be 60 tons.
6. For relocation of existing city domestic or irrigation water facility or electric power utility facility to be done by city forces, contact Charles Hare, Water Commercial Engineer at 787-7442 schedule about 2 weeks to process a work order before relocation work begins.

**J. F. DAVIDSON ASSOCIATES**  
CIVIL ENGINEERS - SURVEYORS - PLANNERS  
RIVERSIDE, CALIFORNIA  
APPROVED BY: *John W. Davidson* DATE: 8-20-59  
R.E. No. 1755-C  
W.O. 2366 FOR: LOMA LUIDA UNIVERSITY, F.B. 102

DESIGNED BY: <i>KWA</i>	DRAWN BY: <i>KWA</i>	CHECKED BY: <i>RP</i>
DATE: 5-22-76	DATE: 4-12-76	DATE: 7-5-76
APPROVED BY: <i>[Signature]</i>	DATE: 11-6-63	DATE: 11-6-63

**CITY OF RIVERSIDE, CALIFORNIA**  
DEPARTMENT OF PUBLIC WORKS  
APPROVED BY: *[Signature]*  
DIRECTOR OF PUBLIC WORKS  
DATE: 11/6/63

**STREET PLAN AND PROFILE  
N.W. SIDE OF RALEY DR.  
TO 400' W. OF PIERCE ST.**

PROJECT NO. **R-1390**  
SHEET **1** OF **1**  
FILE NO. **3369**