

BENCH MARK:
 CITY B.M. - R.R. spike in guy pole #305461 on Easterly side of CREST AVE. at KELLER AVE., per C/P Plan R-572 sheet 4. Elevation 786.22
 T.B.M. - chiseled "D" in top curb of B.C.R. of 5614 return CREST AVE and KELLER AVE. (at 90.77' RT. side CREST AVE.) Elevation 786.97

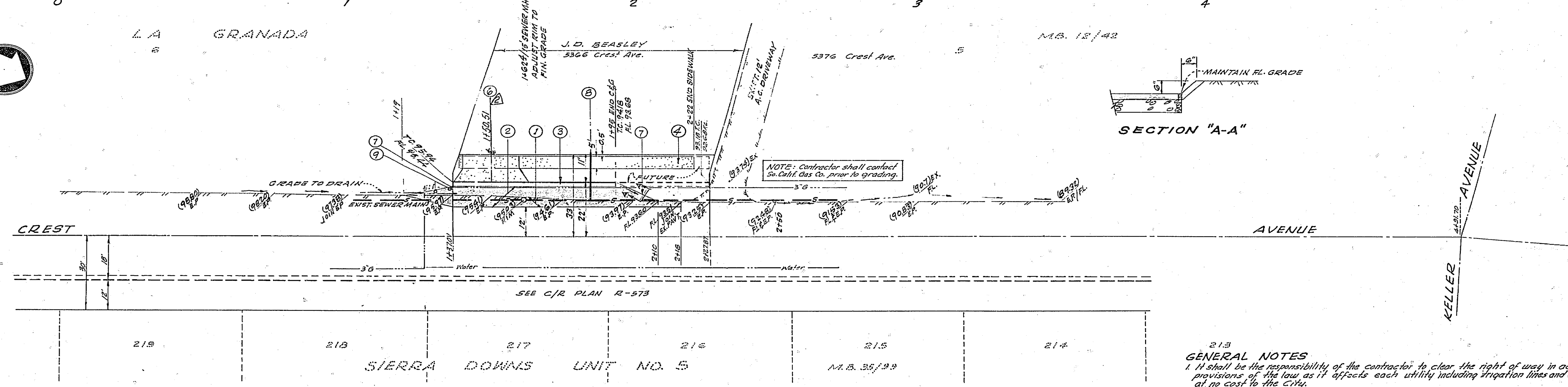

- GENERAL NOTES**
- It shall be the responsibility of the contractor to clear the right of way in accordance with the provisions of the law as it affects each utility including irrigation lines and appurtenances and at no cost to the city.
 - Construction shall be in accordance with City of Riverside, Department of Public Works Specifications No. 461 and Standard Drawings.
 - Prime coat, seal coat and paint binder are required.
 - Trim edge of existing pavement where new paving joins existing paving to a clean straight edge. Construct match-up paving as shown and overlay as directed in the field to produce a smooth crown section. Engineer estimates the overlay paving to be LESS THAN 1-70M.
 - THE DEVELOPER SHALL ARRANGE FOR A SOIL TEST AT SUB GRADE LEVEL BY A SOILS ENGINEER. THICKNESS OF PAVEMENT TYPE OF AGGREGATE BASE SHALL BE DETERMINED BY THE SOILS ENGINEER AND SUBMITTED TO THE CITY OF RIVERSIDE FOR APPROVAL PRIOR TO CONSTRUCTION.

- CONSTRUCTION NOTES**
- REMOVE EXIST. A.C. PAVEMENT.
 - CONST. 4" A.C. OVER 7" A.B. Class 3
 - CONST. CURB & GUTTER PER STD. NO. 200. (6" C.R.)
 - CONST. R. SIDEWALK PER STD. NO. 360
 - CONST. DRIVEWAY APPROACH, A=20', B=27' PER STD. NO. 302.
 - INSTALL 2"x4" REDWOOD HEADBOLTS, TO REMAIN.
 - CONST. 4" V.C.P. SEWER LATERAL
 - INSTALL 14" G.C. REFLECTOR PADDLES

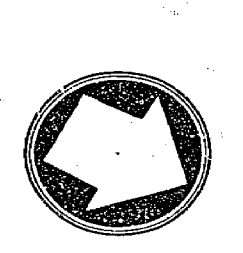
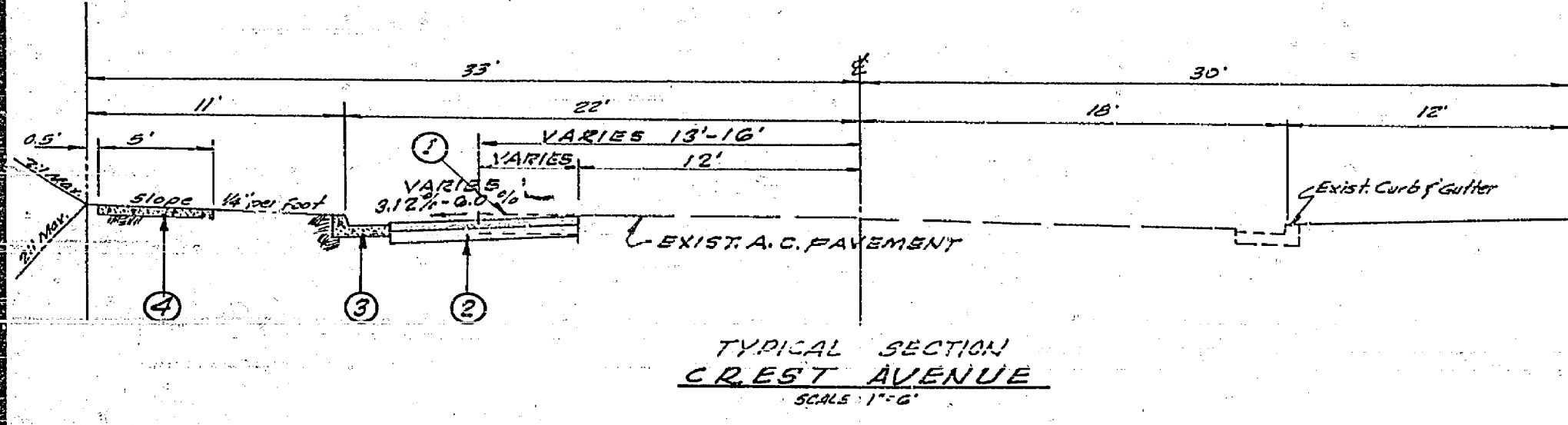

CRAWLEY, HAWKINS & ASSOCIATES ENGINEERS AND SURVEYORS RIVERSIDE, CALIFORNIA - 684-9522 APPROVED: <i>George O. Crawley</i> DATE 5-11-69 FOR J. D. BEASLEY REG. CIVIL ENGINEER NO. 9428 DESIGNED BY: J.D.B. DRAWN BY: A.B. CHECKED BY: J.B.		CITY OF RIVERSIDE, CALIFORNIA DEPARTMENT OF PUBLIC WORKS APPROVED BY: <i>[Signature]</i> DATE 1-19-70 TRAFFIC DIVISION ASSISTANT CITY ENGINEER		S.R. #745 E-36 STREET PLAN & PROFILE CREST AVENUE 264' to 355' S.W. of KELLER AVE. W/4 SIDE ONLY BUILDING PERMIT AT 5566 CREST AVE. HORIZ. SCALE: 1" = 20' VERT. SCALE: 1" = 4' PROJECT NO. R-1393 SHEET 1 OF 1 FILE NO. 4158	
---	--	--	--	---	--