

BENCH MARK ON E. 700' N. 1/2' SEC. 12 T. 4 S. R. 15 E. 1/4 CORNER TO 1/4 SECTION 15 N.W. 1/4 OF GRAMERCY PL. & TYLER AVE.

QUANTITY ESTIMATE

705' C.Y.
25' E.F.
225' S.F.
45' S.F.
45' S.F.
2,340' S.F.
360' S.F.
3' E.F.

SECTION A-A
NO SCALE

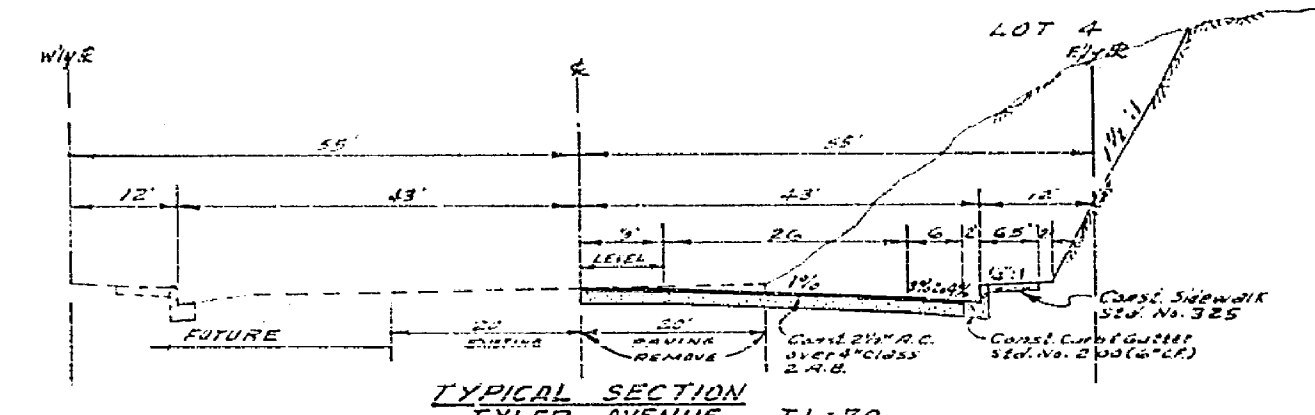

ALBERT A. WEBB ASSOCIATES CIVIL ENGINEERS RIVERSIDE, CALIFORNIA APPROVED BY: <i>E. H. Webb</i> DATE 2/14/68 R.E. No. 2826 W.O. 67-124 FOR Clarence Peltzler P.D. 282	CITY OF RIVERSIDE, CALIFORNIA DEPARTMENT OF PUBLIC WORKS APPROVED BY: <i>William B. Anderson</i> DIRECTOR OF PUBLIC WORKS DATE 12/26/67	STREET PLAN & PROFILE TYLER AVENUE EAST SIDE, 700' N.W. 1/4 OF HEDRICK AVE. R-59-667	PROJECT NO. R-1397 SHEET 1 OF 1 FILE NO. 67-134-A		
		APPROVED BY: <i>W. B. Anderson</i> DATE 12/26/67 ASSISTANT CITY ENGINEER		HORIZ. SCALE: 1" = 20' VERT. SCALE: 1" = 5'	
		DESIGNED BY: <i>B.E.L.</i> DRAWN BY: <i>B.E.L.</i> CHECKED BY: <i>B.E.L.</i>		REVISIONS:	
		MARK:		REVISIONS:	