

950 @

950 @

950 RA

950 RA

SCALE - Hor. 1" = 20'
Vert. 1" = 4'

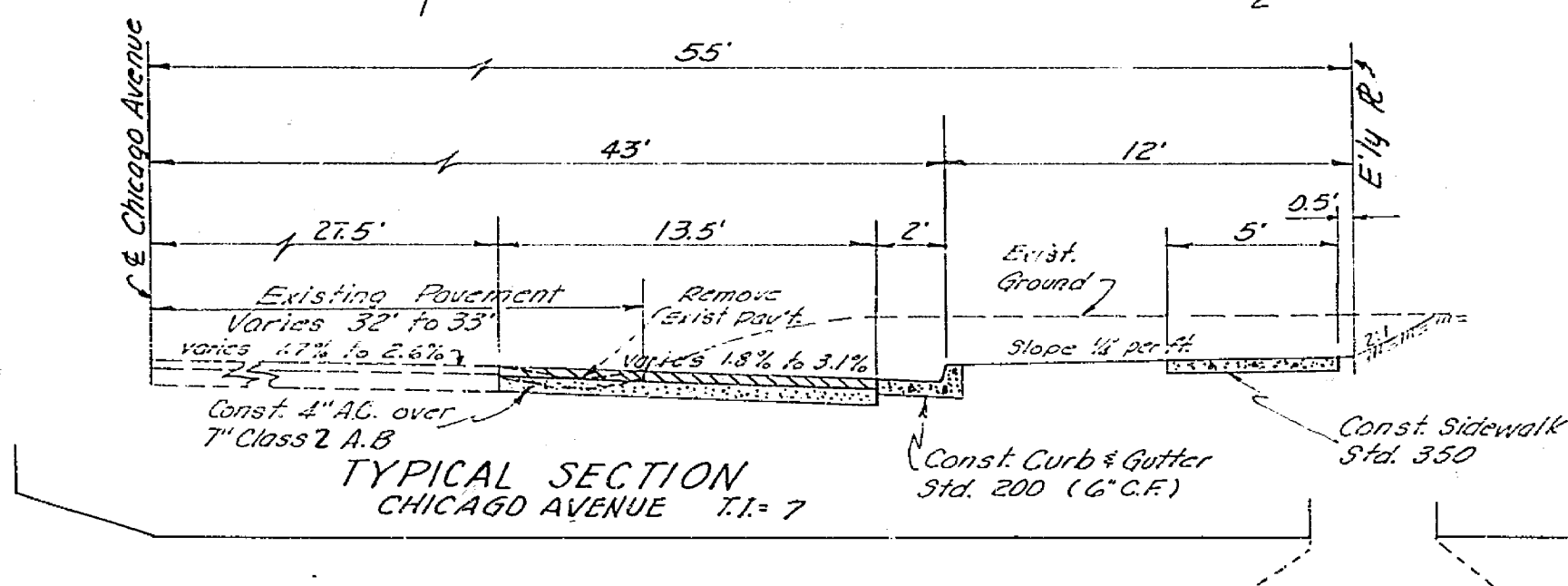
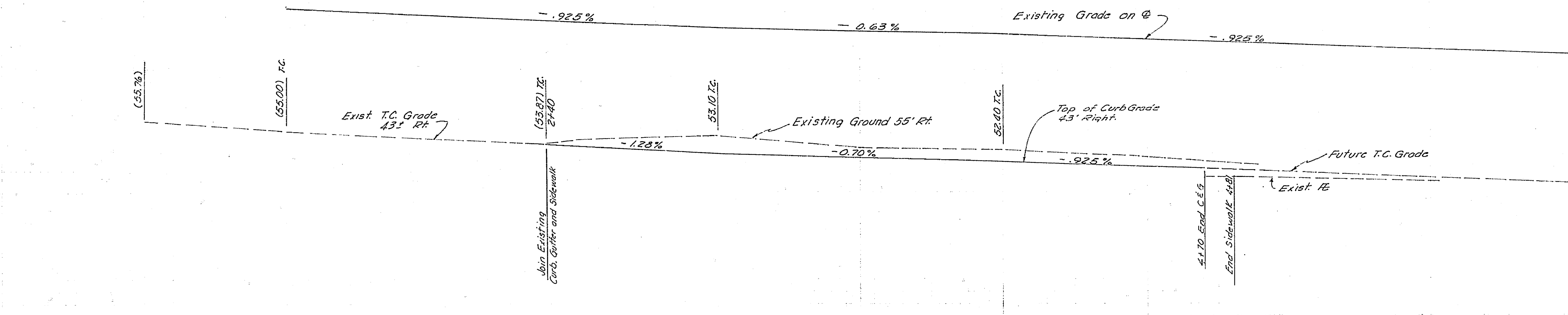

GENERAL NOTES

1. It shall be the responsibility of the contractor to clear the right of way in accordance with the provisions of law as it affects each utility including irrigation lines and appurtenances, and at no cost to the city.
2. Construction shall be in accordance with the City of Riverside, Department of Public Works, Specifications No. 461 and Standard Drawings.
3. Prime Coat, Seal Coat and Joint Binder are required.
4. Grading will require a permit under Drainage 3093 for a cut or fill exceeding 100 cu yds., or a fill over one foot in depth.
5. Joint edge of existing pavement where new paving joins existing pavement, to a clean straight line. Construct match-up paving as shown and overlay paving as directed in the field to produce a smooth crown section.

B.M. Elev. 955.465 - P.K. Nail in South Curb, University Avenue 138' 1\"/>

NOTICE TO CONTRACTOR

The existence and location of any underground utilities, pipes or structures shown on these plans are obtained by a re-search of the available records. To the best of our knowledge, there are no existing utilities except as shown.

The contractor is required to take due precautionary measures to protect the utility lines shown and any other lines not of record or not shown on these plans.

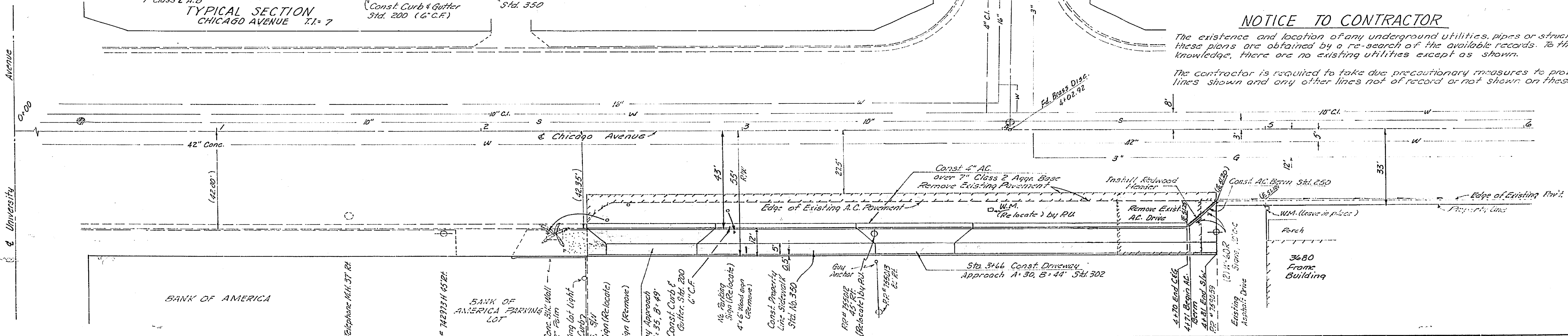

ROBERTSON ASSOCIATES
ENGINEERS
SURVEYORS
RIVERSIDE, CALIFORNIA
Approved *Charles E. Robertson* Date 1-6-70
R.C.E. 15016

CITY OF RIVERSIDE, CALIFORNIA
DEPARTMENT OF PUBLIC WORKS

CHICAGO AVENUE
From 240' North to 481' North
OF UNIVERSITY AVENUE, East Side
Building Permit of 3700 Chicago Ave.

PROJECT NO.
R-1403
SHEET 1 OF 1
FILE NO.

DESIGNED BY	DRAWN BY	CHECKED BY	DATE	APPROVED BY	DATE
				<i>[Signature]</i>	2/6/70