

700

700

700

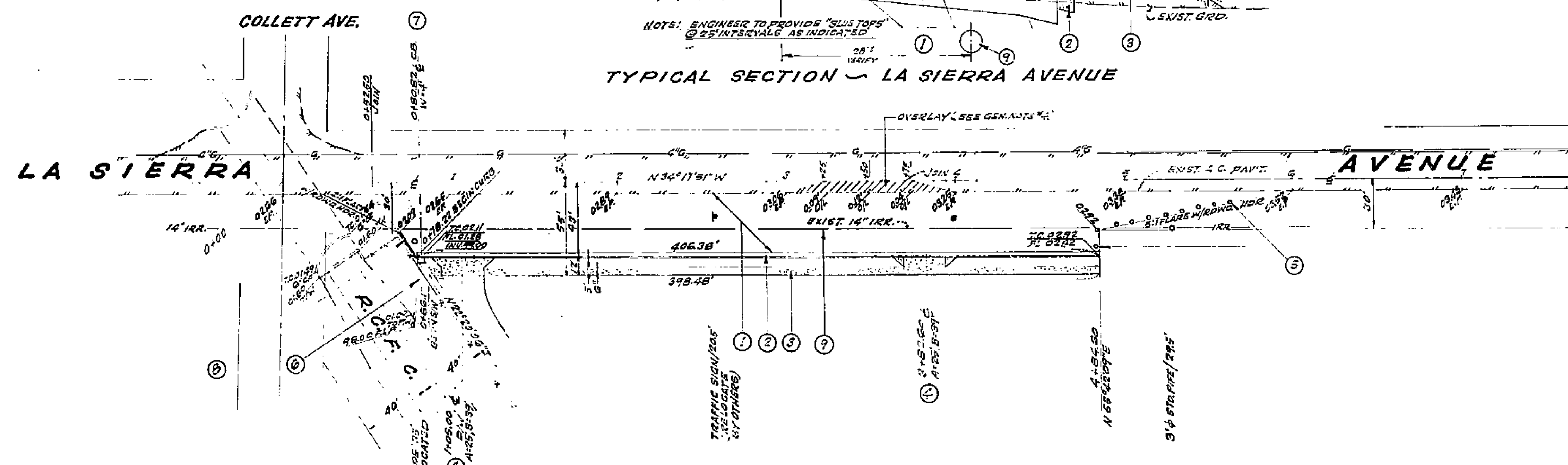
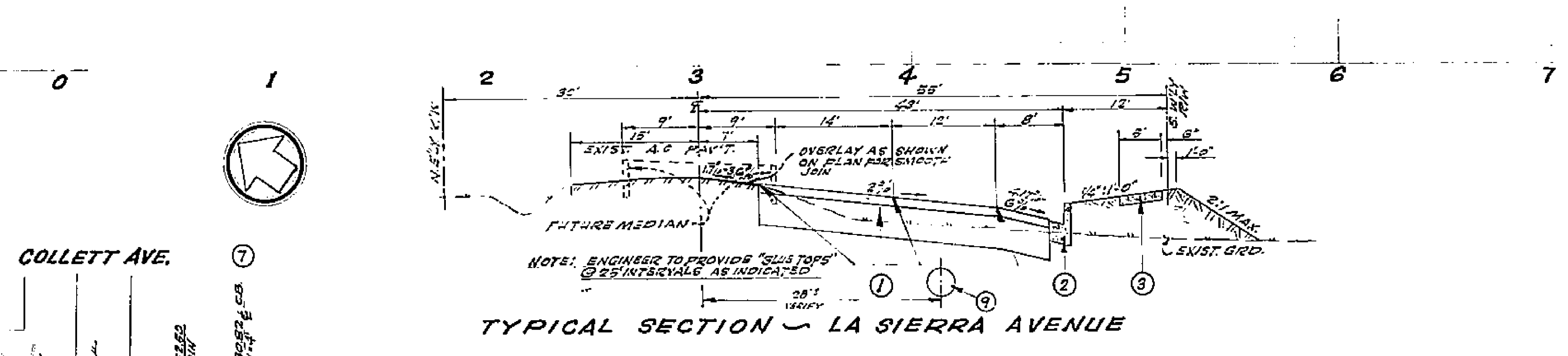
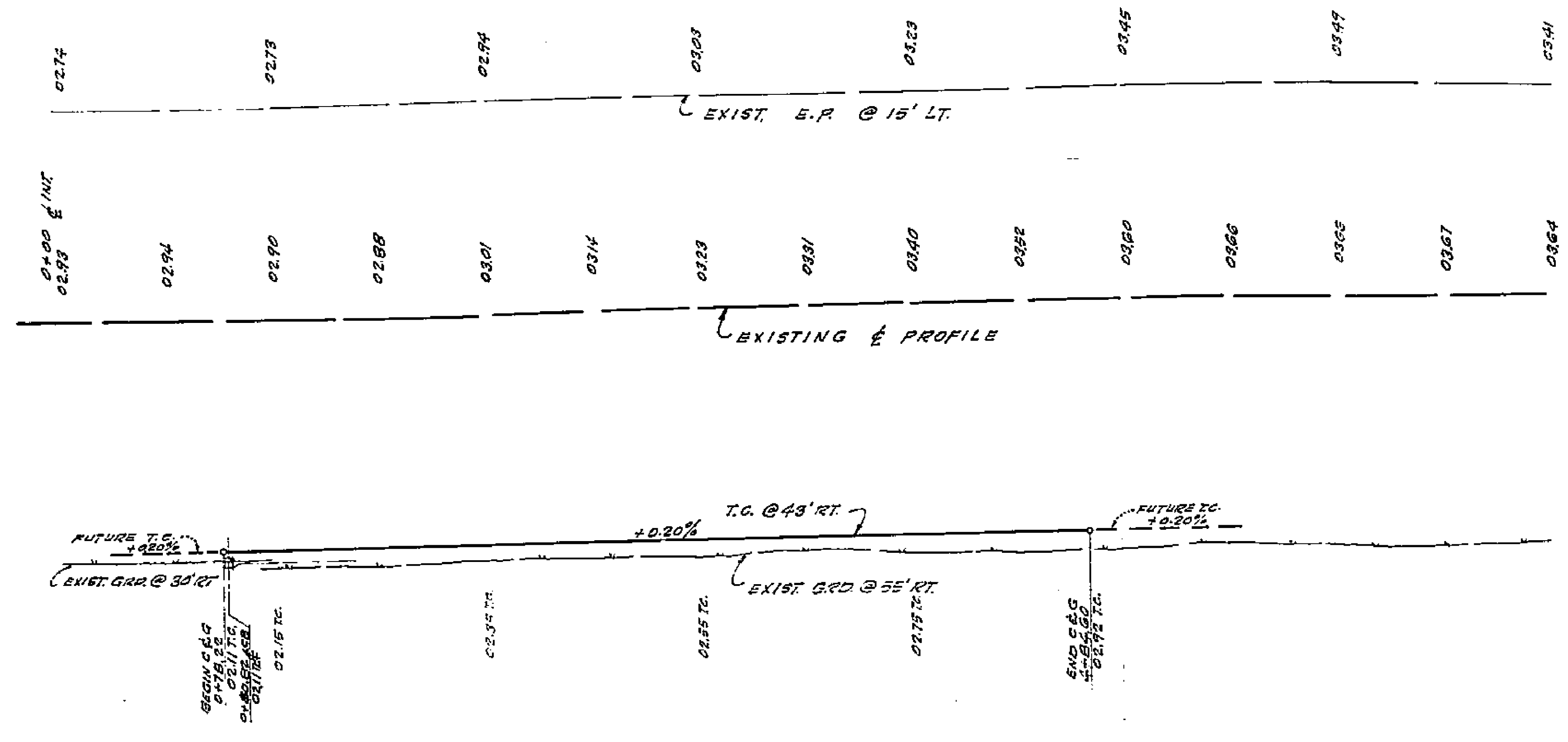

GENERAL NOTES

1. CONSTRUCTION SHALL BE IN ACCORDANCE WITH THE CITY OF RIVERSIDE DEPT. OF PUBLIC WORKS SPECIFICATIONS AS 201 AND STD. DETAILS.
2. IT SHALL BE THE RESPONSIBILITY OF THE CONTRACTOR TO CLEAR THE RIGHT OF WAY IN ACCORDANCE WITH THE PROVISIONS OF THE LAW AS IT AFFECTS EACH UTILITY INCLUDING IRRIGATION LINES AND APPURTENANCES AND AT HIS COST TO THE CITY.
3. PRIME COAT, SEAL COAT AND PAINT BINDER ARE REQUIRED.
4. TRIM EDGES OF EXISTING PAVEMENT WHERE NEW PAVEMENT JOINS EXIST. PAVEMENT TO A 3/8" RAMP STRAIGHT EDGE. CONSTRUCT MATCH-UP PAVING AS SHOWN AND OVERLAY AS DIRECTED IN THE FIELD TO PRODUCE A SMOOTH CROWN SECTION. ENGINEER ESTIMATES THE OVERLAY PAVEMENT TO BE - 1" THK.

BENCH MARK
 PK NAIL IN NE CORNER RETURN, LA SIERRA & COLLETT AVE @ R.C.F.G. & W.C.D. FLOOD CHANNEL. CITY RIV. P.B. 704.102 ELEV. 701.611

- CONSTRUCTION NOTES**
1. CONST. 2 1/2" A.C. OVER 1" CLASS 2 A.S. SURF 1 1/2" CLASS 3 A.B. OR 1 1/2" A.S. OVER 1 1/2" CLASS 3 A.S.
 2. CONST. CURB & GUTTER ACC. STD. DWS. NE 200'-0" C.F.
 3. CONST. PROP. LINES SIDEWALK PER STD. DWS. NE 350'.
 4. CONST. DRIVEWAY APPROACH 12" MIN. W/ 1/2" MIN. SLOPE.
 5. CONST. INGR. PER STD. DWS. NE 225' @ 10' S.P. (10' MIN.)
 6. INSTALL 18" D.C.M.P. 16' O.D. MAIN CUT EXIST. CONC. CHANNEL WALL & SEAL AROUND.
 7. CONST. CATCH BASIN, TYPE 3, PER STD. NE 225'.
 8. REMOVE EXIST. 14" IRRIGATION PIPE & CONSTRUCT 12" A.C.P. CLASS 150 OR 12" CONC. 2000 C.I. 5'-4" TO 5'-11" 4-55. MIN. 30' 20" W.C.D.

CRAWLEY, HAWKINS & ASSOC.
 ENGINEERS & SURVEYORS
 RIVERSIDE, CALIFORNIA

APPROVED: *James O. Crawley* DATE: 10-4-60
 10.11.6 R.O. 9455
 FOR: TRINITY CHRISTIAN CENTER K3103/12

NO.	REVISIONS	DATE

CITY OF RIVERSIDE, CALIFORNIA DEPARTMENT OF PUBLIC WORKS	
APPROVED BY OFFICE ENGINEER TRAFFIC DIVISION ASSISTANT CITY ENG.	DATE 3-14-70

STREET PLAN & PROFILE LA SIERRA AVENUE FROM COLLETT AVE TO 404.20'S+K OF COLLETT AVE.	
RECORD OF SURVEY 1070	
HORIZ. SCALE: 1" = 40'	VERT. SCALE: 1" = 4'

PROJECT NO. R-1416
SHEET 1 OF 1
FILE NO. 4163