

BENCH MARK:
 1/4" DIA. 1/2" CENTER OF N.E. CURB
 PERMITS, ADJUSTED TO 740.00' AVE
 C/E, 123 000 1233, 704441
 ELEV. = 754.23

- GENERAL NOTES:**
- IT SHALL BE THE RESPONSIBILITY OF THE CONTRACTOR TO CLEAR THE RIGHT OF WAY IN ACCORDANCE WITH THE PROVISIONS OF THE LAW AND IT APPLICABLE EACH UTILITY, INCLUDING IDENTIFICATION LINES AND APPURTENANCES, AND AT NO COST TO THE CITY.
 - THE CONTRACTOR SHALL BE IN COMPLIANCE WITH THE CITY OF RIVERSIDE, PERMITS, STATE, LOCAL, AND FEDERAL LAWS AND REGULATIONS.
 - GRAVING WILL REQUIRE A PERMIT UNDER ORDINANCE 30029 FOR A CUT OR FILL EXCEEDING 100 CUBIC YD. OR A FILL OVER ONE FOOT IN ANY TH.
 - TRIM EDGE OF EXISTING PAVEMENT, WHERE NEW PAVEMENT JOINS EXISTING PAVEMENT TO A CLEAN, STRAIGHT LINE. CONSTRUCT MATCH UP PAVING AS SHOWN AND OVERLAY PAVING AS CHECKED IN THE FIELD TO PRODUCE A SMOOTH CROWN SECTION.
 - STREET NAME & TRAFFIC CONTROL SIGNS TO BE FURNISHED AND INSTALLED BY THE CITY OF RIVERSIDE AND PERMITS SPECIFICATION AND STD. DRWG. NO. 002 & 000.
 - DEVIATION APPROACHES TO CONFORM TO CITY OF RIVERSIDE STANDARD DRAWING NO. 302, FOR WIDTH A 6' 2", SEE TABLE PER SAID DRAWING.

NOTICE TO CONTRACTOR

THE EXISTENCE AND LOCATION OF ANY UNDERGROUND UTILITY PIPES OR STRUCTURES SHOWN ON THESE PLANS ARE OBTAINED ON A SEARCH OF THE AVAILABLE RECORDS. TO THE BEST OF OUR KNOWLEDGE THERE ARE NO EXIST. UTILITIES EXCEPT AS SHOWN ON THESE PLANS. THE CONTRACTOR IS REQUIRED TO TAKE THE NECESSARY PRECAUTIONARY MEASURES TO PROTECT THE UTILITY LINES SHOWN AND ANY OTHER LINES NOT OF RECORD.

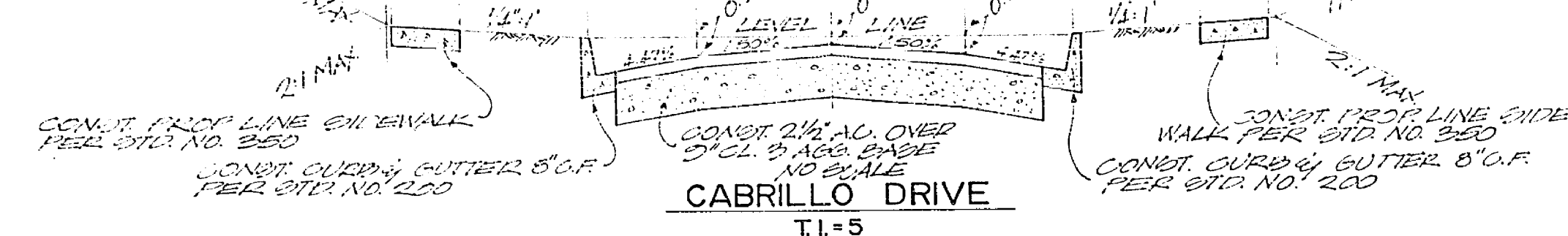

MAXWELL, BROWN & ASSOCIATES PLANNING • ENGINEERING • SURVEYING 1771 NORTH D STREET SAN BERNARDINO, CALIFORNIA Approved By: <i>Philip E. Brown</i> Date: <i>1/10/70</i> Philip E. Brown, RCE 18,679		CITY OF RIVERSIDE, CALIFORNIA DEPARTMENT OF PUBLIC WORKS APPROVED BY: <i>[Signature]</i> DATE: <i>1/10/70</i> OFFICE ENGINEER TRAFFIC DIVISION ASSISTANT CITY ENG. <i>[Signature]</i> DATE: <i>1/10/70</i>		STREET PLAN & PROFILE CABRILLO DRIVE TRACT NO. 4023 HORIZ. SCALE: 1" = 40' VERT. SCALE: 1" = 4'	PROJECT NO. R-1418 SHEET 1 OF 2 FILE NO.
JOB NO. 69-11-3	FB 227	DRAWN BY: <i>[Signature]</i>	CHECKED BY: <i>[Signature]</i>	DESIGNED BY: <i>[Signature]</i>	DRAWN BY: <i>[Signature]</i>

750 LT.

750 ¢

750 RT.

740 LT.

740 ¢

740 RT.

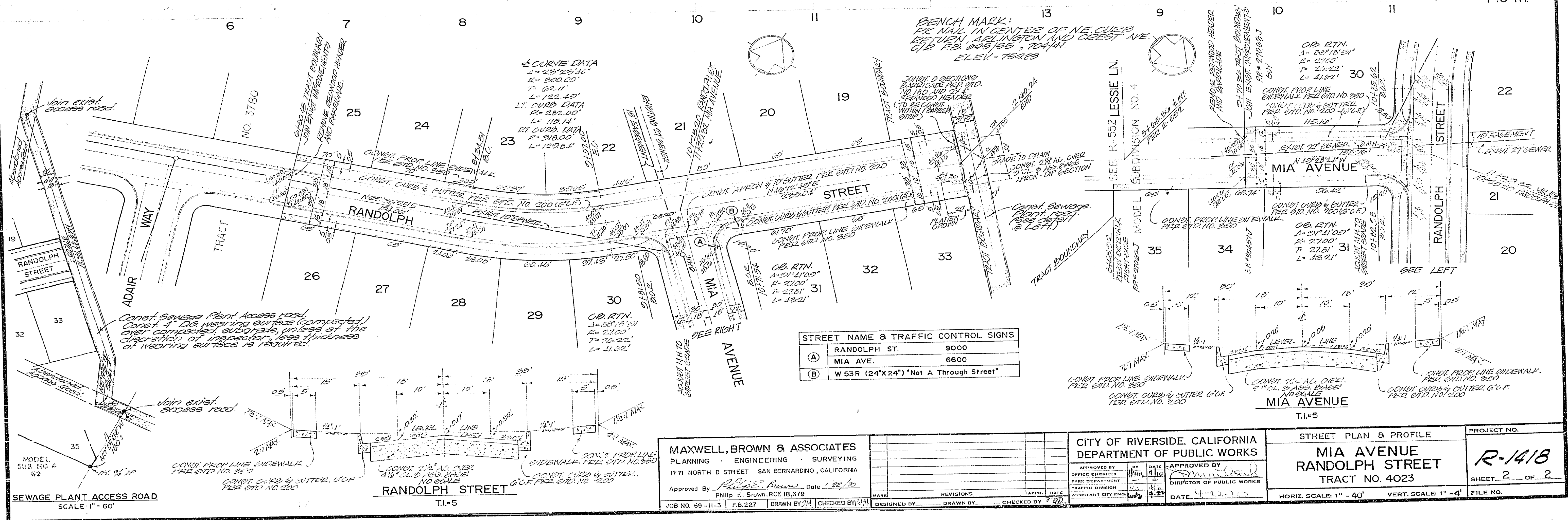
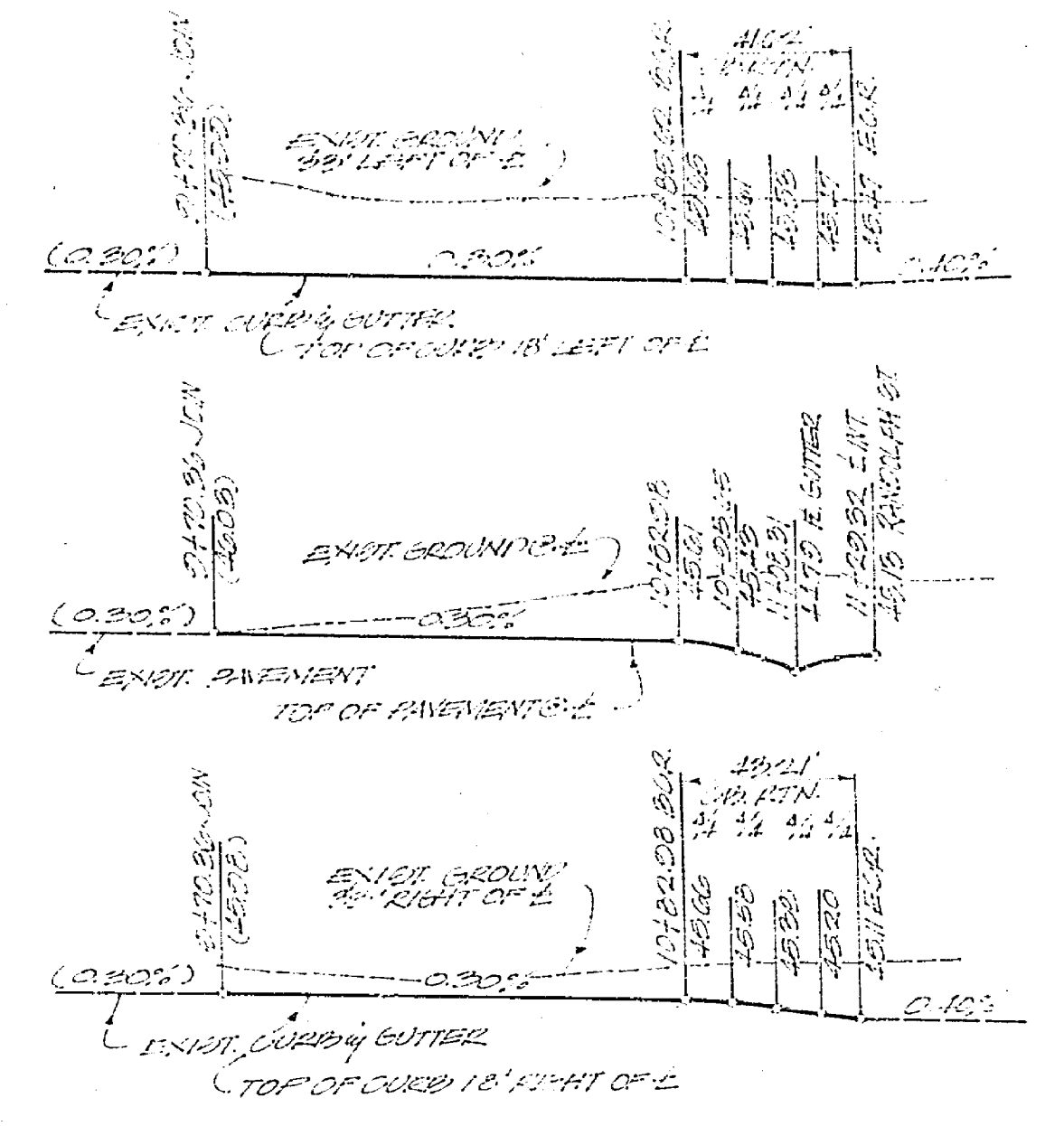
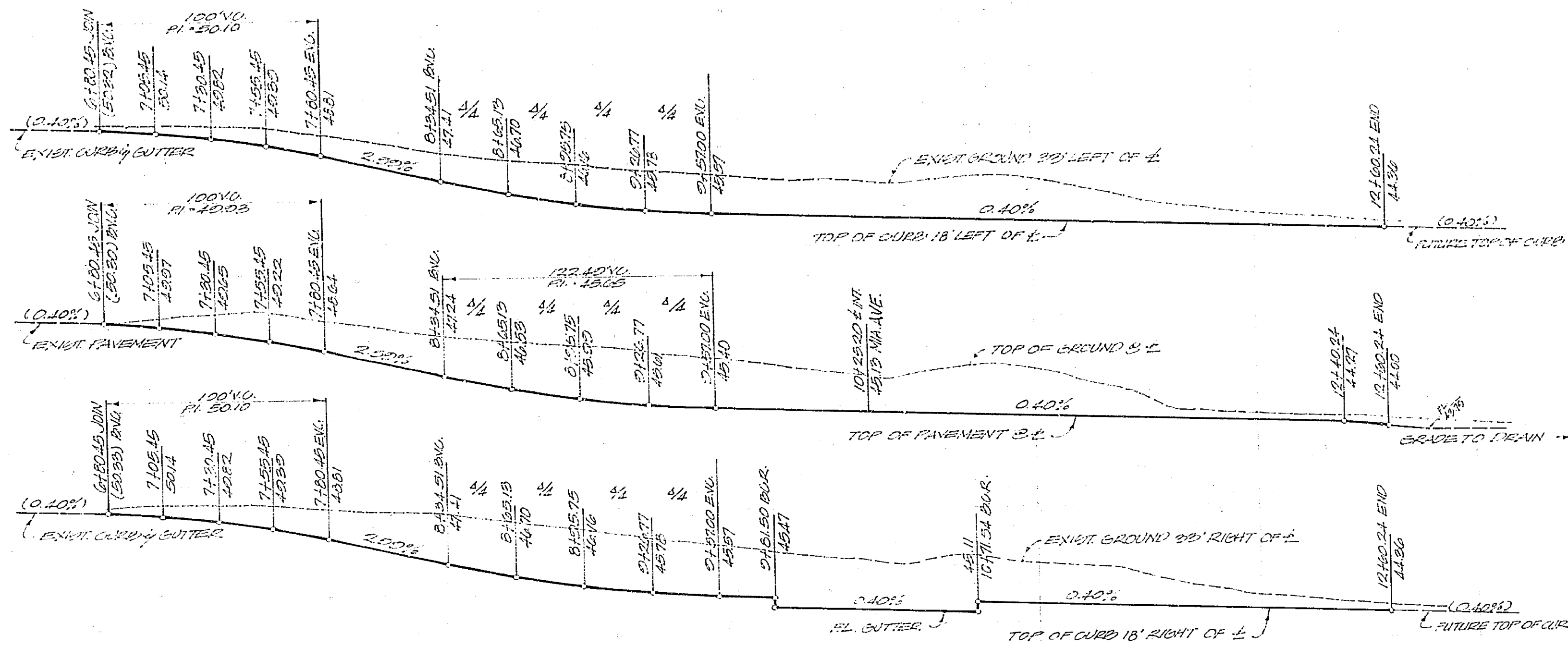

SEWAGE PLANT ACCESS ROAD
SCALE 1" = 60'

RANDOLPH STREET
T.I.#5

MAXWELL, BROWN & ASSOCIATES
 PLANNING ENGINEERING SURVEYING
 1771 NORTH D STREET SAN BERNARDINO, CALIFORNIA
 Approved By *Philip E. Brown* Date *1/22/70*
 PHILIP E. Brown, RCE 18,679
 JOB NO. 69-11-3 F.B.227 DRAWN BY *CM* CHECKED BY *MM*

CITY OF RIVERSIDE, CALIFORNIA
 DEPARTMENT OF PUBLIC WORKS
 APPROVED BY *[Signature]* DATE *4/22/70*
 OFFICE ENGINEER
 TRAFFIC DIVISION
 ASSISTANT CITY ENGINEER

STREET PLAN & PROFILE
 MIA AVENUE
 RANDOLPH STREET
 TRACT NO. 4023
 HORIZ. SCALE: 1" = 40' VERT. SCALE: 1" = 4'

PROJECT NO.
R-1418
 SHEET **2** OF **2**
 FILE NO.