

PROPERTY OF  
CITY OF RIVERSIDE  
ENGINEERING DIVISION

MADE IN THE U.S.A. BY THE  
MILITARY ENGINEERING DIVISION  
OF THE ARMY CORPS OF ENGINEERS  
WASHINGTON, D.C.

MADE IN THE U.S.A. BY THE  
MILITARY ENGINEERING DIVISION  
OF THE ARMY CORPS OF ENGINEERS  
WASHINGTON, D.C.

PROPERTY OF  
CITY OF RIVERSIDE  
ENGINEERING DIVISION

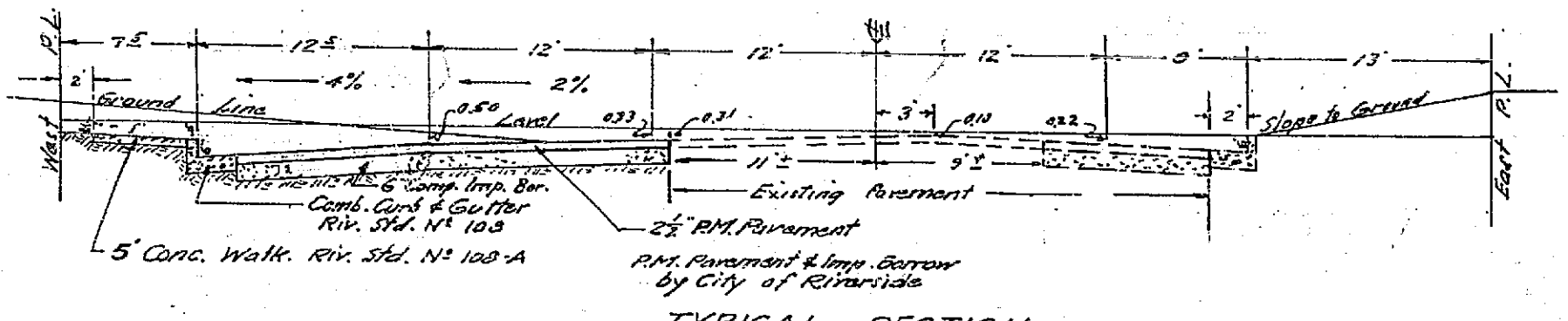
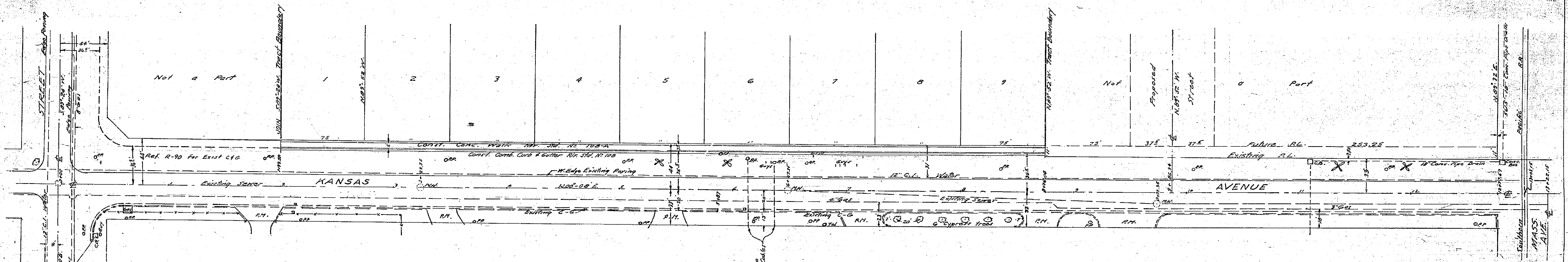
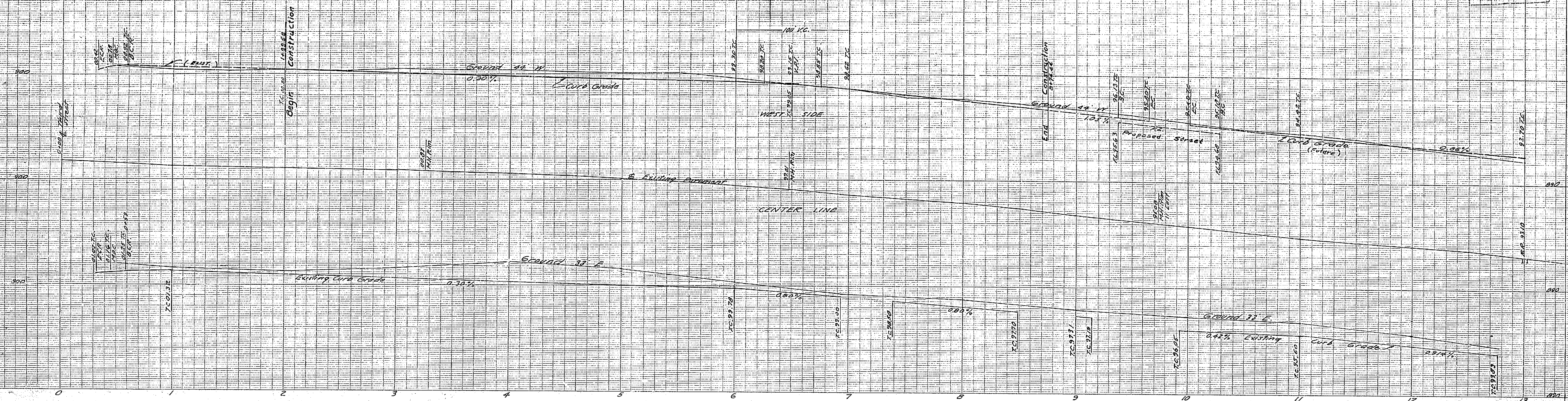

TYPICAL SECTION  
Scales: Hor. 1" = 20'  
Vert. 1" = 4'  
KANSAS AVE. - 3RD ST. TO MASS AVE.

ESTIMATE OF QUANTITIES  
675 lin. ft. Conc. Curb and Gutter  
5375 sq. ft. Conc. Walk

B.M. Spike and lead in  
5th Conc. Riv. at  
Park Ave. & Third St.  
Elev. 890.15

PROPERTY OF  
CITY OF RIVERSIDE  
DEPT. OF PUBLIC WORKS  
ENGINEERING DIVISION

PROPERTY OF  
CITY OF RIVERSIDE  
DEPT. OF PUBLIC WORKS  
ENGINEERING DIVISION

J. F. DAVIDSON - CIVIL ENGINEER  
R.E. No. 882  
RIVERSIDE, CALIFORNIA  
APPROVED BY *J. F. Davidson* DATE 8-28-57

CITY OF RIVERSIDE, CALIFORNIA  
DEPARTMENT OF PUBLIC WORKS  
STREET PLAN 4 - PROFILE  
KANSAS AVENUE  
NON-RESIDENTIAL M-2 GENERAL  
MANUFACTURING SUBDIVISION M-2  
HORIZ. SCALE 1" = 40' VERT. SCALE 1" = 4'

APPROVED BY *J. F. Davidson*  
Director of Public Works  
NO. R-147  
DATE Aug 30, 1957 SHEET 1 OF 1