

PLAN AND PROFILE
SANDBERG STREET

PLAN AND PROFILE
LINCOLN AVENUE

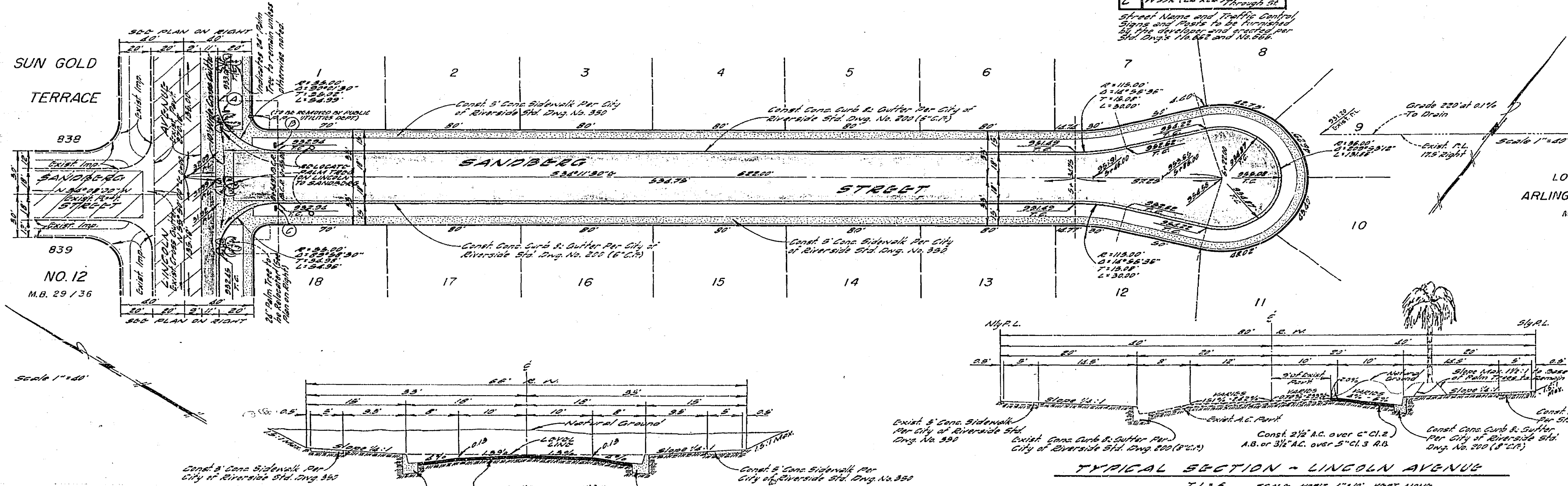

TYPICAL SECTION - SANDBERG STREET
7.1:5 SCALE: HORIZ. 1"=40' VERT. 1"=4'

TYPICAL SECTION - LINCOLN AVENUE
7.1:5 SCALE: HORIZ. 1"=40' VERT. 1"=4'

STREET NAME SCHEDULE

| | | |
|---|----------------|------|
| A | EXISTING | 2100 |
| B | NEW (24" DIA.) | 2100 |
| C | NEW (18" DIA.) | 2100 |

NOTES -
Palm Trees to be relocated as shown to the Parks and Recreation Department Specifications. Contact Parks and Recreation Department 24 hours prior to relocating the palm trees.

GENERAL NOTES -
1. A CONC. SLAB: Soil and load in center of curb return at southwest corner of Lincoln Avenue and Sandberg Street shall be as per the Standard Specifications No. 401 and the Standard Drawing of the City of Riverside, Department of Public Works.
2. It shall be the responsibility of the contractor to obtain the Right of Way in accordance with the provisions of the law as it applies, each utility including irrigation lines and appurtenances and of no cost to the City of Riverside.
3. Working and final binder and seal coat are required.
4. Grading will require a permit under Ordinance No. 3099 for a cut or fill exceeding 100 cubic yards or a fill over 1' in depth.
5. Bottom edge of existing curbing where new curbing joins existing pavement to a clean straight line. Contracting party to be responsible for any damage to underground facilities.
6. Grading shall be done in accordance with the Standard Specifications No. 401 and the Standard Drawing of the City of Riverside, Department of Public Works.
7. Grading shall be done in accordance with the Standard Specifications No. 401 and the Standard Drawing of the City of Riverside, Department of Public Works.
8. Grading shall be done in accordance with the Standard Specifications No. 401 and the Standard Drawing of the City of Riverside, Department of Public Works.

| | | | | | |
|--|-----------------------|--|---------------|--|--------------------|
| GARNER, TEE, TRACADAS & TROY INC. CIVIL ENGINEERING - LAND SURVEYING 357 West Second Street San Bernardino, California Phone TU 5-0266 <i>Frank Tracadas</i> DATE 1/17/79 FRANK TRACADAS R.C.E. 11447 | | CITY OF RIVERSIDE, CALIFORNIA DEPARTMENT OF PUBLIC WORKS APPROVED BY: [Signature] OFFICE ENGINEER: [Signature] PLANS SUPERVISOR: [Signature] TELETYPE DIVISION: [Signature] ASST. CITY ENG. | | PLAN & PROFILE SANDBERG STREET & LINCOLN AVENUE TRACT NO. 4121 PROJECT NO. R-1473 SHEET 1 OF 1 FILE NO. | |
| DESIGNED BY: [Signature] | DRAWN BY: [Signature] | CHECKED BY: [Signature] | DATE: 1/17/79 | HORIZ. SCALE: 1"=40' | VERT. SCALE: 1"=4' |