

BENCH MARK: FB 706/52  
 PK. HIL IN SE CB RETURN  
 FILLMORE ST & DORSET DR.  
 ELEV. 755.750

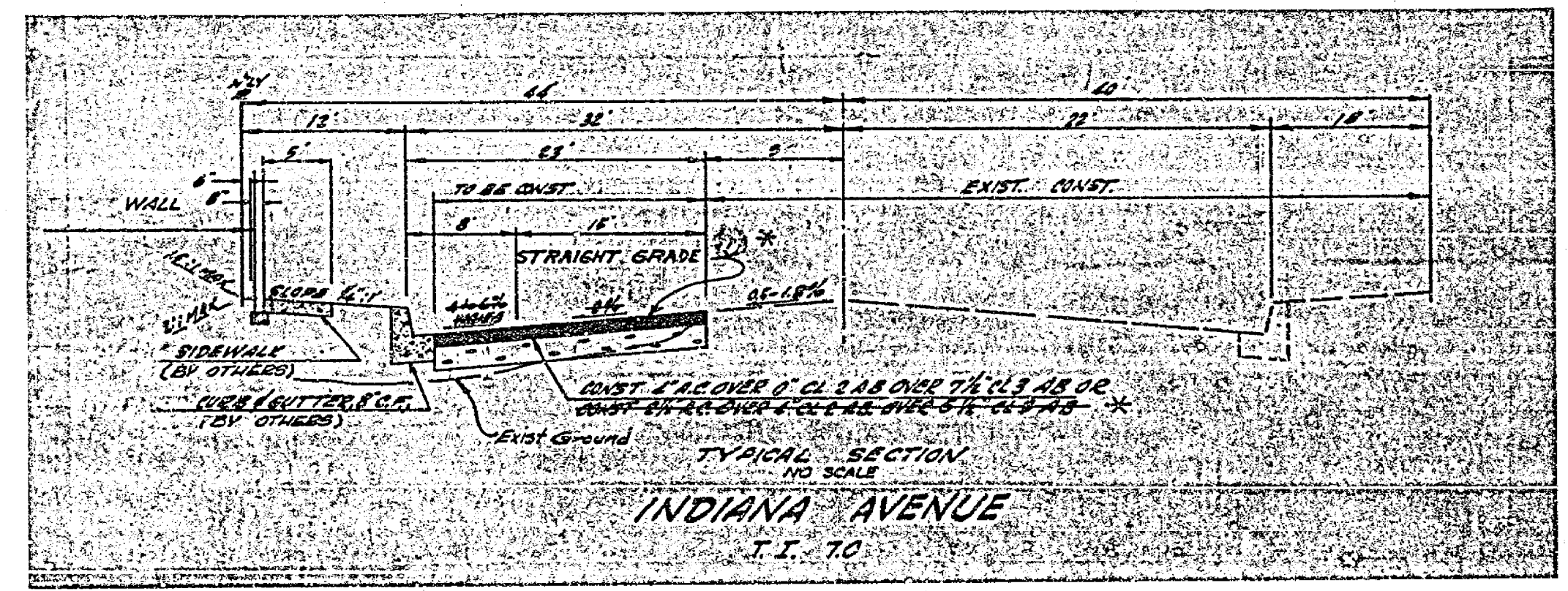
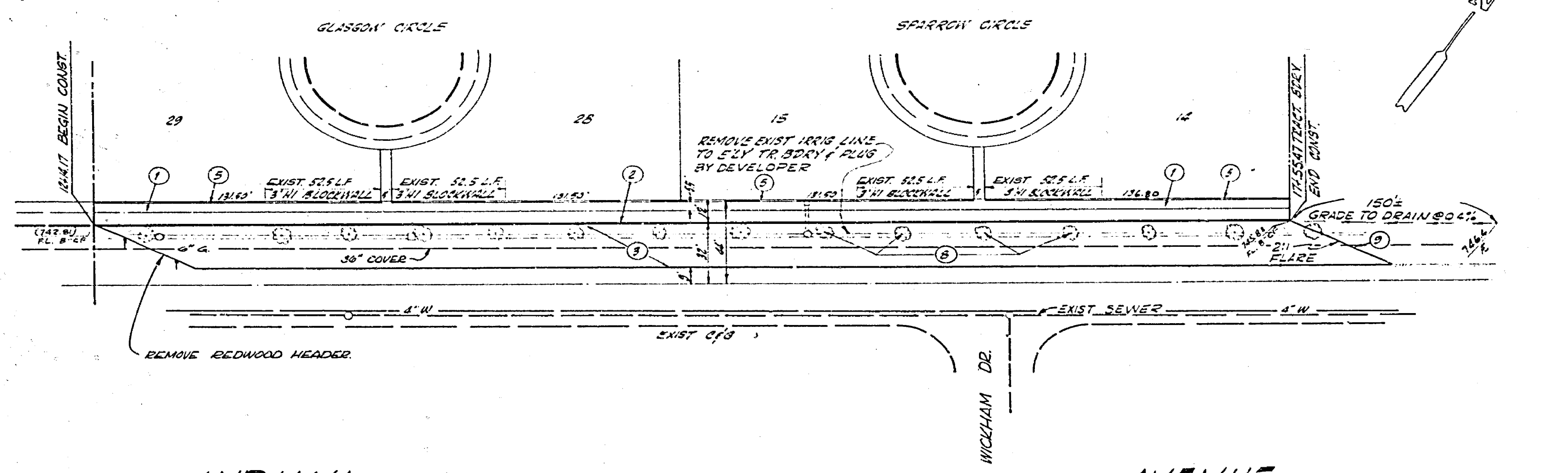

INDIANA

AVENUE

- CONSTRUCTION NOTES
- ① SIDEWALK (BY OTHERS)
  - ② CURB & UTTER 4" W.C. (BY OTHERS)
  - ③ A.C. CURB 4" A.B. TO SE CONST (SEE TYP. CROSS SECTION)
  - ④ EXIST 3" W. SIDEWALK
  - ⑤ FORMER TREE SITES WHICH SHALL BE COMPACTED TO A DEPTH OF 3'
  - ⑥ INSTALL 2" x 4" REDWOOD HEADERS.

\* AS BUILT 10-4-71

IRRIGATION DIVISION

APPROVED BY: *Laurel S. Brown*  
 DATE: 6-2-71

PREPARED IN THE OFFICES OF  
 VOORHEES, TRINDLE & NELSON  
 2201 GARLAND AVENUE  
 IRVINE, CALIFORNIA  
 APPROVED BY: *John McHenry*  
 FOR MARGARET E. G. JONES  
 DATE: 7-7-71

NO.	REVISIONS	APPR.	DATE

CITY OF RIVERSIDE, CALIFORNIA DEPARTMENT OF PUBLIC WORKS			
APPROVED BY	BY	DATE	APPROVED BY
OFFICE ENGINEER	<i>E. J. ...</i>	7/27/71	<i>John McHenry</i>
TRAFFIC DIVISION	(E.S.)	7/27/71	DIRECTOR OF PUBLIC WORKS
ASSISTANT CITY ENGINEER			
			DATE: 7/27/71

INDIANA AVENUE  
 FROM FENBURN ST. TO WICKHAM DR.  
 TRACT 3651  
 CITY PARTICIPATION

PROJECT NO.	R-1495
SHEET	1 OF 1
FILE NO.	

HORIZ. SCALE: 1" = 40'  
 VERT. SCALE: 1" = 4'