

825

825 ±

630

± 630

ORCHARD ST.

2

3

4

5

6

7

8

PARCEL 1

PARCEL 2

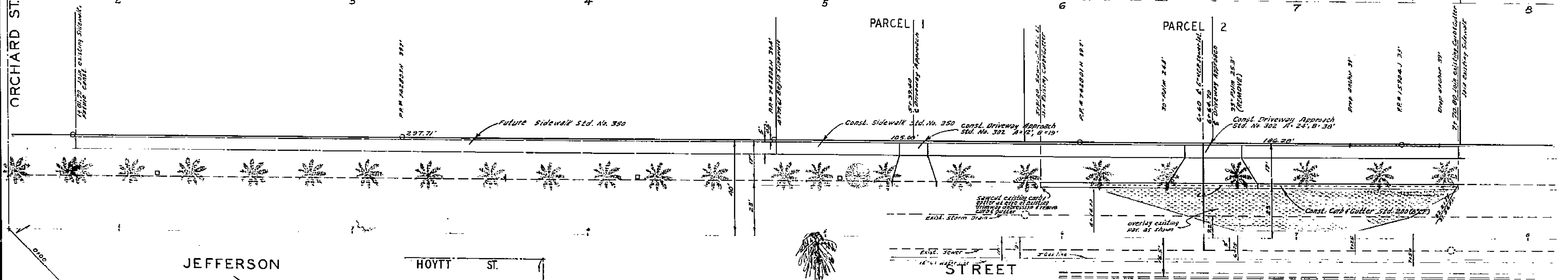

JEFFERSON

HOYTT ST.

STREET

RIVERSIDE FWY.

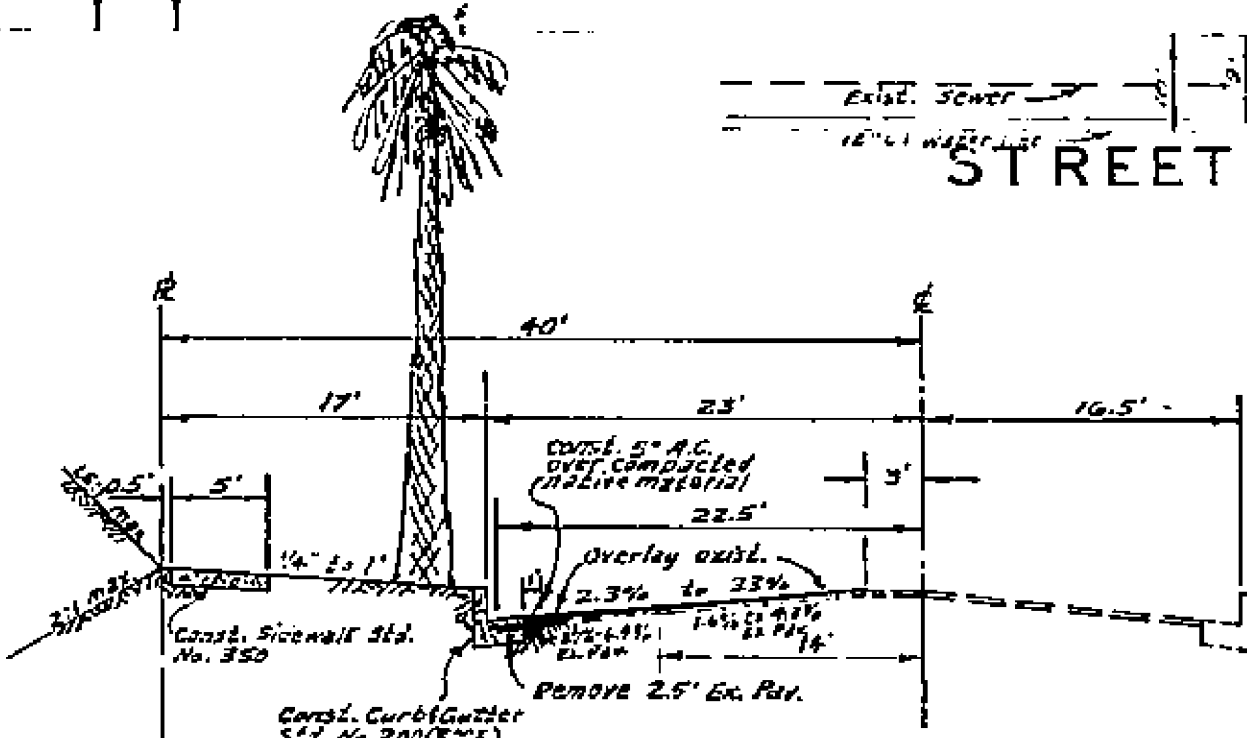
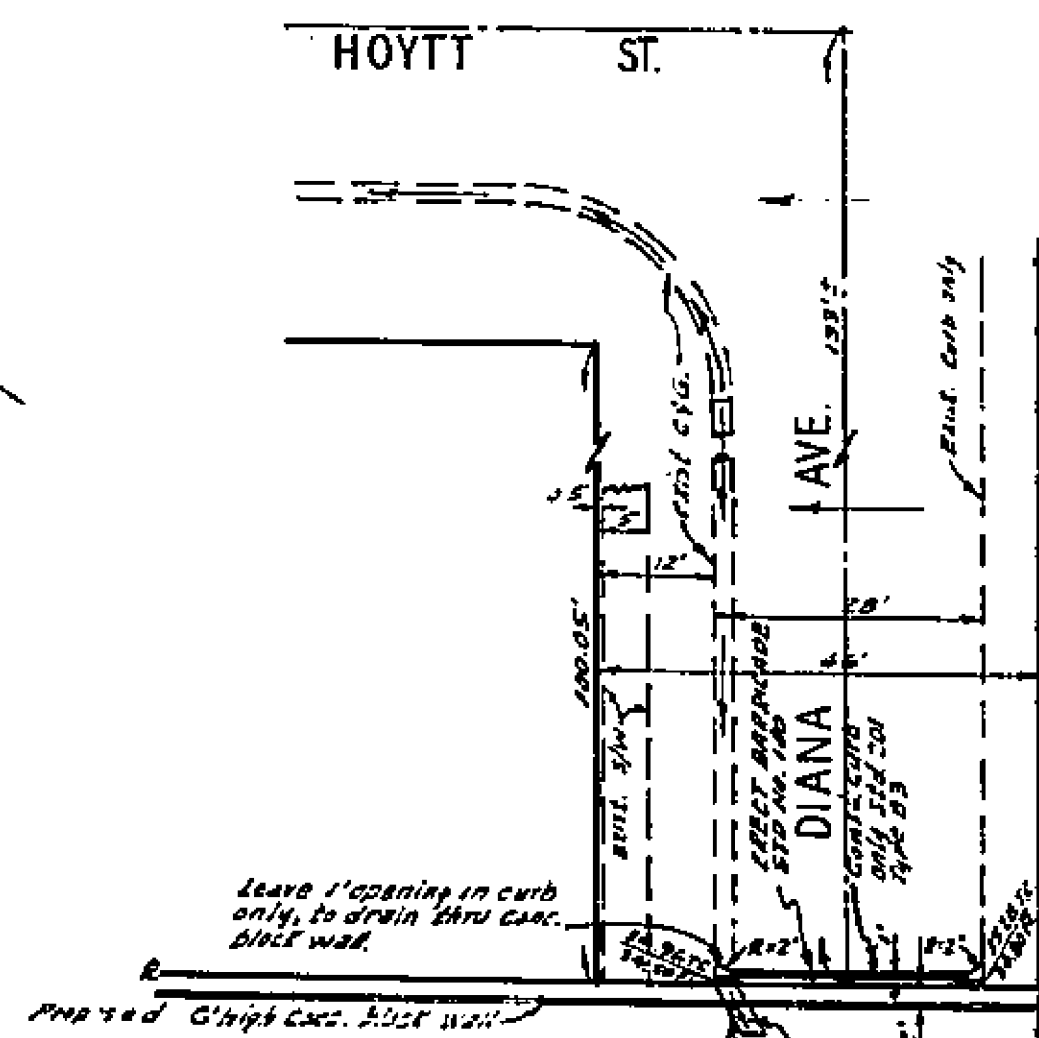

TYPICAL SECTION JEFFERSON STREET

GENERAL NOTES

- 1. Construction shall be in accordance with the Standard Specifications for Public Works Construction, 1970 Edition, and City of Riverside Standard Drawings.
- 2. All flagged elevations shall be staked in the field by the Engineer.
- 3. The amount of asphalt overlay on existing pavement has been estimated by the Engineer to be approximately 11 Tons.

BENCH MARK

CIR No. GS-F Elev. 792.336
P.C. 11/11/2003 M.W. 1/4 of E.C.R. at N.W. corner of Midway Ave. and Jefferson St. CIR No. 739/71

ALBERT A. WEBB ASSOCIATES CIVIL ENGINEERS RIVERSIDE, CALIFORNIA APPROVED BY: <i>[Signature]</i> DATE 12/14/11 R.E. No. 9876 W.D. 71-267 FOR William Austin		CITY OF RIVERSIDE, CALIFORNIA PUBLIC WORKS DEPARTMENT APPROVED BY: <i>[Signature]</i> DATE 2/10/12 PARK DEPARTMENT TRAFFIC DIVISION CHIEF PUBLIC WORKS ENGINEER DATE 2/10/12		STREET PLAN AND PROFILE JEFFERSON STREET BETWEEN ORCHARD ST. AND RIVERSIDE HWY DIANA AVENUE BETWEEN HOYTT ST. AND JEFFERSON ST. PARCEL MAP NO. 66 SCALE: 1" = 20' Horiz., 1" = 4' Vert.		ACCOUNT No. DRAWING NUMBER R-1555 SHEET 1 OF 1 71-267-A	
---	--	--	--	---	--	--	--