

B.M.: CITY DUC 801-20-88
 ON ELY CORNER OF
 TYLER AT MAGNOLIA
 ELEV.: 782.24
 A.B. REF: 989/69-72
 981/72, 75-78
 986/83

PROFILE BANBURY DR.
 SCALE HOR 1"=20'
 VER 1"=5'

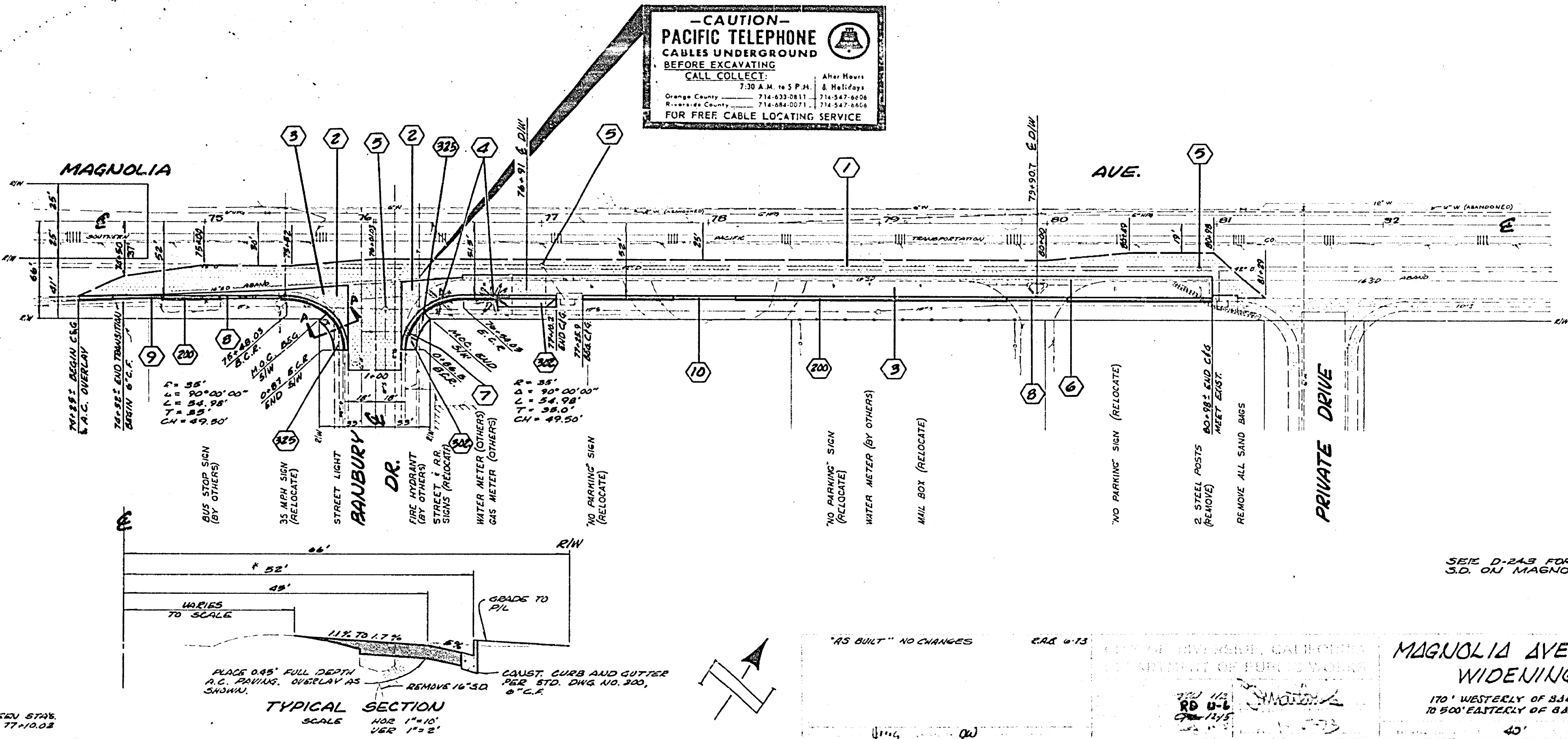
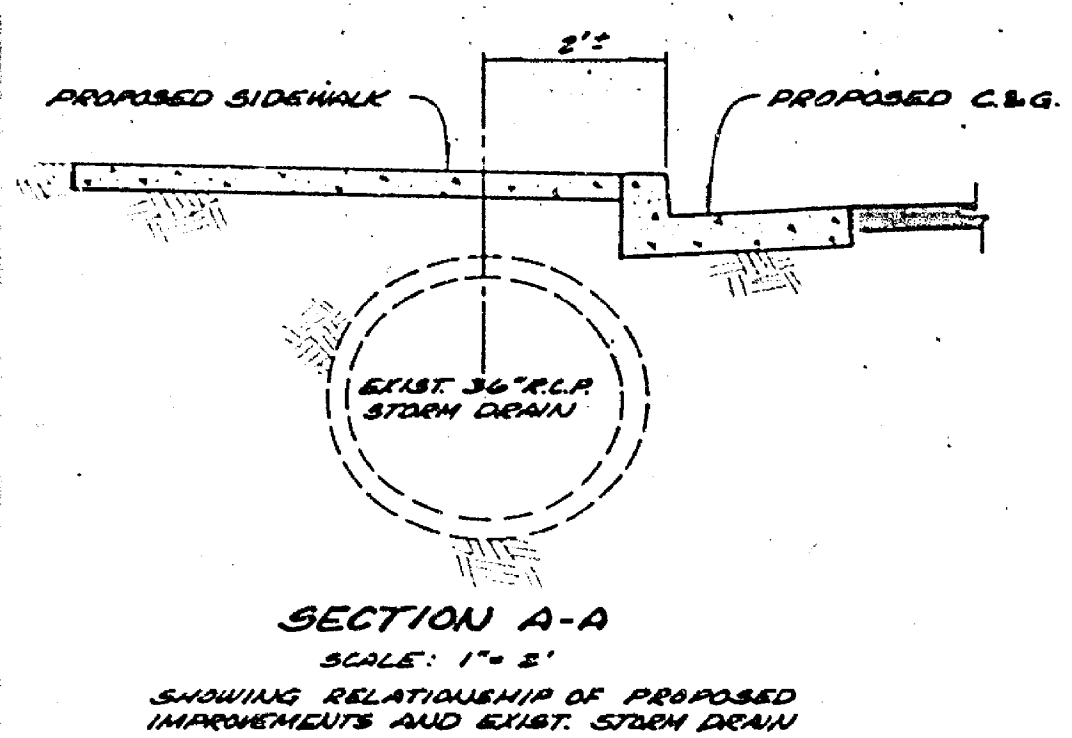

- NOTES:**
- 1 CONST. A.C. OVERLAY.
 - 2 REMOVE EXIST. CURB, GUTTER AND DRAINAGE APPROX.
 - 3 PLACE 0.55' FULL DEPTH A.C. PAVING.
 - 4 REMOVE PALM TREE.
 - 5 ADJUST MANHOLE COVER TO GRADE.
 - 6 REMOVE 16" S.D. BETWEEN STA. 74+38.1 AND 80+96. PLUS EUDS TO BE LEFT IN PLACE.
 - 7 RELOCATE FIRE HYDRANT, BY OTHERS.
 - 8 CONST. CURB & GUTTER PER STD. DWG. NO. 303, 6" C.F.
 - 9 CONST. DIM APPROACH AS PER STD. DWG. NO. 302, A=31' B=56'. LOCATE ADJACENT TO EXIST. C.B.
 - 10 CONST. CURB SIGN AS PER STD. DWG. NO. 326, TERMINATE AT M.O.C.
 - 11 CONST. DIM DEPRESSION B=34'. PLACE A.C. PAVING IN PARKWAY AS REQUIRED.
 - 12 CONST. DIM DEPRESSION B=29'. PLACE A.C. PAVING IN PARKWAY AS REQUIRED.
 - 13 CONST. DIM DEPRESSION B=36'. CHECK WITH MR. MORELL FOR LOCATION. 689-9174.

* CREDIT BETWEEN STNS. 78+54.03 AND 77+00.03 WHEN 16 S.D.

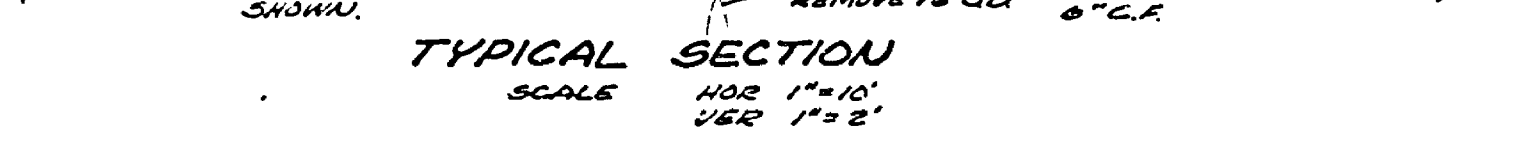

"AS BUILT" NO CHANGES

SEE D-243 FOR S.D. ON MAGNOLIA

MAGNOLIA AVENUE WIDENING
 170' WESTERLY OF BANBURY TO 500' EASTERLY OF BANBURY

INDEXED MAP 22A-264
 R-1606