

B.M. ELY 76146 "PK" IN SE. CB. RET. MADRONA & CALIFORNIA
 F.B. 604/67, 574/53
 SCALE HOR. 1" = 50'
 SCALE VERT. 1" = 5'

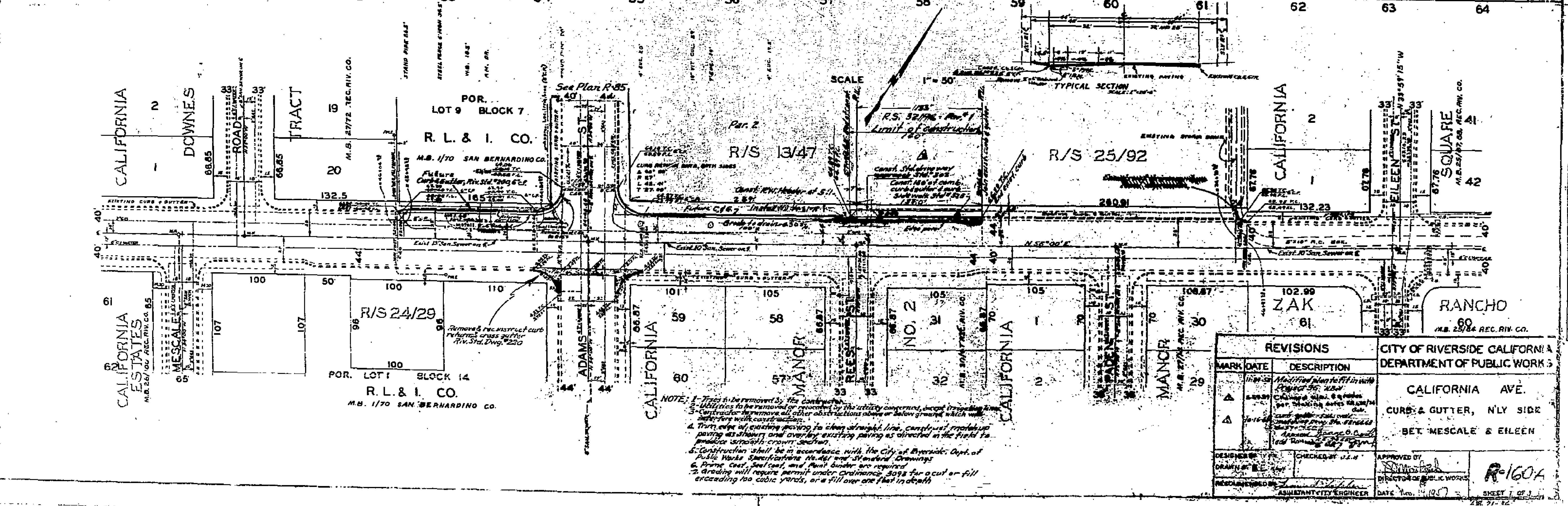

NOTE: 1. Trees to be removed by the Contractor.
 2. Utilities to be removed or relocated by the utility concerned, except (if applicable) gas.
 3. Contractor to remove all other obstructions above or below ground which will interfere with construction.
 4. True edge of existing paving to clean straight line, construct, make-up paving as shown and overlay existing paving as directed in the field to produce smooth crown section.
 5. Construction shall be in accordance with the City of Riverside, Dept. of Public Works Standard Specifications for Street and Storm Drainage Drawings.
 6. Prime coat, Seal coat, and Pavement Binder are required.
 7. Grading will require permit under Ordinance 3093 for a cut or fill exceeding 100 cubic yards, or a fill over one foot in depth.

REVISIONS	
MARK	DATE
Δ	11-16-66
Δ	11-16-66

CITY OF RIVERSIDE CALIFORNIA DEPARTMENT OF PUBLIC WORKS	
CALIFORNIA AVE. CURB & GUTTER, NLY SIDE BET MESCALE & EILEEN	
DESIGNED BY DRAWN BY CHECKED BY APPROVED BY	DATE: 11-16-66 SHEET 1 OF 1

PROFILE	DATE: 11-16-66
NO. 160A	

PLAN	DATE: 11-16-66
NO. 160A	