

PARCEL 2

PARCEL 3

ALBERT A. WEBB ASSOCIATES CIVIL ENGINEERS RIVERSIDE, CALIFORNIA APPROVED BY: <i>[Signature]</i> DATE: 6-24-73 R.E. No. 1630A		CITY OF RIVERSIDE, CALIFORNIA DEPARTMENT OF PUBLIC WORKS APPROVED BY: <i>[Signature]</i> DATE: 7/26/73 DIRECTOR OF PUBLIC WORKS		STREET PLAN AND PROFILE ARRLINGTON AVENUE NORTH SIDE C'N OF VAN BUREN CITY PARTICIPATION FOR P.M. 113	PROJECT NO. 72-290 R-1630-A SHEET 1 OF 2 FILE NO.
DESIGNED BY: <i>[Signature]</i> DRAWN BY: <i>[Signature]</i> CHECKED BY: <i>[Signature]</i>		REVISIONS:		HORIZ. SCALE: 1" = 20' VERT. SCALE: 1" = 2' ADAPTED FROM PLAN R-1630	

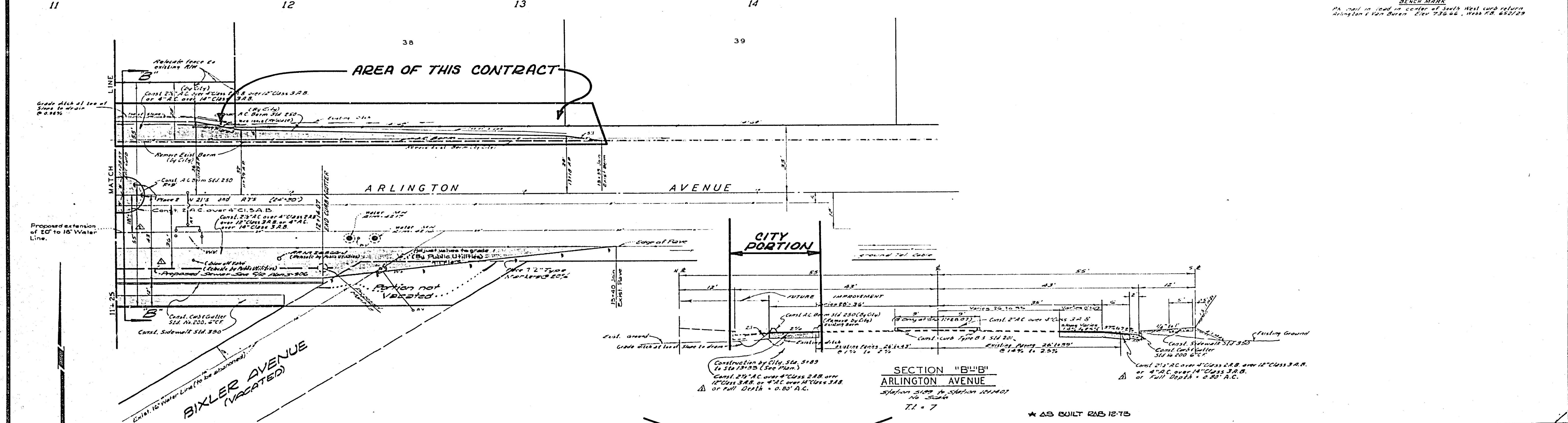
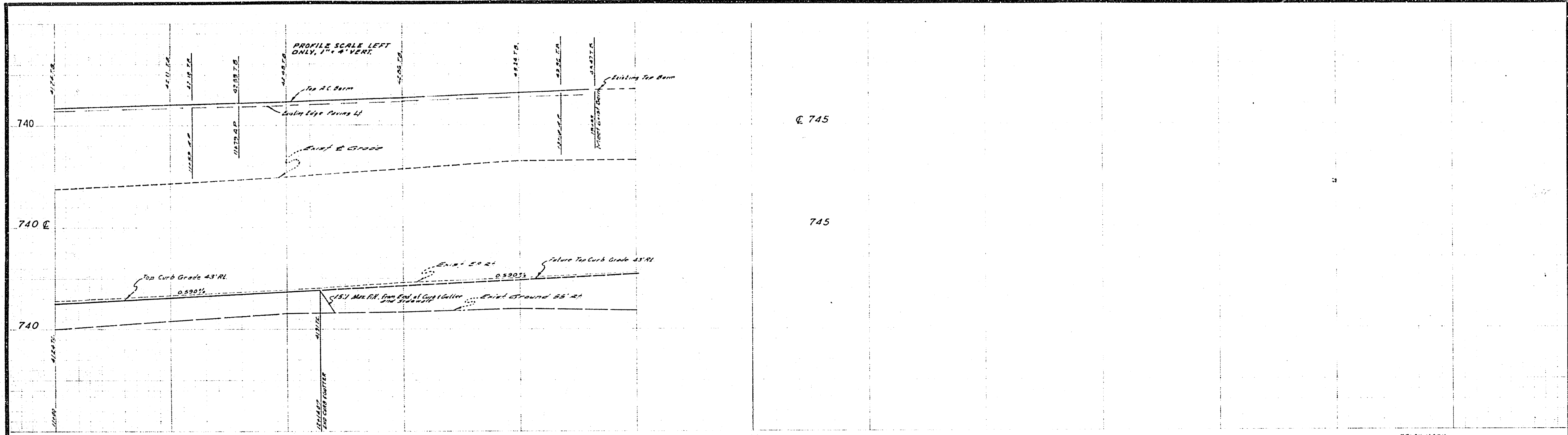

ALBERT A. WEBB ASSOCIATES CIVIL ENGINEERS RIVERSIDE, CALIFORNIA APPROVED BY: <i>[Signature]</i> DATE: 11-24-72 R.E. No. 10025		CITY OF RIVERSIDE, CALIFORNIA DEPARTMENT OF PUBLIC WORKS APPROVED BY: <i>[Signature]</i> DATE: 7/26/73 PARK DEPARTMENT TRAFFIC DIVISION ASSISTANT CITY ENGINEER		STREET PLAN AND PROFILE ARLINGTON AVENUE NORTH SIDE SW. OF 10th STREET CITY PARTICIPATION FOR RM. 113 HORIZ. SCALE: 1" = 20' VERT. SCALE: 1" = 2'	PROJECT NO. 72-270 R-1630-A SHEET 2 OF 2 FILE NO.
---	--	--	--	--	--

ADAPTED FROM PLAN R-1630