

VAN BUREN BLVD. - EXISTING IMPROVEMENT LOCATIONS

ITEM	DESCRIPTION
⊙	22" Ø 21023 RELOCATE BY OTHERS
⊙	12" Ø 19263 RELOCATE BY OTHERS
⊙	12" Ø 19263 RELOCATE BY OTHERS
⊙	22" Ø RELOCATE BY OTHERS
⊙	12" Ø 19263 RELOCATE BY OTHERS
⊙	VICTORIA AVE' CO. 800V RELOCATE TO PARKWAY

STREET SECTION GRADES
 (A) - EXIST VARIES BETWEEN 1.75% & 2.66%
 (B) - NEW IMPROVEMENTS VARIES 1.70% TO 2.65% MAX.
 (C) - VARIES 1.5% MIN., 6% MAX.

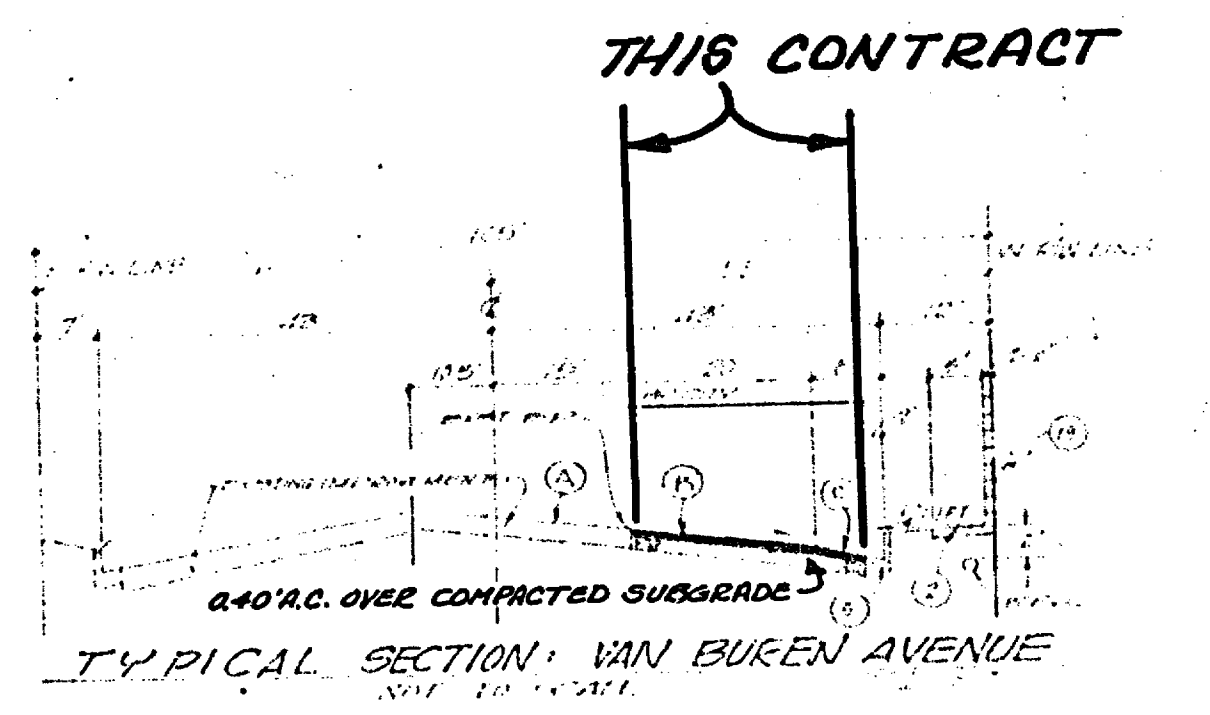
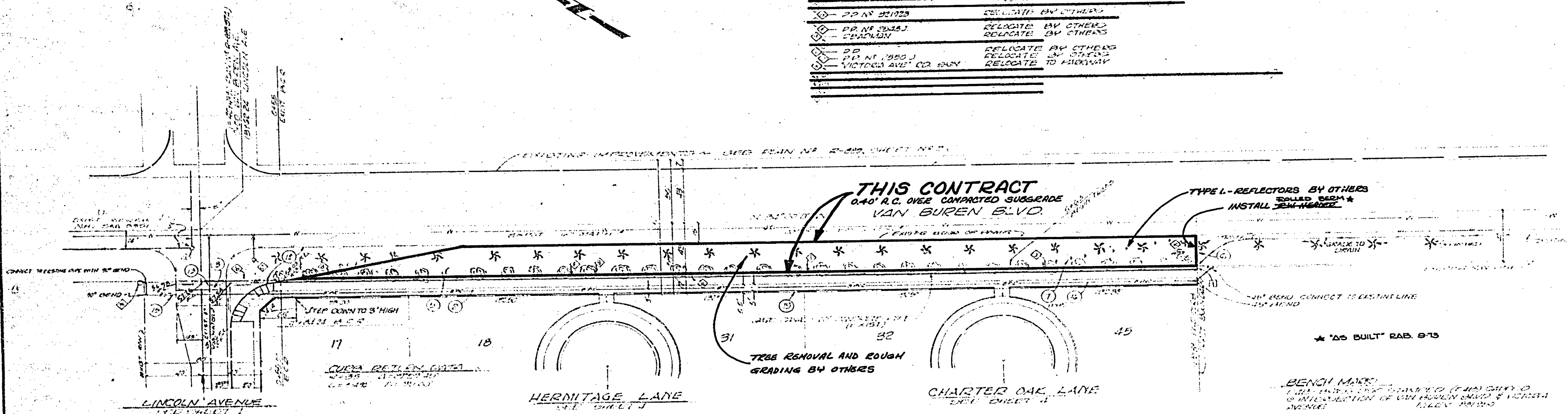

<p>APPROVED UNDER THE SUPERVISION OF</p> <p><i>Don L. Laine</i> 10/5/72</p> <p>L.A. ENGINEERING</p> <p>225 W. 1ST ST. RIVERSIDE, CALIF.</p>	<p>CITY OF RIVERSIDE, CALIFORNIA</p> <p>DEPARTMENT OF PUBLIC WORKS</p> <p>APPROVED BY <i>William J. Hadden</i></p> <p>DATE 6/15/73</p>	<p>STREET PLAN & PROFILE</p> <p>TRACT 4864</p> <p>CITY PARTICIPATION</p> <p>VAN BUREN BOULEVARD FROM LINCOLN AVENUE TO 100' SOUTHWEST</p>	<p>R-1681-A</p> <p>SHEET 1 OF 1</p>
		<p>ADAPTED FROM PLAN R-1681</p>	