

95

95

95

95

95

95

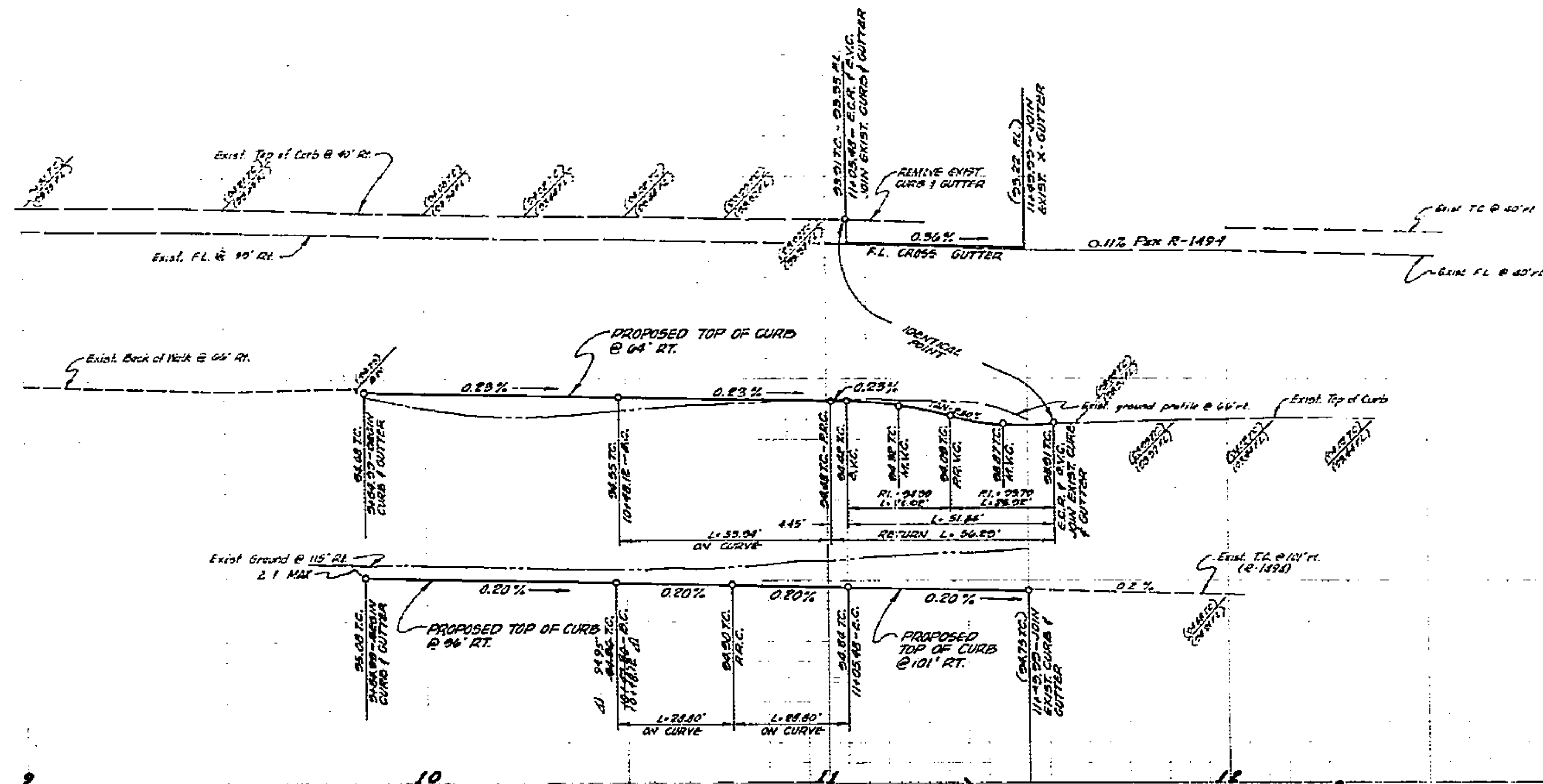

(THIS PROJECT ONLY)
 T. B.M. : 0.12 O. EACH SIDE, 2' AWAY FROM
 OF PROP CORNER 66' SELY OF
 E. MAGNOLIA AVE. 163' ELY OF E
 OF ROSLYN ST.
 ELEV. 794.72
 BRANCH MARK : CITY B.M. # 85-F
 12' W. END 1745' IN T.C., 3' AWAY OF
 E.A.R. @ N.E. CURB INTERSECTION OF
 JEFFERSON ST. & MAGNOLIA AVE.
 ELEV. : 792.34

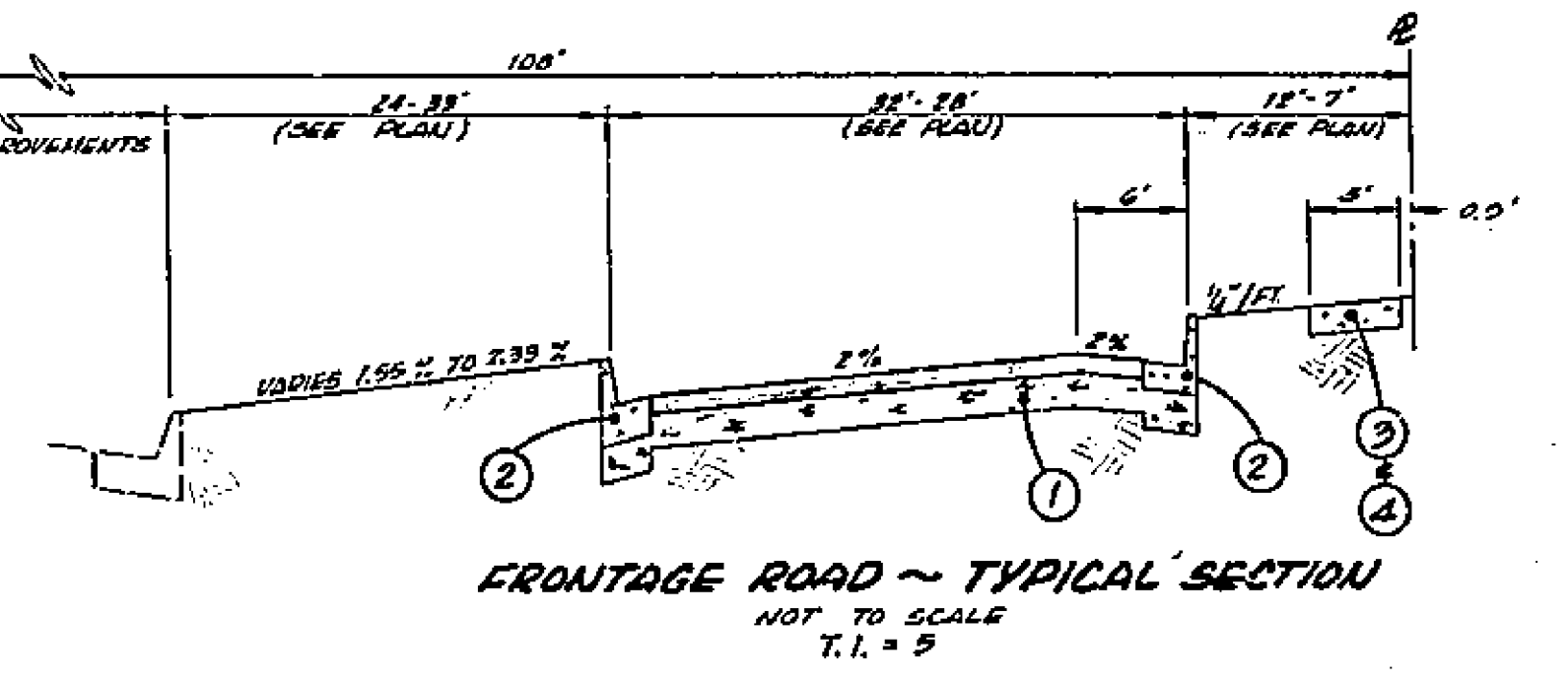

FRONTAGE ROAD - TYPICAL SECTION
 NOT TO SCALE
 T.I. = 5

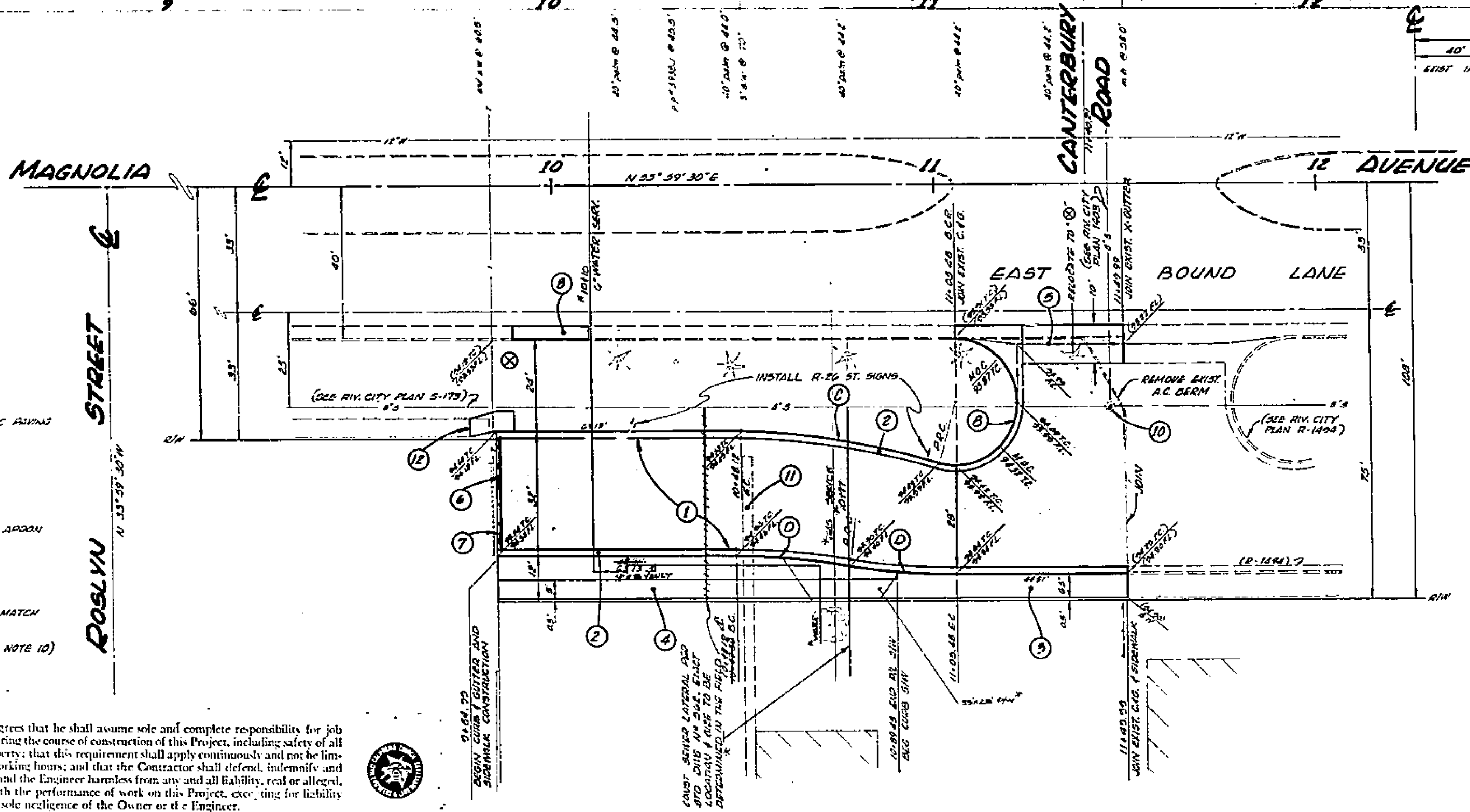

- CONSTRUCTION NOTES :**
1. CONST 1 1/2" A.C. PAVING 9" D.G. BASE OR 0.55' FULL DEPTH A.C. PAVING OVER COMPACTED NATIVE SOIL.
 2. CONST CURB AND GUTTER PER STD DWS # 300, 6" C.F.
 3. CONST CURB SIDEWALK PER STD DWS # 325.
 4. CONST PARALLEL LINE SIDEWALK PER STD DWS # 325.
 5. REMOVE EXIST CURB & GUTTER, CONST CROSS GUTTER AND APPROX PER STD DWS # 310.
 6. CONST BARRICADE PER STD DWS # 160.
 7. INSTALL 28" X 24" REDWOOD WESDER.
 8. REMOVE EXIST DIM DEPRESSION, CONST. CURB & GUTTER TO MATCH EXIST. C.F.G.
 9. CONST DIM APPROACH PER STD DWS # 302 (SEE GENERAL NOTE 10)
 10. ADJUST M.H. TO GRADE
 11. REMOVE EXIST SIGN WITHIN RIGHT OF WAY
 12. REMOVE EXIST SIGN FOR 95' L.F. AND CONST 12" L.F. OF 9" WIDE SIGN PER STD DWS # 325, TO PROVIDE SMOOTH ACCESS

Contractor agrees that he shall assume sole and complete responsibility for job site conditions during the course of construction of this Project, including safety of all persons and property; that this requirement shall apply continuously and not be limited to normal working hours; and that the Contractor shall defend, indemnify and hold the Owner and the Engineer harmless from any and all liability, real or alleged, in connection with the performance of work on this Project, excepting for liability arising from the sole negligence of the Owner or the Engineer.

CURVE	R	D	L	T
①	25.00'	90°40'40"	50.27'	26.00'
②	16.50'	195°27'06"	56.29'	27.15'
③	100.00'	15°27'06"	53.94'	27.15'
④	108.00'	09°49'25"	28.80'	43.64'

J. F. DAVIDSON ASSOCIATES
 CIVIL ENGINEERS - SURVEYORS - PLANNERS
 RIVERSIDE, CALIFORNIA
 APPROVED BY *Robert D. Miller* DATE 5-7-73
 R.E. No. 132591
 W.O. 3708 FOR ROBERT D. MILLER P.B. 10/4

* "AS BUILT" E.S.K. 1/11/74

APPROVED BY: *[Signature]* DATE: 3-5-74
 OFFICE ENGINEER
 PARK DEPARTMENT
 TRAFFIC DIVISION
 ASSISTANT CITY ENGINEER

CITY OF RIVERSIDE, CALIFORNIA
 DEPARTMENT OF PUBLIC WORKS

STREET PLAN & PROFILE
FRONTAGE ROAD
 SE'LY SIDE OF MAGNOLIA AVE. BETWEEN
 ROSLYN ST. & JEFFERSON ST.
 R-53-712

PROJECT NO. **R-1687**
 SHEET **1** OF **1**
 HORIZ. SCALE: 1" = 20' VERT. SCALE: 1" = 2' FILE NO. 4458